

No OF CCTS.	DIMn. A	DIMn. B
2	(5.08 ± 0.05) / .200 ± 0.002	(9.91 ± 0.15) / .390 ± 0.006
3	(10.16 ± 0.08) / .400 ± 0.003	(14.99 ± 0.15) / .590 ± 0.006
4	(15.24 ± 0.08) / .600 ± 0.003	(20.07 ± 0.18) / .790 ± 0.007
5	(20.32 ± 0.08) / .800 ± 0.003	(25.15 ± 0.20) / .990 ± 0.008
6	(25.40 ± 0.10) / 1.000 ± 0.004	(30.23 ± 0.23) / 1.190 ± 0.009
7	(30.48 ± 0.13) / 1.200 ± 0.005	(35.31 ± 0.25) / 1.390 ± 0.010
8	(35.56 ± 0.20) / 1.400 ± 0.008	(40.39 ± 0.28) / 1.590 ± 0.011
9	(40.64 ± 0.20) / 1.600 ± 0.008	(45.47 ± 0.30) / 1.790 ± 0.012
10	(45.72 ± 0.20) / 1.800 ± 0.008	(50.55 ± 0.30) / 1.990 ± 0.012
11	(50.80 ± 0.20) / 2.000 ± 0.008	(55.63 ± 0.33) / 2.190 ± 0.013
12	(55.88 ± 0.25) / 2.200 ± 0.010	(60.71 ± 0.33) / 2.390 ± 0.013

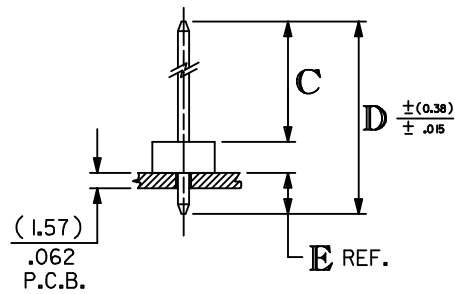
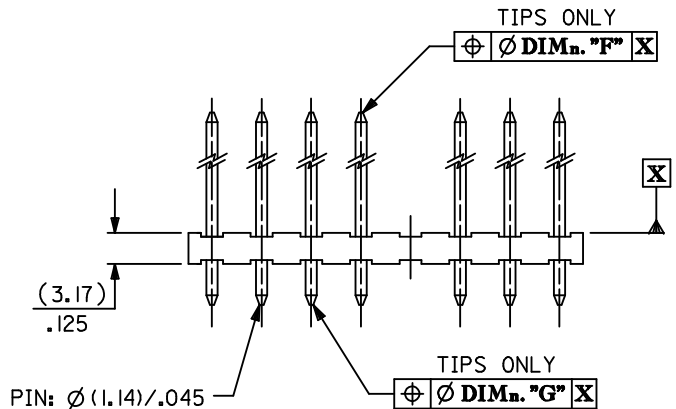

3003-N * - *
 BASE No. | No. OF CCTS. | VERSION | VOID CODE NO. CORRESPONDS TO CIRCUIT NO. VOIDED. MULTIPLE VOIDS START WITH 51.

- NOTES:
 1. MATERIAL: WAFER: NYLON UL94V-2, COLOR: NATURAL
 PINS: BRASS
 2. FINISH: (222) = OVERALL MATTE TIN, (0.00254)/.000100 MIN. OVER (0.00127)/.000050 MIN. NICKEL
 3. PRODUCT SPECIFICATION: PS-99020-0087
 4. PIN PUSH OUT FORCE: (1.36KG)/3LBS MIN.
 5. PIN MUST MEET MOLEX SOLDERABILITY SPEC. ES-152.
 6. MAX. BOW: (0.38)/.015 OVER (25.4)/1.00
 7. FOR DIMENSIONS "C", "D", "E", "F" AND VERSIONS, SEE CHARTS ON SHEET 2 AND SUBSEQUENT SHEETS.
 8. FOR VERSIONS WITH VOIDS, SEE SHEET 4.
 9. CIRCUIT 1 IS USED TO DEFINE VOID LOCATION. CIRCUIT 1 MAY OR MAY NOT LINE UP WITH CIRCUIT 1 ON MATING PART.
 10. THIS PART CONFORMS TO CLASS B REQUIREMENTS OF COSMETIC SPECIFICATION PS-45499-002.

REMOVE AE-3003-NC EEC NO: UCP2013-0223 DRWN:MMSTROH 2012/06/08 CHKD:MKIPPER 2012/07/18 APPR:FSMITH 2012/07/25 BP1 REV	QUALITY SYMBOLS ▽=0 ▽=0 ▽=0	GENERAL TOLERANCES (UNLESS SPECIFIED) mm INCH 4 PLACES ± --- ± --- 3 PLACES ± --- ± .010 2 PLACES ± 0.25 ± .014 1 PLACE ± 0.35 ± --- 0 PLACE ± ±	DIMENSION STYLE MM/IN DRAWN BY DATE DBYRNES 02/11/22 CHECKED BY DATE BMAGUIRE 02/11/22 APPROVED BY DATE FSMITH 2010/12/06	SCALE 2:1 DESIGN UNITS METRIC THIRD ANGLE PROJECTION	TITLE KK (5.08)/.200 VERTICAL HEADER ASSEMBLY ROUND PIN molex	MATERIAL NO. SEE CHART SIZE B THIS DRAWING CONTAINS INFORMATION THAT IS PROPRIETARY TO MOLEX INCORPORATED AND SHOULD NOT BE USED WITHOUT WRITTEN PERMISSION	DOCUMENT NO. SDAE-3003-N* SHEET NO. 1 OF 4
---	--------------------------------------	--	--	--	---	--	---

INDEX: FOR FULL DIMENSIONS SEE RELEVANT SHEET.

ENG. No.	PLATING	DIM. C	DIM. D	SHT. No.
AE-3003-NA	(222)	(11.94) / .470	(19.05) / .750	3
AE-3003-NB	(222)	(16.69) / .657	(23.80) / .937	3
AE-3003-NI	(222)	(13.51) / .532	(20.32) / .800	3

FOR VOID VERSIONS SEE SHEET 4.

SEE SHEET 1 EC NO: UCP2013-0223 DRWN:MMSTROH 2012/06/08 CHKD:KKIPPER 2012/07/18 APPR:FSMITH 2012/07/25	QUALITY SYMBOLS ∇=0 ∇=0 ∇=0	GENERAL TOLERANCES (UNLESS SPECIFIED) 4 PLACES ± --- ± --- 3 PLACES ± --- ± .010 2 PLACES ± 0.25 ± .014 1 PLACE ± 0.35 ± --- 0 PLACE ± ±	DIMENSION STYLE MM/IN DRAWN BY DBYRNES DATE 02/11/22 CHECKED BY DATE BMAGUIRE 02/11/22 APPROVED BY DATE FSMITH 2010/12/06	SCALE 1:1 DESIGN UNITS METRIC THIRD ANGLE PROJECTION	TITLE KK (5.08)/.200 VERTICAL HEADER ASSEMBLY ROUND PIN
	DESCRIPTION BP1	ANGULAR ± --- ° DRAFT WHERE APPLICABLE MUST REMAIN WITHIN DIMENSIONS	MATERIAL NO. SEE CHART	DOCUMENT NO. SDAE-3003-N*	SHEET NO. 2 OF 4
	THIS DRAWING CONTAINS INFORMATION THAT IS PROPRIETARY TO MOLEX INCORPORATED AND SHOULD NOT BE USED WITHOUT WRITTEN PERMISSION				
	molex				

ENG. NO.	AE-3003-NA		AE-3003-NB		AE-3003-NI	
DIMN. "C"	(11.94 ±0.51) .470 ±.020		(16.69 ±0.51) .657 ±.020		(13.51 ±0.51) .532 ±.020	
DIMN. "D"	(19.05) / .750		(23.80) / .937		(20.32) / .800	
DIMN. "E"	(3.94) / .155		(3.94) / .155		(3.63) / .143	
DIMN. "F"	(1.02) / .040		(1.02) / .040		(1.02) / .040	
DIMN. "G"	(1.02) / .040		(1.02) / .040		(1.02) / .040	
PLATING	(222)		(222)		(222)	
	PART NO.	ENG NO.	PART NO.	ENG NO.	PART NO.	ENG NO.
NO. OF CIRCUITS	2	10-08-102I	AE-3003-2A	10-08-1022	AE-3003-2B	10-08-1029 AE-3003-2I
	3	▲ -103I	▲ -3A	▲ -1032	▲ -3B	▲ -1039 ▲ -3I
	4	-104I	-4A	-1042	-4B	-1049 -4I
	5	-105I	-5A	-1052	-5B	-1059 -5I
	6	-106I	-6A	-1062	-6B	-1069 -6I
	7	-107I	-7A	-1072	-7B	-1079 -7I
	8	-108I	-8A	-1082	-8B	-1089 -8I
	9	-109I	-9A	-1092	-9B	-1099 -9I
	10	-110I	-10A	-1102	-10B	-1109 -10I
	11	▼ -111I	▼ -11A	▼ -1112	▼ -11B	▼ -1119 ▼ -11I
	12	10-08-112I	AE-3003-12A	10-08-1122	AE-3003-12B	10-08-1129 AE-3003-12I

SEE SHEET 1 EC NO: UCP2013-0223 DRAWN:MMSTROH 2012/06/08 CHKD:MKIPPER 2012/07/18 APPR:FSMITH 2012/07/25 REV	QUALITY SYMBOLS	GENERAL TOLERANCES (UNLESS SPECIFIED)		DIMENSION STYLE	SCALE	DESIGN UNITS	THIRD ANGLE PROJECTION
	▽/0	mm	INCH	MM/IN	1:1	METRIC	
	▽/0	4 PLACES ± --- ± ---	3 PLACES ± --- ± .010	DRAWN BY DATE	TITLE		
	▽/0	2 PLACES ± 0.25 ± .014	1 PLACE ± 0.35 ± ---	DBYRNES 02/11/22	KK (5.08)/.200 VERTICAL HEADER ASSEMBLY ROUND PIN		
	0 PLACE ± ±	ANGULAR ± --- °	DRAFT WHERE APPLICABLE MUST REMAIN WITHIN DIMENSIONS	CHECKED BY DATE	APPROVED BY DATE	DOCUMENT NO.	
BP1				BMAGUIRE 02/11/22	FSMITH 2010/12/06	SDAE-3003-N*	
				MATERIAL NO.	THIS DRAWING CONTAINS INFORMATION THAT IS PROPRIETARY TO MOLEX INCORPORATED AND SHOULD NOT BE USED WITHOUT WRITTEN PERMISSION		SHEET NO. 3 OF 4

10 9 8 7 6 5 4 3 2 1

WAFERS WITH VOIDS:

No. OF CCTS	ENG. NO.	PART NO.	VOID CCT. LOCATION	FOR DIMns. SEE WAFER No.	PLATING
3	AE-3003-3A-2	38-00-5931	2		
4	AE-3003-4A-2	38-00-6865	2		
4	AE-3003-4A-51	38-00-0205	2,3		
6	AE-3003-6A-51	10-08-1067	2,4,5		
9	AE-3003-9A-2	10-08-1098	2		
10	AE-3003-10A-2	10-08-1108	2		
12	AE-3003-12A-51	10-08-1128	4,7		

SEE SHEET 1 DEC NO: UCP2013-0223 DRW:MMSTROH 2012/06/08 CHKD:HKIPPER 2012/07/18 APPR:FSMITH 2012/07/25 BP1	QUALITY SYMBOLS	GENERAL TOLERANCES (UNLESS SPECIFIED)	DIMENSION STYLE	SCALE	DESIGN UNITS	THIRD ANGLE PROJECTION	
	DESCRIPTION REV	$\nabla = 0$ $\nabla = 0$ $\nabla = 0$	mm INCH	MM/IN	1:1	METRIC	
		4 PLACES ± --- ± ---	DRAWN BY DATE	TITLE KK (5.08)/.200 VERTICAL HEADER ASSEMBLY ROUND PIN molex			
		3 PLACES ± --- ± .010	CHECKED BY DATE				
		2 PLACES ± 0.25 ± .014	APPROVED BY DATE				
1 PLACE ± 0.35 ± ---							
0 PLACE ± ±							
	ANGULAR ± --- °	DRAFT WHERE APPLICABLE MUST REMAIN WITHIN DIMENSIONS	MATERIAL NO.	DOCUMENT NO.	SHEET NO.		
			SEE CHART	SDAE-3003-N*	4 OF 4		
			SIZE B	THIS DRAWING CONTAINS INFORMATION THAT IS PROPRIETARY TO MOLEX INCORPORATED AND SHOULD NOT BE USED WITHOUT WRITTEN PERMISSION			

9 8 7 6 5 4 3 2 1

X-ON Electronics

Largest Supplier of Electrical and Electronic Components

Click to view similar products for [I/O Connectors](#) category:

Click to view products by [Molex](#) manufacturer:

Other Similar products are found below :

[571763P](#) [58098-0628](#) [D38999/20FJ24PA L/C](#) [D38999/20FJ29SB L/C](#) [D38999/24FG11SN L/C](#) [72.250.1628.2](#) [72.250.2428.2](#) [74720-0505](#)
[747680210](#) [76.350.0729.0](#) [76871-1403](#) [FCN-244F080-G/1](#) [FCN-260A9920](#) [FCN-268D024-G/11](#) [FCN-268D024-G/2F#10X-R10](#) [MP-](#)
[5T180MUNNA-005](#) [MP-5XRJ45UNNB-003](#) [PCR-E36PM](#) [PCS-E50FA](#) [PCS-XE26LKA](#) [PCS-XE26MA+](#) [PCS-XES68MS+](#) [G38A71314B](#) [91-](#)
[569719-35R](#) [DX40-50P\(55\)](#) [1571250010](#) [157-22500-3](#) [MS3471L14-19P L/C](#) [MS3476W12-10S L/C](#) [171224-6031](#) [1888020-8](#) [91-569719-35P](#) [91-](#)
[569786-35H](#) [91-569786-35M](#) [91-644626-35P](#) [172501-4002](#) [172501-6002](#) [FCN-260C008-A/L0](#) [FCN-260C024-AL0](#) [FCN-261Z008](#) [FCN-264D024-](#)
[G2K](#) [FCN-268D008-G/1K](#) [2000314-1](#) [200331-1](#) [2007498-2](#) [PCR-E28LMDAG1+](#) [PCR-E36FC+](#) [PCS-E28FS+](#) [PCS-XE26SLFD+](#) [PCS-](#)
[XE26SLFDT+](#)