

NOTE 2

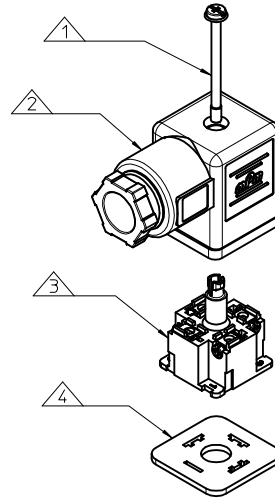

ITEM	DESCRIPTION
1	SCREW
2	COVER ASSEMBLY
3	INSERT ASSEMBLY
4	GASKET

C81311N62\*\*

SERIES \_\_\_\_\_  
 C81= INTERNAL THREAD FORM A  
 POLES \_\_\_\_\_  
 2= 2 POLE, 3= 3 POLE  
 THREAD SIZE \_\_\_\_\_  
 09= PG9 11=PG11, 12= 1/2" GAS, M6=M16x1.5, M0=M1201.5  
 MATERIAL AND HOUSING COLOUR \_\_\_\_\_  
 G= PA6 GRAY, N= PA6 BLACK, W= PA6 BLACK V0, T= TRANSPARENT  
 EARTH POSITION \_\_\_\_\_  
 0= UNMOUNTED, 2= H12, 3= H3, 6= H6, 9= H9

SCREW AND GASKET \_\_\_\_\_  
 1= NBR PROFILE GASKET & SCREW  
 2= NBR FLAT GASKET & SCREW  
 3= WHITE SILICON PROFILE GASKET & SCREW  
 4= WHITE SILICON FLAT GASKET & SCREW  
 R= INTEGRATED GASKET & SCREW WITH GROMMET, NOT ASSEMBLED  
 G= NO GASKET, STANDARD SCREW

NON STANDARD COMPONENTS \_\_\_\_\_  
 14= SINGLE PACKED IN NEUTRAL BAG

NOTES

- PLEASE SEE SHEET 2 FOR CURRENTLY CONFIGURED PART NUMBERS. FOR SPECIFIC PART NUMBERS PLEASE CONTACT SALES OR CONSULT THE INTELLIGENT PART NUMBERS IN THE TABLE ATTACHED.
- EARTH POSITION SHOWN, H6.
- FOR PACKAGING SEE PACKAGING SPEC PK-121023-C81
- PRODUCT SPEC: SEE PS-121201-001
- P/N 1210230637 SHOWN FOR ILLUSTRATION PURPOSES ONLY

LAST INSPECTION NUMBER 2

ADD P/N EC NO: IPG2015-1444 DRWN:POWNER 2015/02/18 CHKD:DMAHER 2015/02/26 APPR:STGERIEFIN 2015/03/05	DESCRIPTION REV	QUALITY SYMBOLS ▽=0 ▽=0		GENERAL TOLERANCES (UNLESS SPECIFIED) mm INCH 4 PLACES ± --- ± --- 3 PLACES ± --- ± --- 2 PLACES ± 0.10 ± --- 1 PLACE ± 0.20 ± --- ANGULAR ± 2 °		DIMENSION STYLE MM ONLY DRAWN BY DATE OSHEA 2011/05/23 CHECKED BY DATE DMAHER 2011/05/30 APPROVED BY DATE EFOLAN 2011/06/14		SCALE 1.5:1	DESIGN UNITS METRIC	THIRD ANGLE PROJECTION
		INTERNAL THREAD C81 SERIES								
		MOLEX MOLEX INCORPORATED								
		DRAFT WHERE APPLICABLE MUST REMAIN WITHIN DIMENSIONS SEE SHEET 2 THIS DRAWING CONTAINS INFORMATION THAT IS PROPRIETARY TO MOLEX INCORPORATED AND SHOULD NOT BE USED WITHOUT WRITTEN PERMISSION								

PART NO	mPm NO	DESCRIPTION
1210230618	C81211G21	TYPE A 2P PG11 GRAY, NBR PROFILE GASKET
1210230620	C81211N21	TYPE A 2P PG11 BLACK, NBR PROFILE GASKET
1210230633	C81311N21	TYPE A 3P PG11 BLACK, NBR PROFILE GASKET
1210230808	C81309N2R	TYPE A 3P PG9 BLACK, INTEGRATED NBR GASKET & IP67 SCREW NOT ASSEMBLED
1210230629	C81309N21	TYPE A 3P PG9 BLACK, NBR PROFILE GASKET
1210230627	C81309G21	TYPE A 3P PG9 GRAY, NBR PROFILE GASKET
1210230635	C81311N24	TYPE A 3P PG11 BLACK, WHITE SILICON FLAT GASKET
1210230694	C813M0N21	TYPE A 3P M20x1.5 BLACK, NBR PROFILE GASKET
1210230612	C81209N21	TYPE A 2P PG9 BLACK, NBR PROFILE GASKET
1210230616	C81209N62	TYPE A 2P PG9 BLACK, NBR FLAT GASKET
1210230707	C813M6N21	TYPE A 3P M16x1.5 BLACK, NBR PROFILE GASKET
1210230781	C81312N23	TYPE A 3P 1/2" GAS BLACK, WHITE SILICON PROFILE GASKET
1210230819	C81312N22	TYPE A 3P 1/2" GAS BLACK, NBR FLAT GASKET
1210230637	C81311N62	TYPE A 3P PG11 BLACK, NBR FLAT GASKET
1210230632	C81311G22	TYPE A 3P PG11 GRAY, NBR FLAT GASKET
1210230631	C81311G21	TYPE A 3P PG11 GRAY, NBR PROFILE GASKET
1210230630	C81309N22	TYPE A 3P PG9 BLACK, NBR FLAT GASKET
1210230687	C812M6N21	TYPE A 2P M16x1.5 BLACK, NBR PROFILE GASKET
1210230626	C81212N21	TYPE A 2P 1/2" GAS BLACK, NBR PROFILE GASKET
1210230624	C81211N62	TYPE A 2P PG11 BLACK, NBR FLAT GASKET
1210230623	C81211N24	TYPE A 2P PG11 BLACK, WHITE SILICON FLAT GASKET
1210230690	C81211N2114	TYPE A 2P PG11 BLACK, NBR PROFILE GASKET SINGLE BAGGED IN NEUTRAL BAG
1210230611	C81209G21	TYPE A 2P PG9 GRAY, NBR PROFILE GASKET
1210230622	C81211N23	TYPE A 2P PG11 BLACK, WHITE SILICON PROFILE GASKET
1210230836	C81309N24	TYPE A 3P PG9 BLACK, WHITE SILICON FLAT GASKET
1210230659	C81209T21	TYPE A 2P PG9 TRANSPARENT, NBR PROFILE GASKET
1210230634	C81311N22	TYPE A 3P PG11 BLACK, NBR FLAT GASKET
1210230860	C81309N2G	TYPE A 3P PG9 BLACK, NO GASKET, STANDARD SCREW
1210230871	C81309W21SA	TYPE A 3P PG9 BLACK, NBR FLAT GASKET & SCREW

<b>SEE SHEET 1</b> EC NO: IFC2015-1444 DRAWN BY: POWNER 2015/02/18 CHKD: DMAHER 2015/02/26 APPR: SUGRIFIN 2015/03/05	DESCRIPTION H	<b>QUALITY SYMBOLS</b> ▽=0 ▽=0	<b>GENERAL TOLERANCES (UNLESS SPECIFIED)</b> <table border="1"> <thead> <tr> <th></th> <th>mm</th> <th>INCH</th> </tr> </thead> <tbody> <tr><td>4 PLACES</td><td>± .005</td><td>± .0004</td></tr> <tr><td>3 PLACES</td><td>± .008</td><td>± .0003</td></tr> <tr><td>2 PLACES</td><td>± 0.10</td><td>± .004</td></tr> <tr><td>1 PLACE</td><td>± 0.20</td><td>± .008</td></tr> </tbody> </table>		mm	INCH	4 PLACES	± .005	± .0004	3 PLACES	± .008	± .0003	2 PLACES	± 0.10	± .004	1 PLACE	± 0.20	± .008	<b>DIMENSION STYLE</b> <b>MM ONLY</b>	<b>SCALE</b> <b>2:1</b>	<b>DESIGN UNITS</b> <b>METRIC</b>	<b>THIRD ANGLE PROJECTION</b>
			mm	INCH																		
		4 PLACES	± .005	± .0004																		
		3 PLACES	± .008	± .0003																		
2 PLACES	± 0.10	± .004																				
1 PLACE	± 0.20	± .008																				
<b>DRAWN BY</b> OSHEA <b>DATE</b> 2011/05/23 <b>CHECKED BY</b> DMAHER <b>DATE</b> 2011/05/30			<b>TITLE</b> <b>INTERNAL THREAD C81 SERIES</b>																			
<b>APPROVED BY</b> EFOLAN <b>DATE</b> 2011/06/14																						
<b>DRAFT WHERE APPLICABLE MUST REMAIN WITHIN DIMENSIONS</b>			<b>MATERIAL NO.</b> SEE TABLE		<b>DOCUMENT NO.</b> SD-121023-008		<b>SHEET NO.</b> 2 OF 2															
<b>THIS DRAWING CONTAINS INFORMATION THAT IS PROPRIETARY TO MOLEX INCORPORATED AND SHOULD NOT BE USED WITHOUT WRITTEN PERMISSION</b>																						

# X-ON Electronics

Largest Supplier of Electrical and Electronic Components

*Click to view similar products for [Heavy Duty Power Connectors](#) category:*

*Click to view products by [Molex](#) manufacturer:*

Other Similar products are found below :

[1424439](#) [1424438](#) [09330062652](#) [2-8675P1](#) [580129-2](#) [605601-1](#) [6340G1](#) [6341G1](#) [6360G1](#) [6373G1](#) [6374g2](#) [6396G1](#) [647757-1](#) [66394-4](#) [6643411-1](#)  
[6646058-2](#) [6646137-1](#) [6646138-1](#) [6646348-1](#) [6646479-1](#) [6646608-1](#) [6646786-1](#) [6651091-1](#) [6651525-1](#) [6651529-1](#) [6651778-1](#) [6651788-1](#) [696465-](#)  
[1](#) [696475-1](#) [73000005059](#) [73000005326](#) [73000005349](#) [73080255059](#) [73080965046](#) [765-15-0080A](#) [765-16-0080B](#) [789.700-44](#) [789.700-54](#) [80-1010](#)  
[80-9](#) [827381-1](#) [829992-1](#) [902-77-02113](#) [PL00U-301-10D10](#) [PL00V-301-10D10](#) [PM103MOOLOO](#) [PM16S1620S32-50](#) [PM206MRALHB](#)  
[PM212MOOLOO](#) [PM309FOOLOO](#)