

7 6 5 4 3 2 1

REVISIONS				
EC NO	DATE	REV	DESCRIPTION	CHANGER
	14.04.30	A	INITIAL RELEASE.	Andrew

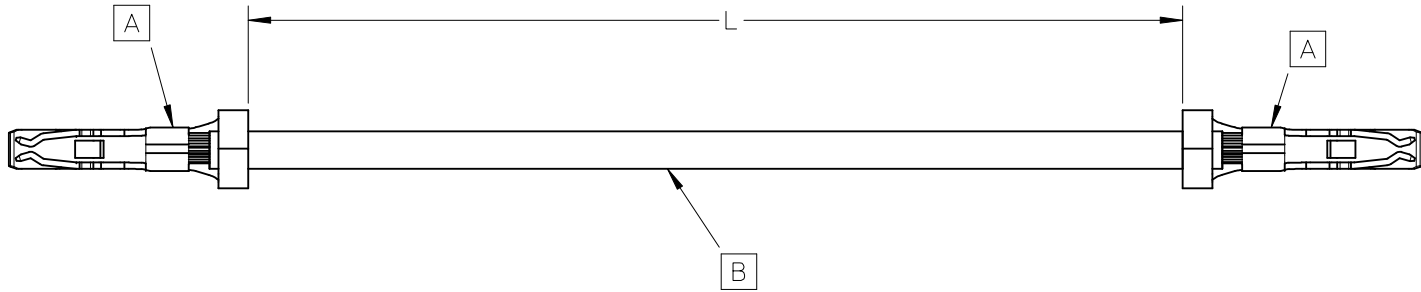

MATERIAL NO.	DESCRIPTION.	L (mm)
688015298	5040520098 - AWG24 - 5040520098 L150mm	150±5
688015299	5040520098 - AWG24 - 5040520098 L300mm	300±5

B	24AWG;PLATED;PVC,BK,OD=1.10MM;UL1061	A/R	
A	TERMINAL 24-28AWG 5040520098		2
ITEM	DESCRIPTION	L(MM)	Q'TY

NOTES
 1. THIS PRODUCT MUST MEET 2011/65/EU ROHS COMPLIANCE.

EC NO: CPG2014-3409 DRWN: JXIA004 CHKD: YXZOU APPR: FNIE	2014/05/10 2014/05/10 2014/05/12	DESCRIPTION REV	QUALITY SYMBOLS	GENERAL TOLERANCES (UNLESS SPECIFIED)	DIMENSION STYLE	SCALE	DESIGN UNITS	THIRD ANGLE PROJECTION																		
			$\nabla_F = 0$ $\nabla_{F'} = 0$ $\nabla_{F''} = 0$	<table border="1"> <thead> <tr> <th></th> <th>mm</th> <th>INCH</th> </tr> </thead> <tbody> <tr> <td>4 PLACES</td> <td>± ---</td> <td>± ---</td> </tr> <tr> <td>3 PLACES</td> <td>± ---</td> <td>± ---</td> </tr> <tr> <td>2 PLACES</td> <td>± ---</td> <td>± ---</td> </tr> <tr> <td>1 PLACE</td> <td>± ---</td> <td>± ---</td> </tr> <tr> <td>0 PLACE</td> <td>± ---</td> <td>± ---</td> </tr> </tbody> </table>		mm	INCH		4 PLACES	± ---	± ---	3 PLACES	± ---	± ---	2 PLACES	± ---	± ---	1 PLACE	± ---	± ---	0 PLACE	± ---	± ---	MM ONLY	---	METRIC
				mm	INCH																					
			4 PLACES	± ---	± ---																					
3 PLACES	± ---	± ---																								
2 PLACES	± ---	± ---																								
1 PLACE	± ---	± ---																								
0 PLACE	± ---	± ---																								
	<table border="1"> <thead> <tr> <th>DRAWN BY</th> <th>DATE</th> <th>TITLE</th> </tr> </thead> <tbody> <tr> <td>JXIA004</td> <td>2014/05/10</td> <td>SEE TABLE 1</td> </tr> <tr> <th>CHECKED BY</th> <th>DATE</th> <td></td> </tr> <tr> <td>YXZOU</td> <td>2014/05/10</td> <td></td> </tr> <tr> <th>APPROVED BY</th> <th>DATE</th> <td></td> </tr> <tr> <td>FNIE</td> <td>2014/05/12</td> <td></td> </tr> </tbody> </table>	DRAWN BY	DATE	TITLE	JXIA004	2014/05/10	SEE TABLE 1	CHECKED BY	DATE		YXZOU	2014/05/10		APPROVED BY	DATE		FNIE	2014/05/12								
DRAWN BY	DATE	TITLE																								
JXIA004	2014/05/10	SEE TABLE 1																								
CHECKED BY	DATE																									
YXZOU	2014/05/10																									
APPROVED BY	DATE																									
FNIE	2014/05/12																									
A			ANGULAR ± ---°	MATERIAL NO.	DOCUMENT NO.	SHEET NO.																				
			DRAFT WHERE APPLICABLE MUST REMAIN WITHIN DIMENSIONS	SEE TABLE 1	SD-68801-151	1 OF 1																				
				SIZE A 4	THIS DRAWING CONTAINS INFORMATION THAT IS PROPRIETARY TO MOLEX INCORPORATED AND SHOULD NOT BE USED WITHOUT WRITTEN PERMISSION																					

6 5 4 3 2 1

X-ON Electronics

Largest Supplier of Electrical and Electronic Components

Click to view similar products for [Specialized Cables](#) category:

Click to view products by [Molex](#) manufacturer:

Other Similar products are found below :

[585P5S5S](#) [603PT6](#) [603SS6L](#) [604PT6](#) [604SS6](#) [654PT2](#) [654ST2](#) [M83513/04-H02C](#) [M83513/04-H13C](#) [FFA.3S.787.CN](#) [84914-0235](#) [84914-0237](#) [1200650264](#) [1200650355](#) [1200650362](#) [1200650442](#) [1200650880](#) [1200650968](#) [1200651246](#) [1200651756](#) [1200680096](#) [1200690050](#)
[1200690242](#) [1200700176](#) [1200700218](#) [120070-0224](#) [1200700267](#) [1200730360](#) [120115-0033](#) [1201150044](#) [1200650368](#) [1200651330](#)
[1200651454](#) [1200651516](#) [1200651571](#) [1200651580](#) [1200651601](#) [1200652122](#) [1200680196](#) [1200690085](#) [1200690095](#) [1200690153](#)
[1200700177](#) [1200700187](#) [1200700190](#) [1200700208](#) [1200730278](#) [1200740059](#) [AC172](#) [R7A-CCA002P2](#)