

dimensions 4.8 x 5.8 x 29.5
 T-groove sensor surface middle area

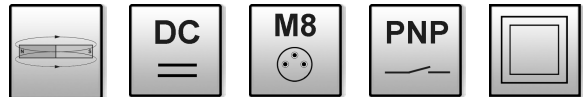

- ✓ insertible from above
- ✓ plastic-housing
- ✓ LED-display
- ✓ short-circuit and reverse polarity protection
- ✓ degree of protection IP67

**wear-free cylinder switch
 plastic housing**



article-no..	MZ072188
connection	0.5m M8-cable connector, PUR
Technical Data	
sensor surface	middle area
output signal	pnp, NO
operating voltage	10 ... 30V DC
current consumption (w/o load)	≤ 8mA
output current (max. load)	≤ 100mA
voltage drop (max. load)	≤ 2.0V DC
response sensitivity typ.	3mT
travel path typ.	10mm
hysteresis typ.	1mm
repeat accuracy typ. ¹⁾	0.1mm
switching frequency	≤ 1kHz
display (signal)	LED yellow
short-circuit protected	+
reverse polarity protected	+
material (housing)	plastic
dimensions	4.8 x 5.8 x 29.5
temperature (operating)	-30 ... +80 °C
degree of protection (EN 60529)	IP67
connection	M8-cable connector, 3-pin, rotatable thread
connection accessories	e.g. VK200075

¹⁾ constant operating voltage and temperature

connection

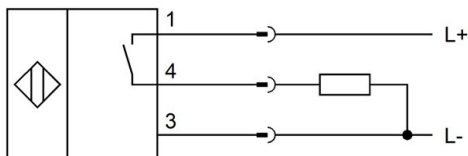

colors: 1 = BN (brown), 3 = BU (blue), 4 = BK (black)
 functions: 1 = L+, 3 = L-, 4 = PNP NO

dimensional drawing

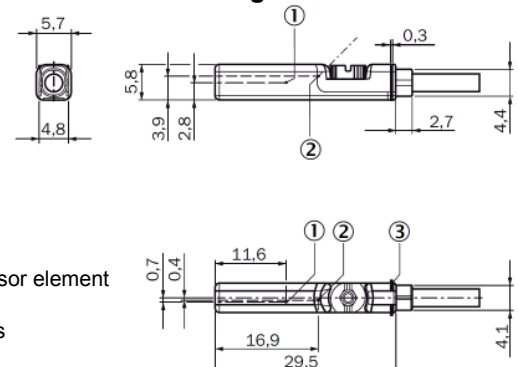

1. position sensor element
2. LED-display
3. retaining ribs

Warning: Never use these devices in applications where the safety of a person depends on their functionality.

X-ON Electronics

Largest Supplier of Electrical and Electronic Components

Click to view similar products for [Board Mount Hall Effect/Magnetic Sensors](#) category:

Click to view products by [IPF ELECTRONIC](#) manufacturer:

Other Similar products are found below :

[ACHS-7194-500E](#) [ACHS-7193-500E](#) [ACHS-7193-000E](#) [ACHS-7194-000E](#) [G-MRCO-017](#) [A1104LUA-T](#) [A1212LUA-T](#) [HGPRDT005A](#)
[AH1808-P-A](#) [AH277AZ4-AG1](#) [AH373-WG-7](#) [AV-10379](#) [AV-10448](#) [A1211LUA-T](#) [SS41C](#) [AH1803-WG-7](#) [AH1806-P-B](#) [AH1894-Z-7](#)
[MA700GQ-P](#) [ATS601LSGTN-HT-WU4-T](#) [ATS601LSGTN-LT-WU4-T](#) [TLE4917](#) [TLE4946-1L](#) [50017859-003](#) [TY-13101](#) [TLE4976L](#)
[AH1751-WG-7-A](#) [SS85CA](#) [BU52002GUL-E2](#) [MAX13366GTE/V+](#) [A1128LUA-T](#) [AH173-WG-7-B](#) [MA702GQ-P](#) [BU52003GUL-E2](#)
[AH277AZ4-BG1](#) [TLE49614MXTSA1](#) [AH3376-P-B](#) [TLE4941](#) [AH3382-P-B](#) [AH3372-W-7](#) [AH9250-W-7](#) [AH211Z4-AG1](#) [AH9251-W-7](#)
[TLE4905L](#) [AH3373-W-7](#) [AH3377-W-7](#) [AH3360-FT4-7](#) [AH3376-W-7](#) [TLE4961-3M](#) [AS5601-ASOT](#)