

NSYSFPSC60

Post fixing device WM Spacial, length 600. For post max 675. Max. Load:100kg.

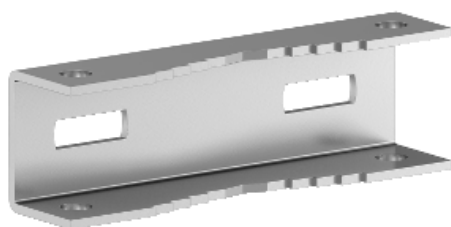

Price* : 54.82 GBP



Main

Range	Spacial
Accessory / separate part category	Fixing accessory
Product or component type	Post fixing device
Application	Multi-purpose
For enclosure nominal dimensions	-
Mounting location	Rear of enclosure
Range compatibility	Spacial CRN Spacial S3D Spacial SBM
Device composition	2 x support rail 2 x strip Fixing elements
Quantity per set	Set of 1

Complementary

Material	Galvanised steel
Fixing mode	Minimum diameter 150 mm Maximum diameter 215 mm By fixing element - screw type M8 - to the inserts in the rear of the enclosure location
Permanent permissible load	100 kg
Height	45 mm
Width	595 mm
Depth	32.5 mm
Product weight	3.2 kg

Offer Sustainability

Sustainable offer status	Green Premium product
RoHS (date code: YYWW)	Compliant - since 0940 - Schneider Electric declaration of conformity

 [Schneider Electric declaration of conformity](#)

REACH	Reference not containing SVHC above the threshold Reference not containing SVHC above the threshold
Product environmental profile	Available  Product Environmental Profile
Product end of life instructions	Need no specific recycling operations

Contractual warranty

Warranty period	18 months
-----------------	-----------

X-ON Electronics

Largest Supplier of Electrical and Electronic Components

Click to view similar products for [Electrical Enclosures](#) category:

Click to view products by [Schneider](#) manufacturer:

Other Similar products are found below :

[120-902](#) [120-905](#) [120-403](#) [120-475](#) [120-901](#) [127-410](#) [130-504](#) [130-506](#) [MR-25L+](#) [30-8739](#) [PIP-11774SCREW](#) [30-9715](#) [MR-25LW+](#) [110-407](#) [111-004](#) [111-008](#) [110-402](#) [110-901](#) [110-907](#) [111-002](#) [110-406](#) [110-910](#) [110-404](#) [110-409](#) [110-410](#) [120-405](#) [106-009](#) [106-505](#) [105-401](#) [106-006](#) [104-406](#) [137-002](#) [105-405](#) [111-005](#) [127-909](#) [106-502](#) [130-475](#) [130-503](#) [127-401](#) [106-010](#) [127-455](#) [127-475](#) [110-903](#) [R260-180-300](#) [9511020](#) [9822029](#) [9820014](#) [P61603000P](#) [9823009](#) [R103-164-000](#)