



**Heavy Duty Mounting
Clamp 11mm**

Heavy Duty Mounting Clamp

Imatronic's Heavy Duty Mounting Clamp has parallel and vertical adjustment which allows the user to aim the laser in any required direction or angle, the robust aluminium construction also assists in conducting heat away from the laser body as well as prevents movement due to shock and vibration. The base plate of the Heavy duty clamp has a series of threaded holes to allow the Heavy Duty Clamp to be securely fastened to stable surface.

The Heavy Duty Mounting Clamp will fit a wide range of Imatronic products. Below is a list of the products and part numbers

Imatronic Part Number	Farnell Part Number	Description
5002-45-000	2065351	Versatile Module 635nm 1mW TTL
5002-46-000	2065352	Versatile Module 635nm 3mW TTL
5002-47-000	2065353	Versatile Module 650nm 1mW TTL
5002-48-000	2065354	Versatile Module 650nm 3mW TTL
3115-28-000	1216294	LDM115G/633/1
3115-29-000	1216313	LDM115G/633/5
3115-26-000	1216290	LDM115G/670/1
3115-27-000	1216291	LDM115G/670/3
3115-52-000	1216308	LDM115P/635/1
3115-51-000	1216307	LDM115P/650/1

Product Operation

Mounting the laser diode module in the Heavy Duty Clamp

1. Un-tighten Allen screw A (see drawing A) with the supplied Allen key.
2. Slide the laser into the mounting hole (see drawing A) and tighten Allen key A.
3. For vertical adjustment of the laser un-tighten Grub screw A (see drawing A). This will allow the section mounting the laser to be adjusted. When the vertical posting is complete re-tighten grub screw A.
4. For horizontal adjustment of the laser un-tighten Grub screw B (see drawing A). This will allow the main body of the mount to be moved. When the horizontal positing is complete re-tighten grub screw B.
5. To secure the Heavy Duty Clamp to a surface screws, machine screw or studs can be used in conjunction with the base section (see drawing A for thread details)

A) Small Mounting Clamp (For 11mm Laser Diode Modules)

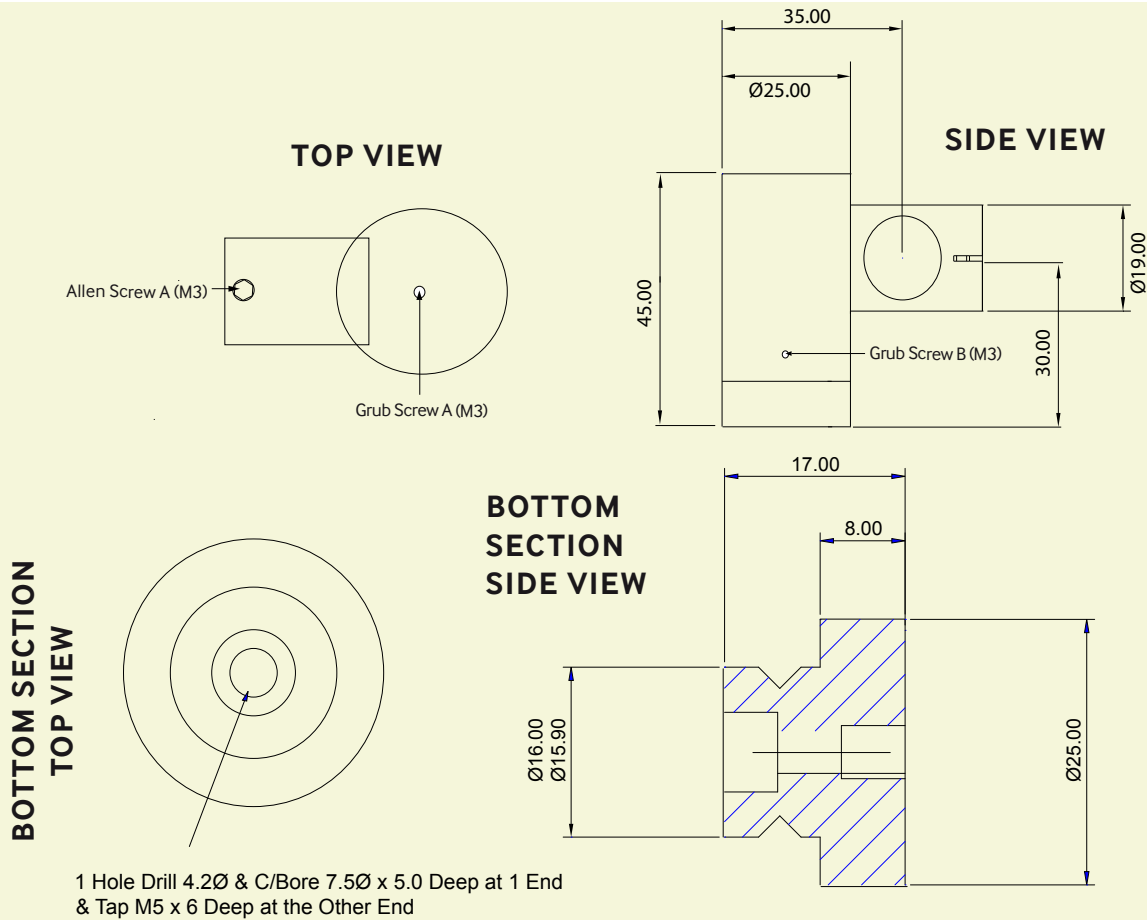

Drawings Not To Scale

Please Note: Imatronic reserve the right to change descriptions and specifications without notice



ISO9001 Certified



For further information about any of our products please contact your local distributor or you can contact Global Laser in the UK. Your Local Distributor Is:

T: +44 (0)1495 212213
 F: +44 (0)1495 214004
 E: sales@globallasertech.com
 www.globallasertech.com

Global Laser Ltd, Cwmtillery Industrial Estate
 Abertillery, Gwent NP13 1LZ UK

X-ON Electronics

Largest Supplier of Electrical and Electronic Components

Click to view similar products for [Imatronic](#) manufacturer:

Other Similar products are found below :

[LGO115/40](#) [1997-03-000](#) [LDM115P/650/1](#) [5002-48-000](#) [1266-03-000](#) [1125-227-000](#)