

FUSE BLOCK

Electric Parts

R3-100-11-4110 *Wiring / Blade Fuse*

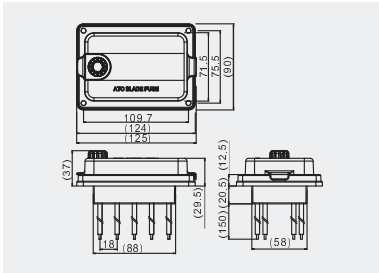

WIRE	32V DC max Output: 20A max per circuit
FUSE	BLADE FUSE

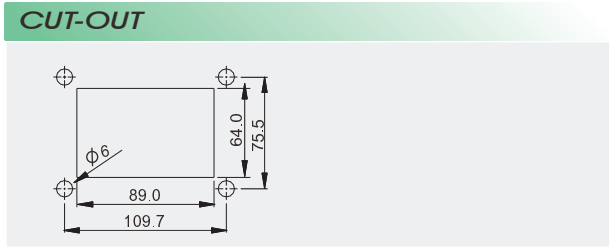

FEATURES:

- Material:
Base: PBT (UL flame: 94V-0).
Cap: PC (UL flame: 94V-2).
- Output terminal rating: wire size #12 AWG.
- Connection wire option available.
- Identify circuits by foot print marking.
- Insulating cover design for dust proof.
- Easy to open by pressing the latch.

R3-101 *Stackable Relay Block*

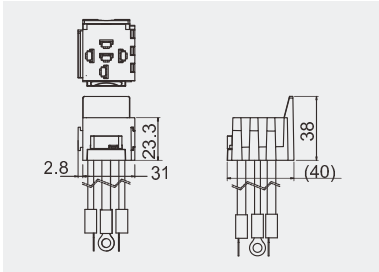

	12V/24V DC
--	------------

FEATURES:

- Material:
Frame: nylon with glass fiber.

RELAY DIM

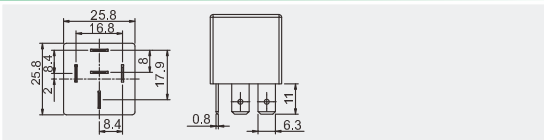

***This Relay Block could string array.**

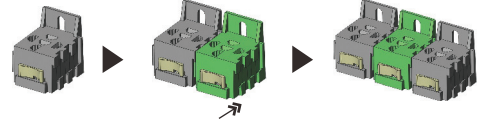

R3-103 *Automotive bolt-in fuse holder | MEGA Fuse*

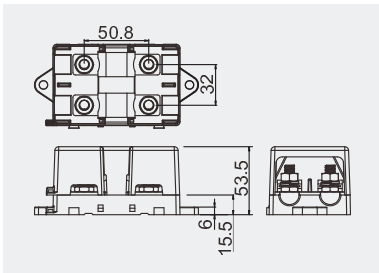

	32V DC, 40A~400A (max.)
FUSE	MEGA FUSE

FEATURES:

- Material:
Cover: PBT.
Housing: nylon.
Screw: Ni plated steel studs.
- M8 threaded studs and hex nut for fuse mounting.
- Torque rating: 20in-lb (2.25 Nm) max.
- Mounting torque rating: 12-18Nm max. M8 screws with washers.

CUT-OUT

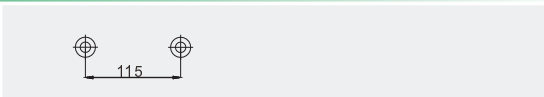

X-ON Electronics

Largest Supplier of Electrical and Electronic Components

Click to view similar products for [Fuse Holder](#) category:

Click to view products by [SCI manufacturer](#):

Other Similar products are found below :

[570-290-741P40](#) [570-290-751P40](#) [0031.1351.01](#) [020417G](#) [020418E](#) [80910030](#) [8601.2020](#) [9-3557-GP REV A](#) [15600-08-10](#) [BK1-HTC-45M](#)
[BK/FHN19G](#) [BK/HJM-HH](#) [BK/HKP-CCHH](#) [BK/HKP-E-CC](#) [BK/HKP-E-HH](#) [BK/HKP-EH-HH](#) [BK/HKP-U-HH](#) [BK/HTJ-LES-FUSE](#)
[HMG-241](#) [2086-1](#) [2193](#) [RTMF-SC](#) [2602](#) [2650](#) [FHN31G1](#) [G4PB8](#) [2660](#) [2799](#) [CQ-209V](#) [345621A](#) [3794](#) [4202](#) [4408](#) [4413](#) [4423](#) [4482](#)
[4532](#) [4537](#) [TSD1404-12](#) [BK/FHN31G1](#) [BK/HKP-H-CC](#) [BK/HKP-JQ-BB](#) [BK/HKP-JQW-BB](#) [BK/HKP-N-HH](#) [BK/HKP-S-CC](#) [BK/HKP-W-](#)
[BBHH](#) [BP/HHS](#) [BPHHU](#) [55900008011](#) [C1933](#)