

FUSE BLOCK

Electric Parts

R3-76B-01-3 1 LED Warning Light / Negative busbar / Blade Fuse

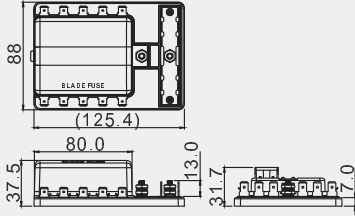

INDICATOR LIGHT

With LED

W/O LED

POSITIONS

CUT-OUT

0 4

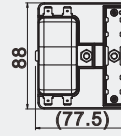

0 6

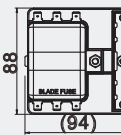

1 0

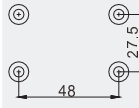
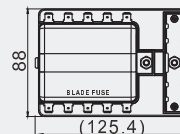

(6.4mm)0.250" Quick connect

Input: 100 A max
Output: 30A max per circuit

FUSE

BLADE FUSE

FEATURES:

- Material:
Base: PBT (UL flame: 94V-0).
Cap: PC (UL flame: 94V-2).
Terminal: tin plated copper.
- Input terminal rating: #10-32 threaded studs (100A. max.)
- Output terminal rating: 30A max per circuit.
- Connection pad option available.
- Input wire size: #4-6 AWG.
- Output wire size: #12-16 AWG.
- Torque rating: 20in-lb (2.25 Nm) max.
- Mounting torque rating: 8in-lb (0.9Nm) max.
- Red LED indicates when fuse is broken.
- Identify circuits by foot print marking.
- Negative bus provides common location for negative collection circuit.
- Clear insulating cover design for water and dust proof.
- Easy to open by pressing the latch.

R3-76D- -3 1 Single Side Design / Blade Fuse

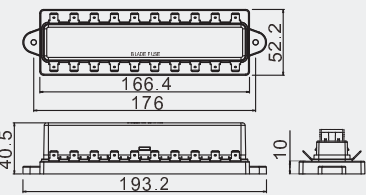

TERMINAL

0 1
(6.4mm)0.250" Quick connect

0 7 SC 4
(M4 Screws)

POSITIONS

CUT-OUT

0 4

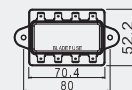

0 6

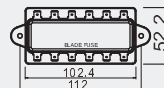

1 0



32V DC
Output: 30A max per circuit

FUSE

BLADE FUSE

FEATURES:

- Material:
Base: PBT (UL flame: 94V-0).
Cap: PC (UL flame: 94V-2).
Terminal: tin plated copper.
- Output terminal rating: 30A max per circuit.
- Terminal wire size: #10 AWG.
- Fuse insertion rating: 17Lb (76N) max.
- Fuse withdrawal forces rating: 17Lb (76N) max.
- Identify circuits by foot print marking.
- Single side design for easy wire entry.
- Clear insulating cover design for water and dust proof.
- Easy to open by pressing the latch.

X-ON Electronics

Largest Supplier of Electrical and Electronic Components

Click to view similar products for [Fuse Holder](#) category:

Click to view products by [SCI manufacturer](#):

Other Similar products are found below :

[570-290-741P40](#) [570-290-751P40](#) [0031.1351.01](#) [020417G](#) [020418E](#) [80910030](#) [8601.2020](#) [9-3557-GP REV A](#) [15600-08-10](#) [BK1-HTC-45M](#)
[BK/FHN19G](#) [BK/HJM-HH](#) [BK/HKP-CCHH](#) [BK/HKP-E-CC](#) [BK/HKP-E-HH](#) [BK/HKP-EH-HH](#) [BK/HKP-U-HH](#) [BK/HTJ-LES-FUSE](#)
[HMG-241](#) [2086-1](#) [2193](#) [RTMF-SC](#) [2602](#) [2650](#) [FHN31G1](#) [G4PB8](#) [2660](#) [2799](#) [CQ-209V](#) [345621A](#) [3794](#) [4202](#) [4408](#) [4413](#) [4423](#) [4482](#)
[4532](#) [4537](#) [TSD1404-12](#) [BK/FHN31G1](#) [BK/HKP-H-CC](#) [BK/HKP-JQ-BB](#) [BK/HKP-JQW-BB](#) [BK/HKP-N-HH](#) [BK/HKP-S-CC](#) [BK/HKP-W-](#)
[BBHH](#) [BP/HHS](#) [BPHHU](#) [55900008011](#) [C1933](#)