

a) Supplied profile.

b) Recovered profile.



MATERIAL;

Section: Heat-shrinkable, thermally stabilised, irradiated, flame retarded Polyolefin.

Adhesive: Raychem hot-melt adhesive S1112

Properties to conform to Raychem Specification RK6029

DIMENSIONS (in millimetres)

PART No.	A	B	C	D	E
	MAX b	MIN b	MIN b	MIN a	TYP b
Nr.6	0.6	0.5	3.5	0.8	1.25
Nr.7	1.0	0.9	4.8	1.6	1.25
Nr.8	2.0	0.9	6.6	2.5	2.25
Nr.9	4.2	0.9	13.5	4.5	2.20
Nr.11	1.5	0.8	4.9	1.6	1.35

NOTE.

- 1) Standard supplied length is 1.2 metres.
- 2) Standard colour is black.

Copyright (!)

The copyright in this drawing is the property of Tyco Electronics UK Ltd. The drawing is issued on the condition that it is not copied, reproduced or disclosed to a third party, either in whole or in part without the prior written consent of Tyco Electronics UK Ltd.

Drawn A.LILLEY. Checked Issue 13 Date December 1995 Conforms to ISO Recommendations

3rd Angle Projection  
Not to Scale

Approval  
Design

MKTG.

Q.A.

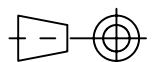

<b>Raychem</b>		<b>Specification Control Drawing</b>	Part Number  TPEM Issue 13
Iss.	Date	E.C.R. No.	Details of Change
2	January 1986	4946/7	Dim Changed
3	January 1986	4993/4	Dim Changed
4	January 1986		Dim Changed
5	December 1986	4957	Coat Machine
6	June 1987	5094	Conform to RK
7	February 1998	5246	Change D dim
8	August 1988	5334	Size 11 added
9	July 1991	T0067	Bought in Line with UKMS
10	March 1992	T0112	NR9 D dim was 4mm
11	June 1993	T0208	NR9 D dim was 7mm
12	April 1995	T0416	NR& also in White note added
13	December 1995	T0427	Bought in Line with Data sheet & UKMS

Tyco Electronics UK Ltd. Faraday Road, Swindon, Wiltshire, SN3 5HH England Telephone: (01793) 528171 Fax: 572516	Tyco Electronics Corporation 300, Constitution Drive, Menlo Park, CA 94025 USA Telephone (650) 361-3860 Fax: (650) 361-5579
Cage Code K1010	Cage Code 06090

## X-ON Electronics

Largest Supplier of Electrical and Electronic Components

*Click to view similar products for* [Enclosures, Boxes, & Cases](#) *category:*

*Click to view products by* [TE Connectivity](#) *manufacturer:*

Other Similar products are found below :

[CR-425 PAINTED](#) [585-R-WH-PK](#) [M-10-PLATED](#) [60221-01](#) [60566-01-000](#) [HPL-9VB BATT DOOR](#) [M-16-LID-PLATED](#) [M18-PLTD](#) [M-21-LID-PLATED](#) [M-21-PLATED](#) [M-23-PLATED](#) [CU-281-MB](#) [6711GSKT](#) [71884-29-028](#) [LH45-100 Black](#) [7200B](#) [72868-510-000](#) [CNS-0000 Black](#) [72883-510-000](#) [CNS-0101 Black](#) [72906-510-000](#) [CNS-0407 Black](#) [73091-510-000](#) [CNM-0000-BLACK Kit](#) [73092-510-000](#) [CNM-0101 Black](#) [73108-510-000](#) [CNL-0303 Black](#) [73395-510-039](#) [CNS-0006 Bone](#) [74257-510-000](#) [CNL-0004](#) [MDC-1183-PLAIN-ALUM](#) [MDC-1183-PTD](#) [MDC-13104-PLAIN-ALUM](#) [MDC-211 - PAINTED IVORY/BEIGE](#) [MDC-321-PTD](#) [MDC-432-PLAIN-ALUM](#) [MDC-973-PTD](#) [76](#) [77153-01-028](#) [FLX6030](#) [83535-01-508](#) [PS-11296-G](#) [PS-11298-B](#) [116-508](#) [120-407](#) [120-412](#) [120-909](#) [120-455](#) [R272-100-000](#) [120-910](#) [R501-001-010](#) [R508-080-000](#) [R508-160-000](#) [R530-120-000](#) [R530-122-000](#) [R530-200-000](#) [R531-160-000](#) [R531-200-000](#) [R582-080-100](#)