

ACCESSORIES

Locking Screws with Plastic Knobs



- Threads:**
- UNC 4-40
 - M2.5
 - M3.0
 - M2.6 on request

Pic.	Order Code:	Name:	Thread	/ Length
1	6718-0101-05	Jackscrew	UNC 4-40	/ 56mm
2	6718-0101-01	Jackscrew	UNC 4-40	/ 51mm
2	6718-0101-02	Jackscrew	M 2.5	/ 51mm
2	6718-0101-03	Jackscrew	M 3	/ 51mm
3	6718-0101-04	Jackscrew	UNC 4-40	/ 41mm
4	6718-0102-01	Jackscrew	UNC 4-40	/ 51mm
4	6718-0102-02	Jackscrew	M 2.5	/ 51mm
4	6718-0102-03	Jackscrew	M 3	/ 51mm
5	6718-0102-04	Jackscrew	UNC 4-40	/ 41mm

Standard Thread Length is 4,5mm.
Other colours on knobs are available upon request.

Locking Screws, Full Metal



- Threads:**
- UNC 4-40
 - M2.5, M2.6 and M3 on request

Pic.	Order Code:	Name:	Thread	/ Length
1	6826-0141-02	Blank JS	UNC 4-40	/ 47mm
2	6826-0141-01	Blank JS	UNC 4-40	/ 31,5mm
3	6826-0142-02	Black Chr. JS	UNC 4-40	/ 47mm
4	6826-0142-03	Black Chr. JS	UNC 4-40	/ 31,5mm
5	6826-0133-01	JS-DSSK	UNC 4-40	/ 18,1mm
6	6826-0133-04	JS-DSSK	UNC 4-40	/ 12,1mm
7	6826-0133-11	JS-DSSK-BK	UNC 4-40	/ 18,1mm
8	6826-0133-14	JS-DSSK-BK	UNC 4-40	/ 12,1mm

Female Screw Kit



Female Screw Kit:

Useful when two cable connectors should be mated together.
(Hex extender + Jackscrew with slot in one part)

Kit consist of:

- 2 pcs of Slotted Jackscrew
- 2 pcs of Hex Extender
- 2 pcs of Washer

Order Code:	Name:
6250-0112-02	Female Screw Kit

Female & Male Screw Locks

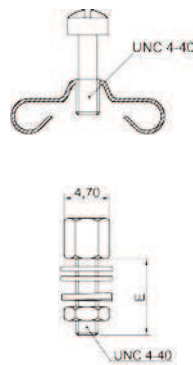

Male Screw Lock:

Order Code:	Name:
2750-0100-01	MH-MSL

Female Screw Lock:

Order Code:	Name:	(E)
2751-0111-01	DJF-5	5mm
2751-0111-02	DJF-7	7mm
2751-0111-03	DJF-8	8mm
2751-0111-04	DJF-10	10mm
2751-0111-05	DJF-14	14mm

Hex Extenders

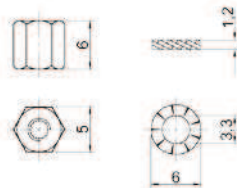

HEX-Extender:

Thread: UNC 4-40
Length: 6 mm

Order Code:	Name:	Note:
6250-0112-01	MHCA0270	With Washer
6857-0104-01	HEX-Extender	Without Washer

X-ON Electronics

Largest Supplier of Electrical and Electronic Components

Click to view similar products for [MH Connectors](#) manufacturer:

Other Similar products are found below :

[MHDCMR37-ULP](#) [MHDRB-MC](#) [MHCCOV-25MEL](#) [MHDPPK25-LG-K](#) [MHCCOV-25SC-BK](#) [BNCL1.0MRG58](#) [MHDTZK15-RA-K](#)
[DCMR09-RA-K](#) [RJ45SRB-RET-P](#) [MHTRI-M-37-K](#) [T-JS](#) [RJ45SRB-RET-O](#) [BNCL2.0MRG58](#) [DSSKP25L-DB25S-K](#) [MHD45ZK15-BK-K](#)
[MHDC09S](#) [MHTRI-P-15-K](#) [MHTRI-M-9-K](#) [RG59/62SRB-B](#) [MHCCOV-15SC-LG](#) [MHRJ116P4CR](#) [MHCCOV-25SC-MP](#) [DSSKM15L-](#)
[DB15S-K](#) [DSSKM25L-DB25S-K](#) [RJ45SRB-RET-Y](#) [MHDPPK-M-37-K](#) [T-JS-M2.5](#) [MHCCOV-25SC-LG](#) [MHRJ45SRI-BK](#) [MHDTZI-37-K](#)
[MHDA25-PMJ6-K](#) [DA9-SMJ8-R-K](#) [CCOV-37SC-BLACK](#) [MHDTZK25-RA-HI-K](#) [MHDA25-SMJ8-K](#) [MHCCOV-9SC-MP](#) [DJF-14](#)
[MHDM37SP](#) [DA9-PMJ8-B-K](#) [DA25-PMJ8-M-K-RC](#) [MHD45ZK9-DM9P-K](#) [GA0909FFLGK-RC](#) [MHDD9F-T-B-S-RBM](#) [MHCCOV-](#)
[25SCL-LG](#) [T-JS-M3.0](#) [MHD45ZK25-K](#) [MHDTPPK37-K](#) [MHCCOV-25ME](#) [C88E210000](#) [MHDVSL15-K](#)