

TECHNICAL DATA:

Configuration

Dome nut	Polyamide PA6
Dust cap	Polyethylene PE-LD, colours *white or **green
Sealing ring/outer part	Silicone rubber VMQ
Sealing ring/inner part	TPE TPS (from M16x1,5)
Gland body	Polyamide PA6
Connecting thread	metric, as per EN 60423

Properties

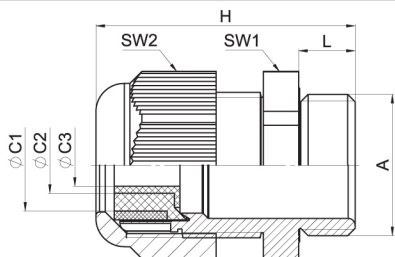

- wide sealing and clamping range
- easy-to-install

Group (Zone)	II 2 G (1,2)	II 2 D (21,22)
Marking	Ex e IIC Gb	Ex tb IIIC Db
Cable installation	fixed	
Temperature range	see table Characteristics, assigned to Part. No.	
Protection grade	IP66	
Test standard	EN 60079-0:2012, IEC 60079-0:2011 EN 60079-7:2007, IEC 60079-7:2006 EN 60079-31:2009, IEC 60079-31:2008	
EC-Type certificate	PTB 99 ATEX 3101 X (M12x1,5 - M16x1,5) PTB 99 ATEX 3128 X (M20x1,5 - M63x1,5) PTB 14 ATEX 1015 X	
IECEx Certificate	IECEx PTB 05.0004X, IECEx PTB 14.0027X	





Characteristics

Connecting thread standard length

A	ØC3 mm	ØC2 mm	ØC1 mm	\overline{mm} L	SW1 mm	SW2 mm	H mm		Part No. -20 °C / +70 °C [*]	Part No. -40 °C / +70 °C [**]	 RAL 5015 sky blue Part No. -55 °C / +70 °C [**]
M12x1,5			5 - 7	8	15	15	31	20	GHG9601955R0101		
M16x1,5		5,5 - 7	7 - 10	8	20	20	35,5	20	GHG9601955R0102		
M20x1,5	5,5 - 7	7 - 9	9,5 - 13	8	24	24	37	20	GHG9601955R0103		
M20x1,5	5,5 - 7	7 - 9	9,5 - 11	8	24	24	37	20		GHG9601955R0109	
M25x1,5	8 - 10	10 - 13	13,5 - 17,5	8	29	29	43	20	GHG9601955R0104		
M25x1,5	8 - 10	10 - 13	13,5 - 15	8	29	29	43	20			GHG9601955R0110
M32x1,5		14 - 17	17,5 - 21	10	36	36	50	20	GHG9601955R0105		GHG9601955R0111
M40x1,5		19 - 22	22 - 28	10	46	46	51	10			GHG9601955R0106
M50x1,5		24 - 28	28 - 35	12	55	55	61,5	10			GHG9601955R0107
M63x1,5		29 - 35	36 - 48 ¹⁾	12	68	68	65,5	5			GHG9601955R0108

Connecting thread long

A	ØC3 mm	ØC2 mm	ØC1 mm	\overline{mm} L	SW1 mm	SW2 mm	H mm		Part No. -20 °C / +70 °C [*]	Part No. -40 °C / +70 °C [**]	 RAL 5015 sky blue Part No. -55 °C / +70 °C [**]
M12x1,5			5 - 7	12	15	15	35	20	GHG9601955R0121		
M16x1,5		5,5 - 7	7 - 10	12	20	20	39,5	20	GHG9601955R0122		
M20x1,5	5,5 - 7	7 - 9	9,5 - 13	13	24	24	42	20	GHG9601955R0123		
M20x1,5	5,5 - 7	7 - 9	9,5 - 11	13	24	24	42	20		GHG9601955R0129	
M25x1,5	8 - 10	10 - 13	13,5 - 17,5	13	29	29	48	20	GHG9601955R0124		
M25x1,5	8 - 10	10 - 13	13,5 - 15	13	29	29	48	20			GHG9601955R0130
M32x1,5		14 - 17	17,5 - 21	15	36	36	55	20	GHG9601955R0125		GHG9601955R0131
M40x1,5		19 - 22	22 - 28	15	46	46	56	10			GHG9601955R0126
M50x1,5		24 - 28	28 - 35	16	55	55	66,5	10			GHG9601955R0127
M63x1,5		29 - 35	36 - 48 ¹⁾	16	68	68	69,5	5			GHG9601955R0128

¹⁾ M63x1,5 with additional sealing

Blue dome nut = specific marking for type of protection Ex i - intrinsic safety

X-ON Electronics

Largest Supplier of Electrical and Electronic Components

Click to view similar products for [Hylec manufacturer](#):

Other Similar products are found below :

[THB.387.D2A](#) [LN167001](#) [THB.391.A3A](#) [50.625 PA/3X7](#) [THB.406.A1G](#) [THB.387.A4A.R](#) [K150-1050-00](#) [K151-1025-00](#) [K151-1063-00](#)
[50.625 PA/R7035](#) [50.216 MPOT-F](#) [K150-1032-00](#) [THB.382.A1A-KIT](#) [K341-1020-00](#) [50.616M/EMVDL-F](#) [GHG9601955R0004](#) [K160-1016-00](#) [K160-1050-00](#) [K150-1040-00](#) [HYKS-07612PP](#) [THB110A6B-F](#) [K151-1032-00](#) [THB.380.3ASSY](#) [THB.384.B1A](#) [50.216 ES](#)
[THK.404.X2A00-F](#) [TTK25BK-SD-F](#) [THB.405.B2A](#) [THB.405.A2B](#) [K160-1063-00](#) [THB.390.C1A](#) [THB.405.A2A](#) [1026010004-F](#) [50.625 ES](#)
[THB.405.A2G](#) [THA.209.A1A](#) [THB.387.D4A](#) [THB.387.C5A](#) [K160-1025-00](#) [50.625 M/EMVDL-F](#) [K160-1040-00](#) [THC.027.A1A](#)
[GHG9601955R0022](#) [THB.387.D5A](#) [K150-1020-00](#) [6000337BC](#) [THB.384.A1A](#) [THK.209.44](#) [5665/221](#) [THB.387.A4A](#)