

Order-No.	Shell Size / for No. of Contacts	B	C	D	∅F	H	U	V	W
FKH1-09SA-5939	1 / 9	±0.1	±0.3	±0.3	min - max	±0.3	±0.4	±0.15	-0.2
FKH2-15SA-5939	2 / 15	25	31.2	31.8	4.5 - 7	35	30.8	25	16.4
FKH3-25SA-5939	3 / 25	33.3	40	32	4.5 - 7	34.7	39.1	33.3	24.7
		47.04	53.7	35	8 - 10.5	37.7	53	47.04	38.5

FKHY-XXSA-5939

e.g. FKH3-25SA-5939

*1) V for hood size 1, 2 or 3
 *2) xx No. of contacts 09, 15 or 25

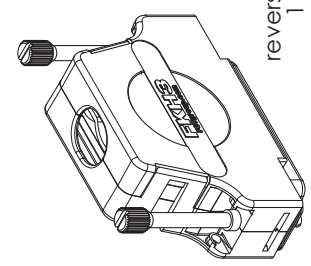
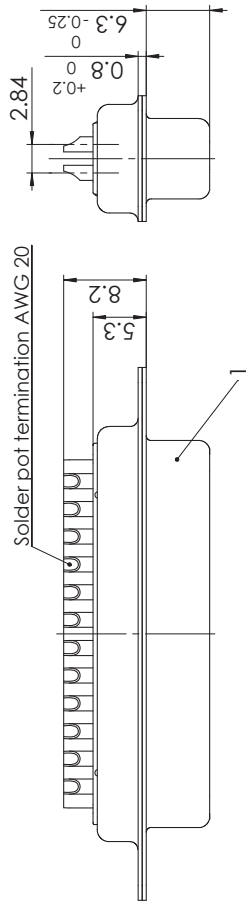
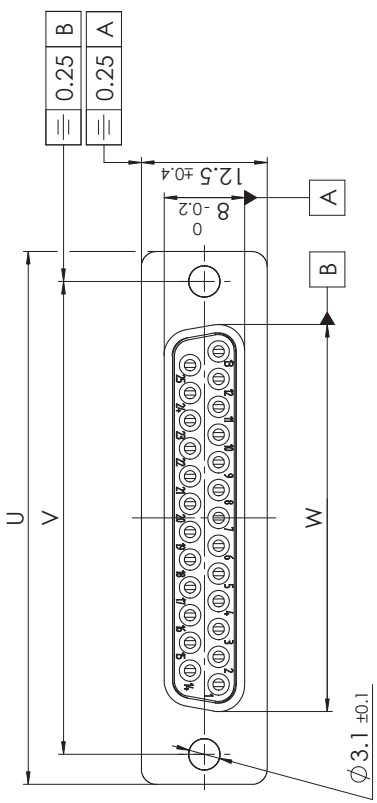

RoHS compliant

max. torque are 40 Ncm
 Part-No. 3 to 6 not mounted

∅F = Cable diameter

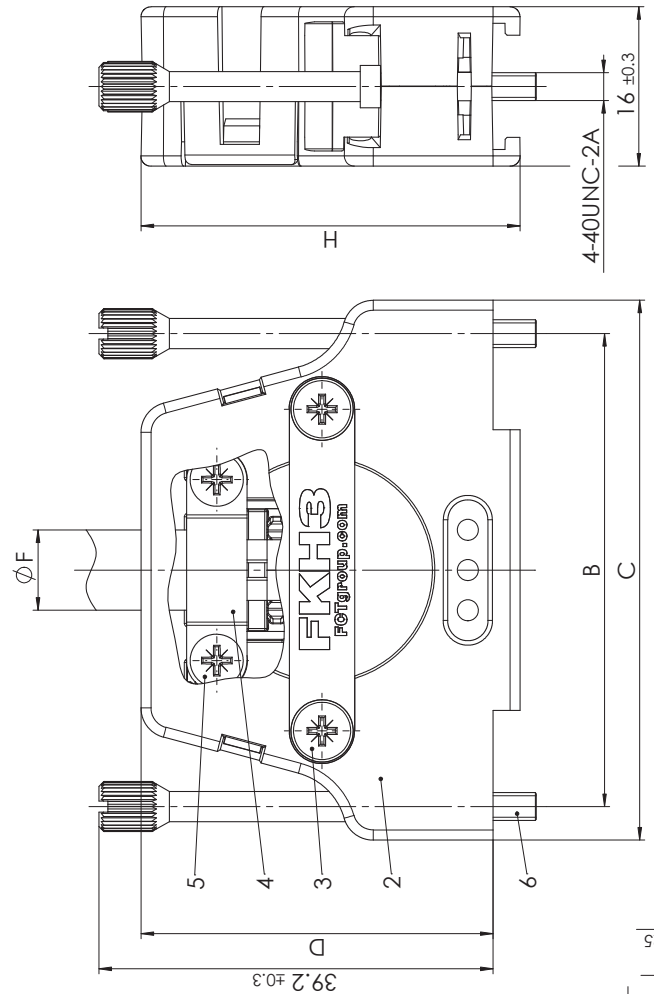

No.	St.	Part	Type Description/Material	Surface plating/Colour/Class
6	2	Knurled thumb screw	FRS1/5 4-40 / Brass	nickel plated
5	2	Cable clamp screw	Steel	zinc plated
4	1	Cable clamp	Steel	tin plated
3	2	Shell screw	Steel	zinc plated
2	1	Hood	FKHy / PC+ABS	black
1	1	D-Sub Connector	FxxS0G1A	

No.		Part		Type Description/Material		Surface plating/Colour/Class	
				FRS1/5 4-40 / Brass		nickel plated	
				Steel		zinc plated	
				Steel		tin plated	
				Steel		zinc plated	
				FKHy / PC+ABS		black	
				FxxS0G1A			
				Type Description/Material		Surface plating/Colour/Class	
				SCALE		TITLE	
				2:1		Hood Connector Set	
				NAME / DATE			
				DRAWN			
				CHECKED			
				DWG. NO.		FKHy-xxSA-5939	
				REV.		1	
				CH.-NO.			
				DATE			
				ORIGINAL: DN A3-DRAWING AS A FILE		REPLACEMENT FOR:	
				PAGES		1	



X-ON Electronics

Largest Supplier of Electrical and Electronic Components

Click to view similar products for FCT Electronics manufacturer:

Other Similar products are found below :

[FMX-008P102](#) [CT50-78S](#) [F2W2SC-1002](#) [24P104C24P1-006](#) [SDB15P159S-060](#) [FMP007P103](#) [FMR3G](#) [2761](#) [ICD040GVP163D-03](#)
[ICD040GVP163D-25](#) [10056427-1050011LF](#) [155298-002](#) [155286-001](#) [173112-0413](#) [173112-0157](#) [10131832](#) [111-0098-994](#) [K761](#)
[25P203C25P2-003](#) [CT25-44S](#) [K1003](#) [FMP003P106](#) [10112041-2020HLF](#) [173112-0077](#) [173112-0074](#) [173114-0092](#) [10046971-019LF](#)
[173112-0146](#) [FAW1PSRG1U](#) [FM7W2SA-K121](#) [FPHGR-1E](#) [FMK2GL](#) [CT15-26P](#) [HT151](#) [173113-0142](#) [173112-0073](#) [151-2811-010](#)
[F15S5G1-1002](#) [91910-21169LF](#) [SHD15P15S-036](#) [SHD15P15S-060](#) [SHD26P26S-012](#) [HM2R89PA8100N9LF](#) [10110818-3005HFLF](#) [73231-](#)
[1321](#) [173113-0143](#) [10093084-2010LF](#) [69168-126](#) [FL09S7-K121](#) [ICD056GVP163D-50](#)