

TWO-HAND OPERATION CONSOLE FOR COMMAND DEVICES, 22MM, ROUND, ENCLOSURE MATERIAL METAL, ENCLOSURE TOP PART GRAY, 3 COMMAND POINTS METAL, STANDARD EQUIPMENT: 2 MUSHROOM PUSHB. BLACK 40MM, 2 X 1NO+1NC, SCREW TERMINAL, 1 EMERG. STOP RED, 40MM, 2NC, SCREW TERMINAL,



Figure similar

product brand name	SIRIUS ACT
Product designation	Commanding and signaling devices
Design of the product	Enclosure
Manufacturer article number	
<ul style="list-style-type: none"> of supplied contact module 	R2 = 3SU1400-1AA10-1BA0 / L2 = 3SU1400-1AA10-1BA0 / M1 = 3SU1400-1AA10-1CA0 / R1 = 3SU1400-1AA10-1CA0 / L1 = 3SU1400-1AA10-1CA0 / M2 = 3SU1400-1AA10-1CA0

Enclosure:	
Design of the housing	Two-hand operating console with standard components
Material of the enclosure	metal
Number of control points	3
Color	
<ul style="list-style-type: none"> of top part of the enclosure 	grey
Delivery state	
<ul style="list-style-type: none"> as a kit pre-wired on strip terminal 	No No
Mounting type of the enclosure	Horizontal

Actuator:	
Design of the operating mechanism	A = Mushroom pushbutton / B = Emergency stop mushroom pushbutton / C = Mushroom pushbutton
Manner of function of the actuating element	A = momentary contact / B = latching / C = momentary contact
Product feature	
<ul style="list-style-type: none"> lockout staggered switching 	No No
Color	

• of the actuating element	A = black / B = red / C = black
Material of the actuating element	metal
Shape of the actuating element	round
Number of contact modules	6
Type of unlocking device	A = none / B = rotate to unlock / C = none

Front ring:	
Product component front ring	Yes
Material of the front ring	metal
Color of the front ring	silver

Holder:	
Material of the holder	Metal

General technical data:	
Product function	
• positive opening	Yes
• EMERGENCY OFF function	Yes
• EMERGENCY STOP function	Yes
Product component	
• Stand/pedestal	No
Shock resistance	
• acc. to IEC 60068-2-27	Sinusoidal half-wave 50 g / 11 ms
Vibration resistance	
• acc. to IEC 60068-2-6	10 ... 500 Hz: 5g
Protection class IP	IP66
Equipment marking	
• acc. to DIN EN 61346-2	S
• acc. to DIN EN 81346-2	S

Auxiliary circuit:	
Number of NC contacts	
• for auxiliary contacts	4
Number of NO contacts	
• for auxiliary contacts	2
Number of CO contacts	
• for auxiliary contacts	0
Design of the contact of the auxiliary contacts	Silver alloy

Connections/ Terminals:	
Type of electrical connection on enclosure	Cable routing at the rear 2 x M25

Ambient conditions:	
Ambient temperature	
• during operation	-25 ... +70 °C
• during storage	-40 ... +80 °C

Installation/ mounting/ dimensions:

Mounting type	Front plate mounting
• of modules and accessories	
Height	185.6 mm
Width	492.4 mm
Depth	159.5 mm

Accessories:

Number of backing plates	1
Marking of backing plate	EMERGENCY-STOP
Color of backing plate	Yellow

Certificates/ approvals:

Further information

Information- and Downloadcenter (Catalogs, Brochures,...)

<http://www.siemens.com/industrial-controls/catalogs>

Industry Mall (Online ordering system)

<http://www.siemens.com/industrymall>

Cax online generator

<http://support.automation.siemens.com/WW/CAXorder/default.aspx?lang=en&mlfb=3SU18533NB001AA1>

Service&Support (Manuals, Certificates, Characteristics, FAQs,...)

<https://support.industry.siemens.com/cs/ww/en/ps/3SU18533NB001AA1>

Image database (product images, 2D dimension drawings, 3D models, device circuit diagrams, EPLAN macros, ...)

http://www.automation.siemens.com/bilddb/cax_de.aspx?mlfb=3SU18533NB001AA1&lang=en

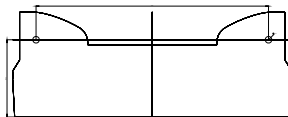
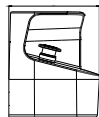
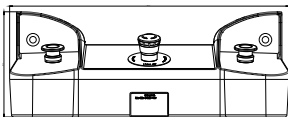

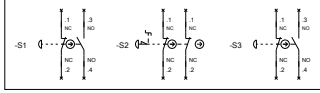

SIEMENS	3SU18.3.NB0_01_4_IEC.DXF <small>Format / Size: Hybrid que</small>
---------	----------------------------------------------------------------------

last modified:

27.04.2015

X-ON Electronics

Largest Supplier of Electrical and Electronic Components

Click to view similar products for [Siemens](#) manufacturer:

Other Similar products are found below :

[5SJ4101-7HG40](#) [5SJ4130-7HG40](#) [5SL6120-7](#) [5ST2144](#) [5ST2167](#) [5SX2125-7](#) [5SX2132-7](#) [5SX2320-7](#) [5SX2340-7](#) [5SX9200](#) [5SY4106-8](#)
[5SY6220-7](#) [6EP1334-3BA10-8AB0](#) [6EP1935-6MD31](#) [6EP3333-8SB00-0AY0](#) [6ES5451-7LA11](#) [6ES7322-1BF01-0AA0](#) [6GK7142-7BX00-0AX0](#) [6GK7177-1FA10-0AA0](#) [D11CEU1](#) [PD63F160](#) [FXD63B175](#) [8WA1011-2SF25](#) [8WA1721](#) [8WA1815](#) [8WA8848-0AC](#) [8WA8-848-0AM](#) [8WA8-848-0AN](#) [8WA8-848-0AT](#) [8WA8-848-0AX](#) [8WA8-848-0BD](#) [8WA8-848-0BF](#) [8WA8-848-0BL](#) [8WA8-848-0BP](#) [8WA8-848-0BQ](#) [14DP32AC81](#) [ED21B100](#) [B32523-.47@400V-J](#) [B65541-T25-A48](#) [B65549-E4-X23](#) [B65812-B1512-T1](#) [B66317-G0000-X127](#) [B66337-G0500-X127](#) [B66417-G-X167](#) [B82724-J](#) [8WA1201](#) [8WA1854](#) [8WA1870](#) [8WA8-848-0AK](#) [8WA8-848-0AV](#)