

EAO – Your Expert Partner for Human Machine Interfaces

704.064.2A - Emergency-stop switch actuator, foolproof EN IEC 60947-5-5

704.064.2A - Emergency-stop switch actuator, foolproof EN IEC 60947-5-5 / ISO 13850



Mounting

Mounting cut-out	Ø 22.5 mm
Design	raised

Front

Front shape	round
Front dimension	Ø 37 mm

Other Attributes

Marking	Arrows
Weight	0.300 kg

Operating-/Indication part

Lens material	Plastic
Lens optics	opaque
Lens profile	Mushroom
Lens colour	red

IP-Rating

Front protection	IP65
------------------	------

Actuator

Switching action	Maintained
------------------	------------

Function

Emergency stop switch

EAO – Your Expert Partner for Human Machine Interfaces

704.064.2A - Emergency-stop switch actuator, foolproof EN IEC 60947-5-5

Dimensions

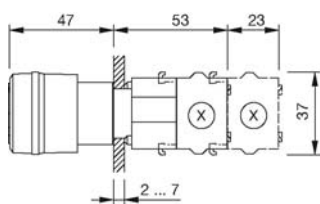

X = Screw terminal

Mounting cut-outs

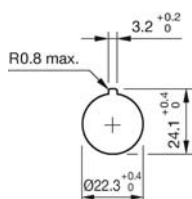

Wiring diagram



Additional information

Shaft yellow

Twist to unlock anti-clockwise

Max. 3 slow-make elements can be clipped on

Application as per DIN EN ISO 13850 and EN 60204-1

Legend

Switching action: C = Maintained

X-ON Electronics

Largest Supplier of Electrical and Electronic Components

Click to view similar products for [EAO manufacturer](#):

Other Similar products are found below :

[01-151.022](#) [01-951.6](#) [02-072.001](#) [61-0029.0](#) [61-221.50D](#) [61-2601.0/D](#) [61-2607.0/D](#) [61-2701.0/D](#) [61-8520.12](#) [61-8640.11](#) [704.012.618](#)
[704.032.218](#) [704.062.5](#) [704.122.018](#) [704-6012](#) [704.902.3](#) [704-9051](#) [704.918.5](#) [704.942.5](#) [70-911.0](#) [EUS-704.000.7](#) [82-4151.2144](#) [82-](#)
[4153.1000](#) [84-8001.5640](#) [84-8510.0040](#) [95-900.005](#) [14-136.025K](#) [200-4001-00](#) [22-212.011](#) [92-440.000](#) [95-900.009](#) [96-932.5](#) [22-225.011](#)
[22-901.2](#) [31-426.036](#) [45-2134.4F10.000](#) [45-2231.22E0.000](#) [45-280X.1C90.003](#) [45-2C37.1920.000](#) [45-2T00.10E0.000](#) [51-401.036K](#) [31-953.3](#)
[31-955.4](#) [41-461.036](#) [41-908.5/5](#) [45-1131.3150.000.101](#) [45-2231.31H0.000](#) [45-2234.4FH0.000](#) [45-50J.1400](#) [51-155.025D](#)