

EAO – Your Expert Partner for Human Machine Interfaces

704.066.2A - Emergency-stop switch, foolproof EN 60947-5-5 ISO 13850

**704.066.2 - Emergency-stop switch actuator,
foolproof EN IEC 60947-5-5 to ISO 13850**



Mounting

Mounting cut-out Ø 22.5 mm
Design raised

Front

Front shape round
Front dimension Ø 37 mm

Other Attributes

Marking Red Raised Arrows
Weight 0.300 kg

Operating-/Indication part

Lens material Plastic
Lens optics opaque
Lens profile Mushroom
Lens colour red

IP-Rating

Front protection IP65

Actuator

Switching action Maintained

Function

Emergency stop switch

EAO – Your Expert Partner for Human Machine Interfaces

704.066.2A - Emergency-stop switch, foolproof EN 60947-5-5 ISO 13850

Dimensions

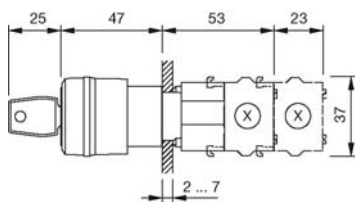

X = Screw terminal

Mounting cut-outs

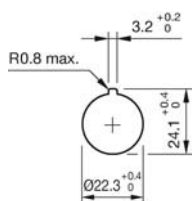

Wiring diagram

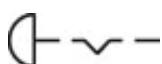

Additional information

Shaft yellow
Key to unlock anti-clockwise
Lock type Euro-Locks 9500
Two keys are supplied with each key lock switch
Optional lock numbers on request
Max. 3 slow-make elements can be clipped on
Application as per DIN EN ISO 13850 and EN 60204-1

Legend

Switching action: C = Maintained

X-ON Electronics

Largest Supplier of Electrical and Electronic Components

Click to view similar products for [EAO manufacturer](#):

Other Similar products are found below :

[01-151.022](#) [01-951.6](#) [02-072.001](#) [61-0029.0](#) [61-221.50D](#) [61-2601.0/D](#) [61-2607.0/D](#) [61-2701.0/D](#) [61-8520.12](#) [61-8640.11](#) [704.012.618](#)
[704.032.218](#) [704.062.5](#) [704.122.018](#) [704-6012](#) [704.902.3](#) [704-9051](#) [704.918.5](#) [704.942.5](#) [70-911.0](#) [EUS-704.000.7](#) [82-4151.2144](#) [82-](#)
[4153.1000](#) [84-8001.5640](#) [84-8510.0040](#) [95-900.005](#) [14-136.025K](#) [200-4001-00](#) [22-212.011](#) [92-440.000](#) [95-900.009](#) [96-932.5](#) [22-225.011](#)
[22-901.2](#) [31-426.036](#) [45-2134.4F10.000](#) [45-2231.22E0.000](#) [45-280X.1C90.003](#) [45-2C37.1920.000](#) [45-2T00.10E0.000](#) [51-401.036K](#) [31-953.3](#)
[31-955.4](#) [41-461.036](#) [41-908.5/5](#) [45-1131.3150.000.101](#) [45-2231.31H0.000](#) [45-2234.4FH0.000](#) [45-50J.1400](#) [51-155.025D](#)