

A-A SECTION

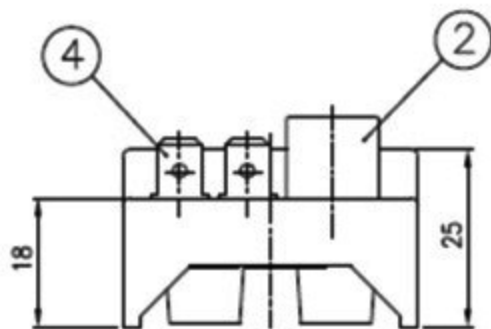
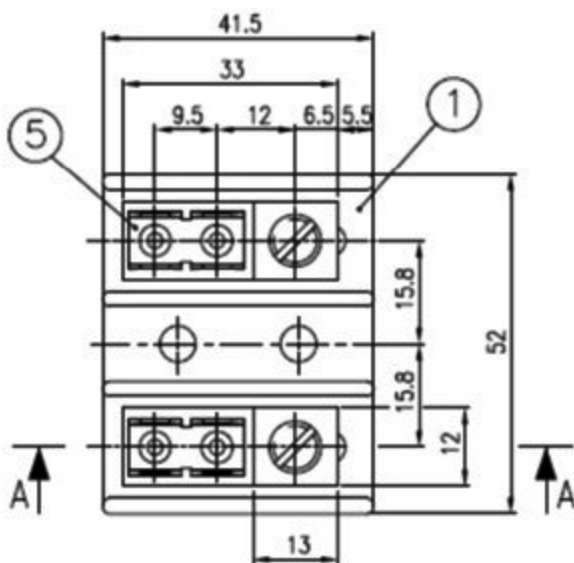
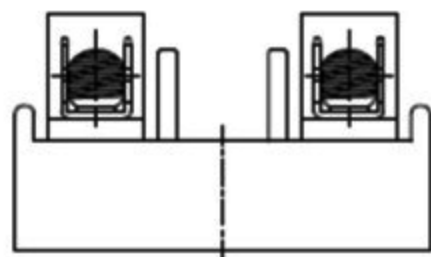

DIMENSIONAL TOLERANCE							
DIMENSION				ROUNDEDNESS AND CHAMFER			
MIN	MAX	MIN	MAX	MIN	MAX	MIN	MAX
3~6	6~30	30~120	200	3~6	6~10	10~15	15~30
±0.2	±0.3	±0.5	±0.8	±1.2	±0.4	±1	±2

SPECIFICATIONS

VOLTAGE RATINGS: 300V
 CURRENT RATINGS: 50A
 CONDUCTORS: ALUMINUM
 MATERIALS: BAKELITE UL94V-0
 SUITABLE WIRE:

LINE: 2~14 AWG CU

LOAD: .25 QC Tab Terminals

WIRING TORQUE:

LINE:
 2~3 AWG 50 LB-IN
 4~6 AWG 45 LB-IN
 8 AWG 40 LB-IN
 10~14 AWG 35 LB-IN

LOAD: .25 OC Tab Terminals

CERTIFICATION MARKING: UL CUL

5	Rivet	COPPER ; #3	4	NI PLATED	RI1	
4	Term.	BRASS (C2680R) ; t0.8 #250	2	NI PLATED	PR1-2	
3	SCREW	SS ; 5/16-24UNF	2	260-PLATED	SC311Y	
2	CONDUCTORS	ALUMINUM AL6061	2	Sn PLATED	AL-1	
1	BASE	BAKELITE (13794) UL94V-0	1		18011-1-2P	BLACK

No.	DATE	CONTENT	REVISION	APPROVED	NO.	PART NAME	MATERIAL	SPECIFICATION	Q'TY	FINISH	PART No.	REMARK
△	'16.07.18	ADD UL CERTIFICATION	LF	LWS	3	SCREW	SS ; 5/16-24UNF		2	260-PLATED	SC311Y	
△	'15.05.21	MATERIAL CHANGE	H.Z.L.	H.L.C.	2	CONDUCTORS	ALUMINUM AL6061		2	Sn PLATED	AL-1	
△	'15.05.14	MATERIAL CHANGE	H.Z.L.	H.L.C.	1	BASE	BAKELITE (13794) UL94V-0		1		18011-1-2P	BLACK

SCALE	DIM.	mm	DRIVEN BY	CHECKED BY	APPROVED BY	TITLE
1/1			H.Z.L.	H.L.C.	H.L.C.	TERMINAL BLOCK
BlockMaster Electronics						
			'15.03.21	'15.03.21	'15.03.21	DWG No. HP-AT101-1-2P (H3)

X-ON Electronics

Largest Supplier of Electrical and Electronic Components

Click to view similar products for [Blockmaster](#) manufacturer:

Other Similar products are found below :

[OTB-388-03P-C](#) [OTB-359N-02P-C](#) [OT-016-M5-L8](#) [HP-ATB-175-5-3P](#) [OTB-358N-06P-C](#) [HP-ATB-175-4-3P](#) [HP-AT-101-1-2P](#) [OTB-351-03P-C](#) [OTB-388-04P-C](#) [OP-487-M6](#) [HP-AT-101-1-3P](#) [HB951-23P](#) [OTB-351-12P-C](#) [OTB-330N-03P-C](#) [OTB-351-05P-C](#) [OTB-388-02P-C](#) [OP-055-M5-L1](#) [OT-201-M8](#) [OP-075-M5](#) [OT-047-M4](#) [675-303/920](#) [OT-048-M5](#) [PSM020H5](#) [MSB03005](#) [KS-03](#) [HI-205-07PH-C](#) [675-102/0](#)
[675-302/0](#)