







## 150W AC-DC Desktop Power Supplies

-  FR4 PCB
-  100% ATE Tested
-  High Reliability
-  Built in OVP, OCP & SCP
-  100% smart burn-in test for 4 hours
-  Level VI Efficiency Regulations Compliant
-  Universal Input 90~260V AC 47~63Hz



### DIMENSIONS

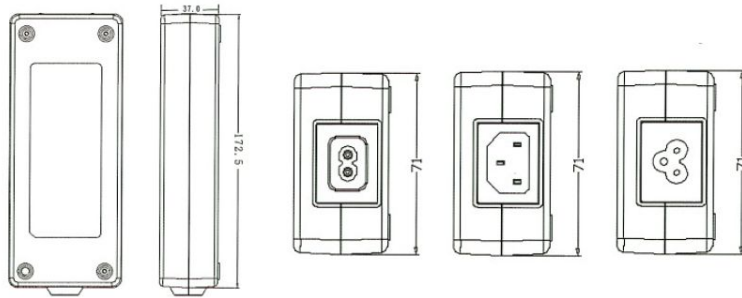

### SPECIFICATIONS

|                          |                       |   |
|--------------------------|-----------------------|---|
| Input                    | Input Range           | 100~240VAC (Full Range), 50/60Hz                        |
|                          | Input Current (RMS)   | 2.5A@90VAC<br>1.2A@264VAC                               |
| Output                   | Voltage Range         | 12~50VDC  |
|                          | Voltage Regulation    | +/- 5% At Constant Voltage Mode                         |
|                          | Current Range         | 0.01~10A  |
|                          | Max Power             | 150W  |
| Energy Saving            |                       | NRCAN, DOE, ERP, GEMS, Efficiency Level VI              |
| Environmental Protection |                       | RoHS, REACH, PAHS                                       |
| Environmental            | Operating Temperature | 0°C ~45°C Ambient                                       |
|                          | Storage Temperature   | -20°C ~+80°C  |
|                          | Operating Humidity    | 10~90% (Non-condensing)                                 |
|                          | Relative Humidity     | 5~95% (Non-condensing)                                  |
|                          | MTBF                  | >25,000 hours at 80% load and 25°C ambient temperature  |
| Approvals                |                       | cETLus, TUV-GS, RCM (C-Tick), CB, FCC, CE, RoHS & REACH |

VAT No. GB 771 1607 40

Registered in England No. 4063412

Weee Reg. WEE/DD0749YY

 +44 (0) 845 260 3400

 enquiries@ideallpower.co.uk

 idealpower.co.uk

Ideal Power Ltd.  
 14 Larks Way  
 Tree Beech Enterprise Park  
 Gunn, Barnstaple  
 Devon, EX32 7NZ  
 England, UK

## **X-ON Electronics**

Largest Supplier of Electrical and Electronic Components

*Click to view similar products for [Ideal manufacturer](#):*

Other Similar products are found below :

[30-582](#) [VDV II PLUS](#) [45-915](#) [45-173](#) [45-098](#) [45-097](#) [L-5361](#) [45-093](#) [45-162](#) [41-990](#) [15DYS618-120150W-3](#) [15DYS624-050400W-K](#) [30-503](#) [35-020](#) [35-060](#) [35-516](#) [45-120](#) [45-1633-1](#) [45-170](#) [45-176](#) [45-1773-1](#) [45-1774](#) [45-1939-1](#) [45-2133-1](#) [45-298](#) [45-372](#) [45-404](#) [K-6336](#) [K-8906R](#) [L-4866](#) [L-9038](#) [LB-1091](#) [35-522](#) [61-775](#) [KB-0276R](#) [25HK-AB-050A400-CP](#) [30-593](#) [30-696](#) [33-856](#) [158050](#) [30-576](#) [45-672](#) [45-292](#) [45-129](#) [LB-1002](#) [30-793](#) [33-864](#) [45-1611-1](#) [R151005](#) [45-1513](#)