

Data Sheet

RP035xxHBLD

Page 1/5

P/N

313141xx

xx=number of poles

2017/01/24

Illustration

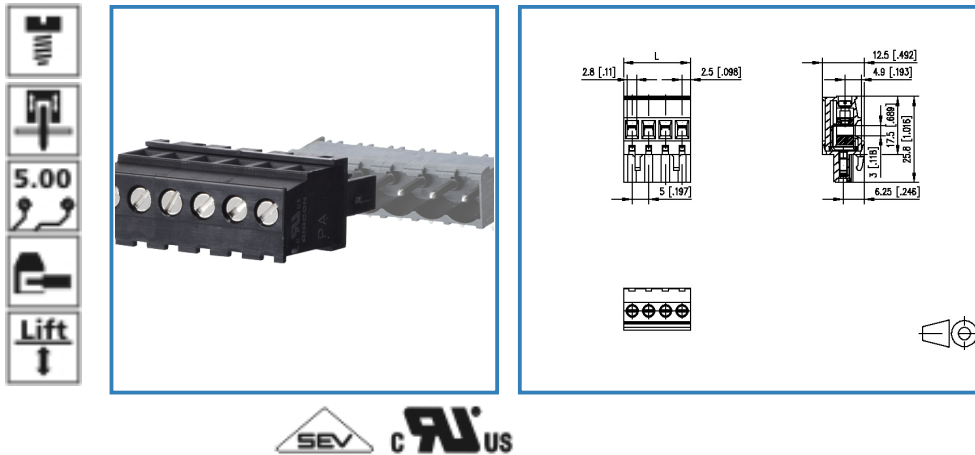

see enlarged drawing at the end of the document

Product specification

- screw type terminal block, pluggable
- centerline 5.00 mm, direction of connection 90°
- lift system, fittable without loss of poles
- color black
- wire entry codeable side perpendicular to plug direction

Data Sheet

RP035xxHBLD

Technical Data

General Data

| | | | |
|---------------------------|-----------|--------|-------|
| Tightening torque SEV | 0.5 Nm | | |
| Tightening torque UL | 4.5 lb-in | | |
| min. number of poles | 2 | | |
| max. number of poles | 24 | | |
| Insulating material class | CTI 600 | | |
| clearance/creepage dist. | 3.2 mm | | |
| protection category | IP 20 | | |
| Overvoltage category | III | III | II |
| Pollution degree | 3 | 2 | 2 |
| Rated voltage | 250 V | 630 V | 630 V |
| Rated test voltage | 4.0 kV | 4.0 kV | 4 kV |

Connection data

| | | | |
|----------------------------|--|--|--|
| Rated wiring solid wire | 0.08 - 2.5 mm ² / AWG 28 - 12 | | |
| Rated wiring stranded wire | 0.08 - 2.5 mm ² / AWG 28 - 12 | | |

Approvals

| | | | |
|--------------------|--|--|--|
| extended wiring UL | 2 AWG 16-18, or 1 AWG 16 stranded with 1 AWG 18 solid, or 1 AWG 16 stranded with 1 AWG 18 stranded | | |
|--------------------|--|--|--|

| | | | |
|--|--------------------|--|--|
|  V / A / AWG | 300 / 12 / 28 - 12 | | |
|--|--------------------|--|--|

| | | | |
|--|---|--|--|
|  | 13.5 A / 320 V / 4 kV / 3 / IEC 61984 / 0.08 - 2.5 mm ² | | |
|--|---|--|--|

Material

| | |
|-----------------------------|---------------------|
| insulating material | PA66 |
| flammability class | V0 |
| contact material | CuSn |
| Glow-Wire Flammability GWFI | 960 |
| Glow-Wire Flammability GWIT | 775 |
| contact surface | Sn |
| terminal body material | CuZn |
| terminal body surface | Ni |
| screw surface | Zn Cr(VI)-frei/free |
| screw thread | M3 |

Climatic properties

| | |
|-------------------------|--------|
| upper limit temperature | 105 °C |
| lower limit temperature | -40 °C |



Data Sheet

RP035xxHBLD

Page 3/5

P/N

313141xx

xx=number of poles

2017/01/24

General

| | |
|-----------|--------------|
| Tolerance | ISO 2768 -mH |
|-----------|--------------|



Data Sheet

RP035xxHBLD

Page 4/5

P/N

313141xx

xx=number of poles

2017/01/24

Matching Part

| P/N | Product name |
|--------|---------------------|
| 311761 | PR065xxHBBN Typ 176 |
| 314761 | PR065xxHBEC Typ 476 |
| 313381 | PR075xxHBER Typ 338 |
| 313371 | PR075xxHBEL Typ 337 |
| 313301 | PT115xxHBBN Typ 330 |
| 313291 | PT115xxHBEC Typ 329 |
| 313201 | PT115xxVBBN Typ 320 |
| 313191 | PT115xxVBEC Typ 319 |
| 312801 | PT105xxHGDN Typ 280 |
| 312781 | PT105xxVGDN Typ 278 |
| 312761 | PT165xxHGDN Typ 276 |
| 312741 | PT165xxVGDN Typ 274 |
| 312701 | PT175xxVGDN Typ 270 |
| 311771 | PR065xxVBBN Typ 177 |
| 314771 | PR065xxVBEC Typ 477 |

Accessories

| P/N | Product name |
|-------------|--------------|
| 700025-01-9 | 700025 |



Data Sheet

RP035xxHBLD

Page 5/5

P/N

313141xx

xx=number of poles

2017/01/24

Illustration

Drawing

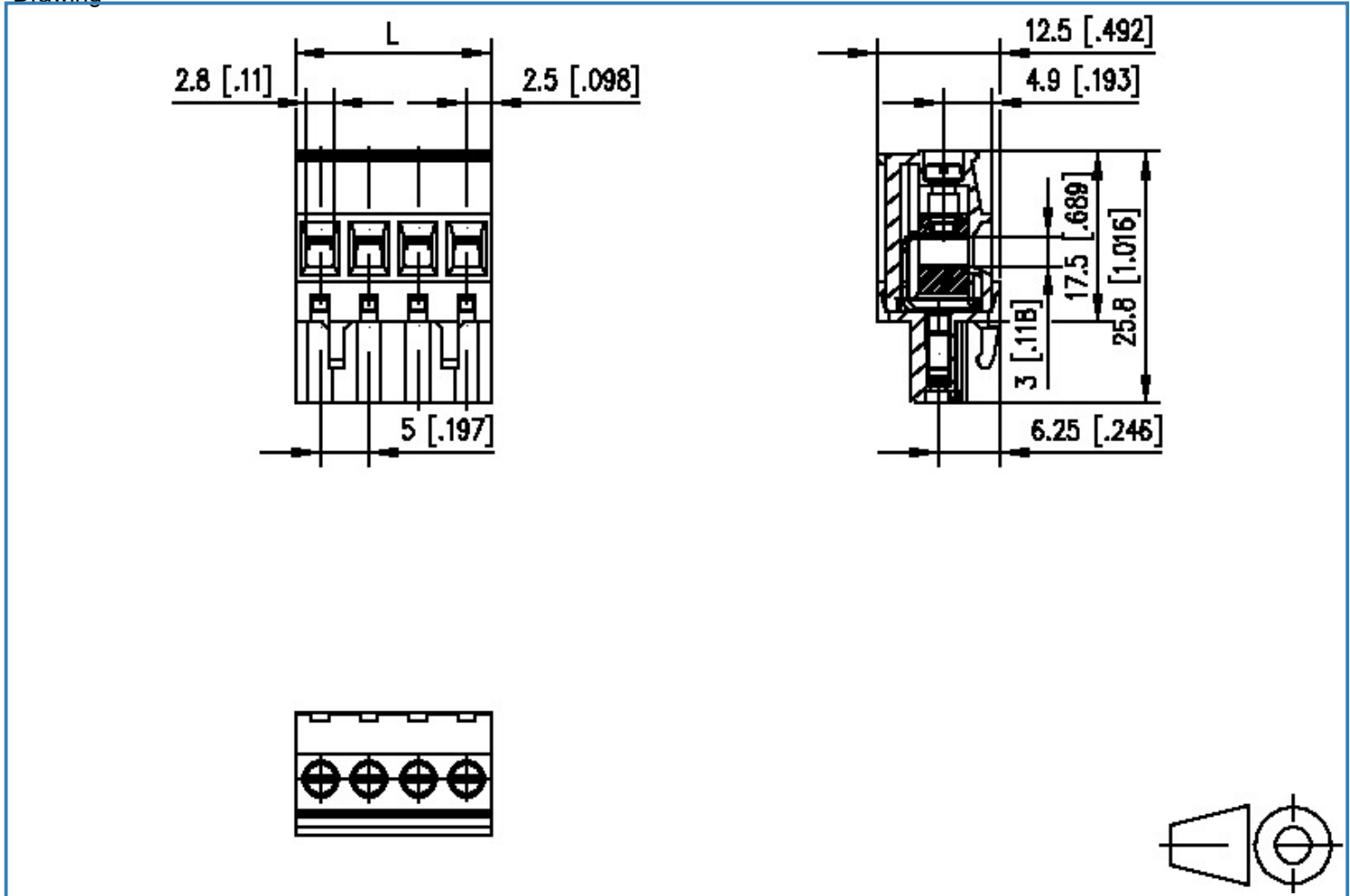

$$L = (\text{pole size} - 1) \times \text{centerline} + 5 [0.197]$$



X-ON Electronics

Largest Supplier of Electrical and Electronic Components

Click to view similar products for [Metz manufacturer](#):

Other Similar products are found below :

[142M4D95050](#) [ASP0631006](#) [4898-454G](#) [4895-454G](#) [4887-454G](#) [4897-454G](#) [ASP0460622](#) [142M2X25005](#) [ASP0440222](#) [1108861321](#)
[1108311319](#) [1108501319](#) [11089313](#) [834HTC-900ML](#) [130920-E](#) [150240C30610E](#) [110304412004](#) [1108831326](#) [150240C30310S](#) [135015-](#)
[SSC-E](#) [1528SBGT19E](#) [1401110012KE](#) [142M2X15010](#) [11085813](#) [810-500](#) [810-50](#) [31336104](#) [ASP0430922](#) [SP06502VBNF](#) [31217103](#)
[142M1D19020](#) [SR99S01VBNN0001](#) [31213102](#) [31251104](#) [AST0820406](#) [1108811319](#) [142M2XB5050](#) [834B-375ML](#) [841ER-1.17L](#)
[31009105](#) [31020205](#) [31024102](#) [31027103](#) [31383106](#) [130922-03-E](#) [130924-E](#) [11027605](#) [1108841319](#) [1108341319](#) [15024AD206-E](#)