

DEEP PUSHBUTTON ENCLOSURES, TYPE 12



INDUSTRY STANDARDS

UL 508A Listed; Type 12, 13; File No. E61997
 cUL Listed per CSA C22.2 No. 94; Type 12, 13; File No. E61997

NEMA/EEMAC Type 12, 13
 CSA File Number 42186: Type 12
 IEC 60529, IP65

APPLICATION

Designed for pushbuttons and switches, the extra depth of these enclosures accommodates additional pushbutton contact blocks.

SPECIFICATIONS

- 14 gauge steel
- Seams continuously welded and ground smooth
- Captivated cover screws thread into sealed wells
- Bonding provision on cover
- Grounding stud on body
- Oil-resistant gasket
- Enclosures with more than one column of pushbutton holes have internal detachable hinge to hold cover open during wiring
- External welded-on mounting brackets for easy installation
- Factory stamped 4-way pushbutton holes
- 22.5-mm size holes

FINISH

ANSI 61 gray polyester powder paint inside and out

ACCESSORIES

See also Accessories.
 Industrial Corrosion Inhibitors
 HOL-SEALERS Hole Seals
 Tamper-Resistant Screws

BULLETIN: PB1

Standard Product

Catalog Number	AxBxC in./mm	Number of Holes	Mounting G x H in./mm	Overall L x W in./mm	J in./mm	T in./mm	X in./mm	Y in./mm
E1PBGXM	3.25 x 2.75 x 3.50 83 x 70 x 89	1	3.75 x 1.88 95 x 48	4.25 x 2.97 108 x 75	3.09 78	2.50 64	1.48 38	1.73 44
E2PBGXM	5.12 x 2.75 x 3.50 130 x 70 x 89	2	5.62 x 1.88 143 x 48	6.12 x 2.97 155 x 75	3.09 78	2.50 64	1.48 38	1.55 39
E3PBGXM	7.25 x 2.75 x 3.50 184 x 70 x 89	3	7.75 x 1.88 197 x 48	8.25 x 2.97 210 x 75	3.09 78	2.50 64	1.48 38	1.48 38
E4PBGXM	9.50 x 2.75 x 3.50 241 x 70 x 89	4	10.00 x 1.88 254 x 48	10.50 x 2.97 267 x 75	3.09 78	2.50 64	1.48 38	1.48 38
E6PBGXM	8.50 x 5.00 x 4.25 216 x 127 x 108	6	9.00 x 4.12 229 x 105	9.50 x 5.22 241 x 133	3.84 98	4.75 121	1.48 38	2.11 54
E9PBGXM	8.50 x 7.25 x 4.25 216 x 184 x 108	9	9.00 x 5.63 229 x 162	9.50 x 7.47 241 x 190	3.84 98	6.25 159	1.48 38	2.11 54
E12PBGXM	10.38 x 7.25 x 4.25 264 x 184 x 108	12	10.88 x 5.63 276 x 162	11.38 x 7.47 289 x 190	3.84 98	6.25 159	1.48 38	1.92 49

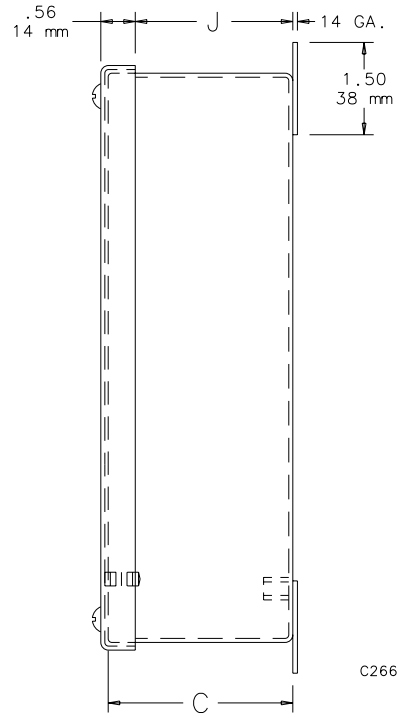
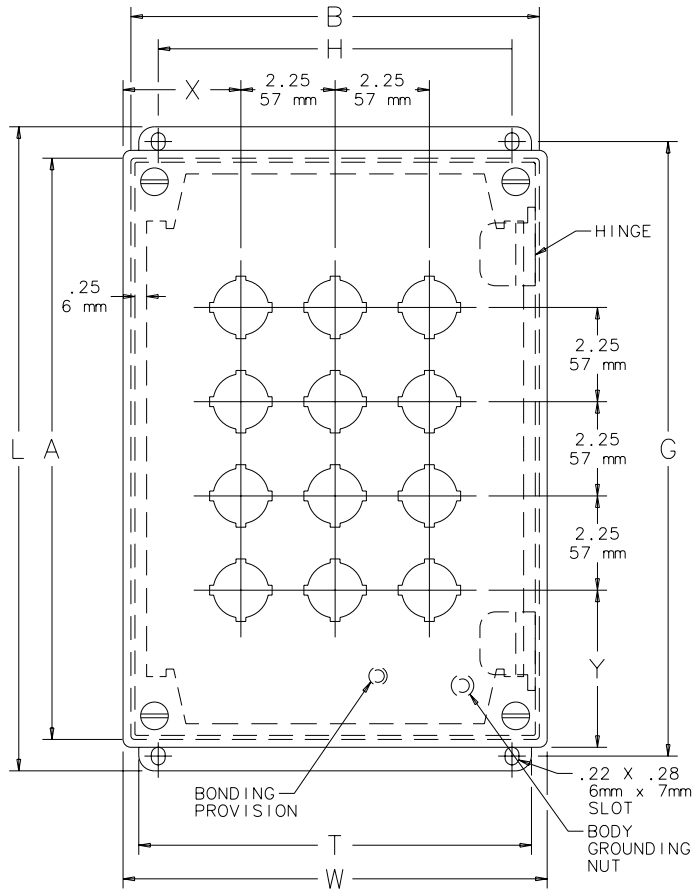

C2667-C

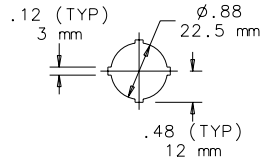

22.5mm 4-way

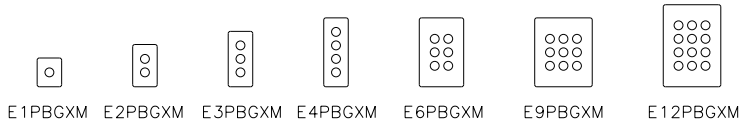

X-ON Electronics

Largest Supplier of Electrical and Electronic Components

Click to view similar products for [Hoffman](#) manufacturer:

Other Similar products are found below :

[A-1412CHQR](#) [A-6P4G](#) [A-202408LP](#) [CSD20168SS](#) [CSD20206](#) [CSD20208SS](#) [CSD24168](#) [CSD36248](#) [CSD36308](#) [PCU7](#) [PDS76R](#)
[PRA197TP](#) [PT126](#) [A10086CH](#) [A1008CHNFSS](#) [A10106CH](#) [A10106CHFL](#) [A10106PHCW](#) [A1043DSC](#) [A1066JFGQRR](#) [A12106CHQRFG](#)
[A1212SC](#) [A1412CHNFSS](#) [A161208LP](#) [A161410CH](#) [A16148CHQRFG](#) [A16H12ALP](#) [A18P16AL](#) [A24H2408SSLP](#) [A24H24BLP](#)
[Q13138PCE](#) [A36P24](#) [Q3PBPCDM](#) [A404CH](#) [A606CHNF](#) [A606NF](#) [A806SC](#) [A845JFGR](#) [A864CHQRFGW](#) [A90P36F1](#) [HJ1412HWPL2LG](#)
[HJ1816HWPL2LG](#) [RHJ1210HWPL2LG](#) [AS125SS](#) [ASE10X10X4](#) [ASE12X12X4](#) [E1PBG](#) [E2PBG](#) [E3PB](#) [LED24V15](#)