

Soldering - Solderen - Soudage - Lötten - Soldadura - Lötning - Juottaminen - Saldatura - Solda

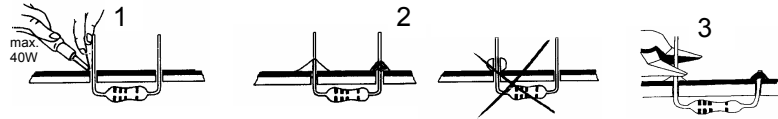

START **1** Resistor - Weerstand - Résistance - Widerstand - Resistencia - Motstand - Vastus - Resistenze

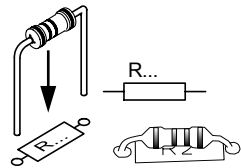

◇ R1... R4: 470

(Yellow, Purple, Brown) -(Geel, Paars, Bruin) -(Jaune, Violet, Brun) - (Gelb, Violet, Braun) -(Gul, Lila, Brun) -(Keltainen, Purppura, Ruskea) - (Amarillo, Morado, Marrón) -(Amarelo, Violeta, Castanho) - (Giallo, Viola, Marrone)

◇ R5, R6: 4K7

(Yellow, Purple, Red) -(Geel, Paars, Rood) -(Jaune, Violet, Rouge) - (Gelb, Violet, Rot) -(Gul, Lila, Röd) -(Keltainen, Purppura, Punainen) - (Amarillo, Morado, Rojo) -(Amarelo, Violeta, Encarnado) - (Giallo, Viola, Rosso)

◇ R7: 47

(Yellow, Purple, Black) -(Geel, Paars, Zwart) -(Jaune, Violet, Noir) - (Gelb, Violet, Schwarz) -(Gul, Lila, Svart) -(Keltainen, Purppura, Musta) - (Amarillo, Morado, Negro) -(Amarelo, Violeta, Preto) - (Giallo, Viola, Nero)

2 Diode

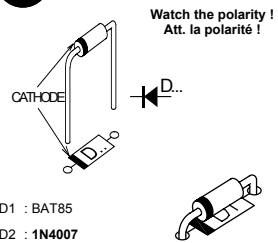

Watch the polarity!
Att. la polarité!

◇ D1 : BAT85
◇ D2 : 1N4007

3 Push buttons

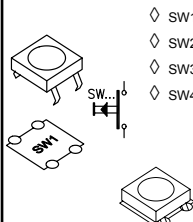

◇ SW1
◇ SW2
◇ SW3
◇ SW4

4 IC socket

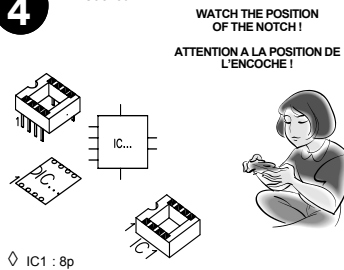

WATCH THE POSITION
OF THE NOTCH!
ATTENTION A LA POSITION DE
L'ENCOCHE!

◇ IC1 : 8p

5 Capacitor

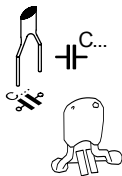

◇ C1:1µF (105)

6 LED

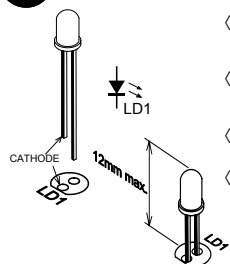

Watch the polarity!
Att. la polarité!

◇ LD1 : Yellow-Geel-Jaune-Gelb-Gul-Keltainen-Amarillo-Amarelo-Giallo
◇ LD2 : Red, Rood, Rouge, Rot, Röd, Punainen, Rojo, Encarnado, Rosso.
◇ LD3 : Green, Groen, Vert, Grün, Grön, Vihreä, Verde
◇ LD4 : Red,Rood, Rouge, Rot, Röd, Punainen, Rojo, Encarnado, Rosso.

7 Transistor

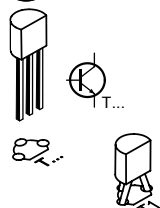

◇ T1: BC547

8 Loudspeaker

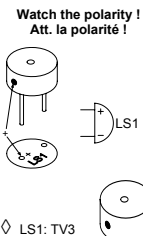

◇ LS1: TV3

9 IC

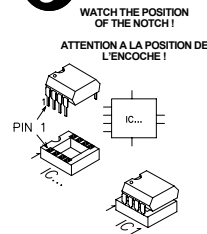

WATCH THE POSITION
OF THE NOTCH!
ATTENTION A LA POSITION DE
L'ENCOCHE!

◇ IC1 : PIC12C508A

10 Battery lips

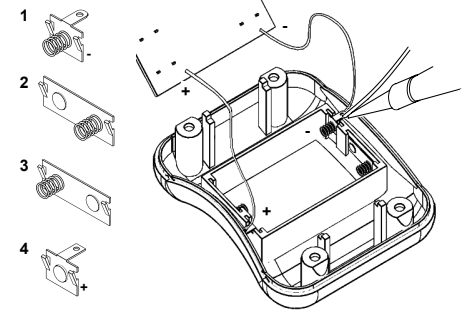
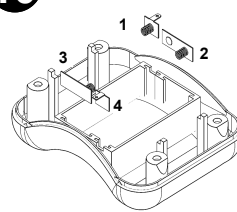

11 Batteries

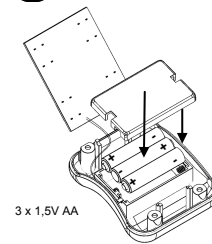

13 Diagram

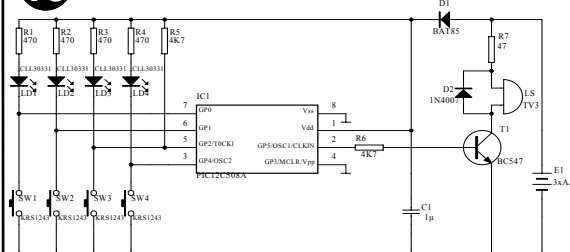

12 Assembly

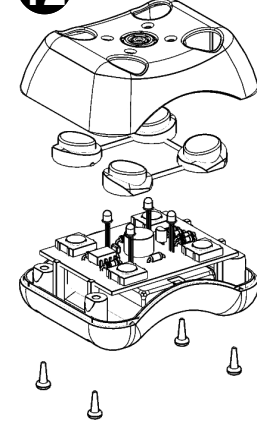

START:

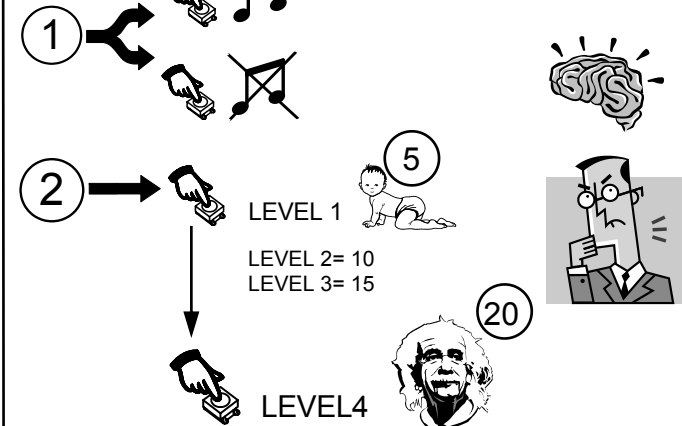

X-ON Electronics

Largest Supplier of Electrical and Electronic Components

Click to view similar products for [Velleman](#) manufacturer:

Other Similar products are found below :

[MK137](#) [MK106](#) [K2622](#) [K/DIODE1](#) [72-6514](#) [MK108](#) [K8072](#) [K2634](#) [80-7352](#) [K/TF300](#) [MK149](#) [HPS140MK2](#) [VM100](#) [MK123](#) [MK144](#)
[MK152](#) [K8086](#) [K/RES-E12](#) [MK190](#) [MK134](#) [K/TRANS1](#) [CD018](#) [K1803](#) [K/RES-E3](#) [MK111](#) [MK103](#) [MK100](#) [OMSB36](#) [K/CAP1](#) [MK109](#)
[MK120](#) [MK135](#) [MK150](#) [MK112](#) [VTHH6](#)