

**MCV™ Series 59 & 6**

U.S. Patent #: 7,112,093  
7,264,502  
6,929,508

## Universal Compression Connectors

Holland Electronic's new universal compression connectors were created with the Commercial AV Installers' needs in mind. This series consists of five Universal Connectors that terminate most major brands of cable, including Plenum RG-6, RG-6, RG-59, Mini-23 AWG and Mini 25 AWG cables.

### Features:

- **One Universal Connector for each Series of Cable (Including Plenum)**
- **Easy Insertion**
- **All Metal Construction**
- **Optimized for Digital Video Applications**
- **Patented Viewing Window**
- **Accommodates Color-Coded Application Bands (P/N: SRR)**

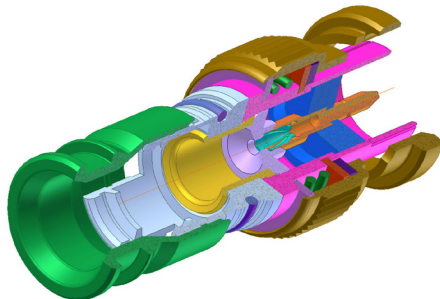

**FITS MOST MAJOR COAXIAL CABLE BRANDS - Plenum RG-6, RG-6, RG-59, Mini 23 & Mini 25** - Our new *MCV Universal Compression Connectors* fit a wide variety of coaxial cables that vary in size between manufacturers. Some differences often include thickness of jacket or diameter of insulation depending on variance in materials used in the cable manufacturing process.



### AVAILABLE IN BNC, RCA AND F

Frequency Range	DC - 3,000 MHz	
Return Loss (1 GHz)	> -27dB	
Return Loss (3 GHz)	> -21dB	
Insertion Loss (1 GHz)	< .15 dB Max	
	(The above test results from BNC6-MCVL)	
	Jacket O.D. Range	Pull Force
RG59 MCV	5.8 - 6.1	55 lbs. typical
RG6 MCV	5.9 - 6.9	70 lbs. typical
RG6 MCVL	6.6 - 7.4	70 lbs. typical
SLC1855-FPU	3.7 - 4.1	40 lbs. typical
SLC-MINI25U	2.7 - 2.9	30 lbs. typical

### WORKS WITH MOST COMPRESSION TOOLS



Cable Prep	MCT
Cable Prep	HPT-6590
Liberty	CM-TOOL
Cable Pro	CPLCCT-SLM
Holland	CT-FBR

RG-6 & RG-59 - Fits all standard 21MM Compression Tools  
Mini 23 & 25 AWG - Fits all standard 29.8MM Compression Tools

### COMPATIBLE COAXIAL CABLE

Connector Series →	59-MCV	6-MCV	6-MCVL	23 AWG	25 AWG
Sheerwire Brand	SVHD59P	SVCA6P	SVCA6QP	SVHD23P	SV253SP
Gepco Brand	SVHD59R	SVCA6R	SVCA6QR	SVHD23R	SV253SR
	SVCC59P	495025	SVHD6P	VS5230	SV254SP
	SVCC59R	C5820	SVHD6R		SV254SR
	SV59222P		SVRG63R		SV255SP
	SV59222R		SVRG64R		SV255SR
	SV59182P		SVRG65R		SV256SR
	SV59182R		SVRG66R		RGB250S
	495023		SVCC6P		RGBS250S
	C5782		SVCC6R		RGBSC250S
			C5812		RGBHVC250S
			C5785		

# MCV - COMPATIBLE COAXIAL CABLE

Outside Diameter -->	5.8 - 6.1	5.9 - 6.9	6.6 - 7.4	3.7 - 4.1	2.7 - 2.9
<b>Connector Series</b>	<b>59-MCV</b>	<b>6-MCV</b>	<b>6-MCVL</b>	<b>23 AWG</b>	<b>25 AWG</b>
<b>Sheerwire Brand</b>	SVHD59P	SVCA6P	SVCA6QP	SVHD23P	SV253SP
	SVHD59R	SVCA6R	SVCA6QR	SVHD23R	SV253SR
	SVCC59P		SVHD6P		SV254SP
	SVCC59R		SVHD6R		SV254SR
	SV59222P		SVRG63R		SV255SP
	SV59222R		SVRG64R		SV255SR
	SV59182P		SVRG65R		SV256SR
	SV59182R		SVRG66R		
			SVCC6P		
			SVCC6R		
<b>Gepco Brand</b>	495023	495025	C5812	VS5230	RGB250S
	C5782	C5820	C5785		RGBS250S
			1152A		RGBSC250S
					RGBHVC250S
<b>Belden</b>	549945	1829R/9116	1829R/9116	1855A	1277P-R
	543945	533945	533945	1855P	1278P-R
	1505A	1189AP	1189AP		1278R
	8241A	9116	9116		1279P-R
	1151A	1306B	1306B		1280P-R
	9100	1258AM	1258AM		1281R-S3
	9104	1530A	1530A		1281R-S4
	9275	1532A	1532A		1281R-S5
	9104N	1532AM	1532AM		1281R-S6
	9555	539945	539945		HC2648R
	8241	1152A	1152A		HC2650R
	9274		1260AM		1280R
	9105M		1360SB		1164B
	9204				1167B
	9240				1418B
	9259				
	9209A				
	8212				
	8221				
	8263				
	9110				
	9167				
	9224				
	9244				
	9659				
	1426A				
	1505F				
	8241B				
	8241F				
	1186A				
	88281				
<b>Honeywell/Genesis</b>	5013	5012	5012	5022*	
	5035	5038	5038	5019	
	5001	5038	5038	5020	
	5009	5302	5302	5029	
	5013			5098	
	5103			5099	
	5104				
	5301				
	5351				
	5355				

# MCV - COMPATIBLE COAXIAL CABLE

Outside Diameter -->	5.8 - 6.1	5.9 - 6.9	6.6 - 7.4	3.7 - 4.1	2.7 - 2.9
Connector Series	59-MCV	6-MCV	6-MCVL	23 AWG	25 AWG
<b>Liberty</b>	20-CMR-VIDEO	18-CMP-VID	RG6-QUAD-CATV-WHT	23-YCLLSIAM	AVC-6-PLN*
	20-CMP-VID	RG6-P-CATV	RG6-CM	RGB-SOL-MINI	AVC14-PLN*
	RG59-CATV-PL		RG6-QUAD		AVC18-PLN*
	RG59-CCTV		QUADFLEX		RGB5C-PLN*
	RG59-18-2C		18-CMR		RGB5C-25CMP
	ELAN-CM-VIA		RG6-QUAD-PL		
	RG59-CCTV-PL		RG6-CCTV-PVC		
<b>Tappan</b>	C30022	C40009	C40009	C90032	H91925
	C30114	C40055	C40055	D90033	H91946
	H90369	C40055	C40055		H91924
	H91319	C40076	C40076		H91930
		D40019	D40019		
		H90454	H90454		
		H90767	H90767		
		H915578	H915578		
		H91569	H91569		
		SU4008	SU4008		
		SU4020	SU4020		
<b>Commscope</b>	2020K-V			7538	
	2036K-V			7538-B	
	5550				
	5553				
	5554				
	2054V				
<b>West Penn Cross</b>	815R	6100	6100	825*	WP258255
	819	6100	6100	2825	WP258263
	2815B	6150	6150	HD825	WP258265
	804	25Q841	25Q841	25825	253CRGB
	814	2806B	2806B	HD25825	255CRGB
	815	806R	806R	WP8253*	3CRGB
	819	AQC841	AQC841	WP8255*	5CRGB
	2814			45825	252825
	AQC815				
<b>Coleman / Signal</b>	99979	92003	92003	99401	
	92004	92003	92003	99403	
	92074			99405	
	991055			99415	
	991057			99425	
	993251			99426	
	339253			993211	
	993236				

## **X-ON Electronics**

Largest Supplier of Electrical and Electronic Components

*Click to view similar products for [holland electronics](#) manufacturer:*

Other Similar products are found below :

[CA-30/550](#) [FAM-16](#) [RCA59-MCV](#) [SLC59-BNC-1](#) [SLC-1855-RCAFPU](#) [DSG-3100](#) [SLC-1855FPU](#) [FAM-8](#) [DSG-2100/DSB-21G](#) [FAM-20](#)  
[SLC-1855-BNCFPU](#) [SLCU-6-1](#) [FAM-10](#) [FAM-3](#)