

## Lift-off Hinges

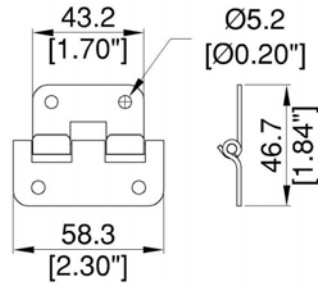
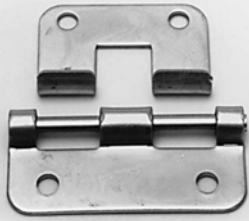

### P0625

Lift Off Hinge

Material: Steel

Part Number	Finish	Description
P0625K	Black	
P0625Z	Zinc	

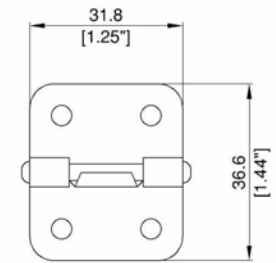
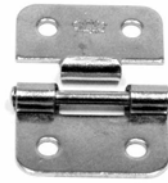

FIXING HOLES 4.3mm/.17"

### P0644

Lift Off Hinge.

Material: 1.2mm/ 18 gauge Steel

Part Number	Finish	Description
P0644N	Nickel	

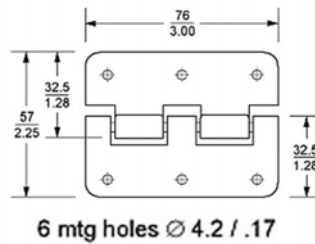

### 1993

Large Lift Off Hinge.

Special Order outside USA & China

Material: Steel

Part Number	Finish	Description
1993	Zinc	
1993BK	Black	

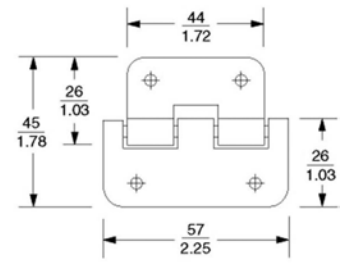
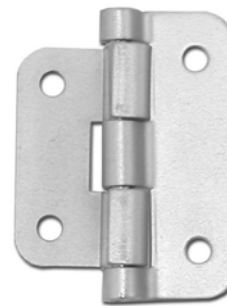

### 1519

Lift Off Hinge.

Special Order outside USA & China

Material: Steel

Part Number	Finish	Description
1519	Zinc	
1519BK	Black	
1519N	Nickel	

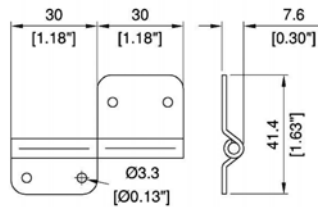

### 1460-1463

Slip Hinge. Allows for Easy Removal of Doors.

Available with Different Pin Lengths.

Special Order outside USA & China

Material: Steel

Part Number	Finish	Orientation	Pin
1460YZ	Yellow Zinc	Right	54mm/ 2.1"
1461YZ	Yellow Zinc	Left	54mm/ 2.1"
1462	Zinc		60mm/ 2.4"
1462YZ	Yellow Zinc	Right	60.5mm/ 2.4"
1463YZ	Yellow Zinc	Left	60.5mm/ 2.4"

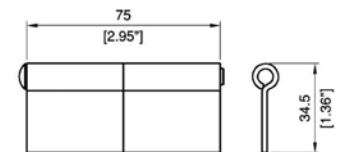

### 8389

Heavy Duty Stainless Steel Slip Hinge. Allows for Easy Removal of Doors.

Common on Stainless Steel Food Service Equipment.

Special Order outside USA & China

Material: Stainless Steel

Part Number	Finish	Description
8389SS	Stainless Steel	

## X-ON Electronics

Largest Supplier of Electrical and Electronic Components

*Click to view similar products for [Penn Elcom](#) manufacturer:*

Other Similar products are found below :

[RWB-1032-12UK](#) [RWB-1032-16UK](#) [H1008-BLK](#) [L905/927Z](#) [3232LK](#) [R6418-1032](#) [M154306](#) [5295](#) [G08](#) [G12](#) [3234LK](#) [R2100/2UK](#) [OR-4A6637](#) [M1552](#) [W9000-V6](#) [R0828/12](#) [R0828/16](#) [H1053Z](#) [H1024](#) [R8500-12](#) [D0604K](#) [R0828/18](#) [3233LK](#) [R0828/06](#) [8700/FANCORD](#)  
[R0821](#) [R1206/2U](#) [R0828/10](#) [F1554](#) [M1530](#) [R1194/2UK](#) [G10](#) [R1290/1U](#) [H0494](#) [G0780](#) [KIT](#) [M1500](#) [9106](#) [F1694](#) [R0828/14](#) [9112](#)  
[S1032/HP100](#) [G15](#) [M1701](#) [M1504](#) [EX-6301B](#) [R1206/1U](#) [H1053K](#) [C1824K](#) [R0828/21](#) [R0828/08](#)