

*Schroff*

# ADVANCEDMC CARRIERS

Cabinets ..... 1

Wall mounted cases ..... 2

Accessories for cabinets and wall mounted cases . 3

Climate control . 4

Electronics cases ..... 5

Subracks/ 19" chassis .... 6

Front panels, plug-in units ... 7

Systems ..... 8

Power supply units ..... 9

Backplanes ... 10

Connectors, front panel component system ..... 11

Appendix ..... 12

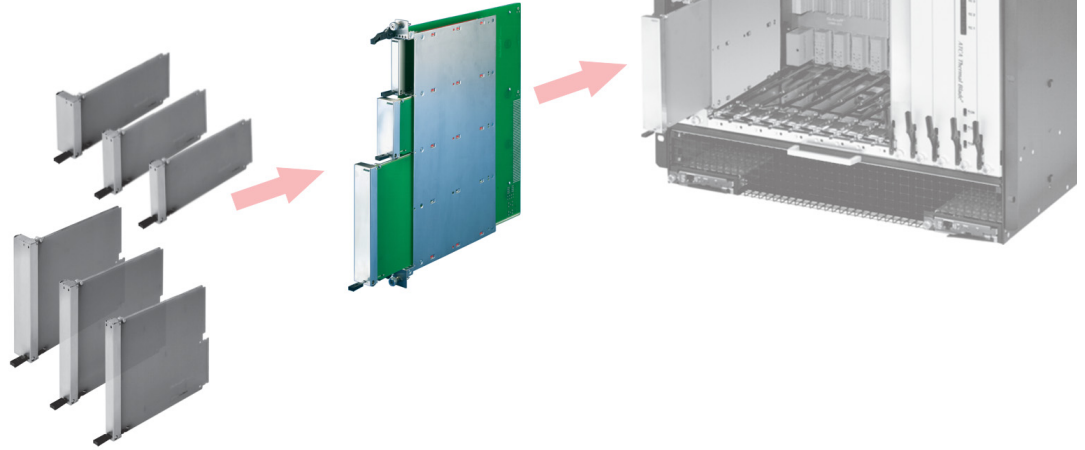

12806028

**AdvancedMC carriers**

AdvancedMC carriers are plug-in units that are slotted into an AdvancedTCA system. They contain the carrier board that accepts AdvancedMC modules.

Electrical connection to the AdvancedTCA backplane is via connectors. With the fully-assembled AdvancedMC carrier in place, cost-effective additional functions may be integrated into the system.

The standard, in accordance with PICMG specification AMC.0 R2.0, defines three different mechanical versions:

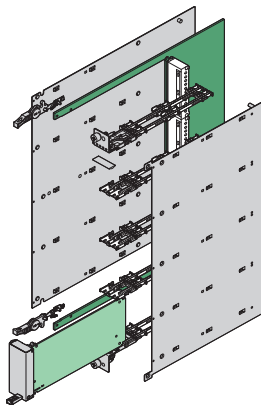

12805082

**Cutaway carrier**

- Carrier board is cut out in the area of the AdvancedMC modules
- Max. placement: 8 single compact or 4 single full-size AdvancedMC modules
- Combinations of full-size and compact modules are possible

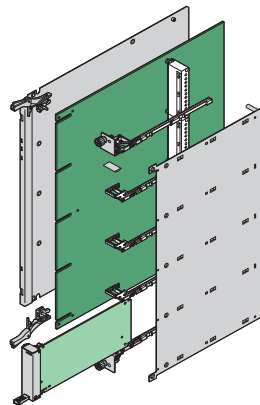

12805083

**Conventional carrier**

- Carrier board runs continuously from front to rear
- Max. placement: 4 single compact or 4 single mid-size AdvancedMC modules

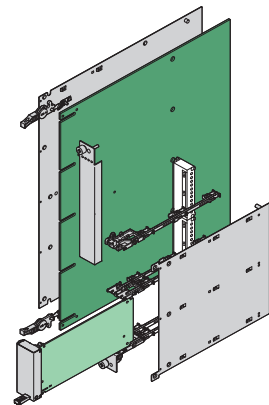

12805081

**Hybrid carrier**

- Carrier board is a combination of conventional and cutaway carrier
- The maximum placement depends on the carrier board design
- Combinations of all AdvancedMC modules are possible

# Systems – AdvancedMC carriers

## AdvancedMC carriers for AdvancedTCA systems

- Cutaway, conventional and hybrid carrier mechanics for
  - compact AdvancedMC carrier boards
  - Mid-size AdvancedMC carrier boards
  - Full-size AdvancedMC carrier boards
- Standard versions from stock
- Individual carrier/module combination of your choice



12867020

### AdvancedMC carriers

- 1 slot chassis, 8 U, 6 HP for AdvancedTCA systems
- Inserter/extractor handle for microswitch activation
- Versions
  - **Cutaway carrier** for compact and full-size modules
  - **Conventional carrier** for mid-size and compact modules

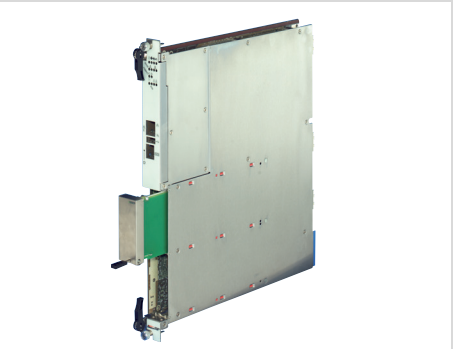

### Individual solutions on request

- AdvancedMC hybrid carrier
- AdvancedMC hybrid mechanics for rugged AdvancedMC modules (MicroTCA.1)



12812005 12806016

### Cutaway carriers

For compact and full-size modules

Complete kits .... 8.28

Kit without struts, guide rails ..... 8.29

Guide rails/struts 8.30

Microswitches ... 8.31

Differences between standard and MF handles for AMC carriers . 8.31

### Conventional carriers

For mid-size and compact modules

Complete kits with AdvancedTCA IEA handle ..... 8.32

Guide rails/struts 8.33

Microswitches ... 8.33

ServicePLUS .. 8.34

ServicePLUS configuration

Hybrid carrier .. 8.35

### ServicePLUS from page 8.34

- e.g. individual configuration and fitting of hybrid carriers)
- e.g. modifications (cut-outs, special colours)
- e.g. custom solutions (special sizes)

[www.schroff.biz/ServicePLUS](http://www.schroff.biz/ServicePLUS)



30407004

## Systems – AdvancedMC cutaway carrier

### Carrier mechanics for compact and full-size AdvancedMC modules

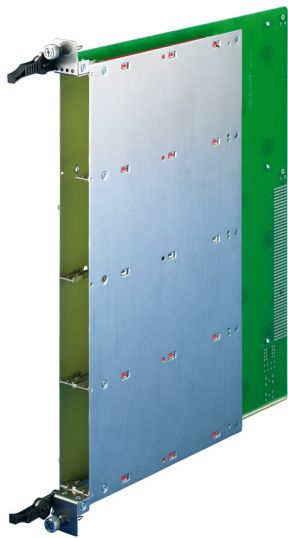

- Mechanics for cutaway carrier board (carrier **with** 3 different struts, guide rails, ESD clips)
- Stainless steel (EMC shielded)
- Width 1 slot (6 HP), height 8 U, corresponds to PICMG® AMC.0 R2.0
- Inserter/extractor handle, designed for microswitch activation hot-swap)

#### Delivery comprises (Kit)

Item	Qty	Description
1	1	Cover plate B (right), stainless steel, brushed, 0.6 mm, inner surface electrically insulated, exterior with protective film
2	1	Cover plate A (left), stainless steel, brushed, 0.6 mm, inner surface electrically insulated, exterior with protective film
3	1	Lower splitting extrusion (strut), Zn die-cast, nickel-plated
4	1	Upper splitting extrusion (strut), Zn die-cast, nickel-plated
5	1	Lower front panel, stainless steel, brushed, 1 mm, alignment pin and retention screws pressed in
6	1	Upper front panel, stainless steel, brushed, 1 mm, alignment pin and retention screws pressed in, with holes for LEDs
7	1	Standard inserter/extractor handle, with microswitch operation, plastic lever, black
8	1	Standard inserter/extractor handle, plastic lever, black
9	1	EMC profile seal, core: foam, sleeve: textile cladding with CuNi coating
10	3	Support member between cover A and B
11	3	Support member for cover A (on the left)
12	3	Support member for cover B (on the right)
13	8	ESD clip
14	10	AdvancedMC guide rail, PBT, UL 94 V-0, red
15	1	Assembly kit

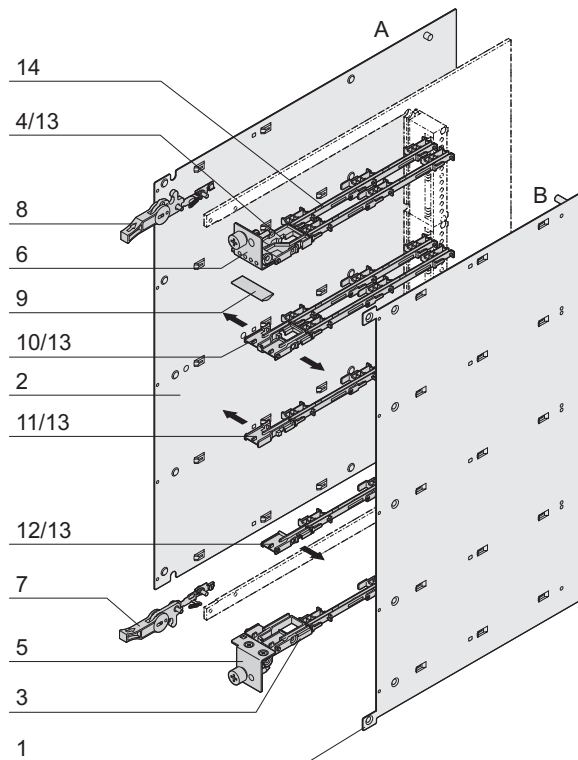

12805002

#### Order Information

Description	Part no.
Carrier mechanics for AdvancedMC compact and full-size modules <b>with</b> struts, ESD clips and guide rails	<b>10849-001</b>
<b>Accessories</b>	
<b>Microswitch, normally closed, for AdvancedMC carrier (compact and full-size modules)</b> for soldering (SMD), PU 10 pieces	<b>20849-236</b>
<b>Microswitch, normally open, for AdvancedMC carrier (compact and full-size modules)</b> for soldering (SMD), PU 10 pieces	<b>20849-235</b>
<b>Description inserter/extractor handle</b>	<b>Page 8.31</b>
<b>Microswitch description</b>	<b>Page 8.31</b>
<b>AdvancedMC module mechanics</b>	<b>Page 8.56</b>

12807086



ServicePLUS see page 8.34

## Systems – AdvancedMC cutaway carrier

### Carrier mechanics for compact and full-size AdvancedMC modules

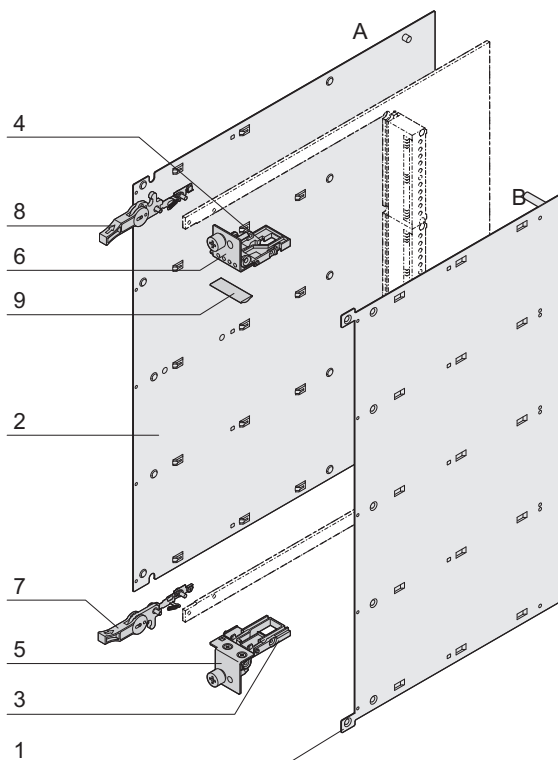
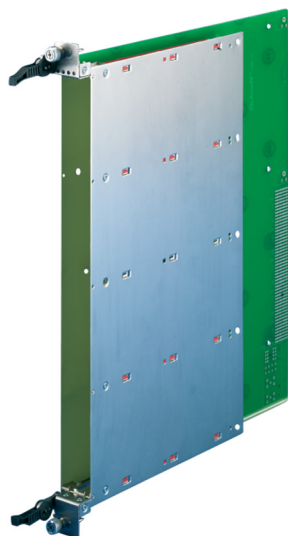

- Mechanics for cutaway carrier board (carrier **without** struts, guide rails, ESD clips, for individual placement)
- Stainless steel (EMC shielded)
- Width 1 slot (6 HP), height 8 U, corresponds to PICMG® AMC.0 R2.0
- Inserter/extractor handle, designed for microswitch activation (hot-swap)

#### Delivery comprises (Kit)

Item	Qty	Description
1	1	Cover plate B (right), stainless steel, brushed, 0.6 mm, inner surface electrically insulated, exterior with protective film
2	1	Cover plate A (left), stainless steel, brushed, 0.6 mm, inner surface electrically insulated, exterior with protective film
3	1	Lower splitting extrusion (strut), Zn die-cast, nickel-plated
4	1	Upper splitting extrusion (strut), Zn die-cast, nickel-plated
5	1	Lower front panel, stainless steel, brushed, 1 mm, alignment pin and retention screws pressed in
6	1	Upper front panel, stainless steel, brushed, 1 mm, alignment pin and retention screws pressed in, with holes for LEDs
7	1	Standard inserter/extractor handle, with microswitch operation, plastic lever, black
8	1	Standard inserter/extractor handle, plastic lever, black
9	1	EMC profile seal, core: foam, sleeve: textile cladding with CuNi coating
10	1	Assembly kit

#### Order Information

Description	Part no.
Carrier mechanics for AdvancedMC compact and full-size modules without struts, ESD clips and guide rails	<b>10849-002</b>
<b>Accessories</b>	
<b>Microswitch, normally closed, for AdvancedMC carrier (compact and full-size modules)</b> for soldering (SMD), PU 10 pieces	<b>20849-236</b>
<b>Microswitch, normally open, for AdvancedMC carrier (compact and full-size modules)</b> for soldering (SMD), PU 10 pieces	<b>20849-235</b>
<b>Further struts, ESD clips and guide rails</b>	<b>Page 8.30</b>
<b>Description inserter/extractor handle</b>	<b>Page 8.31</b>
<b>Microswitch description</b>	<b>Page 8.31</b>
<b>AdvancedMC module mechanics</b>	<b>Page 8.56</b>



ServicePLUS see page 8.34

## Systems – AdvancedMC cutaway carrier

### Board guides/struts for AdvancedMC compact and full-size modules

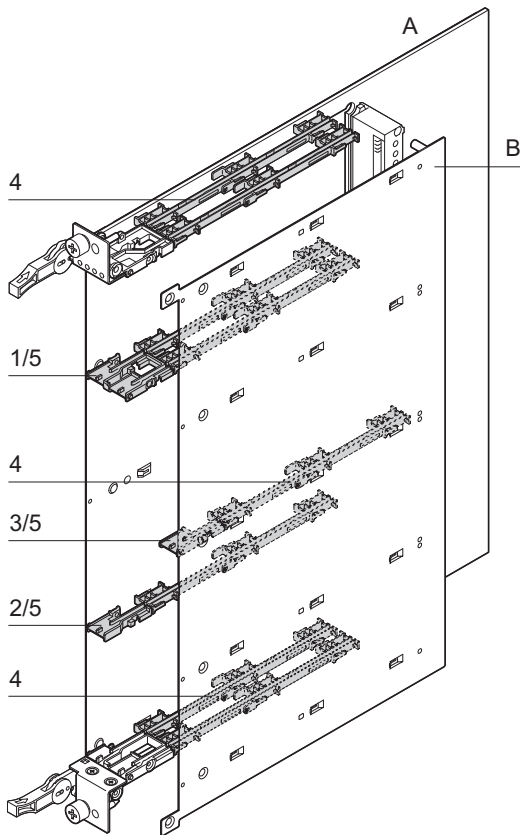

- Struts and guide rails are always required to guide boards
- 3 different struts
  - The strut is assembled between the cover plates A and B
  - The strut is assembled on the left of cover plate A
  - The strut is assembled on the right of cover plate B
- The ESD clip pushes into the strut (one per board guide)
- The guide rails clip into the cover plate

#### Order Information

Item	Description	Qty/PU	Part no.
1	Strut between cover A (left) and B (right), Zn die-cast, nickel-plated	10	20849-009
2	Splitting extrusion (strut) for cover A (left), Zn die-cast, nickel-plated	10	20849-010
3	Splitting extrusion (strut) for cover B (on the right), Zn die-cast, nickel-plated	10	20849-011
4	AdvancedMC guide rail, PBT, UL 94 V-0, red	10	20849-008
5	ESD clip, stainless spring steel, for deflection of electrostatic charges	50	20849-021

#### Accessories

**Microswitch, normally closed, for AdvancedMC carrier (compact and full-size modules)** 20849-236  
for soldering (SMD), PU 10 pieces, page 8.31

**Microswitch, normally open, for AdvancedMC carrier (compact and full-size modules)** 20849-235  
for soldering (SMD), PU 10 pieces - page 8.31

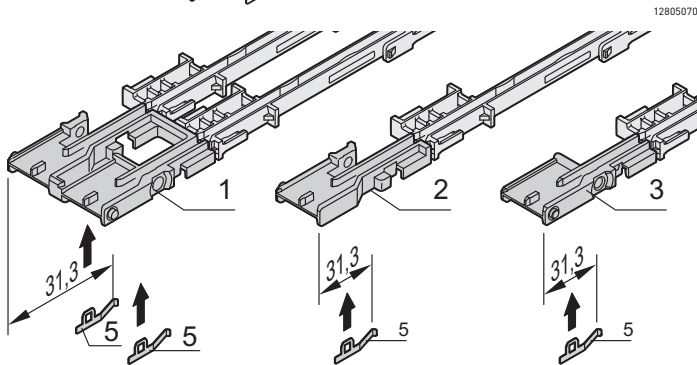

12805071



ServicePLUS see page 8.34



**Systems – AdvancedMC cutaway carrier**

**Microswitch for carrier (compact and full-size AdvancedMC modules)**

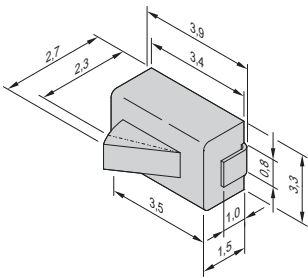

12807066

■ Microswitch for soldering (SMD)

**Order Information**

Description	Qty/PU	Part no.
Microswitch, <b>normally closed</b> , for AdvancedMC carrier (compact and full-size modules)	10	<b>20849-236</b>
Microswitch, <b>normally open</b> , for AdvancedMC carrier (compact and full-size modules)	10	<b>20849-235</b>

**Technical data**

Max. switch current	1 mA, 5 V <sub>DC</sub>
Operating temperature	-15 °C ... +70 °C
Electrical lifespan	10 <sup>5</sup> switching cycles

"Normally closed"

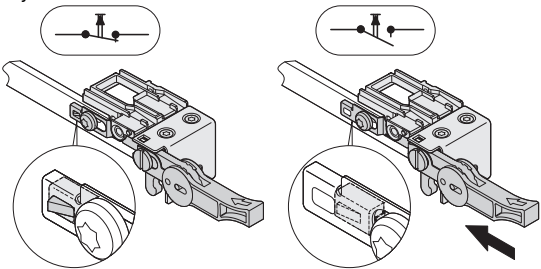

12807081

Handle in inoperative position

Handle activated

Closer

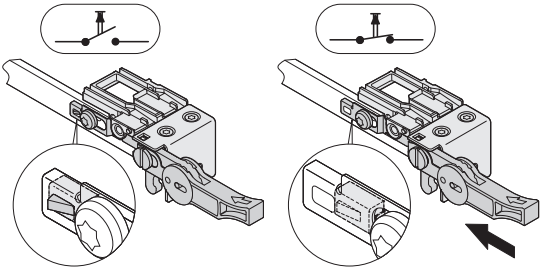

12807082

Handle in inoperative position

Handle activated

**Differences between standard and MF handle for AdvancedMC carrier (compact and full-size modules)**

**Standard front handle** - is included in delivery of carriers for compact and full-size modules

**MF handle** - can be exchanged by standard handle if needed (available on request)

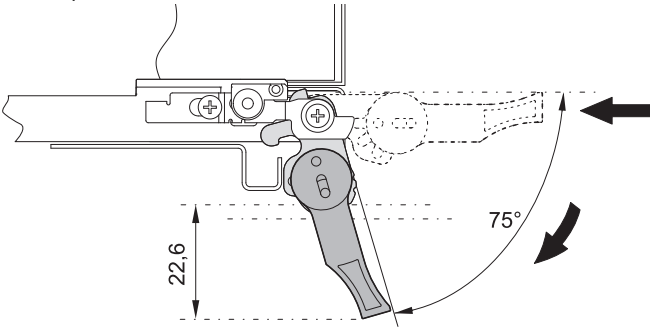

12806063

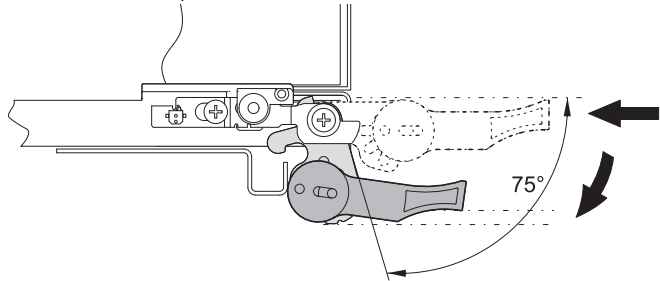

12805072

- Extractor handle 75° opening angle
- Insertion/extraction in one step
- Swing range: 23 mm below and above the pitch line
- Included in delivery of carrier

- Extractor handle 75° opening angle
- Insertion/extraction in three steps (2 operations)
- Small swing range (0 mm) below and above the pitch line. The lower respectively upper limit of the carrier is not exceeded during extraction.

## Systems – AdvancedMC conventional carrier

### Carrier mechanism for mid-size AdvancedMC modules with AdvancedTCA IEA handle, complete kit

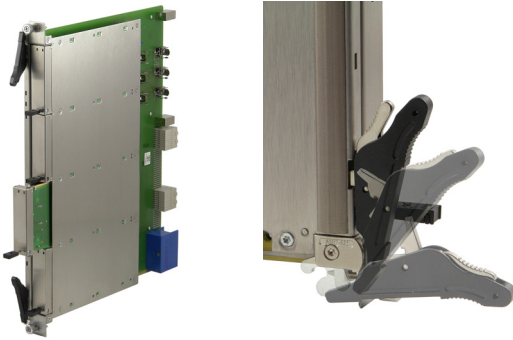

12808001 12808002

- Mechanics for conventional carrier, stainless steel (EMC shielded)
- Width 1 slot (6 HP), height 8 U, corresponds to PICMG® AMC.0 R2.0
- AdvancedTCA IEA inserter/extractor handle, designed for microswitch activation (hot-swap)
- Carrier mechanics with struts and guide rails for four modules

#### Delivery comprises (Kit)

Item	Qty	Description
1	1	Cover plate B (right), stainless steel, brushed, 0.6 mm, inner surface electrically insulated, exterior with protective film
2	1	Cover plate A (left), stainless steel, brushed, 0.6 mm, inner surface electrically insulated, exterior with protective film
3	1	Lower splitting extrusion (strut), Zn die-cast, nickel-plated
4	1	Upper splitting extrusion (strut), Zn die-cast, nickel-plated
5	1	Lower front panel, stainless steel, brushed, 1 mm, alignment pin and retention screws pressed in
6	1	Upper front panel, stainless steel, brushed, 1 mm, alignment pin and retention screws pressed in
7	1	Lower AdvancedTCA IEA inserter/extractor handle, with microswitch activation, plastic lever, black
8	1	AdvancedTCA IEA inserter/extractor handle, top, with microswitch activation, lever plastic, black
9	1	EMC profile seal, core: foam, sleeve: textile cladding with CuNi coating
10	1	EMC profile seal, core: foam, sleeve: textile cladding with CuNi coating
11	3	Splitting extrusion between covers A and B (4 ESD clips)
12	5	AdvancedMC guide rail, PBT, UL 94 V-0, green
13	1	Fixing material kit

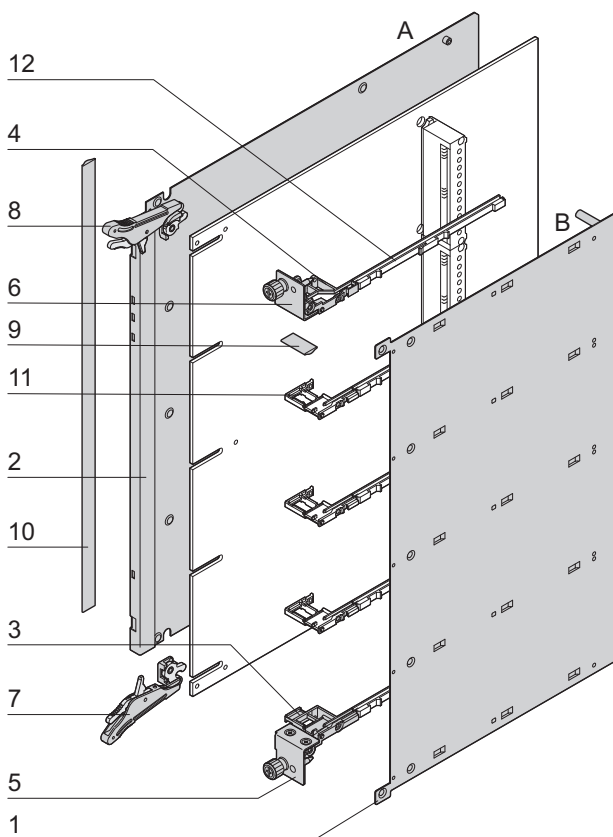

12808050

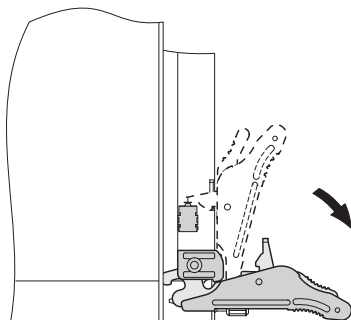

12808051

#### Order Information

Description	Part no.
AdvancedMC carrier mechanism for mid-size AdvancedMC modules with AdvancedTCA IEA handle with struts, ESD clips and guide rails	10849-011

#### Accessories

<b>Microswitch for carriers (mid-size AdvancedMC modules)</b> normally closed, for soldering (SMD), PU 10 pieces	20817-853
<b>Microswitch for carriers (mid-size AdvancedMC modules)</b> normally open, for soldering (SMD), PU 10 pieces	20817-909

<b>AdvancedMC module mechanics</b>	Page 8.56
------------------------------------	-----------

#### Note

- Carrier with stronger cover plate A (1 mm) on request
- Carrier for compact AdvancedMC modules on request
- Southco type handle kit on request



ServicePLUS see page 8.34



Systems – AdvancedMC conventional carrier

Board guides/struts for AdvancedMC mid-size modules

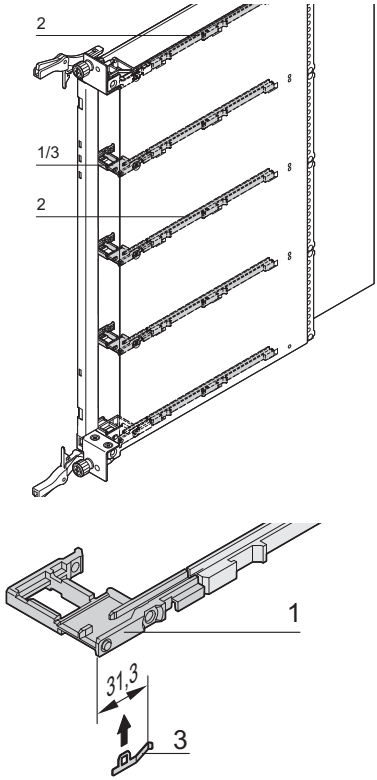

12806061

12806062

- Struts and guide rails are always required to guide boards
- Strut is assembled between cover plates A and B
- The ESD clip pushes into the strut (one per board guide)
- The guide rails clip into the cover plate

Order Information

Item	Description	Qty/PU	Part no.
1	Strut between cover A (left) and B (right), Zn die-cast, nickel-plated	10	<b>20849-242</b>
2	AdvancedMC guide rail for mid-size carrier, PBT, UL 94 V-0, green	10	<b>20849-166</b>
3	ESD clip, stainless spring steel, for deflection of electrostatic charges	50	<b>20849-021</b>

Microswitch for carriers (mid-size AdvancedMC modules)

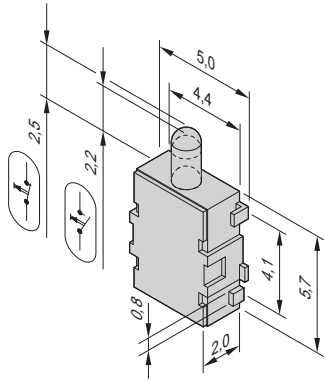

12807071

- Microswitch for soldering (SMD)
- Can be used for all conventional carrier handles

Order Information

Description	Qty/PU	Part no.
Microswitch ( <b>normally closed</b> ) for carrier (mid-size AdvancedMC modules)	10	<b>20817-853</b>
Microswitch ( <b>normally open</b> ) for carrier (mid-size AdvancedMC modules)	10	<b>20817-909</b>

Technical data

Max. switch current	100 mA, 12 V <sub>DC</sub>
Operating temperature	-20 °C ... +60 °C
Electrical lifespan	5 x 10 <sup>5</sup> switching cycles

Opener

Closer

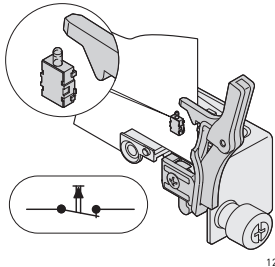

12807079

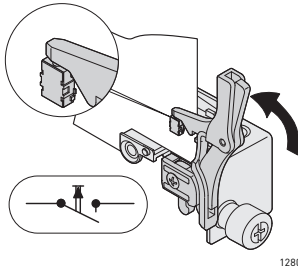

12807087

## Systems – AdvancedMC carrier ServicePLUS



### modification

**Small changes. Large impact.**

Custom drillings, cut-outs and special colours for off-the-shelf products

- Mechanical modifications
- Ready to send within 10 working days



### solution

**Simple. Fast. From one source.**

Integration and custom developments

- Customised complete solutions

## Systems – AdvancedMC carrier ServicePLUS

### ServicePLUS: solution

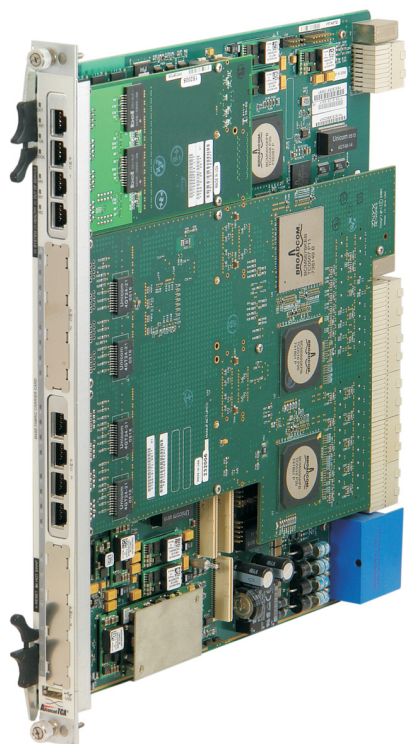

12812004

### AdvancedMC carrier mechanics

- The carrier board is a combination of conventional and cutaway carriers
- Max. placement depends on the design of the carrier board
- Custom versions on request
  - Single/double combinations
  - Handles
  - AdvancedTCA IEA
  - AdvancedTCA Southco

## Appendix – Order notes

### Packaging units

A packaging unit (PU) - e.g. carton, bag - contains the stated quantity. If you order the quantity 1, you will automatically receive the quantity defined as PU.

Example: EMC textile gasket  
See page 5.22  
Part number 21101-853

Quantity (per part number): 10 pieces

Order quantity: . . . . . Delivery quantity:

1 . . . . .	10 pieces
2 . . . . .	20 pieces
3 . . . . .	30 pieces

### Price list

Our price list is available by e-mail from your customer consultant. Please find all contact details at [www.schroff.biz/contact](http://www.schroff.biz/contact).

### Always up-to-date

Please visit our website [www.schroff.biz](http://www.schroff.biz) where we continuously inform about news and technical changes.

### Quick links

**Catalogue request:** [www.schroff.biz/catalogues](http://www.schroff.biz/catalogues)

**Product configurators:** [www.schroff.biz/conf](http://www.schroff.biz/conf)

**Contact details:** [www.schroff.biz/contact](http://www.schroff.biz/contact)

**Product search:** [www.schroff.biz/oneclick](http://www.schroff.biz/oneclick)

**Front Panel Express:** [www.frontpanelexpress.eu](http://www.frontpanelexpress.eu)

**VARISTAR:** [www.varistar.co.uk](http://www.varistar.co.uk)

**Railway technology:** [www.schroff.co.uk/railway](http://www.schroff.co.uk/railway)

**IT Infrastructure:** [www.schroff.co.uk/datacom](http://www.schroff.co.uk/datacom)

### Standard pack quantity (SPQ)

Please take into consideration that deliveries may be carried out in the stated SPQs (SPQ, e.g. 5 pieces, 10 pieces, 50 pieces, etc.). Differing order quantities (e.g. 2 pieces) may be changed to the next possible delivery quantity = Standard Pack Quantity (in this case 10 pieces).

Example: Front horizontal rail  
See page 5.31  
Part number 34560-228

Quantity (per part number): 1 piece  
Standard pack quantity (SPQ): 10 pieces

Order quantity: . . . . . Delivery quantity:

≤ 10 . . . . .	10 pieces
> 10 ≤ 20 . . . . .	20 pieces
> 20 ≤ 30 . . . . .	30 pieces

### Delivery times

Part numbers in bold face type are ready for despatch within 2 working days; part numbers in normal type are ready for despatch within 10 working days.

### Business relations

Schroff is exclusively operating in Business to Business (B2B). Private individuals can buy Schroff products via our sales representatives (see [www.schroff.biz/contact](http://www.schroff.biz/contact)).

### Responsible for contents and print

Schroff GmbH, Marketing Communication,  
D-75334 Straubenhardt, Germany

The data in this catalogue have been thoroughly edited and checked - in assistance with an accredited Quality Management System in accordance with EN ISO 9001:2008.

Faults and spelling mistakes, but mainly changes due to improvements and further developments of our products are subject to change. There is no possibility to claim indemnity/compensation.

<b>Cabinets</b>	Overview.....	1.0	LHX 20/40 Air/water heat exchangers.....	1.224	<b>1</b>
	Varistar Cabinet platform.....	1.2	LHX 3 Air/water heat exchangers.....	1.236	
	Varistar Electronics.....	1.10	Novastar.....	1.240	
	Varistar EMC.....	1.54	Eurorack.....	1.270	
	Varistar Seismic.....	1.84	Outdoor.....	1.316	
	Varistar MIL.....	1.120	Etsirack.....	1.346	
	Varistar Data/network systems.....	1.124	19" lab racks.....	1.354	
	Varistar Containment.....	1.202	PROLINE.....	1.362	
<b>Wall mounted case</b>	Overview.....	2.0			<b>2</b>
	Epcase.....	2.36			
	LAN wall-mounted distributors.....	2.46			
<b>Cabinet and wall-mounted case accessories</b>	Overview.....	3.0	Monitors, keyboards, monitoring.....	3.44	<b>3</b>
	Mechanics.....	3.2	Socket strips.....	3.50	
	Telescopic slides.....	3.24	Power control socket strips.....	3.72	
	Electrical.....	3.29			
<b>Climate control</b>	Overview.....	4.0	Accessories.....	4.58	<b>4</b>
	Cooling concepts/service.....	4.2			
	19" fan trays.....	4.4			
	Air filtered fans.....	4.20			
<b>Desktop enclosures</b>	Overview.....	5.0	Comptec.....	5.100	<b>5</b>
	RatiopacPRO.....	5.6	Accessories.....	5.108	
	PropacPRO.....	5.44	Interscale.....	5.200	
	CompacPRO.....	5.76	Minipac.....	5.230	
<b>Subracks/ 19" chassis</b>	Overview.....	6.0	EuropacPRO industrial applications.....	6.86	<b>6</b>
	EuropacPRO.....	6.2	EuropacPRO Rugged.....	6.92	
	EuropacPRO for railroad applications.....	6.70	MultipacPRO.....	6.112	
			Inpac.....	6.128	
<b>Front panels, Plug-in-units, Frame type plug-in-units</b>	Overview.....	7.0	PCB accessories.....	7.102	<b>7</b>
	Front panels.....	7.2			
	Plug-in units.....	7.16			
	Frame type plug-in units.....	7.64			
<b>Systems</b>	Overview.....	8.0	AdvancedMC modules.....	8.56	<b>8</b>
	AdvancedTCA.....	8.2	CompactPCI, Serial, PlusIO, PSB.....	8.68	
	AdvancedMC carriers.....	8.26	VME, VME64x, VXS, VPX.....	8.88	
	MicroTCA.....	8.36	Accessories.....	8.106	
<b>Power supply systems</b>	Overview.....	9.0	19" accessories.....	9.18	<b>9</b>
	19" AC/DC switched-mode PSUs.....	9.2	PSUs for MicroTCA.....	9.20	
	19" AC/DC linear regulators.....	9.12	PSUs for VMEbus.....	9.22	
	19" AC/DC convertors.....	9.15	PSUs for CompactPCI, VME64x.....	9.24	
<b>Backplanes</b>	Overview.....	10.0	VME64x, VMEbus.....	10.15	<b>10</b>
	CompactPCI, Serial, PlusIO.....	10.4	Power.....	10.18	
	PXI.....	10.11	Universal.....	10.19	
	VXS.....	10.14	Test adaptors.....	10.20	
<b>Connectors, Front panel component systems</b>	Overview.....	11.0			<b>11</b>
	Connectors.....	11.2			
	Front panel component system.....	11.12			
<b>Appendix</b>	Standards abbreviations.....	12.0			<b>12</b>
	Notes on ordering.....	12.10			
	Order number index.....	12.11			
	Product index.....	12.62			

## **X-ON Electronics**

Largest Supplier of Electrical and Electronic Components

*Click to view similar products for [schroff](#) manufacturer:*

Other Similar products are found below :

[24566-125](#) [14575171](#) [14575271](#) [14576145](#) [14575265](#) [20117-156](#) [20817772](#) [20827088](#) [20846211](#) [20860229](#) [21100777](#) [23022602](#) [23130082](#)

[24571331](#) [24571586](#) [24572066](#) [24822075](#) [26230-374](#) [30817-001](#) [30825080](#) [20849021](#) [20860240](#) [23001021](#) [24560080](#) [24571303](#)

[24572054](#) [24572056](#) [30219-113](#) [20848-410](#) [20838-125](#) [20860-601](#) [20860-633](#) [10225-602](#) [10225-623](#) [10828058](#) [13100103](#) [28230-439-C](#)

[24563-457](#) [24563-444](#) [20848-601](#) [21101-853](#) [20818-020](#) [21101-847](#) [24563-134](#) [24564-431](#) [24827-107](#) [24563-142](#) [24563-157](#) [24563-442](#)

[A265HC-5.80EH](#)