



ELECTRONICS, INC.
44 FARRAND STREET
BLOOMFIELD, NJ 07003
(973) 748-5089
<http://www.nteinc.com>



NTE7213 Integrated Circuit Vertical Deflection Output BUS Supporting with E/W Drive

Description:

The NTE7213 is an E/W Drive and Vertical Deflection Output integrated circuit in a 10-Lead SIP type package designed for use in high-definition TV and CRT displays in systems that use a BUS control system signal-processing IC. This device can directly drive (including DC component) the deflection yoke from the sawtooth wave output from the BUS control system signal-processing IC. Similarly, the diode modulator block can be driven from the parabolic wave output.

Features:

- Built-In Charge Pump Circuit for Low Power Operation
- Vertical Output Circuit
- Excellent Crossover Characteristics
- Supports DC Coupling
- E/W Drive Circuit

Pin Connection Diagram
(Front View)

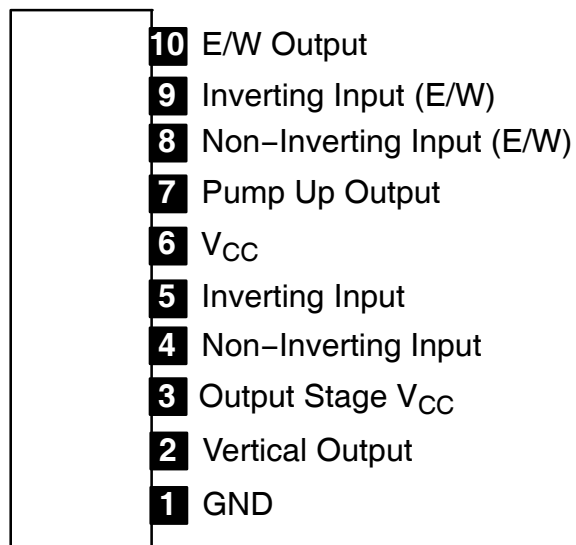

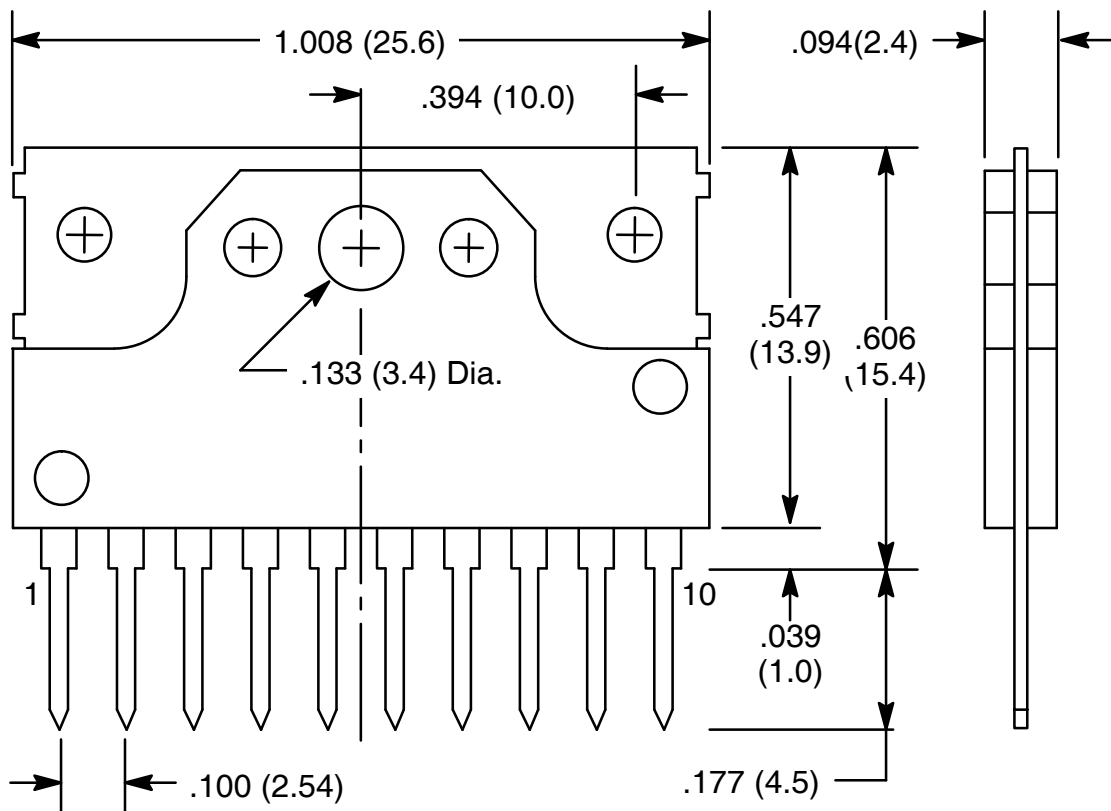

X-ON Electronics

Largest Supplier of Electrical and Electronic Components

Click to view similar products for [nte manufacturer](#):

Other Similar products are found below :

[747](#) [797](#) [868](#) [1724](#) [NEH680M50FE](#) [NEHH1.0M450CB](#) [NTE48](#) [NTE526A](#) [228A](#) [231](#) [954](#) [2023](#) [47-20848-R](#) [510](#) [R04-11A30-120](#) [04-SLPE3750A](#) [5615](#) [591](#) [7056](#) [NTE5710](#) [7448](#) [NEH.10M50AA](#) [NEH2.2M63AA](#) [NEH330M35DD](#) [NEH33M10AA](#) [NEV.22M100AA](#) [TP0006-100](#) [NTE182](#) [NTE528](#) [NTE542](#) [NTE74154](#) [WH20-02-25](#) [04-SCBW25L-BK](#) [04-SCBW32L-BK](#) [04-SCW10C-BK](#) [04-SCBW19L-GR](#) [04-SCW19L-WH](#) [04-SCW19L-OR](#) [04-SCW38L-WH](#) [04-SCBW50L-OR](#) [04-SCBW50L-GR](#) [04-SCW10C-GR](#) [04-SCW10C-OR](#) [04-SCBW32L-GR](#) [04-SCBW32L-WH](#) [04-SCBW32L-OR](#) [04-SCBW6C-WH](#) [04-SCBW6C-GR](#) [04-SCBW6C-OR](#) [04-SCBW25L-GR](#)