

Plug SLS2-F

Stackable, Ø 2 mm hollow plugs for self-assembly of test leads.

Solder connection.

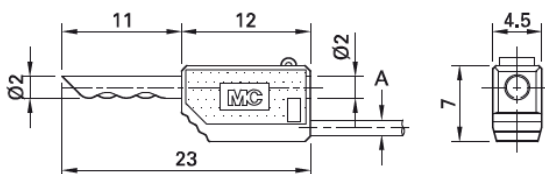
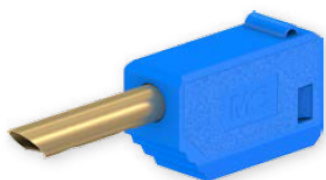

Assembly instructions MA133

www.staubli.com/electrical

Order No.	Type	Rated voltage/current	Cable (A)		*Colors																					
22.2611-*	SLS2-F	30 VAC / 10 A 60 VDC / 10 A	<table border="0"> <tr> <td>PVC</td> <td>TPE</td> <td>Ø 2.1 mm</td> <td rowspan="2">0.5 mm²</td> <td rowspan="2">Au</td> <td rowspan="2"> <table border="0"> <tr> <td>21</td> <td>22</td> <td>23</td> <td>24</td> <td>25</td> </tr> <tr> <td>27</td> <td>29</td> <td></td> <td></td> <td></td> </tr> </table> </td> </tr> <tr> <td>SIL</td> <td></td> <td>Ø 2.3 mm</td> <td></td> <td></td> </tr> </table>	PVC	TPE	Ø 2.1 mm	0.5 mm ²	Au	<table border="0"> <tr> <td>21</td> <td>22</td> <td>23</td> <td>24</td> <td>25</td> </tr> <tr> <td>27</td> <td>29</td> <td></td> <td></td> <td></td> </tr> </table>	21	22	23	24	25	27	29				SIL		Ø 2.3 mm				
PVC	TPE	Ø 2.1 mm	0.5 mm ²	Au	<table border="0"> <tr> <td>21</td> <td>22</td> <td>23</td> <td>24</td> <td>25</td> </tr> <tr> <td>27</td> <td>29</td> <td></td> <td></td> <td></td> </tr> </table>	21				22	23	24	25	27	29											
21	22	23				24	25																			
27	29																									
SIL		Ø 2.3 mm																								

Component parts

22.2020-*	KT2-F	Insulator
22.1006	LS2-F	Plug

X-ON Electronics

Largest Supplier of Electrical and Electronic Components

Click to view similar products for [staubli manufacturer](#):

Other Similar products are found below :

[23.3070-21,+ -22,+ -23,+ -24,+ -25](#) [61.7607-21 25M](#) [66.9706-21](#) [63.9358-22](#) [28.0127-10027](#) [49.0126-05023](#) [49.0126-20024](#) [28.0124-20029](#)
[22.2633-23](#) [23.3020-28](#) [66.9407-05028](#) [49.7049-24](#) [60.7008-999-21](#) [61.7664-999-23](#) [61.7612-100-22](#) [14.0034-29](#) [23.0440-21](#) [28.0116-](#)
[05022](#) [28.0116-05023](#) [24.0224-21](#) [65.9098-21](#) [64.9214-2122](#) [23.3060-24](#) [67.9799-22](#) [61.7607-29 25M](#) [23.3120-28](#) [49.0126-05024](#) [49.0126-](#)
[05025](#) [49.0079-05023](#) [66.9392-15022](#) [66.9407-05027](#) [66.9408-10028](#) [67.9770-100-21](#) [22.1027 & 22.2380-23](#) [61.7611-100-33](#) [60.7018-100-](#)
[21](#) [28.0116-20022](#) [28.0125-02522](#) [66.9328-25](#) [65.3314-21,+ -22,+ -23,+ -24,+ -25,+ -29](#) [22.3006-21](#) [28.0055-05024](#) [23.3120-20](#) [49.0126-](#)
[02525](#) [28.0126-05024](#) [28.0126-20020](#) [28.0124-05020](#) [28.0125-05021](#) [28.0125-20023](#) [22.2656-25](#)