

DESIGNED: 胡金花 DATE: 2016.09.09	X.±5.0°	X.±0.30
CHECKED: 曹熙 DATE: 2016.09.09	X.±3.0°	.X±0.25
CO SIGNED: 劉北平 DATE: 2016.09.09	.XX±2.0°	.XX±0.15
APPROVED: 李輝 DATE: 2016.09.09	.XXX±1.0°	.XXX±0.10

DWG. NO. CSEC202-CA1CA	PART NO. CSEC202-XXXX A001C1AX
------------------------	--------------------------------

TITLE: 1.27 FEMALE HEADER
DUAL ROWS SMT TYPE
BASE 4.40H

Ordering Information

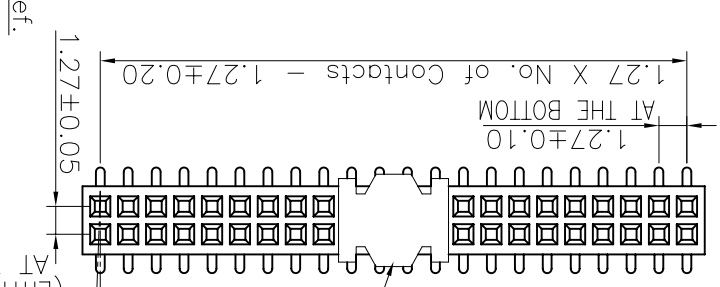
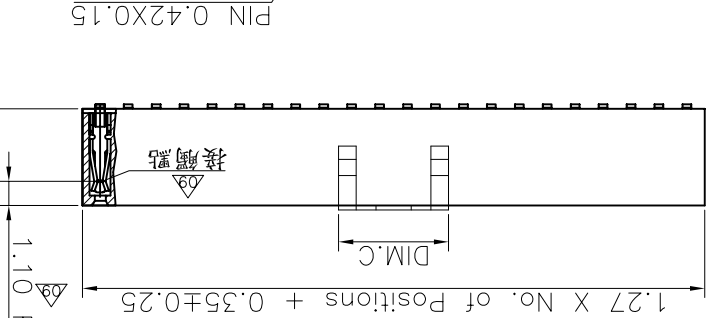
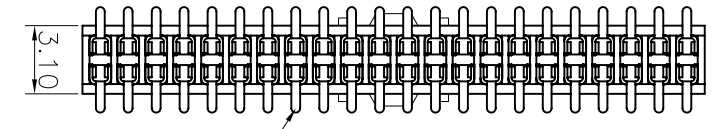

DIM.C	NOTE
4mm	02~03PIN
5mm	04~50PIN

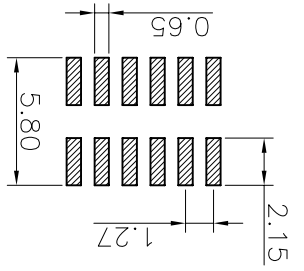

Recommended P.C.Board Layout
(Tolerance:±0.05)

The cap is used above 4pins
2 MAX SWAY
(EITHER DIRECTION)
2.3pins with tape&reel packing

Acetate tape
(φ3.50X0.15)

Specifications
Current Rating:1.0amp
Insulation Resistance:1000MΩmin.
Dielectric Withstanding Voltage:300VAC
Contact Resistance:20mΩMax.
Operating Temperature:-40°C to +125°C
Materials
Contact Material:Phosphor Bronze
Insulator Material:High Temperature Thermoplastic, UL 94V-0 LCP
or the equivalent material
All materials must meet Greenconn requirement for environment protection.

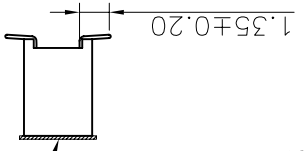
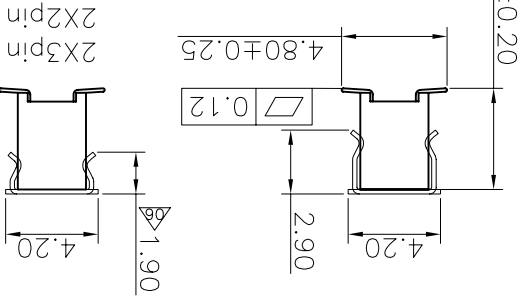

REV.	LOCAS.	DESCRIPTION	DATE	DRAWN
09		標註接觸點位置.	2013.04.17	楊海
10		因業務同處方形膠紙改圖形膠紙,故變更膠紙配方.	2013.10.10	邱明周
11		依業務要求,變更操作溫度範圍	2015.11.07	胡金花
12		依業務要求,增加02pin號CAP信息	2016.09.09	胡金花

X-ON Electronics

Largest Supplier of Electrical and Electronic Components

Click to view similar products for [greenconn](#) manufacturer:

Other Similar products are found below :

[GBEC201-3479B001C1AF](#) [CBEC219-0679B001C1AF](#) [GPEA214-1002A005C1BA](#) [GPED201-0802A005C1BC](#) [CBEC220-1379B001C1AF](#)
[GBEC201-1379B001C1AF](#) [CBEC219-1379B001C1AF](#) [GPEA214-0802A005C1BA](#) [CSEC202-2002A001C1AC](#) [CBEC220-0679B001C1AF](#)
[CBEC220-3479B001C1AF](#) [GPEB213-0502A018C1BC](#) [CBEC219-3479B001C1AF](#) [CSEB202-1002A001C1AC](#) [CSEB202-2502A001C1AC](#)
[CSEC208-0502A001C1AC](#) [GBEC202-0679B001C1AF](#) [CBEC219-2579B001C1AF](#) [GPED201-2502A005C1BC](#) [CSEB202-0802A001C1AC](#)
[GPEB213-1002A018C1BC](#) [CSEA202-2502A001C1AC](#) [CBEC219-4079B001C1AF](#) [GPEA214-2502A005C1BA](#) [CSEA202-2002A001C1AC](#)
[GBEC201-2579B001C1AF](#) [CBEC220-2579B001C1AF](#) [GBEC202-2579B001C1AF](#) [GPEA214-2002A005C1BA](#) [GPED201-1002A005C1BC](#)
[GBEC201-4079B001C1AF](#) [CBEC220-4079B001C1AF](#) [GBEC202-4079B001C1AF](#) [GBEC202-1379B001C1AF](#) [GBEC202-3479B001C1AF](#)
[GPEB213-2002A018C1BC](#) [CSEC208-1002A001C1AC](#) [CSEC208-2002A001C1AC](#) [CSEB202-2002A001C1AC](#) [GPED201-2002A005C1BC](#)
[GPEB213-2502A018C1BC](#) [CSEC208-2502A001C1AC](#) [GPEC214-2502B009C1BC](#) [CBEC201-0679B001C1AF](#) [CBEC201-2579B001C1AF](#)
[CBEC201-3479B001C1AF](#) [CBEC201-1379B001C1AF](#) [CBEC201-4079B001C1AF](#) [GBED202-2579B001C1AD](#) [CBED201-1379B001C1AD](#)