

Dimensions mm[inch]
tolerances acc. to DIN ISO 2768-m
Toleranzen gem. DIN ISO 2768-m

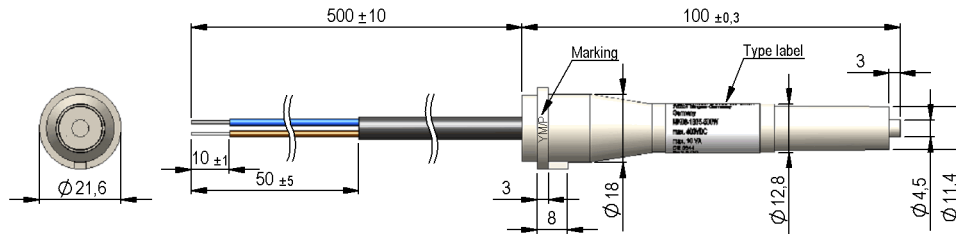

Isometric
Scale 1:5
Maßstab 1:5



Sensor polarisation

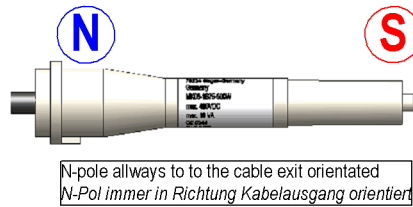

Cable

round cable H05RN-F 2x0,75 mm², black
colour of wires: brown and blue
Rundkabel H05RN-F 2x0,75 mm², schwarz
Aderfarben: braun und blau

Terminals

ends tinned
Enden verzinkt

Schematic

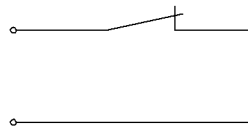

Marking

according to EN60062/factory code
gem. EN60062/Fertigungsstätte

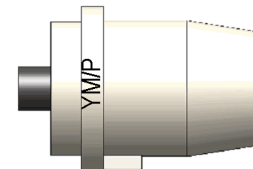

Magnet arrangement

lateral actuation
seitliche Betätigung

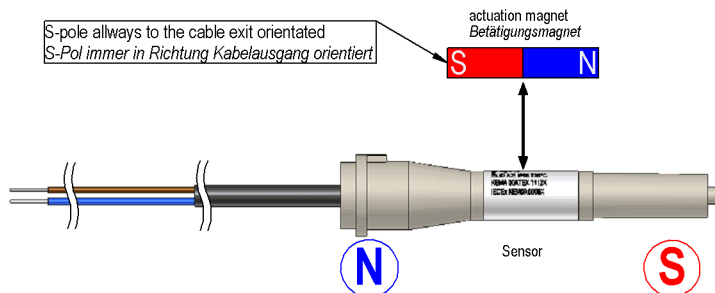

Label

StandexMeder Electronics GmbH
78224 Singen-Germany
MK08-1B75-500W
max. 400 VDC
max. 10 VA



Ex mb II T6
Ex tD A21 IP65 T85°C
KEMA 00ATEX 1112 X
IECEx KEM09.0006X



Europe: +49 / 7731 8399 0 | Email: info@meder.com
 USA: +1 / 508 295 0771 | Email: salesusa@meder.com
 Asia: +852 / 2955 1682 | Email: salesasia@meder.com

Item No.:
2282752054
 Item:
MK08-1B75-500W

Magnetic properties	Conditions	Min	Typ	Max	Unit
Pull-In	at 20°C	38		45	AT
Test equipment		KMS-18			

Contact data 75	Conditions	Min	Typ	Max	Unit
Contact rating	Any DC combination of V & A not to exceed their individual max.'s			10	W
Switching voltage (<31 AT)	DC or Peak AC			400	V
Switching current	DC or Peak AC			0,5	A
Carry current	DC or Peak AC			1	A
Contact resistance static	Measured with 40% overdrive Start Value			150	mOhm
Insulation resistance	RH <45 %, 100 V test voltage	10			GOhm
Breakdown voltage (20-30 AT)	according to EN 60255-5	400			VDC
Operate time incl. bounce	measured with 40% overdrive			0,5	ms
Release time	measured with no coil excitation			0,1	ms
Capacity	@ 10 kHz across open switch		0,4		pF

Special Product Data	Conditions	Min	Typ	Max	Unit
Contact - form		B - NC			
Sensor-resistance	measured with 40% overdrive			200	mOhm
Housing material		Makrolon 2805 grey, Bayer AG D-51368 Leverkusen,			
Housing material		Polycarbonat			
Sealing compound		1. Silikon RTV627 INDEG GmbH Emil-Kömmerling-Str. 5,			
Sealing compound		D-66954 Pirmasens			
Sealing compound		Colour: dark grey; useful temperature range: -60 to 204°C			
Sealing compound		Mixing: RTV627A base component and			
Sealing compound		RTV627B curing agent in 1:1 ratio by weight or vol.			
Sealing compound		Operate temperature: 21°C			
Sealing compound		2. Polyurethan PU570 WEVO Chemie GmbH,			
Sealing compound		Mergenthaler Str. 13, D-73760 Ostfildern-Kemnat			
Sealing compound		Colour: dark grey, operate temperature -40 to 130°C			
Sealing compound		Quota of the filling substances:100 parts of vol.PU570 and			
Sealing compound		26 parts of vol. Harder 300, operating temperature 21°C			

Environmental data	Conditions	Min	Typ	Max	Unit
Shock	1/2 sine, duration 11ms, in 3 axis			50	g
Vibration	from 10 - 2000 Hz			35	g
Operating temperature		-40		60	°C
Storage temperature		-40		60	°C

Cable specification	Conditions	Min	Typ	Max	Unit
Cable type		oil resistant round cable H05RN-F 2x0,75 mm ² , black,			
Cable type		Colour of wires: brown and blue			

Modifications in the sense of technical progress are reserved

Designed at: 09.12.13 Designed by: WKOVACS
 Last Change at: Last Change by:

Approval at: 17.12.13 Approval by: KOLBRICH
 Approval at: Approval by:

Version: 01

X-ON Electronics

Largest Supplier of Electrical and Electronic Components

Click to view similar products for [standexmeder](#) manufacturer:

Other Similar products are found below :

[MK18-B-500W](#) [DIP05-1A72-12L](#) [CRF05-1AS](#) [HE06-1B83-150](#) [HE24-1A83](#) [MK02/0-1A66-1000W](#) [SHV12-1A85-78L3K](#) [KT12-1A-BV88589](#) [SIL05-1A72-71QHR](#) [NDFEB 8X15MM](#) [BE12-2A85-BV420](#) [MK04-1A66B-500W](#) [DIP05-1A72-13L](#) [HM24-1A69-20-6](#) [HM12-1A83-06-UL](#) [H12-1B83](#) [KT12-1A-40L-THT](#) [SIL05-1A31-71L](#) [MK06-4-C](#) [LI05-1A85](#) [NDFEB 10X5X1.9MM](#) [LS01-1A66-PP-500W](#) [M11/M8](#) [LS02-1A66-PP-500W](#) [HM24-1A69-300](#) [LS02-1A66-PA-500W](#) [KT05-1A-40L-THT](#) [MK21M-1A66C-500W](#) [DIP24-1C90-51D](#) [SIL24-1A72-71D](#) [SIL24-1A75-71L](#) [DIP12-1A72-12L](#) [ORD211-1015](#) [DIP12-2A72-21L](#) [H24-1A83](#) [MK17-C-3](#) [SHV12-1A85-78L4K](#) [ALNICO500; 10X40MM](#) [HE24-1A83-02](#) [MS05-1A87-75DHR](#) [DIL05-2C90-63L](#) [DIP24-1A72-12L](#) [HM24-1A69-06](#) [DIP24-1A31-16D](#) [HE06-1A16](#) [MK03-1A66E-500W](#) [LS01-1A66-PA-500W](#) [ORD228VL-2030](#) [DIP05-1C90-51L](#) [ALNICO500 5X22MM](#)