



Series 24 Lok Tainer

WEIGHT

.97g/cm (.087 oz/in)

MATERIALS AND FINISH

HOUSING

Material:

.025-in. (.64-mm) thick Beryllium Copper per QQ-C-533 or .024-in. (.61-mm) thick Cold Rolled Steel per ASTM A-366

Finish:

See finish table on opposite page

CAM

Material:

Beryllium Copper per QQ-C-533

LEVER

Material:

Cold Rolled Steel per ASTM A-366
Note: Beryllium Copper lever furnished when housing is unplated

Finish:

See finish table on opposite page

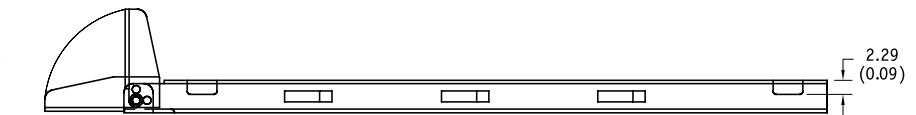
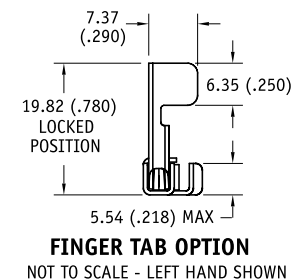
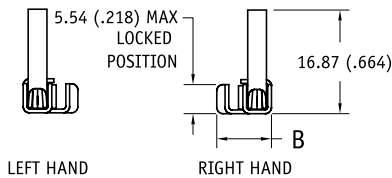
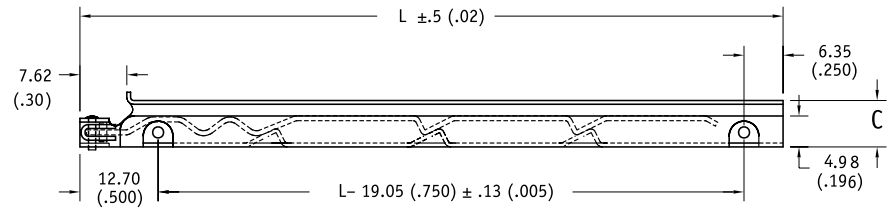
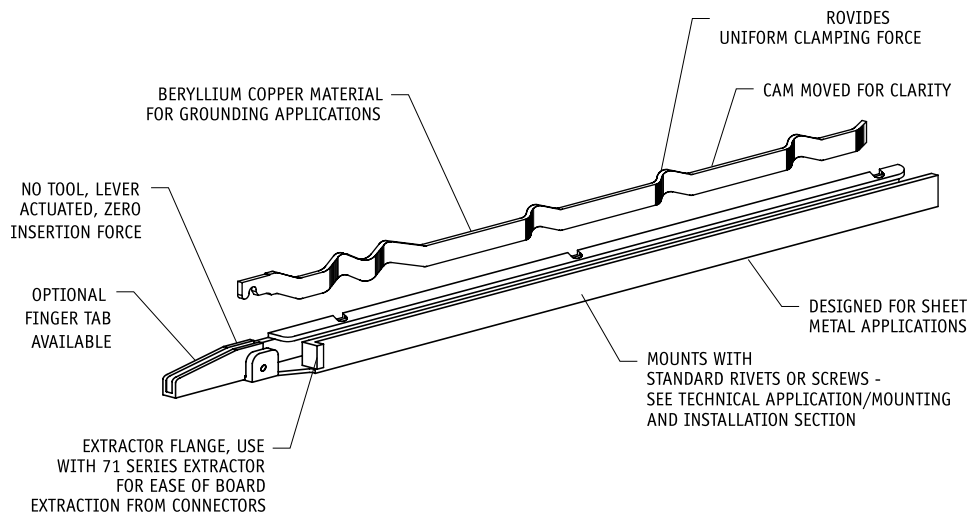

Units: mm(in)
unless specified otherwise,
.xx = ± .25, .x = ± .5
(.xxx = ± .010, .xx = ± .02)

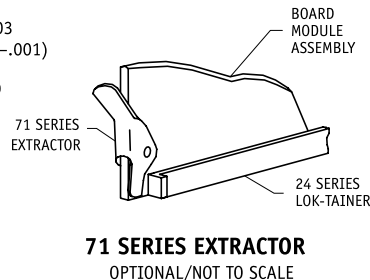
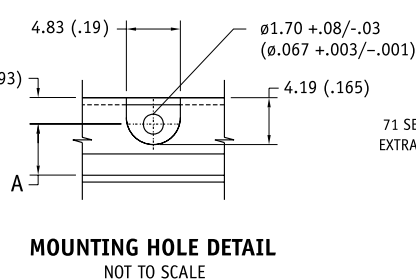

MOUNTING HOLE DIMENSIONS

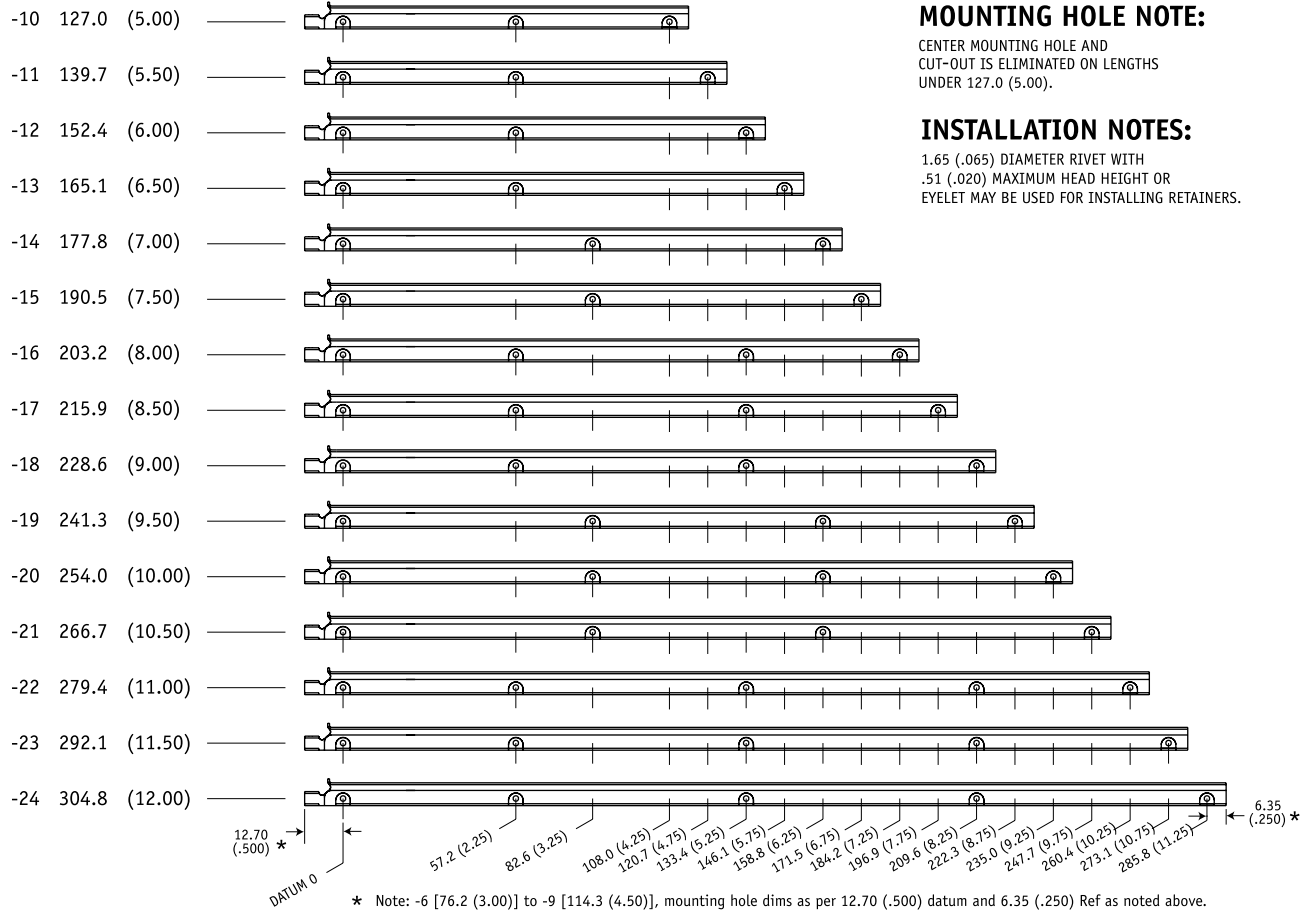

MOUNTING HOLE NOTE:

CENTER MOUNTING HOLE AND CUT-OUT IS ELIMINATED ON LENGTHS UNDER 127.0 (5.00).

INSTALLATION NOTES:

1.65 (.065) DIAMETER RIVET WITH .51 (.020) MAXIMUM HEAD HEIGHT OR EYELET MAY BE USED FOR INSTALLING RETAINERS.

Part Number Code example: 24BX-3-10-6-L

Series 24 Lever-actuated LOK-TAINER, Beryllium Copper housing with flange, 2.39-mm (.094-in.) thick board, 127.2-mm (5.00-in.) long, nickel plate finish and left hand lever action

Part Number Code	
Series 24 LOK-TAINER Lever Actuated	T 24 B X - 2 - 10 - 5 - L
Finger Tab	
Finger tab _____ T	
None _____ [Blank]	
Housing Material	
Beryllium Copper _____ B	
or select from Materials Table	
Extractor Flange	
(Standard) _____ X	
None _____ [Blank]	
Board Thickness	
1.60 (.063) PCB Thickness _____ 2	
or select from Board Thickness Table	
Length	
Length in 12.7 (.50) increments _____ 6 [76.2 (3.00)]	
_____ to 24 [304.8 (12.00)]	
Finish	
Gold Plate _____ 5	
or select from Finish Table	
Lever Action	
Left hand _____ L	
Right hand _____ R	

MATERIALS TABLE

CODE LETTER	
B	BERYLLIUM COPPER, 1/4H PER ASTM-B-194
S	STEEL PER ASTM-A-366

BOARD THICKNESS TABLE

DASH #	THICKNESS	A	B	C
	+ .127 / - .000			
-1	0.79 (.031)	4.58 (.180)	8.89 (.350)	7.55 (.297)
-2	1.60 (.063)	4.58 (.180)	8.89 (.350)	7.55 (.297)
-3	2.39 (.094)	5.34 (.210)	9.66 (.380)	8.31 (.327)

FINISH TABLE

DASH #	
[blank]	SILVER PLATE PER QQ-S-365, TYPE III, GRADE A
-1	NONE
-2	EBANOL PER MIL-F-495 FOR BERYLLIUM COPPER PER MIL-C-13924 FOR STEEL
-3	CADMIUM PER QQ-P-416, TYPE 2, CLASS 2
-4	COPPER PLATE PER MIL-C-14550, CLASS 2
-5	GOLD PLATE PER MIL-G-45204, TYPE 1, GLASS 1
-6	NICKEL PLATE PER QQ-N-290, CLASS 1, GRADE G, BRIGHT
-7	ZINC PLATE CLEAR CHROMATE, PER ASTM-B-633, Fe/Zn 8
-8	ZINC PLATE YELLOW CHROMATE, PER ASTM-B-633, Fe/Zn 8

NOTE: NO FINISH (-1) NOT AVAILBLE WITH "S" STEEL MATERIAL

X-ON Electronics

Largest Supplier of Electrical and Electronic Components

Click to view similar products for [schroff](#) manufacturer:

Other Similar products are found below :

[24566-125](#) [14575171](#) [14575271](#) [14576145](#) [14575265](#) [20117-156](#) [20817772](#) [20827088](#) [20846211](#) [20860229](#) [21100777](#) [23022602](#) [23130082](#)

[24571331](#) [24571586](#) [24572066](#) [24822075](#) [26230-374](#) [30817-001](#) [30825080](#) [20849021](#) [20860240](#) [23001021](#) [24560080](#) [24571303](#)

[24572054](#) [24572056](#) [30219-113](#) [20848-410](#) [20838-125](#) [20860-601](#) [20860-633](#) [10225-602](#) [10225-623](#) [10828058](#) [13100103](#) [28230-439-C](#)

[24563-457](#) [24563-444](#) [20848-601](#) [21101-853](#) [20818-020](#) [21101-847](#) [24563-134](#) [24564-431](#) [24827-107](#) [24563-142](#) [24563-157](#) [24563-442](#)

[A265HC-5.80EH](#)