

Amp.	16
Pole	5
d	168
Øe	67
f	75
m	133
Øp	8/21

Plug, screwless,
with insulation displacement technique,
with flexible cable entry,
IP 44

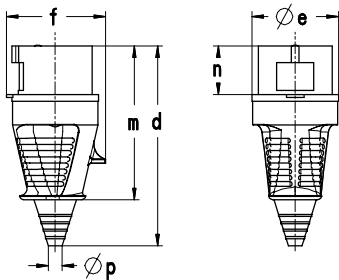

Amp.	16			32			63		
Pole	3	4	5	3	4	5	3	4	5
d	143	147	153	181	181	181	252	252	252
Øe	51	58	65	72	72	72	81	81	81
f	60	68	75	79	79	88	97	97	97
m	108	112	117	138	138	138	192	192	192
n	37	37	37	46	46	46	67	67	67
Øp	7/13	8/21	8/21	11/24	11/24	11/24	15/33	15/33	15/33

Plugs,
with flexible cable entry,
IP 44

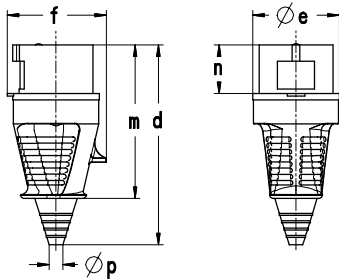

Amp.	16	32
Pole	5	5
d	153	181
Øe	65	72
f	75	88
m	117	138
n	37	46
Øp	8/21	11/24

Plugs,
red special version,
with flexible cable entry,
IP 44

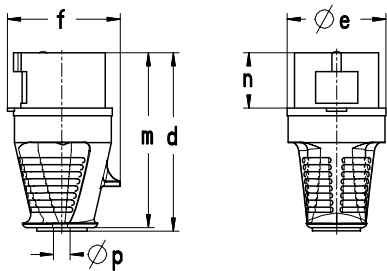

Amp.	16
Pole	5
d	111
Øe	51
f	60
m	108
n	37
Øp	8/15

Plugs,
with inverted cable entry,
IP 44

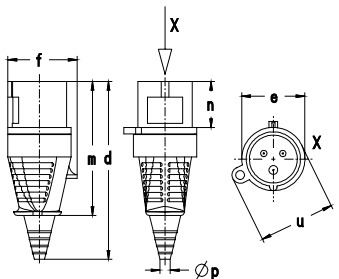

Amp.	16
Pole	5
d	143
e	51
f	60
m	108
n	37
Øp	7/13
u	61

Plugs,
with flexible cable entry,
with eye hook for padlock (for locking with
panel socket 512 306, 512 304 or 512 309),
IP 44

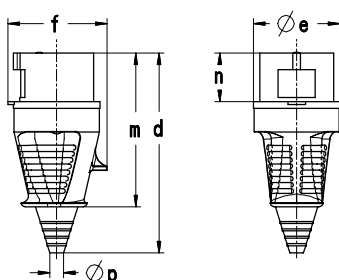

Amp.	16	32
Pole	5	5
d	153	181
Øe	65	72
f	75	88
m	117	138
n	37	46
Øp	8/21	11/24

Phase inverters,
with flexible cable entry,
IP 44

   2P+E 3P+E 3P+N+E			Ampère	Poles	110 V 50 a. 60 Hz <small>3pole 4pole 5pole 4h 4h 4h</small>	230 V 50 a. 60 Hz <small>3pole 4pole 5pole 6h 9h 9h</small>	400 V 50 a. 60 Hz <small>3pole 4pole 5pole 9h 6h 6h</small>	500 V 50 a. 60 Hz <small>3pole 4pole 5pole 7h 7h 7h</small>	> 50 - 500 V 100 - 300 Hz <small>3pole 4pole 5pole 10h 10h 10h</small>	> 50 - 500 V over 300 - 500 Hz <small>3pole 4pole 5pole 2h 2h 2h</small>		
Part numbers												
 <i>pic. 210SL</i>	16	5									10/60	246
						210 SL						
 <i>pic. 230</i>	16	3	210 304	210 306	210 309						10	111
	16	4	210 404	210 409	210 406	210 407	210 410	210 402			10	147
	16	5	210 504	210 509	210						10/60	176
	32	3	230 304	230 306	230 309						10	202
	32	4	230 404	230 409	230 406	230 407	230 410	230 402			10	226
	32	5	230 504	230 509	230						10/60	250
	63	3	260 304	260 306	260 309						5	475
	63	4	260 404	260 409	260 406	260 407	260 410	260 402			5	527
	63	5	260 504	260 509	260						5	575
 <i>pic. 233</i>	16	5									10/60	176
	32	5									10/60	250
 <i>pic. 215 306</i>	16	3	215 304	215 306	215 309						10	101
 <i>pic. 212 306</i>	16	3	212 304	212 306	212 309						10	113
 <i>pic. 230 PH</i>	16	5									10	180
	32	5									10	257

X-ON Electronics

Largest Supplier of Electrical and Electronic Components

Click to view similar products for [walther](#) manufacturer:

Other Similar products are found below :

[339306](#) [269306](#) [239](#) [630406](#) [330](#) [10110](#) [269](#) [430304](#) [130406](#) [630306](#) [410](#) [319306](#) [10280](#) [630](#) [10380](#) [410306](#) [610304](#) [10400](#) [210304](#)
[310306](#) [410304](#) [330304](#) [230304](#) [230306](#)