

THIS DRAWING IS UNPUBLISHED. RELEASED FOR PUBLICATION
 © COPYRIGHT BY TYCO ELECTRONICS CORPORATION. ALL RIGHTS RESERVED.

| LOC | | DIST | | REVISIONS | | | |
|-----|-----|-------------------------|--|-----------|-----|------|--|
| P | LTR | DESCRIPTION | | DATE | DWN | APVD | |
| | F | REV PER EC 0512-0302-05 | | 05DEC05 | BC | GS | |
| | G | ECR-10-019054 | | 15SEP10 | DP | MQW | |

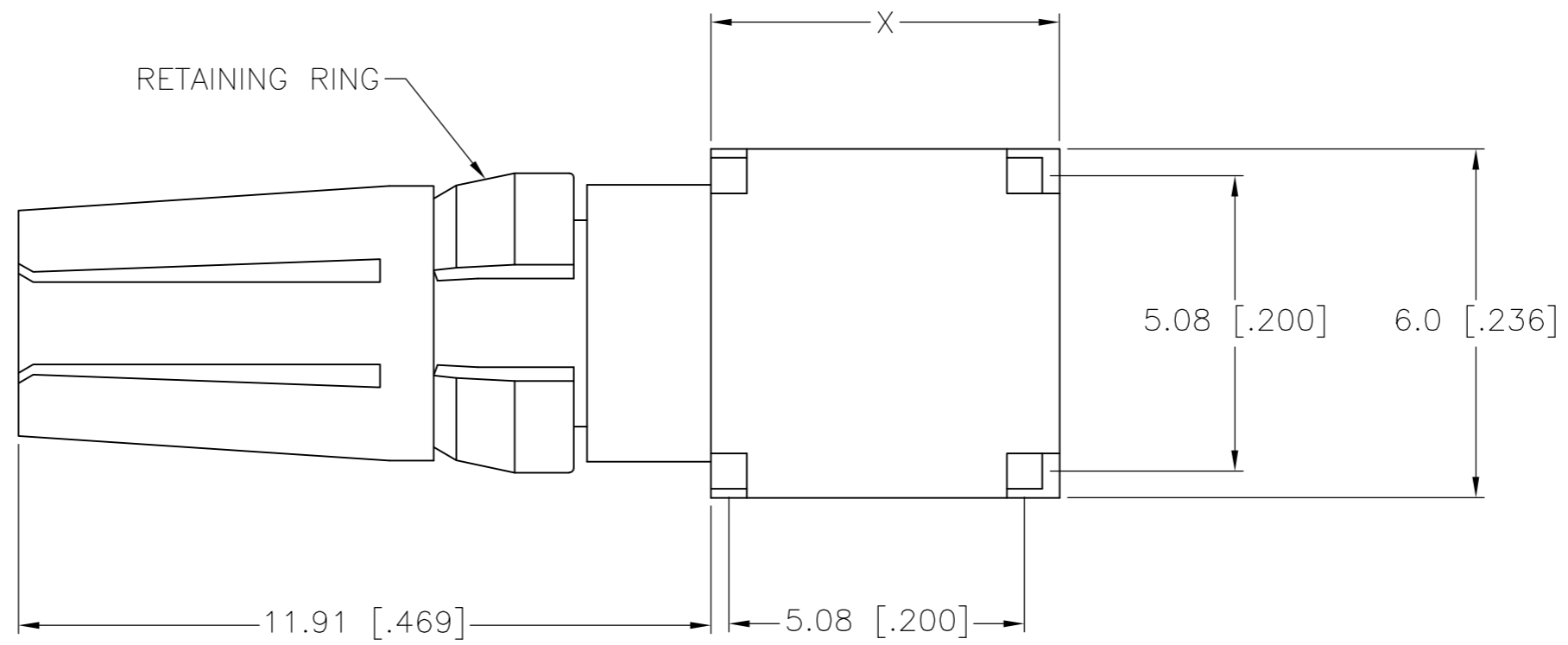
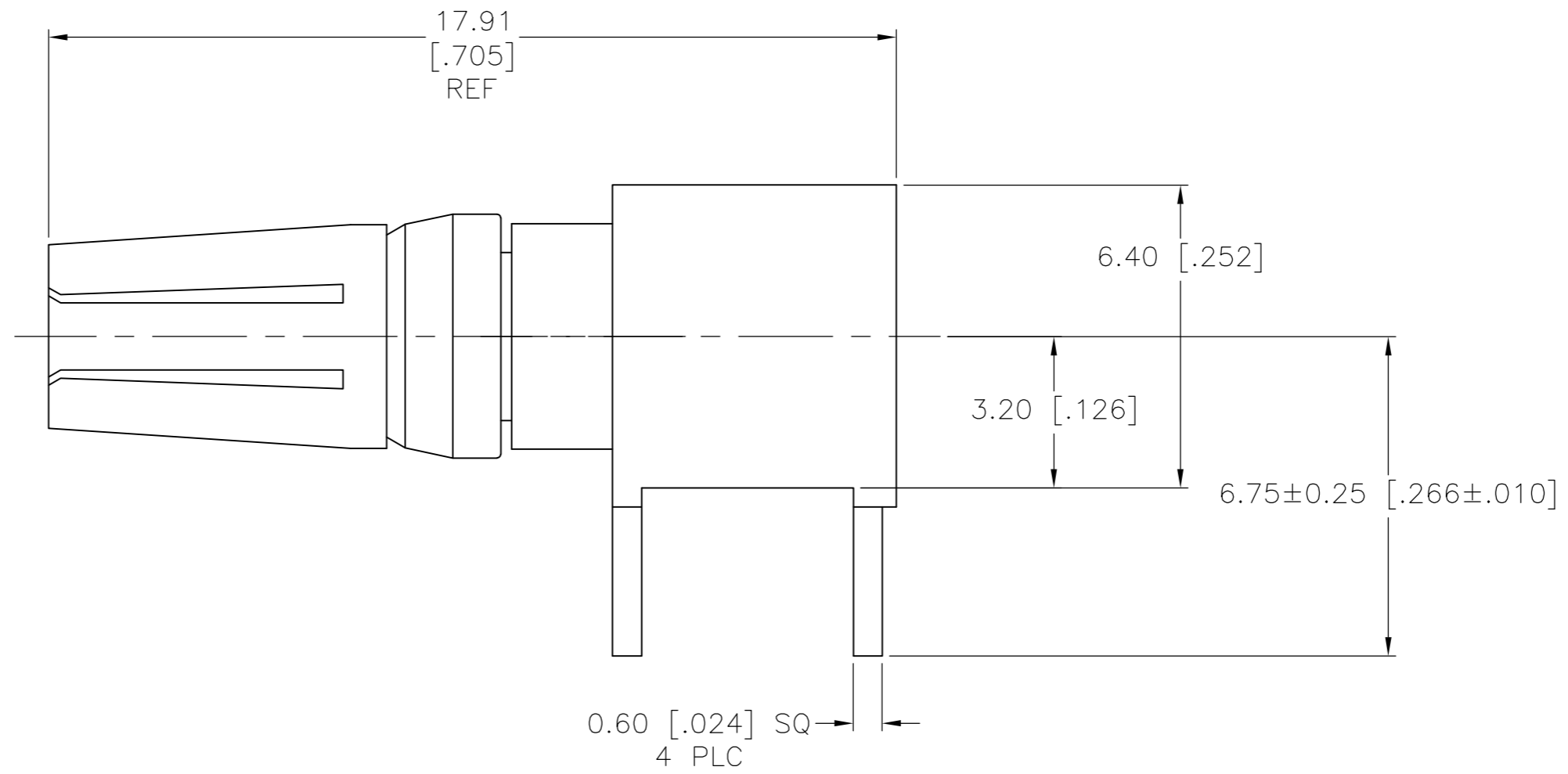

- 1 SUITABLE FOR FEMALE TYPE M CONNECTORS.
- 2 CONTACT SPRING: BERYLLIUM COPPER.
CONTACT BODY: BRASS.
RETAINING RING: BERYLLIUM COPPER.
- 3 CONTACT FINISH: 0.00127[.000050] MIN GOLD IN CONTACT AREA,
0.00254[.000100] MIN TIN/LEAD IN AREA "X", ALL OVER
0.00127[.000050] NICKEL.
- 4 CONTACT FINISH: 0.00076[.000030] MIN GOLD IN CONTACT AREA,
0.00254[.000100] MIN TIN/LEAD IN AREA "X", ALL OVER
0.00127[.000050] NICKEL.

| | | |
|----------|--------|-------------|
| OBSOLETE | 4 | 148513-2 |
| | 3 | 148513-1 |
| | FINISH | PART NUMBER |

| | | | | |
|---|--|-----------------------|---|-----------------|
| THIS DRAWING IS A CONTROLLED DOCUMENT. | | DWN B.CARBO 05DEC05 | Tyco Electronics Corporation Harrisburg, PA 17105-3608 | |
| DIMENSIONS: mm [INCHES] | | CHK A.SHARPE 05DEC05 | NAME POWER CONTACT, EUROCARD TYPE M, FEMALE 90', PRINTED CIRCUIT BOARD MOUNT | |
| TOLERANCES UNLESS OTHERWISE SPECIFIED: ±0.2 | | APVD A.SHARPE 05DEC05 | APPLICATION SPEC | |
| MATERIAL | | FINISH SEE TABLE | SIZE A2 | CAGE CODE 00779 |
| 6-PLC ± | | 1-PLC ± | DRAWING NO C=148513 | |
| 2-PLC ± | | 3-PLC ± | RESTRICTED TO | |
| 4-PLC ± | | ANGLES ± | SCALE 8:1 | |
| FINISH | | WEIGHT | SHEET 1 of 1 | |
| SEE TABLE | | CUSTOMER DRAWING | REV G | |

X-ON Electronics

Largest Supplier of Electrical and Electronic Components

Click to view similar products for [Hard Metric Connectors](#) category:

Click to view products by [TE Connectivity](#) manufacturer:

Other Similar products are found below :

[10146110-VR5C](#) [6345127-1](#) [646916-9](#) [6469658-1](#) [853016](#) [973108](#) [1-2000713-0](#) [1-2000713-2](#) [1-2000713-3](#) [120646-1](#) [134187](#) [1645343-1](#)
[1645456-1](#) [1645594-1](#) [1645601-1](#) [1934822-1](#) [2000829-2](#) [2000985-2](#) [223085-1](#) [278071110010833](#) [1645179-1](#) [1645245-1](#) [1645457-1](#)
[1645525-1](#) [1645570-1](#) [1645596-1](#) [1857470-1](#) [1934275-1](#) [1934289-1](#) [1934759-1](#) [2000673-1](#) [2000984-2](#) [204975](#) [2170292-2](#) [2-536642-6](#) [3-](#)
[100668-0](#) [352188-1](#) [352629-1](#) [3-646346-0](#) [3-646356-0](#) [3-646457-0](#) [3-646529-0](#) [3-646530-0](#) [5120823-1](#) [5120899-1](#) [3-100145-0](#) [3-100147-0](#)
[3-100669-1](#) [HM2DK2368PLF](#) [5646530-1](#)