

THIS DRAWING IS UNPUBLISHED. RELEASED FOR PUBLICATION
 © COPYRIGHT BY TYCO ELECTRONICS CORPORATION. ALL RIGHTS RESERVED.

LOC		DIST		REVISIONS			
P	LTR	DESCRIPTION		DATE	DWN	APVD	
AF	50	E		REVISED PER ECR-07-002180	31JAN07	JR	GJ

- SPECIFICATIONS:
MAGNET WIRE #8 - #34 AWG,
.040"(1.02mm) - .006"(0.16mm) DIA COPPER.
OTHER SIZES MAY BE ACCOMMODATED.
CONSULT TYCO ELECTRONICS FOR APPROVAL.
- POCKET RECOMMENDATION: 1601425
- SUPPLIED LOOSE PIECE ONLY
- PRELIMINARY - NOT FOR PRODUCTION
- TERMINAL APPLICATION TO COMPLY WITH TYCO ELECTRONICS SPECIFICATION 114-13166 FIGURE 9.

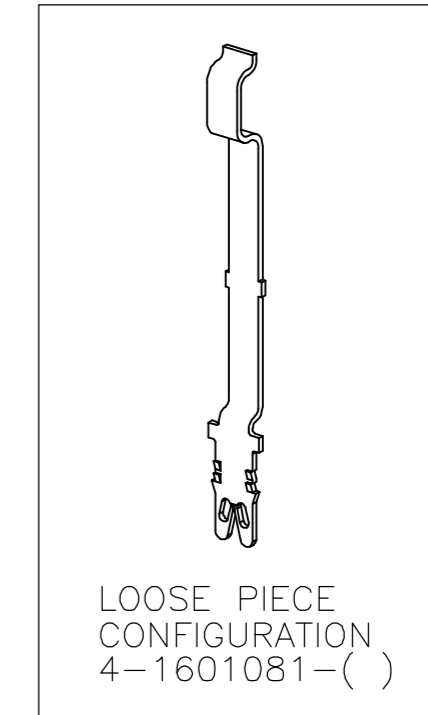
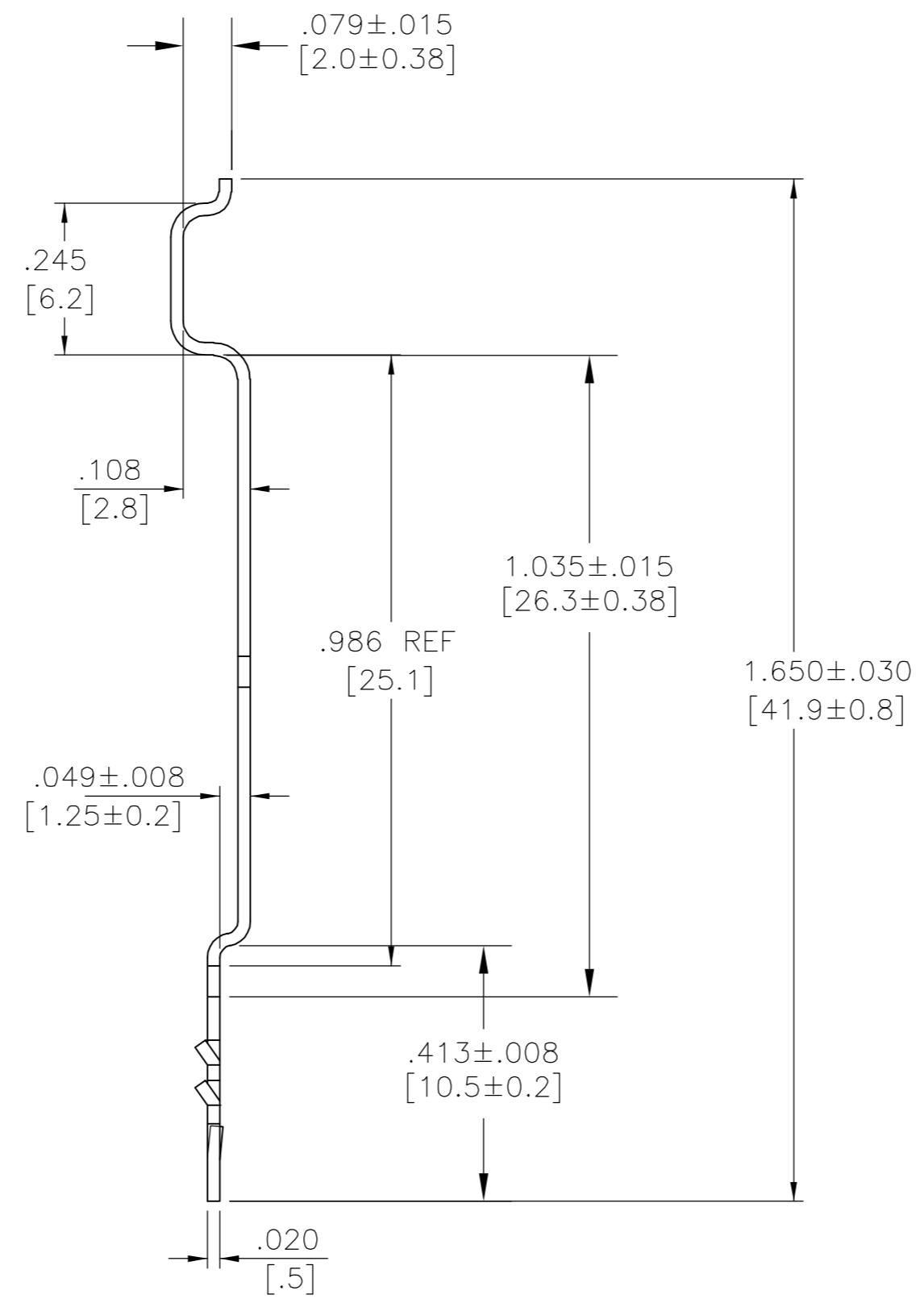
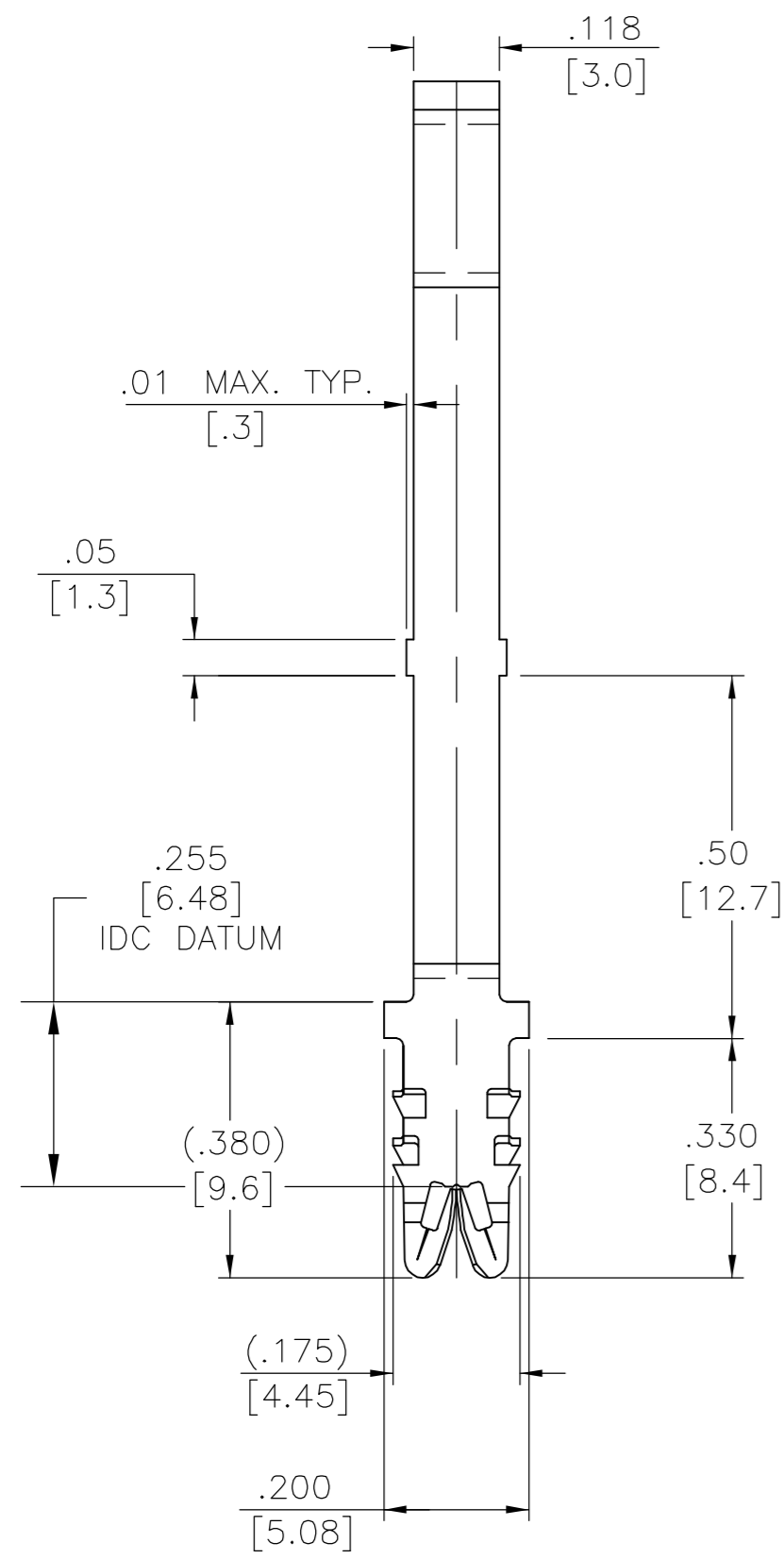

SUPERSEDED BY 4-1601081-3
 SUPERSEDED BY 4-1601081-2

-	-	-
-	-	-
PRE-TIN PLATE OVER NICKEL UNDERPLATE	-	4-1601081-3
PRE-SILVER PLATE OVER NICKEL UNDERPLATE	031-151-025	4-1601081-2
PRE-TIN PLATE OVER NICKEL UNDERPLATE	-	1601081-3
PRE-SILVER PLATE OVER NICKEL UNDERPLATE	131-151-025	1601081-2
FINISH		REFERENCE PART NUMBER
THIS DRAWING IS A CONTROLLED DOCUMENT.		TYCO PART NUMBER
DWN J.WELLER 11JAN2002		Tyco Electronics Corporation Harrisburg, PA 17105-3608
CHK M.FEHER 11JAN2002		
APVD K.RANDOLPH 11JAN2002		
PRODUCT SPEC		
DIMENSIONS: mm [INCHES]		NAME
TOLERANCES UNLESS OTHERWISE SPECIFIED:		108-2085
0 PLC ± -	1 PLC ± -	APPLICATION SPEC
2 PLC ± .01[0.25]	3 PLC ± .005[0.13]	5
4 PLC ± -	ANGLES ± 2°	SIZE CAGE CODE DRAWING NO RESTRICTED TO
MATERIAL BRASS, H04	FINISH SEE TABLE	A2 00779 C=1601081
CUSTOMER DRAWING		SCALE 4:1 SHEET 1 OF 1 REV E

X-ON Electronics

Largest Supplier of Electrical and Electronic Components

Click to view similar products for [Terminals](#) category:

Click to view products by [TE Connectivity](#) manufacturer:

Other Similar products are found below :

[HT-13-10](#) [71M-250-32-NB](#) [01-2065-1-0216](#) [00581P0075](#) [M10-10RX](#) [M10BCK](#) [60205-1](#) [604200-1](#) [60598-1-CUT-TAPE](#) [60617-1-C](#) [60873-1](#) [M14-516R/SK](#) [M14-6RSX](#) [M18-10FLX](#) [M18-8FBX](#) [M18-8R/LX](#) [M18BCK](#) [61314-6-C](#) [61-S](#) [61-SN-A](#) [62-NBM-A](#) [63-S](#) [640179-1](#) [640917-2-CUT-TAPE](#) [6501550002](#) [66107-2-C](#) [696683-1](#) [696834-1](#) [696861-1](#) [696931-1](#) [696999-1](#) [M8-516RK](#) [M86700006](#) [MA250DMFMX-A](#) [701-2007](#) [701-2307](#) [701-7761-03](#) [70F-110-32-PB](#) [718-N-A](#) [71M-187-20-NBL](#) [71M-250-32-NBL](#) [72F-187-20-NBL](#) [72M-250-32-NBL](#) [7310](#) [73F-250-32](#) [73F-250-32-NBL](#) [73F-250-32-NL](#) [F14-10C](#) [F-1M](#) [751-250](#)