

1.27µm [.000050] MIN TIN PER MIL-T-10727 OVER
 1.27µm [.000050] MIN TIN PER MIL-G-45204 ON MATING END FOR A LENGTH OF 5.08 [.200] MIN
 0.38µm [.000015] MIN GOLD PER MIL-G-45204 ON MATING END FOR A LENGTH OF 5.08 [.200] MIN
 BOTH OVER 1.27µm [.000050] MIN NICKEL PER QQ-N-290 ON ENTIRE CONTACT.

1.27µm [.000050] MIN TIN PER MIL-T-10727 OVER
 1.27µm [.000050] MIN TIN PER MIL-G-45204 ON MATING END FOR A LENGTH OF 5.08 [.200] MIN
 0.38µm [.000015] MIN GOLD PER MIL-G-45204 ON MATING END FOR A LENGTH OF 5.08 [.200] MIN
 BOTH OVER 1.27µm [.000050] MIN NICKEL PER QQ-N-290 ON ENTIRE CONTACT.

1.27µm [.000050] MIN TIN PER MIL-T-10727 OVER
 1.27µm [.000050] MIN TIN PER MIL-G-45204 ON MATING END FOR A LENGTH OF 5.08 [.200] MIN
 0.38µm [.000015] MIN GOLD PER MIL-G-45204 ON MATING END FOR A LENGTH OF 5.08 [.200] MIN
 BOTH OVER 1.27µm [.000050] MIN NICKEL PER QQ-N-290 ON ENTIRE CONTACT.

1.27µm [.000050] MIN TIN PER MIL-T-10727 OVER
 1.27µm [.000050] MIN TIN PER MIL-G-45204 ON MATING END FOR A LENGTH OF 5.08 [.200] MIN
 0.38µm [.000015] MIN GOLD PER MIL-G-45204 ON MATING END FOR A LENGTH OF 5.08 [.200] MIN
 BOTH OVER 1.27µm [.000050] MIN NICKEL PER QQ-N-290 ON ENTIRE CONTACT.

1.27µm [.000050] MIN TIN PER MIL-T-10727 OVER
 1.27µm [.000050] MIN TIN PER MIL-G-45204 ON MATING END FOR A LENGTH OF 5.08 [.200] MIN
 0.38µm [.000015] MIN GOLD PER MIL-G-45204 ON MATING END FOR A LENGTH OF 5.08 [.200] MIN
 BOTH OVER 1.27µm [.000050] MIN NICKEL PER QQ-N-290 ON ENTIRE CONTACT.

1.27µm [.000050] MIN TIN PER MIL-T-10727 OVER
 1.27µm [.000050] MIN TIN PER MIL-G-45204 ON MATING END FOR A LENGTH OF 5.08 [.200] MIN
 0.38µm [.000015] MIN GOLD PER MIL-G-45204 ON MATING END FOR A LENGTH OF 5.08 [.200] MIN
 BOTH OVER 1.27µm [.000050] MIN NICKEL PER QQ-N-290 ON ENTIRE CONTACT.

1.27µm [.000050] MIN TIN PER MIL-T-10727 OVER
 1.27µm [.000050] MIN TIN PER MIL-G-45204 ON MATING END FOR A LENGTH OF 5.08 [.200] MIN
 0.38µm [.000015] MIN GOLD PER MIL-G-45204 ON MATING END FOR A LENGTH OF 5.08 [.200] MIN
 BOTH OVER 1.27µm [.000050] MIN NICKEL PER QQ-N-290 ON ENTIRE CONTACT.

1.27µm [.000050] MIN TIN PER MIL-T-10727 OVER
 1.27µm [.000050] MIN TIN PER MIL-G-45204 ON MATING END FOR A LENGTH OF 5.08 [.200] MIN
 0.38µm [.000015] MIN GOLD PER MIL-G-45204 ON MATING END FOR A LENGTH OF 5.08 [.200] MIN
 BOTH OVER 1.27µm [.000050] MIN NICKEL PER QQ-N-290 ON ENTIRE CONTACT.

1.27µm [.000050] MIN TIN PER MIL-T-10727 OVER
 1.27µm [.000050] MIN TIN PER MIL-G-45204 ON MATING END FOR A LENGTH OF 5.08 [.200] MIN
 0.38µm [.000015] MIN GOLD PER MIL-G-45204 ON MATING END FOR A LENGTH OF 5.08 [.200] MIN
 BOTH OVER 1.27µm [.000050] MIN NICKEL PER QQ-N-290 ON ENTIRE CONTACT.

1.27µm [.000050] MIN TIN PER MIL-T-10727 OVER
 1.27µm [.000050] MIN TIN PER MIL-G-45204 ON MATING END FOR A LENGTH OF 5.08 [.200] MIN
 0.38µm [.000015] MIN GOLD PER MIL-G-45204 ON MATING END FOR A LENGTH OF 5.08 [.200] MIN
 BOTH OVER 1.27µm [.000050] MIN NICKEL PER QQ-N-290 ON ENTIRE CONTACT.

1.27µm [.000050] MIN TIN PER MIL-T-10727 OVER
 1.27µm [.000050] MIN TIN PER MIL-G-45204 ON MATING END FOR A LENGTH OF 5.08 [.200] MIN
 0.38µm [.000015] MIN GOLD PER MIL-G-45204 ON MATING END FOR A LENGTH OF 5.08 [.200] MIN
 BOTH OVER 1.27µm [.000050] MIN NICKEL PER QQ-N-290 ON ENTIRE CONTACT.

1.27µm [.000050] MIN TIN PER MIL-T-10727 OVER
 1.27µm [.000050] MIN TIN PER MIL-G-45204 ON MATING END FOR A LENGTH OF 5.08 [.200] MIN
 0.38µm [.000015] MIN GOLD PER MIL-G-45204 ON MATING END FOR A LENGTH OF 5.08 [.200] MIN
 BOTH OVER 1.27µm [.000050] MIN NICKEL PER QQ-N-290 ON ENTIRE CONTACT.

1.27µm [.000050] MIN TIN PER MIL-T-10727 OVER
 1.27µm [.000050] MIN TIN PER MIL-G-45204 ON MATING END FOR A LENGTH OF 5.08 [.200] MIN
 0.38µm [.000015] MIN GOLD PER MIL-G-45204 ON MATING END FOR A LENGTH OF 5.08 [.200] MIN
 BOTH OVER 1.27µm [.000050] MIN NICKEL PER QQ-N-290 ON ENTIRE CONTACT.

1.27µm [.000050] MIN TIN PER MIL-T-10727 OVER
 1.27µm [.000050] MIN TIN PER MIL-G-45204 ON MATING END FOR A LENGTH OF 5.08 [.200] MIN
 0.38µm [.000015] MIN GOLD PER MIL-G-45204 ON MATING END FOR A LENGTH OF 5.08 [.200] MIN
 BOTH OVER 1.27µm [.000050] MIN NICKEL PER QQ-N-290 ON ENTIRE CONTACT.

1.27µm [.000050] MIN TIN PER MIL-T-10727 OVER
 1.27µm [.000050] MIN TIN PER MIL-G-45204 ON MATING END FOR A LENGTH OF 5.08 [.200] MIN
 0.38µm [.000015] MIN GOLD PER MIL-G-45204 ON MATING END FOR A LENGTH OF 5.08 [.200] MIN
 BOTH OVER 1.27µm [.000050] MIN NICKEL PER QQ-N-290 ON ENTIRE CONTACT.

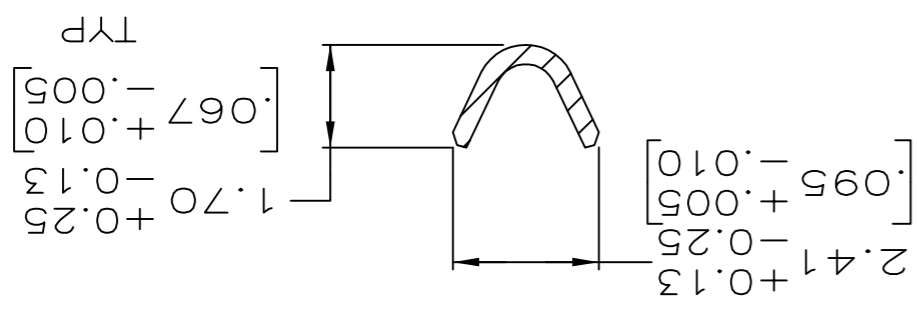
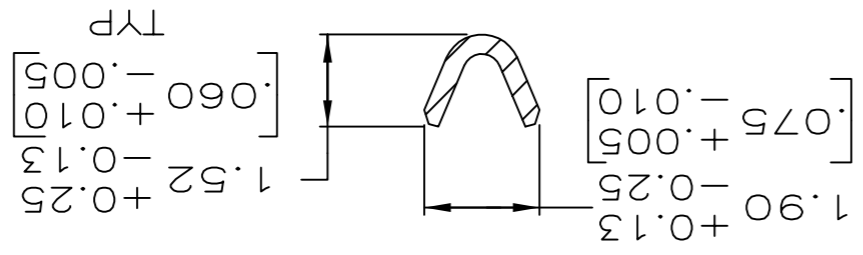
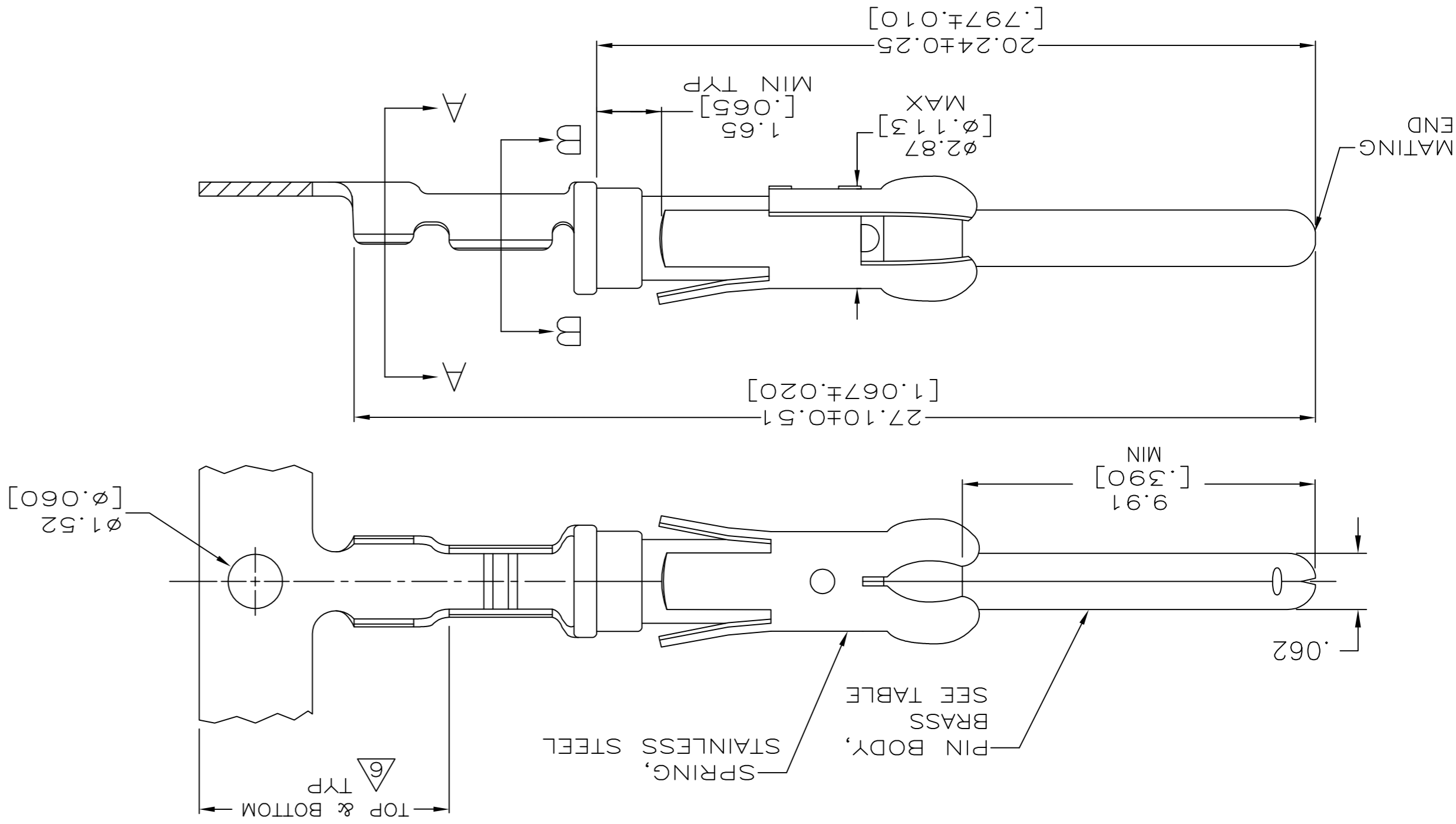

13 OBSOLETE PARTS: OBSOLETE CIS STREAMLINING PER D.RENAUD/D.SINISI

SECTION B-B

SECTION A-A

MATERIAL		SEE CALLOUTS		SEE TABLE		CUSTOMER DRAWING	
FINISH		DIMENSIONS: mm [INCHES]		TOLERANCES UNLESS OTHERWISE SPECIFIED:		SCALE 8:1	
0 P/LC ±		0.13 [.005]		±		SHEET 1 OF 1	
1 P/LC ±		±		±		REV AJ	
2 P/LC ±		±		±		RESTRICTED TO	
3 P/LC ±		±		±		DRAWING NO 66106	
4 P/LC ±		±		±		CASE CODE A2 00779	
APPLICATOR SPEC		APPLICATOR SPEC		APPLICATOR SPEC		PIN ASSEMBLY, .062, TYPE III+	
PRODUCT SPEC		PRODUCT SPEC		PRODUCT SPEC		NAME J.WESTMAN	
APVD R.SHIREY		APVD R.STONE		APVD R.SHIREY		DATE 7-17-91	
CHK R.STONE		CHK R.STONE		CHK R.SHIREY		DATE 8-15-91	
DWN R.SHIREY		DWN R.STONE		DWN R.SHIREY		DATE 8-19-91	
THIS DRAWING IS A CONTROLLED DOCUMENT.		THIS DRAWING IS A CONTROLLED DOCUMENT.		THIS DRAWING IS A CONTROLLED DOCUMENT.		DATE 7-17-91	

REELING	P/N BODY FINISH	LOOSE PIECE REF	PART NO
STANDARD	3	66107-1	66106-1
STANDARD	7	66107-2	66106-2
STANDARD	4	66107-3	66106-3
STANDARD	2	66107-4	66106-4
STANDARD	3	66107-1	66106-5
OBSOLETE	7	66107-2	66106-6
OBSOLETE	4	66107-3	66106-7
OBSOLETE	2	66107-4	66106-8
OBSOLETE	5	66107-7	1-66106-2
OBSOLETE	10	66107-8	1-66106-4
OBSOLETE	11	1-66107-1	1-66106-5
OBSOLETE	11	1-66107-1	1-66106-6
OBSOLETE	12	-	1-66106-7

REVISIONS	P	LTR	DESCRIPTION	DATE	DWN	APVD
1	AJ		REVISED PER ECO-16-017885	06OCT2017	RS	MZ
2	AH		REVISED PER ECO-12-012316	05JUL12	KH	MZ

X-ON Electronics

Largest Supplier of Electrical and Electronic Components

Click to view similar products for [Standard Circular Contacts](#) category:

Click to view products by [TE Connectivity](#) manufacturer:

Other Similar products are found below :

[M24308/4-14F](#) [12110600010](#) [129591AU](#) [1000B BULK](#) [RFM26W-1D28](#) [RM20M13D28](#) [RM24M9D28](#) [MS3474W10-6P L/C](#) [164-901-CD](#)
[1900ND02P2B00A](#) [192900-0082](#) [192900-0356](#) [ST-JL05-16S-C3-100](#) [T01-CRIMP-S03](#) [APK-SA16A07-002](#) [CONT-JL05-08S-C2-10](#)
[RC16M-23T](#) [RFD26L-1D28](#) [M85049/124S13W](#) [JN1-22-20S-R-PKG100](#) [031-50565](#) [031-50794](#) [SJS861301M](#) [CF16SC18RF](#) [CONT-JL05-](#)
[08P-C1-10](#) [ST-JL05-16P-C1-100](#) [ST-JL05-16S-C1-100](#) [ST-JL05-20P-C1-100](#) [ST-JN5-S-C1B-2500-\(A534G\)](#) [82911466K](#) [82911467NK](#)
[84690-0106](#) [M81714/67-21](#) [M24308/2-11F](#) [HN0201600031](#) [M85049/118S20W](#) [031-50969-010](#) [T3P16FC3LZ](#) [ST-JL05-16S-C2-3500](#) [ZP-](#)
[4016-10NF](#) [HN0201600022](#) [M24308/2-290F](#) [T3P22MC1LY](#) [CONT-JL05-08P-C2-10](#) [M24308/2-283Z](#) [CONT-JL05-12P-C1-10](#)
[RM20M12G8D28](#) [031-50676](#) [12115010110](#) [SAM12C-03G03](#) [CAP-DACMDPC2](#)