

THIS COPY IS PROVIDED ON A RESTRICTED BASIS AND IS NOT TO BE USED IN ANY WAY DETRIMENTAL TO THE INTERESTS OF PANDUIT CORP.

NOTES:

1. IDENTIFICATION: 1RU HORIZONTAL, (10) C-13  
230V / 16A / SINGLE-PHASE POU

PART NO.	COLOR
HB0D2J0AA10M1	BLACK

2. ACCESSORY COMPONENTS:  
(4) 10-32 x 1/2" MOUNTING SCREWS  
(4) 12-24 x 1/2" MOUNTING SCREWS  
(1) RETAINING CLAMP FOR C-20 INLET

3. DIMENSIONS IN PARENTHESES ARE METRIC (mm).

4. UNIT COMPLIES WITH IEC 60950-1, EN55022, EN55024, AND IS CE MARKED.

5. RoHS COMPLIANT.

6. VISIT OUR ON-LINE CATALOG AT WWW.PANDUIT.COM FOR A CURRENT LIST OF PRODUCTS APPLICABLE FOR USE WITH THIS PART.

7. MAXIMUM AVAILABLE POWER = 3.7 KW

PANDUIT P/N	WEIGHT
HB0D2J0AA10M1	2.3 lb (1.1 kg)

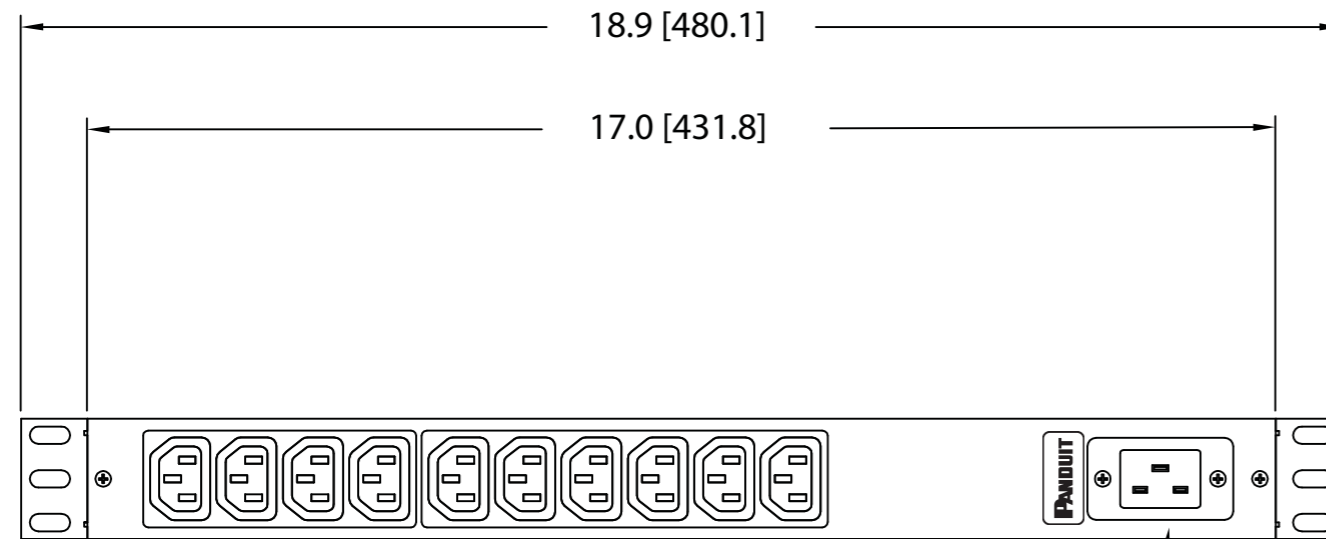

IEC320 C20  
POWER INLET

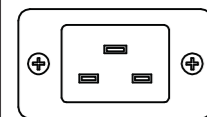
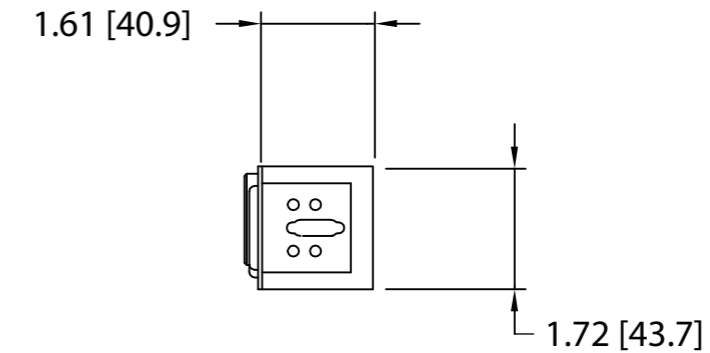

C20 POWER INLET  
20 AMP, 250V, SINGLE-PHASE  
SOCKET  
IEC320

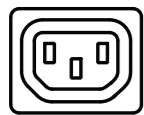

TEN (10)  
RECEPTACLES  
10 AMP, 250V  
STRAIGHT BLADE  
IEC 60320/C13

REV	DATE	BY	CHK	DESCRIPTION	ECN	R	CUST	SUP	OTH
00A	2-10-11	MAV		RELEASED TO PRODUCTION	09V098HH				

MODEL FILENAME	09V098HH/00.PRT	
CAD FILENAME/LAYERS	09V098HH_DC/00A.PRT	
<b>PANDUIT</b> CORP TINLEY PARK, ILLINOIS		
1RU HORIZONTAL, (10) C-13 POWER OUTLET UNIT (HB0D2J0AA10M1) CUSTOMER DRAWING		
UNLESS OTHERWISE SPECIFIED, DIMENSIONAL TOLERANCES ARE:		UNLESS OTHERWISE SPECIFIED,
INCHES	+	[METRIC - MILLIMETER]
X.X	+/- 0.03	X
X.XX	+/- 0.015	X.X
X.XXX	+/- 0.005	X.XX
		ANGLE
		+/- 1°
DRAWN BY	MAV	MAT'L:
DATE	2-10-11	
CHK'D		
SCALE	NONE	
DRAWING NO.	09V098HH	DWG
		SIZE
		B

## X-ON Electronics

Largest Supplier of Electrical and Electronic Components

*Click to view similar products for [Power Outlet Strips](#) category:*

*Click to view products by [Panduit](#) manufacturer:*

Other Similar products are found below :

[G20IG606](#) [1301430288](#) [1301530208](#) [1302100069](#) [1301430321](#) [1301530054](#) [1447B163](#) [1585T16A1RA](#) [UL602CB-6](#) [UL7408-6](#) [ULHC4-15](#)  
[V20IG606](#) [UL2063BD](#) [TSB](#) [1301530203](#) [4748.03](#) [4309](#) [UL7208-15](#) [3083](#) [3050F](#) [3090](#) [1301530132](#) [1301530117](#) [1301530164](#) [1301530050](#)  
[1301530141](#) [1301430252](#) [1301530179](#) [1301530065](#) [1301350158](#) [1301530052](#) [1301530068](#) [1301530120](#) [HB0B1L4BT08W1](#)  
[VB0D2B2BM30P1](#) [HA0A1D0CA10E1](#) [HA0A1M2CM10E1](#) [HA1A1D0CA10E1](#) [VB0B1L2BN24H1](#) [PN1A1C0BA10E1](#) [HA0B1E0CA1081](#)  
[HA0D2U0CA1081](#) [HA0D2A0CA1081](#) [HA1D2U0CA1081](#) [HA1D2A0CA1081](#) [HB1B2J0AA10M1](#) [LZ1D2A0FA0AJ1](#) [LZ1D2P0FA0AL1](#)  
[VB0B1L4CN48M1](#) [MA002](#)