

2



1

THIS COPY IS PROVIDED ON A RESTRICTED BASIS AND IS NOT TO BE USED IN ANY WAY DETRIMENTAL TO THE INTERESTS OF PANDUIT CORP.

NOTES:
1. IDENTIFICATION: VERTICAL, (20) 5-15R
120V / 15A / SINGLE-PHASE POU

PANDUIT P/N	WEIGHT
CMRPSV15SIL	9 lb (4.1 kg)

<u>PART NO.</u>	<u>COLOR</u>
CMRPSV15SIL	BLACK

2. ACCESSORY COMPONENTS:
 (4) #10-32 x 1/2" MOUNTING SCREWS
 (4) #12-24 x 1/2" MOUNTING SCREWS
 (2) #10-32 LOCKING COLLAR SCREWS
 (2) L-BRACKETS
3. DIMENSIONS IN PARENTHESES ARE METRIC (mm).
 4. SURGE SUPPRESSION UP TO 330V OR 720 JOULES.
 5. UL® & c-UL® LISTED 60950.
 6. RoHS COMPLIANT.
 7. VISIT OUR ON-LINE CATALOG AT WWW.PANDUIT.COM FOR A CURRENT LIST OF PRODUCTS APPLICABLE FOR USE WITH THIS PART.
 8. MAXIMUM AVAILABLE INPUT POWER = 1.4 KW
 9. INSTALLATION SHALL COMPLY WITH ALL APPLICABLE NATIONAL, STATE, AND LOCAL CODES.

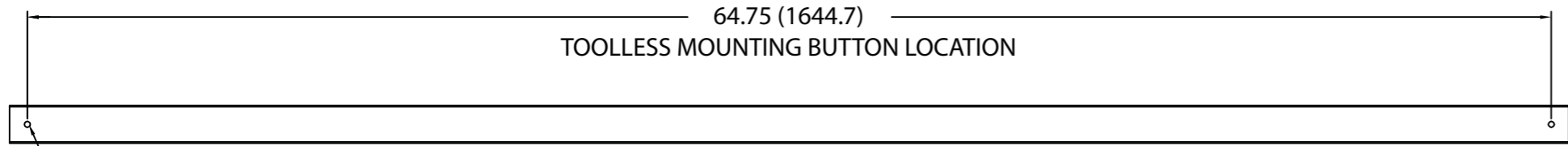

TOOLLESS MOUNTING BUTTON 2X

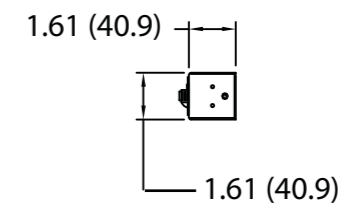
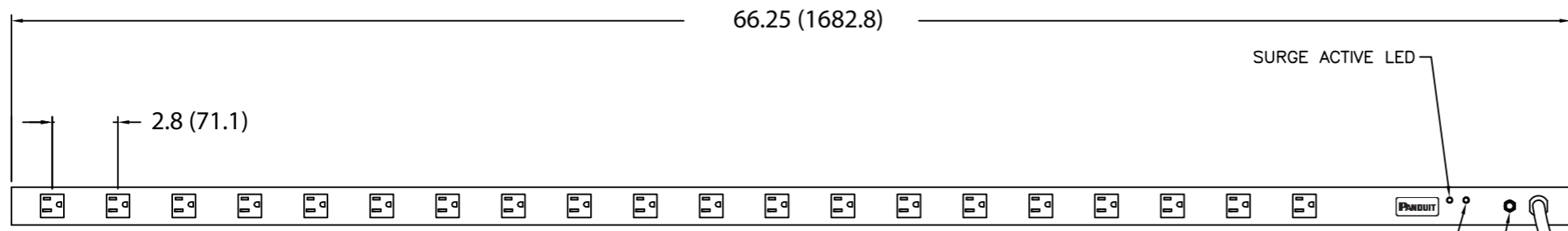

PLUG
15 AMP, 125V, SINGLE-PHASE
STRAIGHT BLADE
NEMA 5-15P

TWENTY (20)
RECEPTACLES
20 AMP, 125V
STRAIGHT BLADE
NEMA 5-15R

REV	DATE	BY	CHK	DESCRIPTION	ECN	R	CUST	SUP	OTH
01A	9-11-12	PIP		A. ADDED NOTE #9. B. UPDATED BUTTON MOUNTING NOTE.	09V098YB				
00A	10-26-11	MRWA	KRKE	RELEASED TO PRODUCTION	09V098YB				

MODEL FILENAME	09V098YB/01.PRT
CAD FILENAME/LAYERS	09V098YB_DC/01A.PRT
PANDUIT CORP. TINLEY PARK, ILLINOIS	
VERTICAL, (20) 5-15R POWER OUTLET UNIT CUSTOMER DRAWING	
UNLESS OTHERWISE SPECIFIED, DIMENSIONAL TOLERANCES ARE: INCHES X.X +/- 0.03 X.XX +/- 0.015 X.XXX +/- 0.005 [METRIC - MILLIMETER] X.X +/- 0.8 X.XX +/- 0.4 X.XX +/- 0.13 ANGLE +/- 1°	
UNLESS OTHERWISE SPECIFIED, ALL DIMENSIONS ARE GIVEN IN INCHES, THIRD ANGLE PROJECTION	SCALE NONE
DRAWN BY MRWA	MAT'L:
DATE 10-26-11	
CHK'D KRKE	DWG NO. 09V098YB
	DWG SIZE B

2



1

X-ON Electronics

Largest Supplier of Electrical and Electronic Components

Click to view similar products for [Power Outlet Strips](#) category:

Click to view products by [Panduit](#) manufacturer:

Other Similar products are found below :

[G20IG606](#) [1301430288](#) [1301530208](#) [1302100069](#) [1301430321](#) [1301530054](#) [1447B163](#) [1585T16A1RA](#) [UL602CB-6](#) [UL7408-6](#) [ULHC4-15](#)
[V20IG606](#) [UL2063BD](#) [TSB](#) [1301530203](#) [4748.03](#) [4309](#) [UL7208-15](#) [3083](#) [3050F](#) [3090](#) [1301530132](#) [1301530117](#) [1301530164](#) [1301530050](#)
[1301530141](#) [1301430252](#) [1301530179](#) [1301530065](#) [1301350158](#) [1301530052](#) [1301530068](#) [1301530120](#) [HB0B1L4BT08W1](#)
[VB0D2B2BM30P1](#) [HA0A1D0CA10E1](#) [HA0A1M2CM10E1](#) [HA1A1D0CA10E1](#) [VB0B1L2BN24H1](#) [PN1A1C0BA10E1](#) [HA0B1E0CA1081](#)
[HA0D2U0CA1081](#) [HA0D2A0CA1081](#) [HA1D2U0CA1081](#) [HA1D2A0CA1081](#) [HB1B2J0AA10M1](#) [LZ1D2A0FA0AJ1](#) [LZ1D2P0FA0AL1](#)
[VB0B1L4CN48M1](#) [MA002](#)