

This document is the property of Amphenol Corporation and is delivered on the express condition that it is not to be copied, reproduced or used, in whole or in part, for manufacture or sale by anyone other than Amphenol Corporation without the prior consent, at that no right is granted to disclose or to use any information in this document.

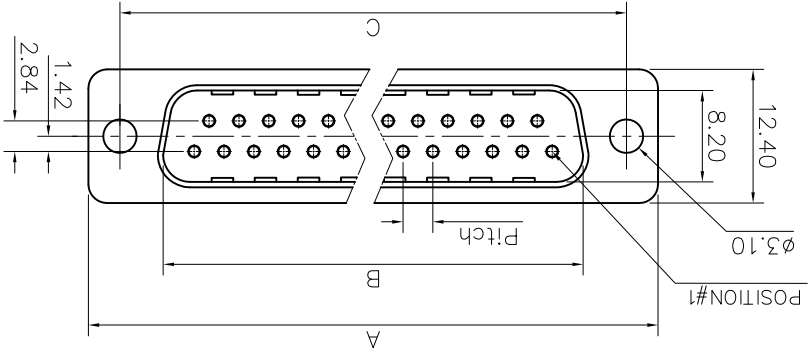

| | | | | |
|------------|-------|-------|-------|-------|
| DIMS SHELL | A | B | C | Pitch |
| | 30.70 | 16.80 | 25.00 | 2.74 |
| | 39.00 | 25.10 | 33.30 | 2.74 |
| | 52.90 | 38.80 | 47.00 | 2.77 |
| | 69.20 | 55.30 | 63.50 | 2.77 |

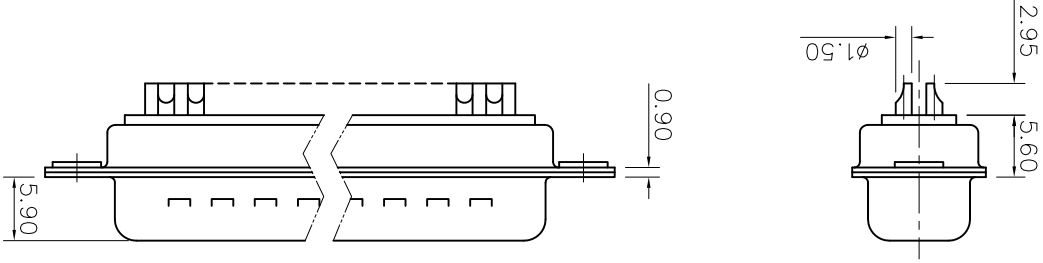

Customer Drawing

PRODUCT CODE

L 717D X XX P

- L: RoHS Compliance
- Contact type: P: Male
- Configuration: 09,15,25,37
- Shell Size: E,A,B,C
- 717D: tinned shell + dimples for plug

SHELL : Steel 2.5um(100u") min tin over 1.25um(50u") min nickel
BODY : Glass filled thermoplastic.
CONTACTS : Flame retardant to UL94 V-0,Color Black.
ELECTRICAL : Voltage rating : 300 V RMS at 50 Hz
 0.1um(4u") min gold over 1.25um(50u") min nickel
 Current rating 7.5A.
 Insulation resistance >5000 M Ohms
 Withstanding Voltage >1000V AC for one minute
 Contact resistance 20 mohms max.
CLIMATIC : Temperature range -55 °C up to +125°C
 Damp heat 21 days(40 °C-95% HR)
MARKING : Amphenol...(Series No.)
 Commercial reference
 Manufacturing date

D-SUB TECHNICAL DATA

| REV | SYM | ECN | DESCRIPTION | DATE | APPROVED |
|-----|-----|------|-----------------------|----------|----------|
| 1 | | HK-- | First Release Drawing | 12/26/07 | IP |

UNLESS OTHERWISE SPECIFIED
 TOLERANCES
 U.S. METRIC
 .X +/
 .XX +/
 .XXX +/
 FRACTIONS +/
 ANGLES +/
 Z

| | |
|----------|-------------|
| DATE | APPROVAL |
| 12/26/07 | |
| CHECKED | U.S. METRIC |
| 12/26/07 | |
| CHECKED | U.S. METRIC |
| 12/26/07 | |

FOR MATERIALS AND FINISHES
 REMOVE SHARP EDGES
 SEE NOTES
 DIMENSIONS
 U.S. METRIC

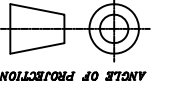

| | | |
|---------------------------------------|-------|--------------|
| SIZE | SCALE | SHEET 1 OF 1 |
| A4 | NONE | |
| DRAWING NO. | REV | |
| C L717DXXXP | 1 | |
| Machined contacts connector, D series | | |

Amphenol

Amphenol East Asia Limited

X-ON Electronics

Largest Supplier of Electrical and Electronic Components

Click to view similar products for [D-Sub Standard Connectors](#) category:

Click to view products by [Amphenol](#) manufacturer:

Other Similar products are found below :

[DCM37S732N](#) [DAM15P500](#) [DEV09S364GTLF](#) [DEM09P032N](#) [DDM50P732N](#) [DAM15S332N](#) [173109-2218](#) [173109-2466](#) [173109-2436](#)
[173109-2435](#) [56F706-005-LI](#) [56F711-015](#) [015-0341-000](#) [015-0372-008](#) [015-8544-011](#) [017041-0005](#) [020419-0104](#) [012-0515-000](#) [012-9507-](#)
[034](#) [012-9507-114](#) [012-9534-001](#) [020745-0008](#) [609-25P](#) [M24308/2-23Z](#) [M243082310F](#) [M243082410F](#) [M243082411F](#) [M24308/4-21](#)
[CT1A18-11PSA206](#) [CT1N36-5SC](#) [CT2-16S-17PS](#) [CT2-20-15PCAU](#) [CT2-24-12PS](#) [CT2-24-28PSF127A206](#) [CT2-32-9PC](#) [CT6F9767-14-4-](#)
[14S-5PC](#) [CT6FA10SL-4PS](#) [CT7-18-10SC](#) [CT7-18-10SCAU](#) [CT7-18-12SCAU](#) [CT7-18-1PC](#) [CT7-18-1PCAU](#) [CT7-18-21SCAU](#) [M83513/01-](#)
[FC](#) [M83723/76W24619 L/C](#) [M85049/48-3-2F](#) [69001-865](#) [6STD09PCM99B70X](#) [6STD09SCM99B30X](#) [6STD09SCT99S40X](#)