

THIS COPY IS PROVIDED ON A RESTRICTED BASIS AND IS NOT TO BE USED IN ANY WAY DETRIMENTAL TO THE INTERESTS OF PANDUIT CORP.

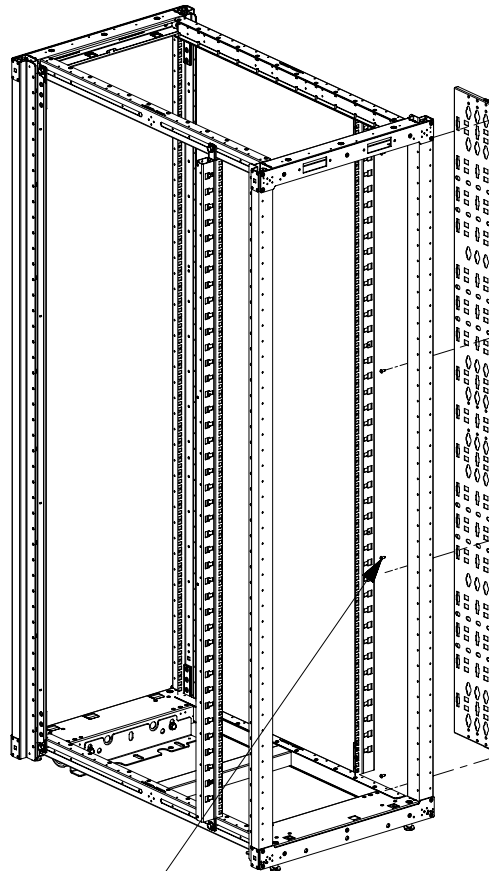
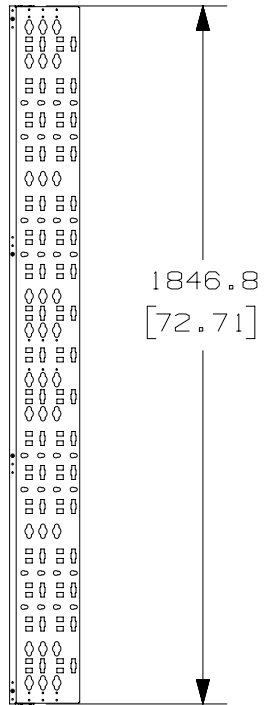
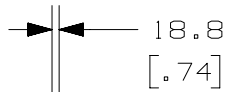
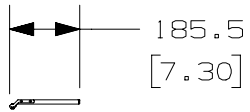

M5 SCREW
4 PLCS

6" CABLE MANAGEMENT
BRACKET

- NOTES:
1. VISIT OUR ON-LINE CATALOG AT WWW.PANDUIT.COM FOR A LIST OF CURRENT PARTS APPLICABLE FOR USE WITH THIS PRODUCT.
 2. PRIMARY DIMENSIONS ARE IN MILLIMETERS (mm).
 3. PARTS SUPPLIED:
(1) - 6" CABLE MANAGEMENT BRACKET FL
(4) - M5 PAN HEAD SCREWS
 4. COMPATIBLE COMPONENTS: (PURCHASED SEPARATELY)
- S2LR
- S1LR
- S2DR
- S1DR

| PANDUIT P/N | WEIGHT |
|-------------|-----------------------------|
| S2BRK6 | 4.2 Kg/EACH 9.2 LBS/EACH |

| REV | DATE | BY | CHK | APR | DESCRIPTION | ECN |
|-----|----------|----------|------|------|-----------------------------------|-------------|
| 01B | 6/15/17 | MEX-JAGC | BRAP | BRAP | REVISED NOTES | V09001HQ |
| 01A | 12/18/13 | MDCS | RCHA | JDWE | HEIGHT OF PART WAS 1896.8 [74.68] | 11V231AD-DC |
| 00A | 9/26/13 | PBS | RCHA | JDWE | RELEASED TO PRODUCTION | 11V231AD-DC |

| | | | | |
|------------------------|---------|--|-------|------|
| TITLE | | 6" CABLE MANAGEMENT BRACKET FG (S2BRK6) | | |
| ITEM REVISION NAME | | CUSTOMER DRAWING | | |
| DATASET FILE NAME | | 11V231AD-DC/01B | | |
| DRAWING NUMBER: | | 11V231AD-DC | | |
| MATERIAL: | | N/A | | |
| THIRD ANGLE PROJECTION | | | | |
| DRAWN BY | DATE | CHK | SCALE | SIZE |
| PBS | 9/26/13 | RCHA | NONE | A |
| SHT 1 OF 3 | | | | |

D10100DA/20

THIS COPY IS PROVIDED ON A RESTRICTED BASIS AND IS NOT TO BE USED IN ANY WAY DETRIMENTAL TO THE INTERESTS OF PANDUIT CORP.

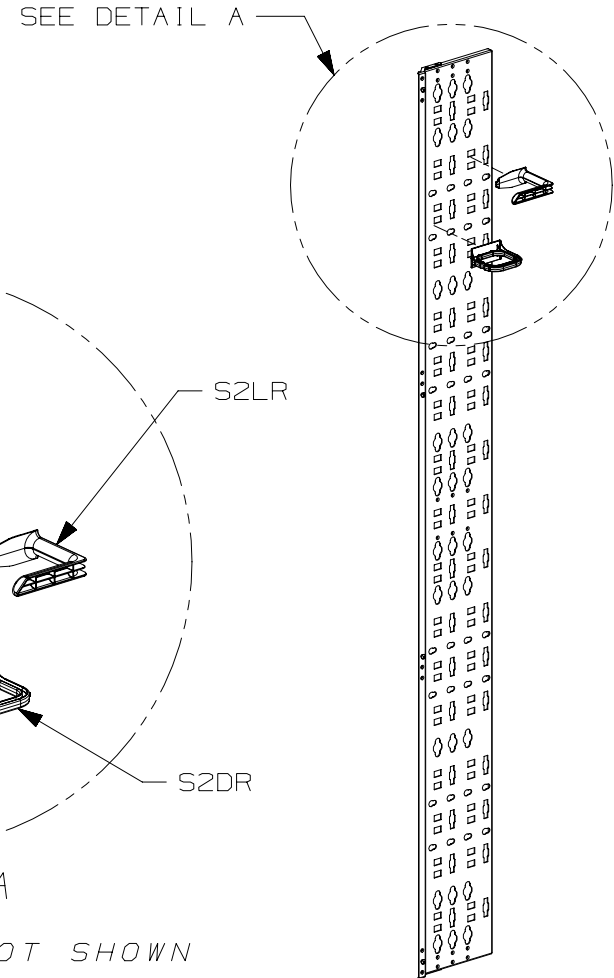
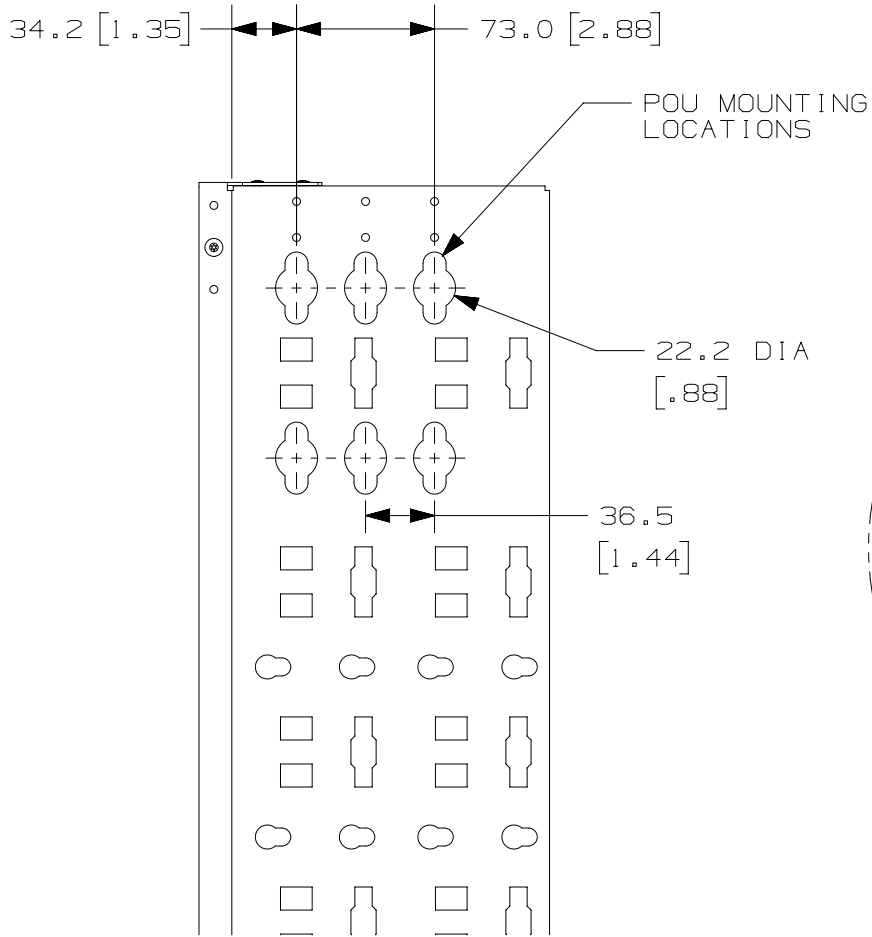

| 01B | 6/15/17 | MEX-JAGC | BRAP | BRAP | SEE SHEET 1 OF 3 FOR REVISIONS | V09001HQ | |
|-----|----------|----------|------|------|--------------------------------|-------------|--|
| 01A | 12/18/13 | MDCS | RCHA | JDWE | SEE SHEET 1 OF 3 FOR REVISIONS | 11V231AD-DC | |
| 00A | 9/26/13 | PBS | RCHA | JDWE | SEE SHEET 1 OF 3 FOR REVISIONS | 11V231AD-DC | |
| REV | DATE | BY | CHK | APR | DESCRIPTION | ECN | |

| | | | | | | | | |
|--------------------|---------|------|-------|--|------------------------|--|---|------|
| TITLE | | | | | | | 6" CABLE MANAGEMENT BRACKET FG (S2BRK6) | |
| | | | | | | | CUSTOMER DRAWING | |
| ITEM REVISION NAME | | | | | | | 11V231AD/01 | |
| DATASET FILE NAME | | | | | | | 11V231AD_DC/01B | |
| | | | | | | | MATERIAL: | |
| | | | | | | | N/A | |
| | | | | | | | DRAWING NUMBER: | |
| | | | | | | | 11V231AD-DC | |
| | | | | | THIRD ANGLE PROJECTION | | | |
| DRAWN BY | DATE | CHK | SCALE | | | | | SIZE |
| PBS | 9/26/13 | RCHA | NONE | | | | | A |
| | | | | | | | SHT 2 OF 3 | |

D10100DA/20

2

1

2

1

THIS COPY IS PROVIDED ON A RESTRICTED BASIS AND IS NOT TO BE USED IN ANY WAY DETRIMENTAL TO THE INTERESTS OF PANDUIT CORP.

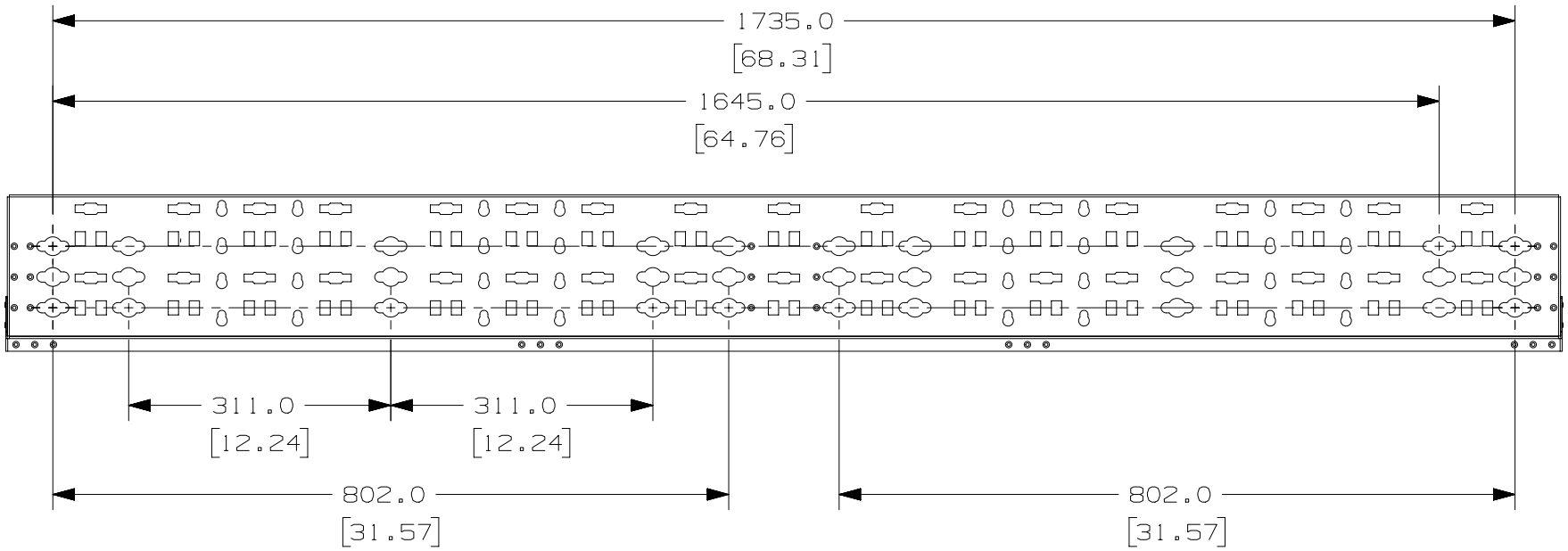

| REV | DATE | BY | CHK | APR | DESCRIPTION | ECN |
|-----|----------|----------|------|------|--------------------------------|-------------|
| 01B | 6/15/17 | MEX-JAGC | BRAP | BRAP | SEE SHEET 1 OF 3 FOR REVISIONS | V09001HQ |
| 01A | 12/18/13 | MDCS | RCHA | JDWE | SEE SHEET 1 OF 3 FOR REVISIONS | 11V231AD-DC |
| 00A | 9/26/13 | PBS | RCHA | JDWE | SEE SHEET 1 OF 3 FOR REVISIONS | 11V231AD-DC |

| | | | |
|---|--|--------------------------------|--|
| TITLE 6" CABLE MANAGEMENT BRACKET FG (S2BRK6) CUSTOMER DRAWING | | | |
| ITEM REVISION NAME 11V231AD/01 | | PANDUIT | |
| DATASET FILE NAME 11V231AD_DC/01B | | | |
| DRAWN BY PBS | | MATERIAL: N/A | |
| DATE 9/26/13 | | DRAWING NUMBER: 11V231AD-DC | |
| CHK RCHA | | THIRD ANGLE PROJECTION | |
| SCALE NONE | | SHT 3 OF 3 | |
| SIZE A | | | |

D10100DA/20

X-ON Electronics

Largest Supplier of Electrical and Electronic Components

Click to view similar products for [Racks & Rack Cabinet Accessories](#) category:

Click to view products by [Panduit](#) manufacturer:

Other Similar products are found below :

[CR-1727](#) [M00-PLN](#) [F2420](#) [F2424](#) [8310-1032-SS](#) [9104](#) [PLFF2000](#) [PLFF6000](#) [GP216](#) [PTFA60000LG](#) [H-9163-B](#) [AC220-84-1](#) [HEH050BA](#)
[1427C3](#) [BAS-5104](#) [N-700-2](#) [190-002](#) [HTL10](#) [HTS10](#) [PC-118](#) [PC-780L](#) [PC-79](#) [PC-800](#) [SC4-28](#) [F3024](#) [AKWAMT](#) [PLFF1000](#) [GRPB12PG](#)
[CG3-340S/12](#) [2CWDP36](#) [2CWDP48](#) [2SSHINGE](#) [CP-001BK](#) [CPL19431LG1](#) [R570-004-107](#) [M6123-4007-SS](#) [TS170](#) [531300535](#) [BRX-](#)
[12290](#) [C4BD3077SBK1](#) [UPS 7-17-14 PLAIN](#) [LP40](#) [5261304-07](#) [CCA26-44-01](#) [706-102](#) [CG3-160G](#) [7112C-PLN ALUM](#) [CM10](#) [TS81](#) [7142](#)