

PLEASE CHECK WWW.MOLEX.COM FOR LATEST PART INFORMATION

Part Number: **0987861018**
Status: **Active**
Overview: MOX Products
Description: 2.54mm Pitch MOX Receptacle Housing, 6 Circuits, Dual Row, Gray

Documents:

[Drawing \(PDF\)](#) [Packaging Specification PK-98786-001-001 \(PDF\)](#)
[Application Specification AS-98787-001-001 \(PDF\)](#) [RoHS Certificate of Compliance \(PDF\)](#)

General

Product Family Crimp Housings
Series **98786**
Application Power, Wire-to-Board, Wire-to-Wire
Application Tooling Part Link 63813-8500
Comments 2x3 Circuits, Contact Retention Force without secondary locking: 40N, with secondary locking: 60N
Overview [MOX Products](#)
Product Name MOX
UPC 822348761319

Physical

Circuits (maximum) 6
Color - Resin Gray
Gender Receptacle
Glow-Wire Capable No
Keying to Mating Part None
Lock to Mating Part Yes
Material - Resin Nylon
Net Weight 1.060/g
Number of Rows 2
Packaging Type Bag
Panel Mount No
Pitch - Mating Interface 2.54mm
Pitch - Termination Interface 2.54mm
Polarized to Mating Part Yes
Stackable No
Temperature Range - Operating -40°C to +100°C

Electrical

Current - Maximum per Contact 7.5A

Solder Process Data

Lead-freeProcess Capability N/A

Material Info

Engineering Number 49908228

Reference - Drawing Numbers

Application Specification AS-98787-001-001
Packaging Specification PK-98786-001-001
Sales Drawing SD-98786-001

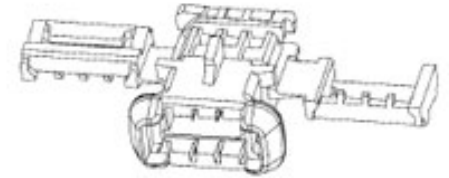

Series image - Reference only

EU ELV

Compliant

EU RoHS

Compliant

REACH SVHC

Not Contained Per
-ED/01/2018 (15
January 2018)

Halogen-Free

Status

Not Relevant

Need more information on product environmental compliance?

Email productcompliance@molex.com
Please visit the [Contact Us](#) section for any non-product compliance questions.

China ROHS	Not Relevant
ELV	Compliant
RoHS Phthalates	Not Contained

Search Parts in this Series

[98786](#) Series

Mates With

[98780](#) Male Header, [98787](#) MOX Plug Housing

Use With

[98658](#) MOX Crimp Terminal

Application Tooling | [FAQ](#)

Tooling specifications and manuals are found by selecting the products below. Crimp Height Specifications are then contained in the Application Tooling Specification document.

Global

Description

Product #

Extractor Tool for MOX 0.635mm	0638138500
--------------------------------	----------------------------

This document was generated on 03/01/2018

PLEASE CHECK WWW.MOLEX.COM FOR LATEST PART INFORMATION

X-ON Electronics

Largest Supplier of Electrical and Electronic Components

Click to view similar products for [Automotive Connectors](#) category:

Click to view products by [Molex](#) manufacturer:

Other Similar products are found below :

[003-018-000](#) [600858](#) [60403001](#) [60993906-B](#) [60993913-B](#) [629515004020001](#) [M902-2131](#) [M902-2161](#) [M902-2344](#) [72.330.1035.1](#)
[73.353.4028.0](#) [F118010](#) [F119300-B](#) [F132210](#) [F132210-B](#) [F166900](#) [F180100](#) [F258300](#) [F258300-B](#) [F294300-B](#) [F339100](#) [F339700](#) [F358300-](#)
[B](#) [F374110](#) [F407400](#) [F412210](#) [F427600](#) [F444110](#) [F487000](#) [F495100-B](#) [F500900-B](#) [F509500B-B](#) [770444-1](#) [776880-1](#) [827153-1](#) [881735-1](#)
[8N1515-32-24P](#) [9-1326727-8](#) [9-1326729-8](#) [925467-1](#) [925474-1](#) [928905-1](#) [936398-2](#) [964562-1](#) [964562-4](#) [964731-2](#) [965051-1](#) [968782-1](#)
[GT17SA-8DS-HU](#) [GT17VS-10DP-5.2CF](#)