

REVISIONS				
#	LY#	DESCRIPTION	DATE	OWN APVD
	D	REVISED PER ECO-16-009784	20JUN16	RS GJ

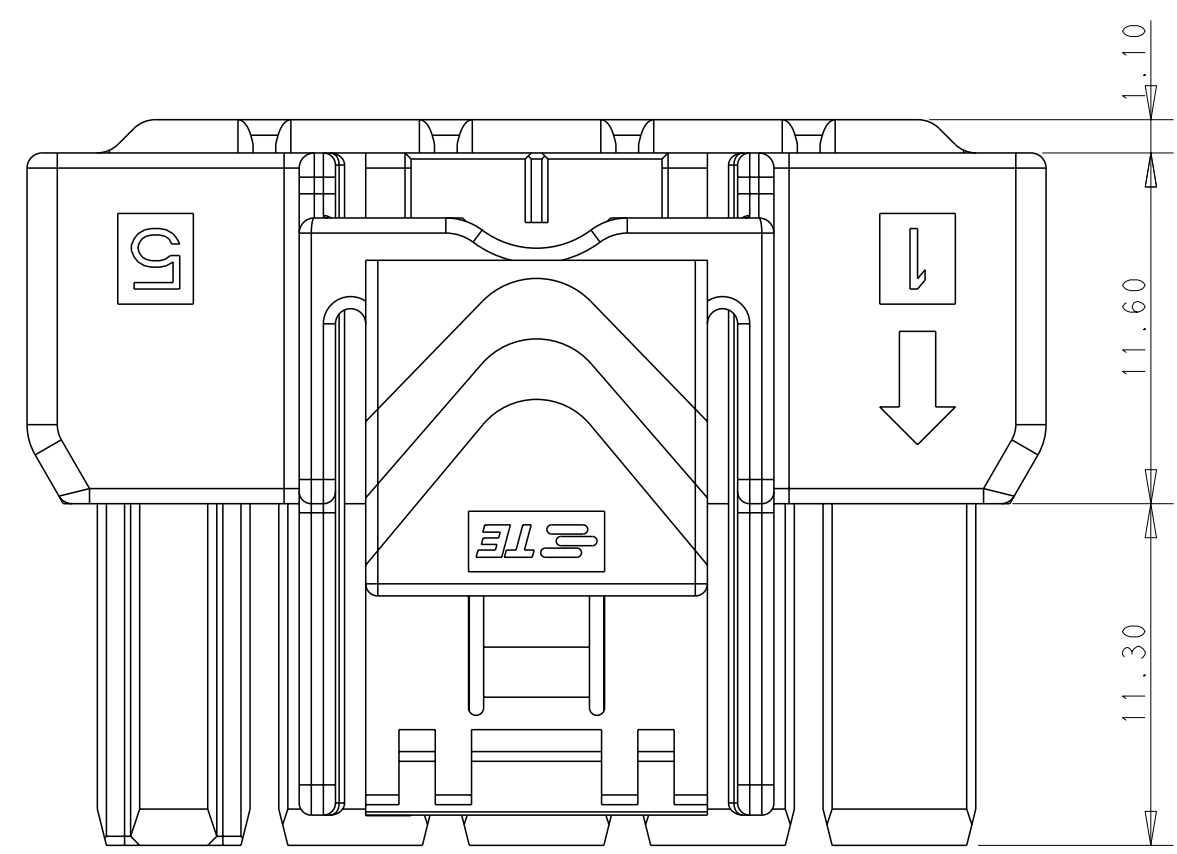

POS.	DIM. A
3*5	33.70
3*4	27.70
3*3	21.70

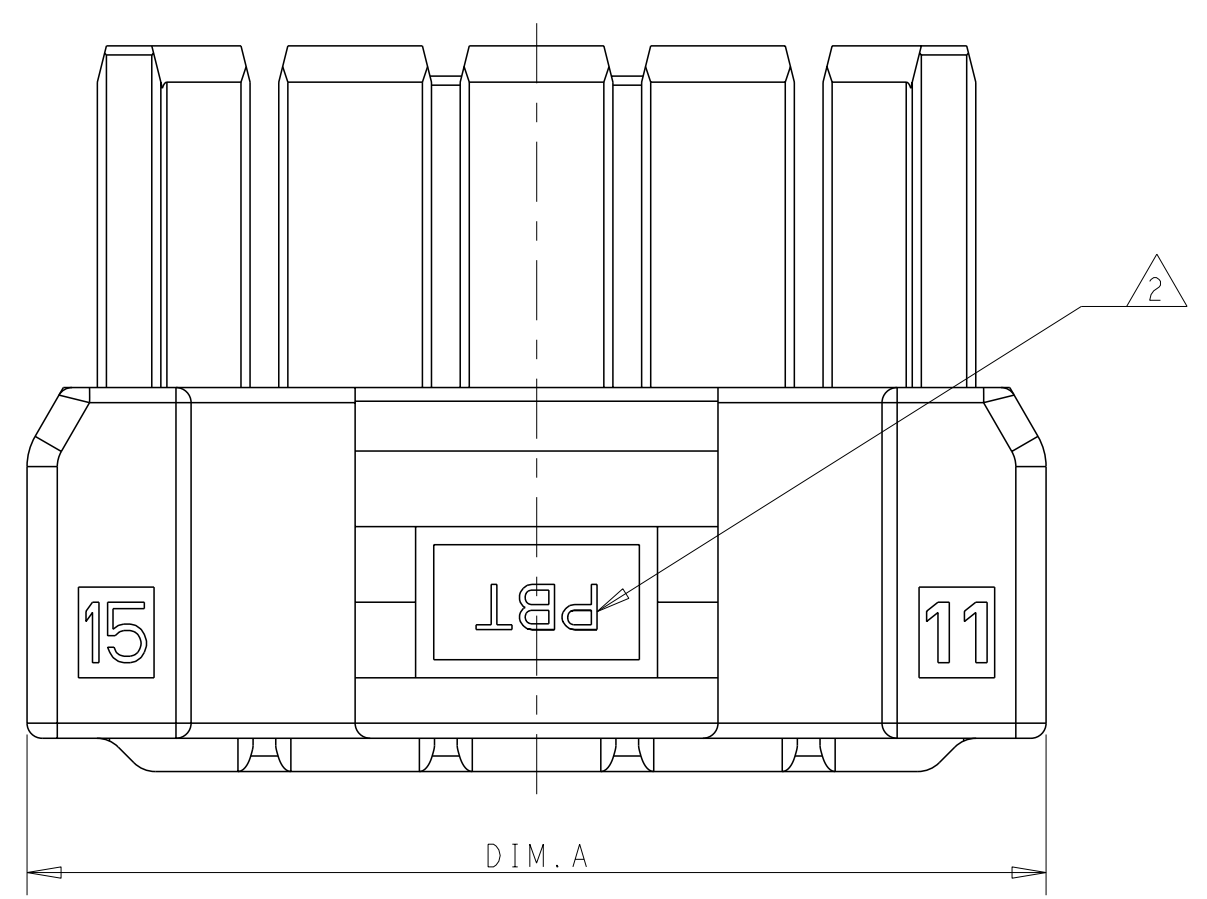
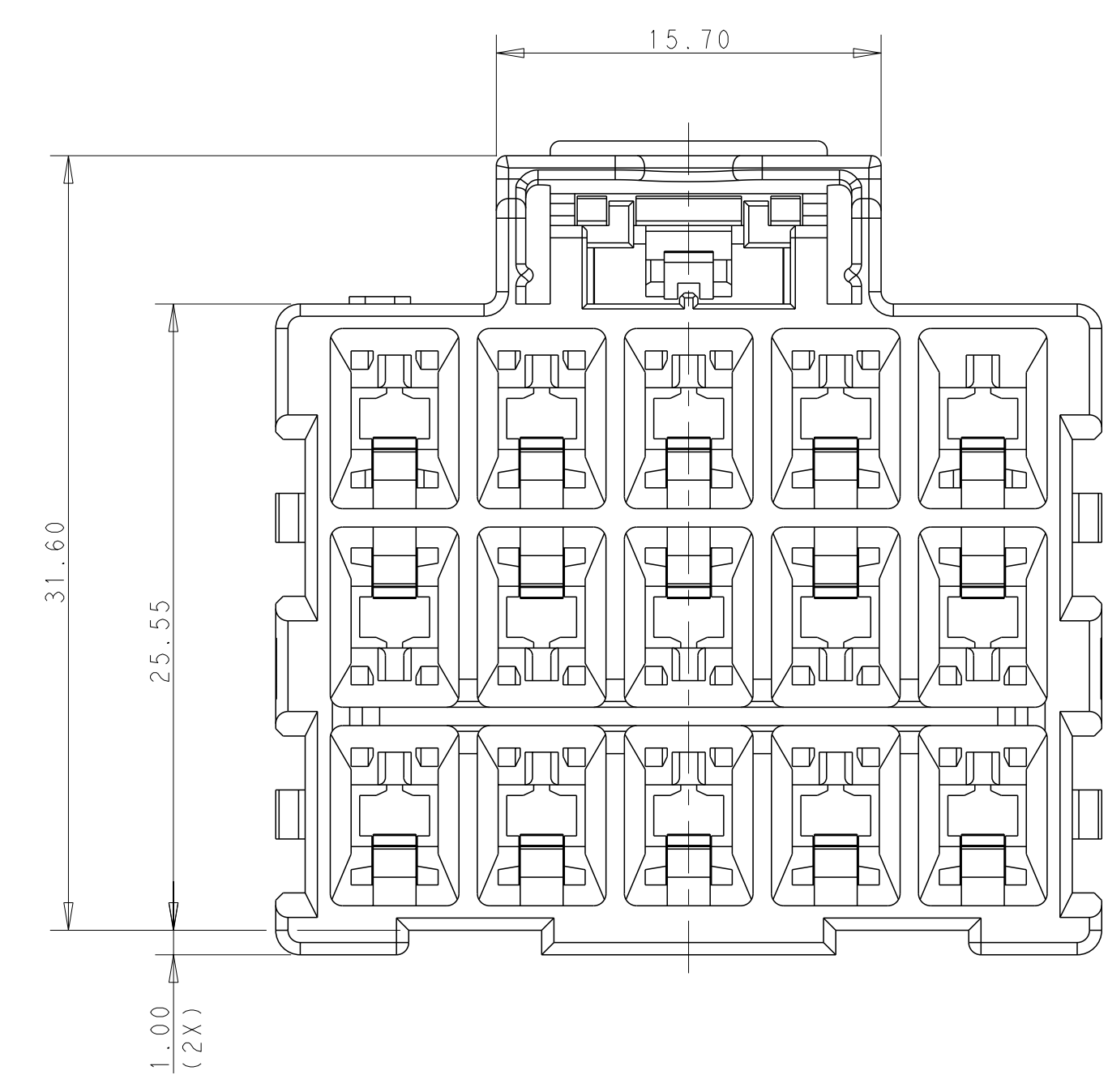
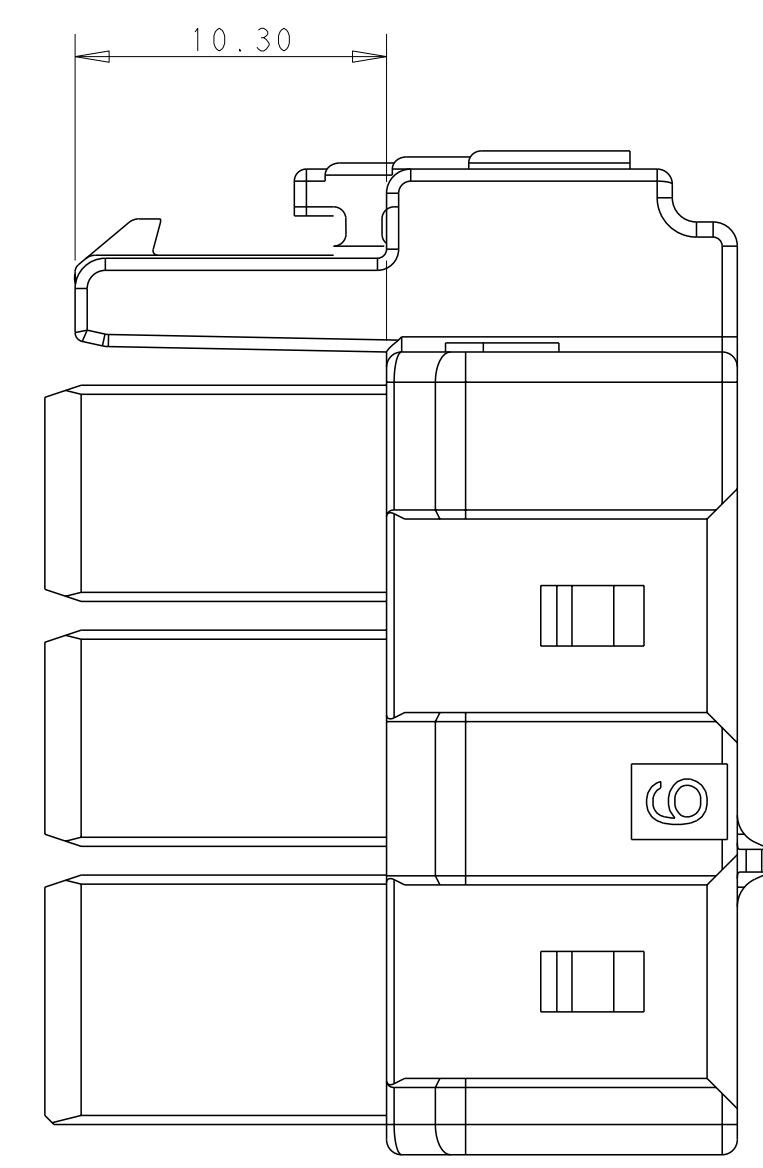
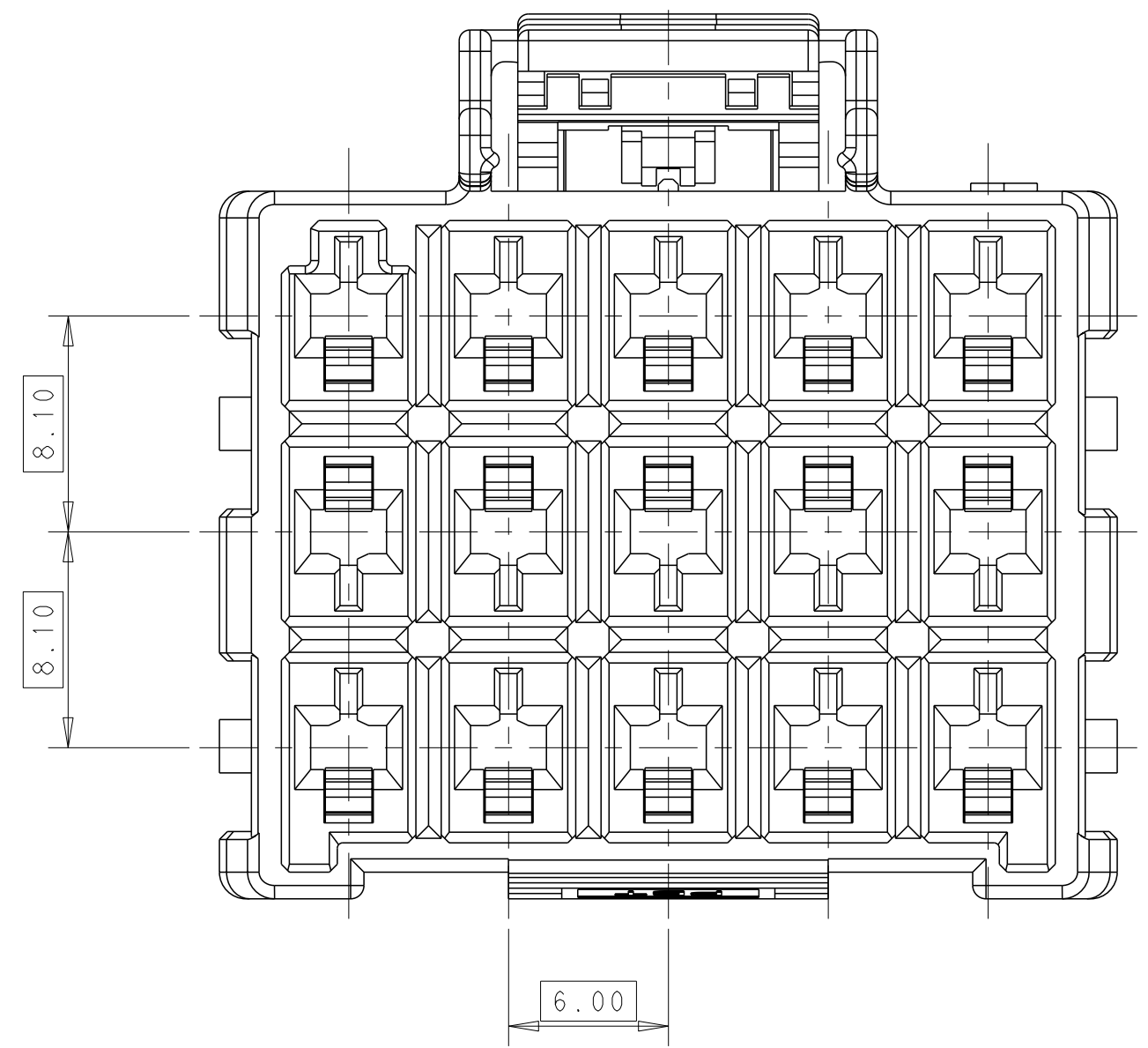

- ⚠ MATERIAL:
 LEVEL 1:PBT,STANDARD TEMPERATURE 105°C
 KEY A:NATURAL; KEY B:PURPLE; KEY C:BLUE; KEY D:YELLOW

 LEVEL 2:NYLON,HIGH TEMPERATURE 150°C
 KEY A:LIGHT GREY; KEY B:RED; KEY C:BLACK; KEY D:NATURAL
- ⚠ MATERIAL MARK:
 LEVEL 1:PBT,LEVEL 2:HDT
- 3 APPLICABLE CONTACT P/N
 RECEPTACLE CONTACT:1971237/1971779/81/83/85/87-*, 2238066-*
- 4 MATING CONN. P/N
 CAP HSG:*-1971874/5-*,
 DOUBLE ROW LOCK PLATE:*-1971778-*,SINGLE ROW LOCK PLATE:*-1971777-*

5 This product has not completed validation testing.

THIS DRAWING IS A CONTROLLED DOCUMENT.		OWN TOMMY WU 09JUL2012	TE Connectivity NAME PLUG HOUSING,TRIPLE ROW POWER TRIPLE LOCK
DIMENSIONS:		CHK HAPYE WU 09JUL2012	
TOLERANCES UNLESS OTHERWISE SPECIFIED:		APVD YUHONG MAO 09JUL2012	
mm		PRODUCT SPEC	
0 PLC	±	108-106118	SIZE
1 PLC	±0.35	APPLICATION SPEC	CAGE CODE
2 PLC	±0.25	114-106118	DRAWING NO
3 PLC	±	WEIGHT	RESTRICTED TO
4 PLC	±	Customer Drawing	A100779C=1971876
ANGLES	±	SCALE 3:1	SHEET 1 OF 2
FINISH	-	REV D	

REVISIONS				
P	LY#	DESCRIPTION	DATE	APPV
-	-	SEE SHEET 1	-	-

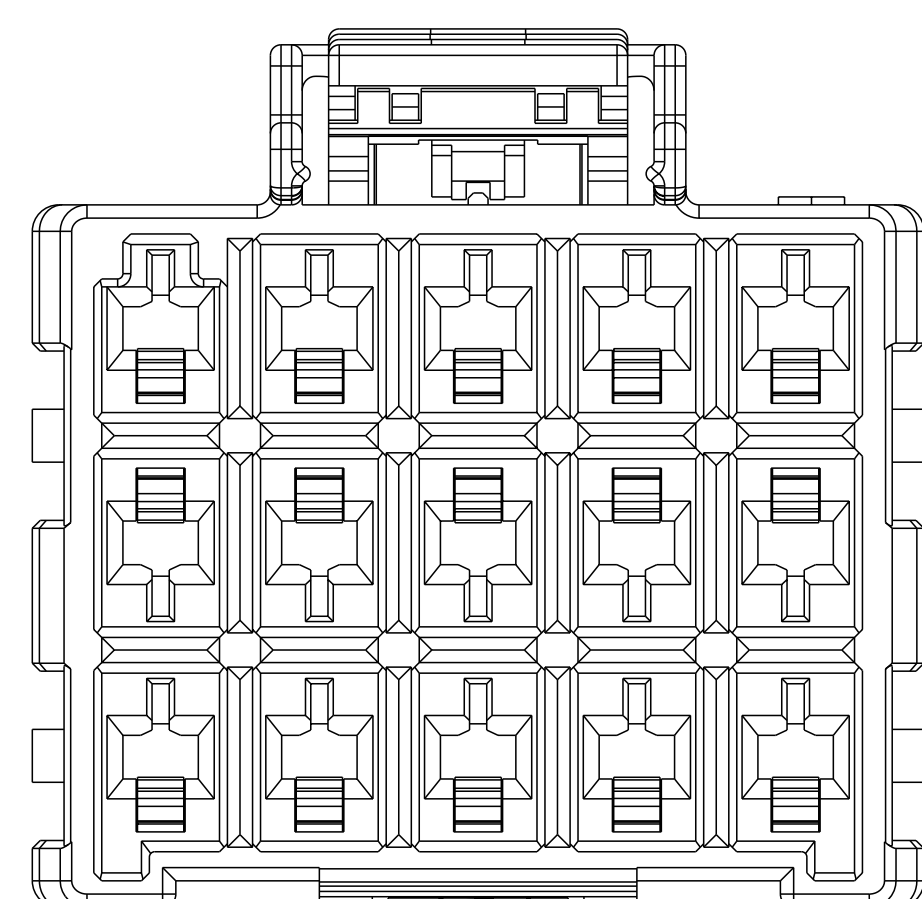
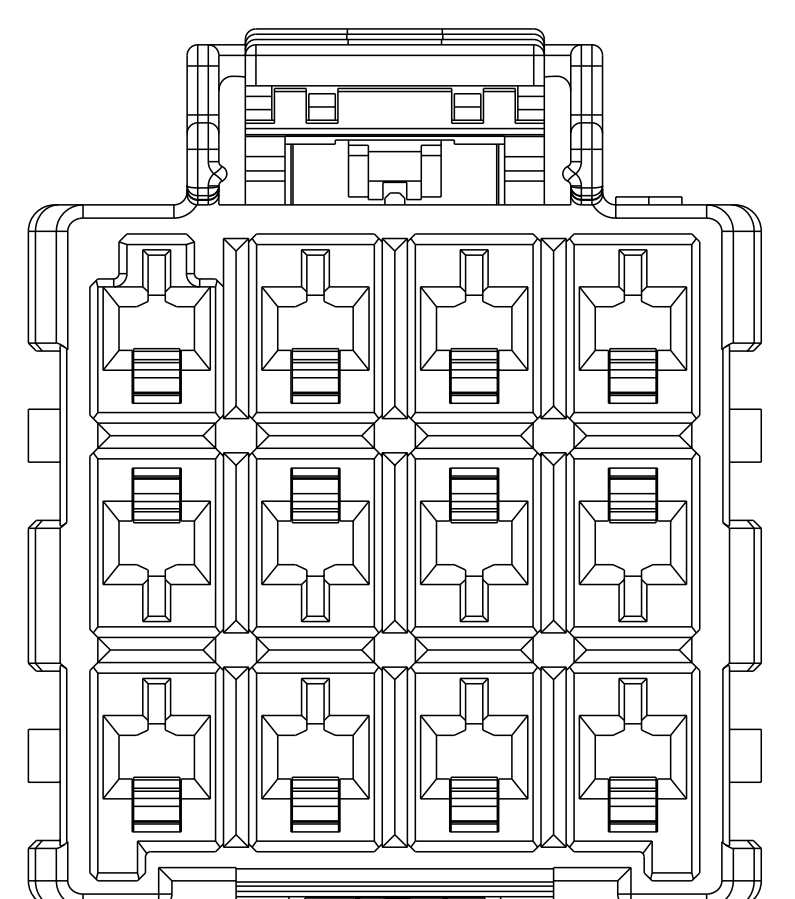
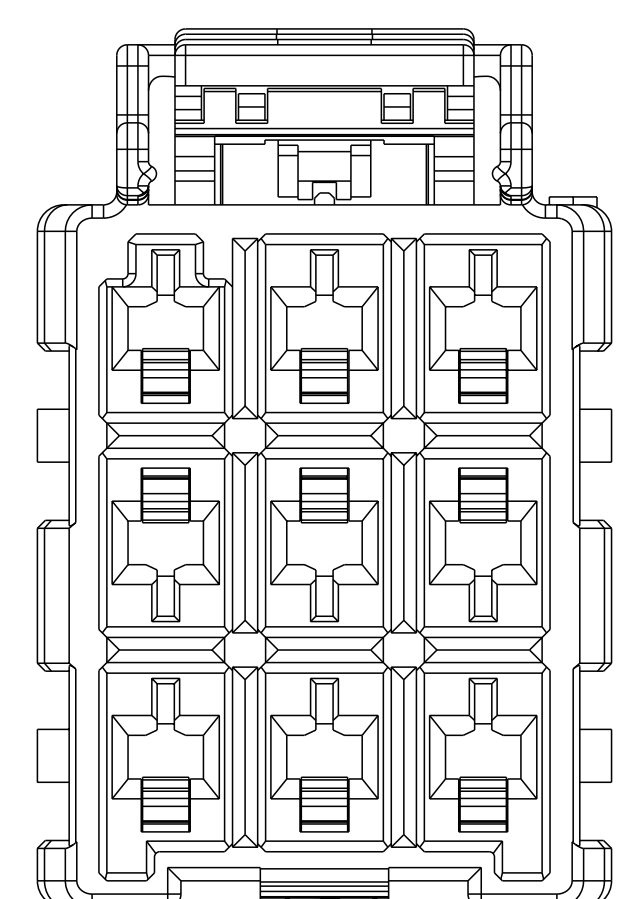
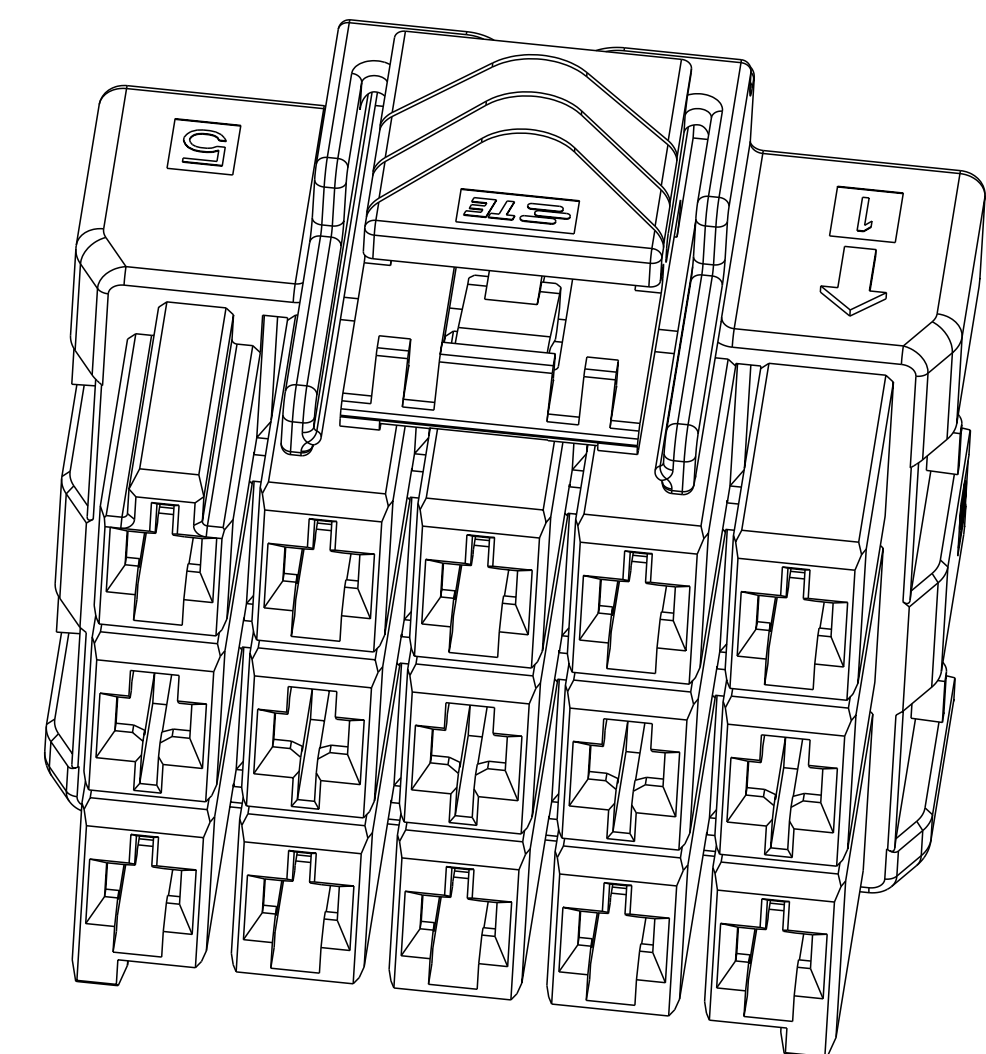
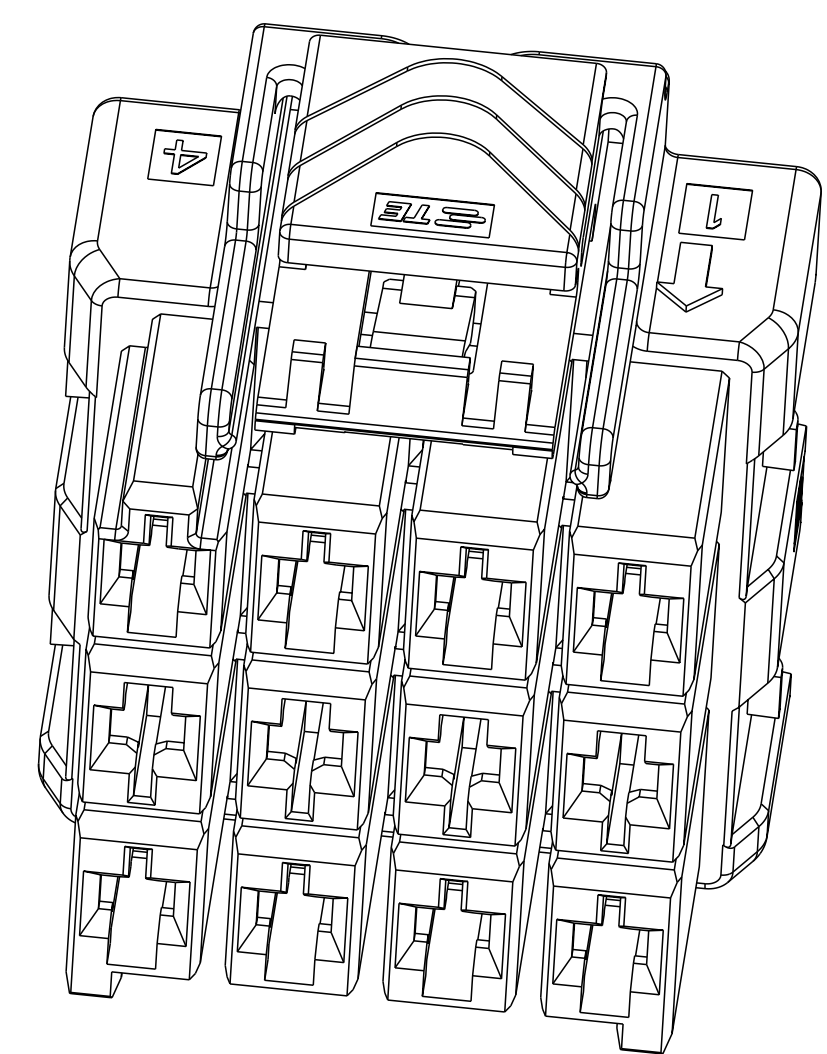
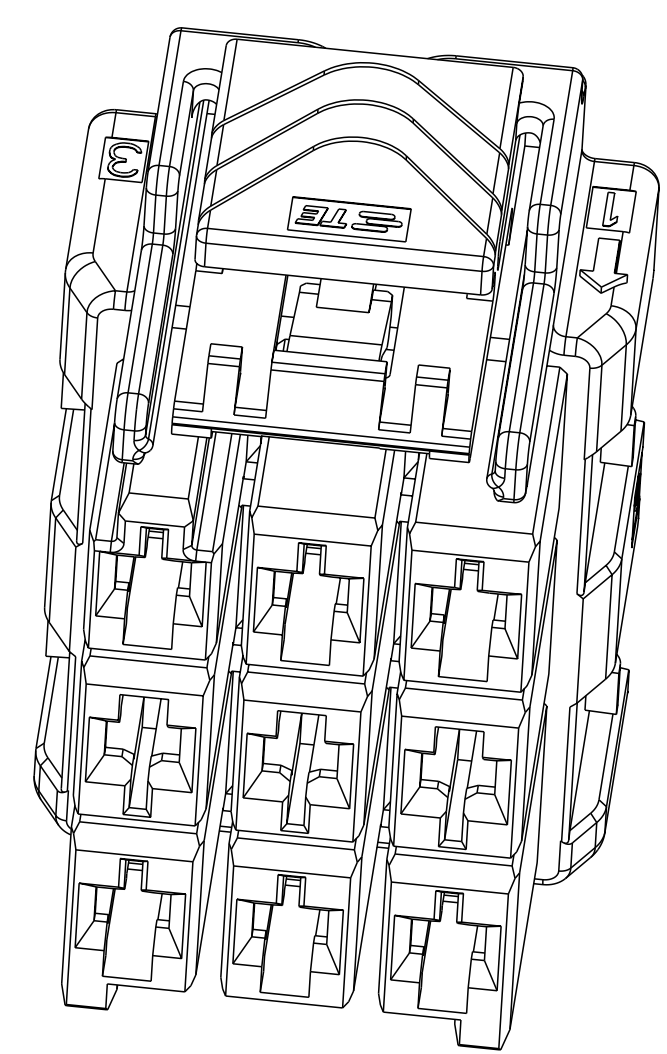

POS.	MATERIAL	KEY	P/N
3*5		LEVEL 1	KEY A 1-1971876-7
			KEY B 2-1971876-7
			KEY C 3-1971876-7
			KEY D 4-1971876-7
3*4		LEVEL 1	KEY A 5-1971876-7
			KEY B 6-1971876-7
			KEY C 7-1971876-7
			KEY D 8-1971876-7
3*3		LEVEL 1	KEY A 1-1971876-4
			KEY B 2-1971876-4
			KEY C 3-1971876-4
			KEY D 4-1971876-4
3*3		LEVEL 2	KEY A 5-1971876-4
			KEY B 6-1971876-4
			KEY C 7-1971876-4
			KEY D 8-1971876-4

3*3 POSITIONS

3*4 POSITIONS

3*5 POSITIONS

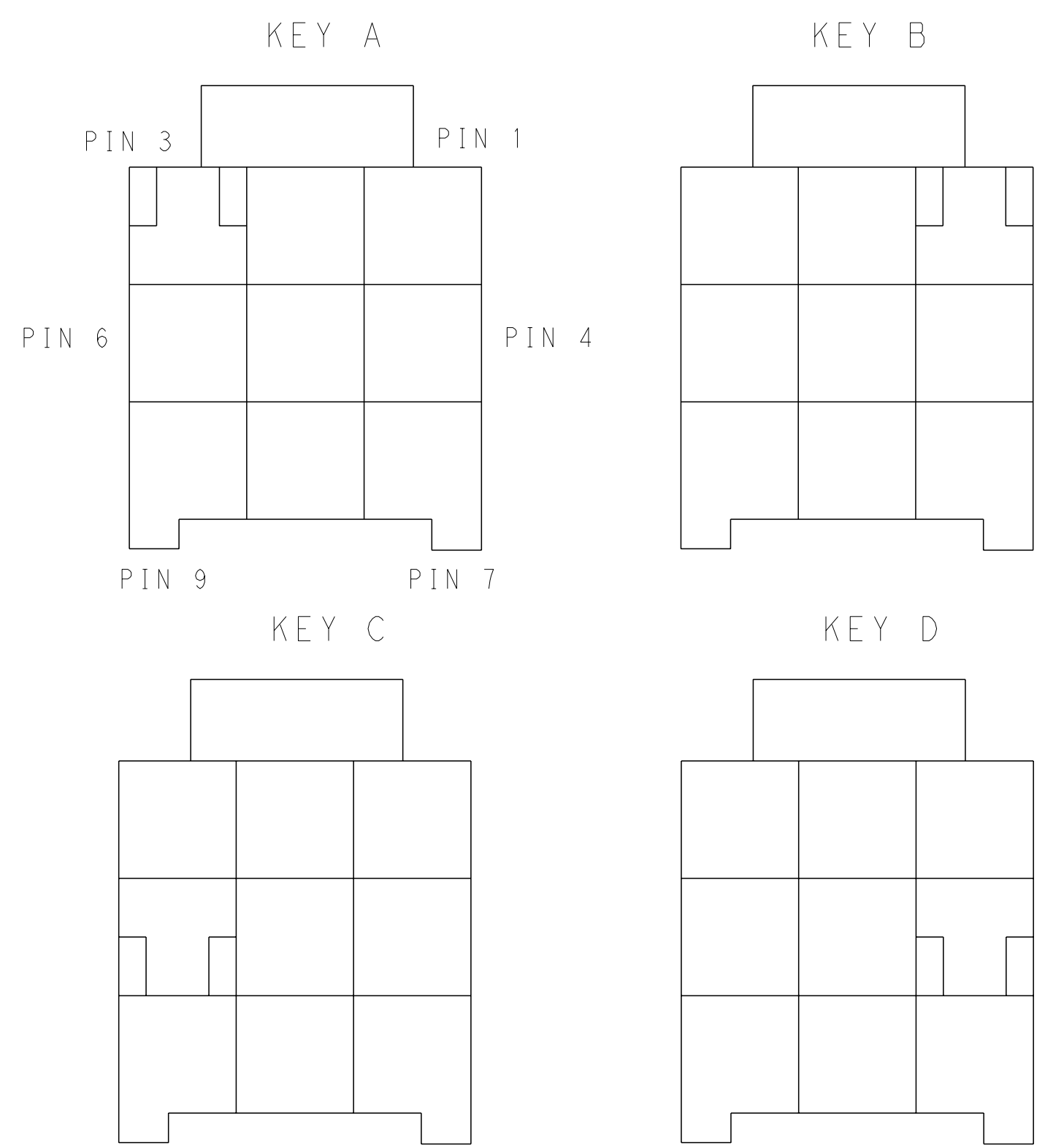

KEYING FOR 3*3 POS.

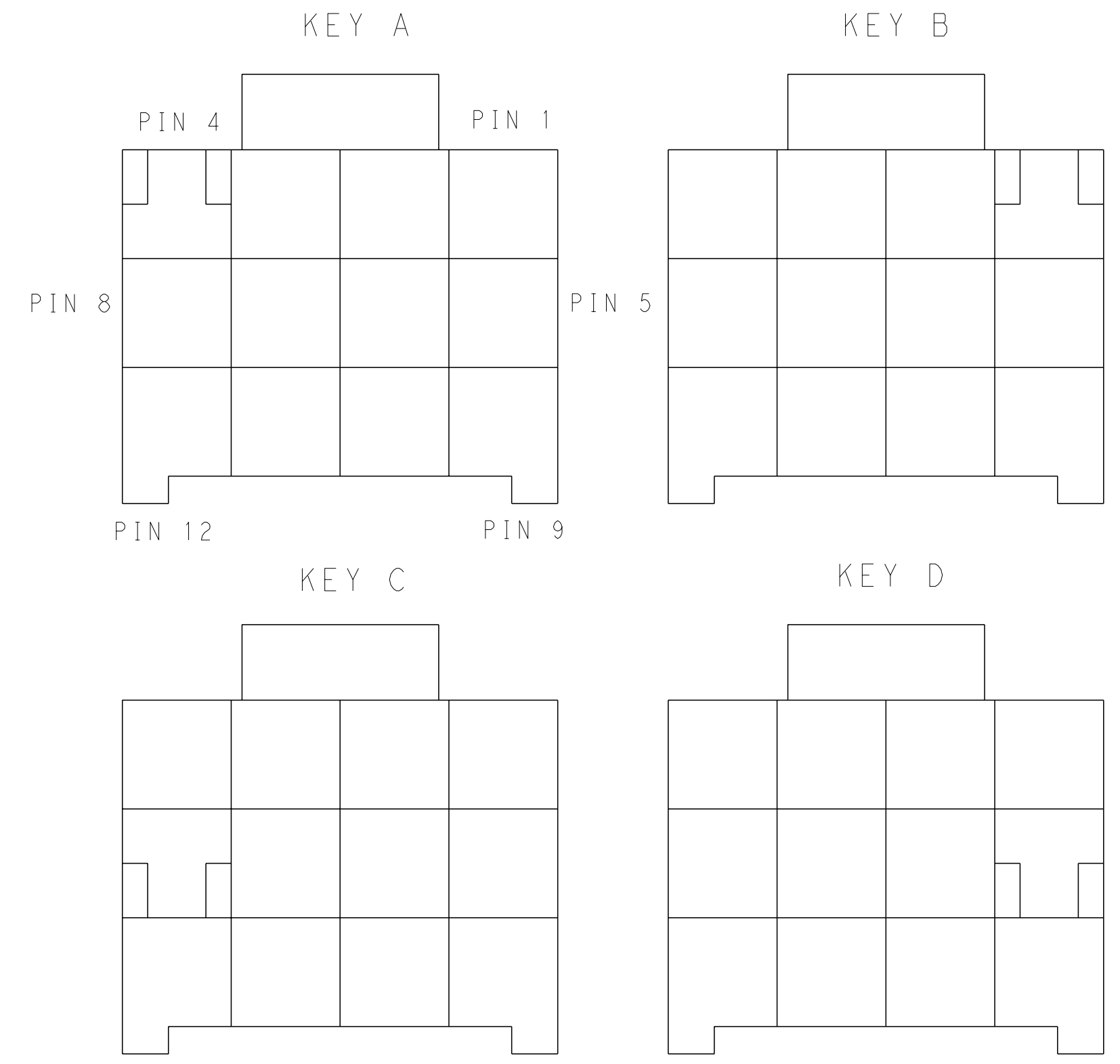

KEYING FOR 3*4 POS.

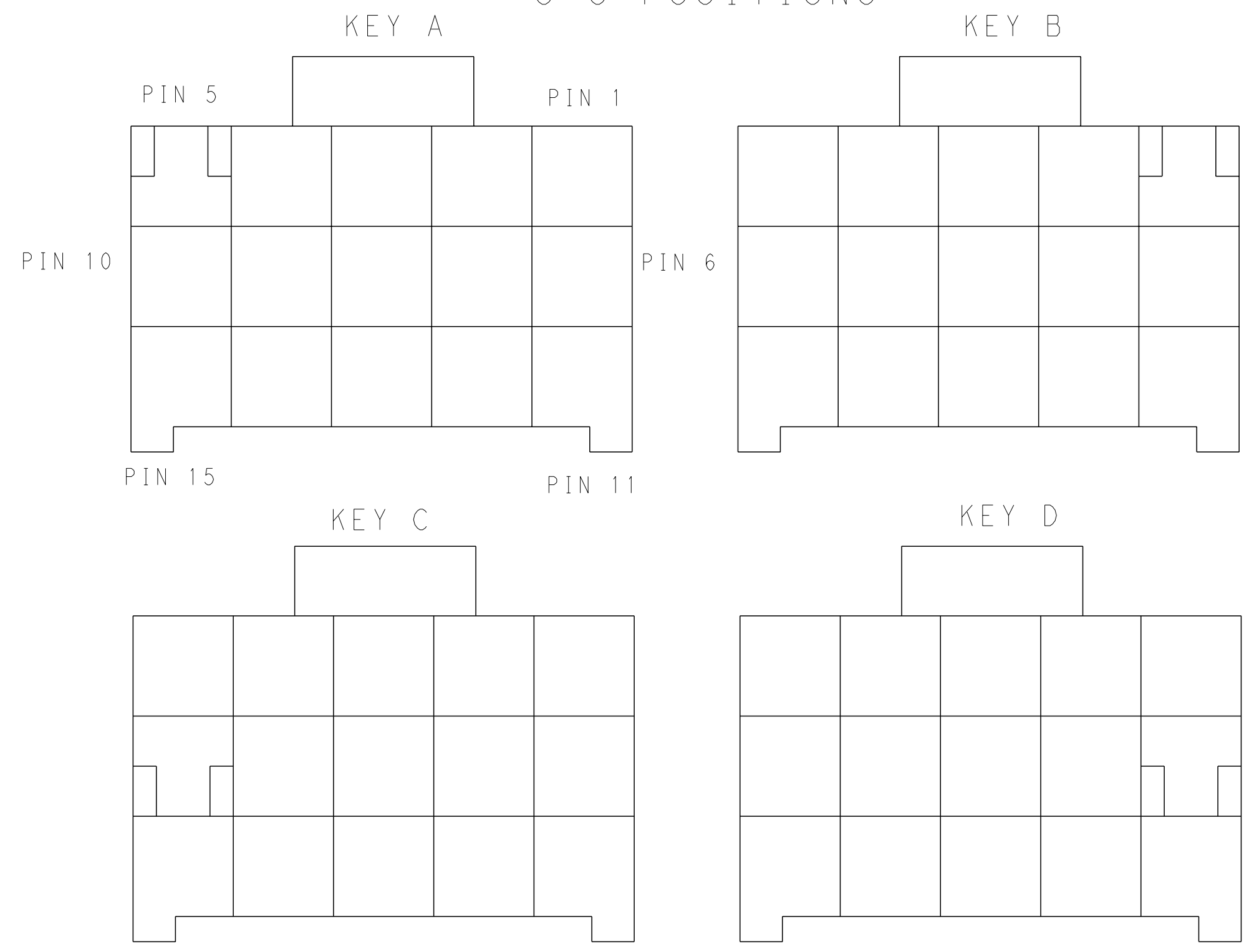

KEYING FOR 3*5 POS.

THIS DRAWING IS A CONTROLLED DOCUMENT.		OWN TOMMY WU 09JUL2012	TE Connectivity PLUG HOUSING, TRIPLE ROW POWER TRIPLE LOCK
DIMENSIONS: mm		CHK HAPYE WU 09JUL2012	
TOLERANCES UNLESS OTHERWISE SPECIFIED:		APVD YUHONG MAO 09JUL2012	
0 PLC ± 1 PLC ±0.35 2 PLC ±0.25 3 PLC ± 4 PLC ± ANGLES FINISH ±		NAME PRODUCT SPEC 108-106118 APPLICATION SPEC 114-106118 WEIGHT	
MATERIAL		Customer Drawing	SIZE CAGE CODE DRAWING NO. RESTRICTED TO A1 00779C=1971876 SCALE - SHEET 2 OF 2 REV D

X-ON Electronics

Largest Supplier of Electrical and Electronic Components

Click to view similar products for [Heavy Duty Power Connectors](#) category:

Click to view products by [TE Connectivity](#) manufacturer:

Other Similar products are found below :

[1424439](#) [1424438](#) [09330062652](#) [2-8675P1](#) [605601-1](#) [6340G1](#) [6341G1](#) [6360G1](#) [6373G1](#) [6374g2](#) [6396G1](#) [647757-1](#) [66394-4](#) [6643411-1](#)
[6646058-2](#) [6646137-1](#) [6646138-1](#) [6646348-1](#) [6646479-1](#) [6646608-1](#) [6646786-1](#) [6646940-1](#) [6651091-1](#) [6651525-1](#) [6651529-1](#) [6651778-1](#)
[6651788-1](#) [696465-1](#) [696475-1](#) [73000005059](#) [73000005349](#) [73000005642](#) [73080255059](#) [73080965046](#) [765-15-0080A](#) [765-16-0080B](#)
[789.700-44](#) [789.700-54](#) [80-1010](#) [80-9](#) [827381-1](#) [829992-1](#) [902-77-02113](#) [PL00U-301-10D10](#) [PM103MOOLOO](#) [PM16S1620S32-50](#)
[PM212MOOLOO](#) [PM309FOOLOO](#) [PM324FOOLCH](#) [PMHPAF11S03](#)