

SEE NOTE		SEE NOTE	
MATERIAL		FINISH	
DIMENSIONS: MM		TOLERANCES UNLESS OTHERWISE SPECIFIED:	
THIS DRAWING IS A CONTROLLED DOCUMENT.		DWN J. LAI 31AUG2009	
CHK S. CHIEN 31AUG2009		APVD W. KODAMA 31AUG2009	
NAME		NAME	
TE Connectivity		SLIMLINE SATA RECEPTACLE, RIGHT ANGLE, TH, 1.5SH TOP MOUNT	
RESTRICTED TO		DRAWING NO	
REV B		CAGE CODE	
REV 3		SIZE	
1 OF 3 SHEET		SCALE	
CUSTOMER DRAWING		WEIGHT 1.05 GRAMS	
A3		A3	
00779		00779	
C=1735777		C=1735777	

0.762um [30µ"]	1735777-3
0.381um [15µ"]	1735777-2
G/F	1735777-1
MINIMUM	PART NUMBER
GOLD PLATING	

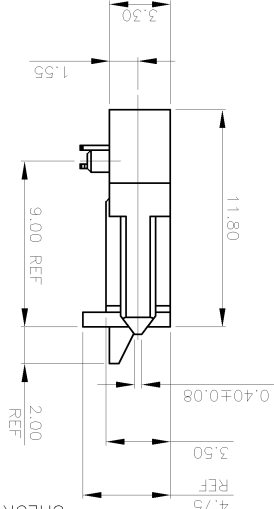
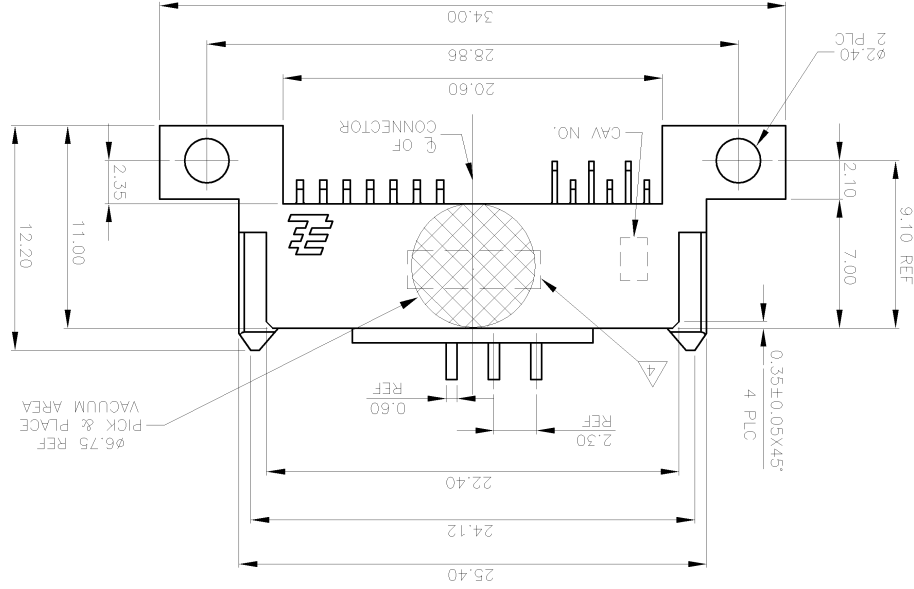
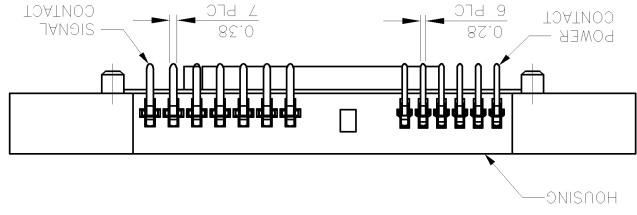

- MATERIAL: HOUSING: HIGH TEMP THERMOPLASTIC(LCP) WITH 0% GF, UL94V-0, BLACK
CONTACT: PHOSPHOR BRONZE
CAP: HIGH TEMP THERMOPLASTIC(LCP) WITH 0% GF, UL94V-0, BLACK
- FINISH: CONTACT MATING AREA: GOLD PLATING(SEE TABLE)
2.54um [100µ"] MIN. MATTE-TIN PLATING ON SOLDERTAIL:
1.27um [50µ"] MIN. NICKEL UNDERPLATE PLATING ALL OVER.
- REFLOW SOLDER CAPABLE TO 260°C PER TEST SPEC.
109-201, CONDITION B.
DATE CODE LOCATION.
- NO CUMULATIVE TOLERANCE.
- LOW HALOGEN SPECIFICATION:
- CHLORINE(CI): 900ppm MAX.
BROMINE(Br): 900ppm MAX.
CHLORINE(CI)+BROMINE(Br): 1500ppm MAX.

LOC	DIST	REV	DATE	DESCRIPTION	REVISED (ECR-12-003204)	21FEB12	JL	WK
DW								

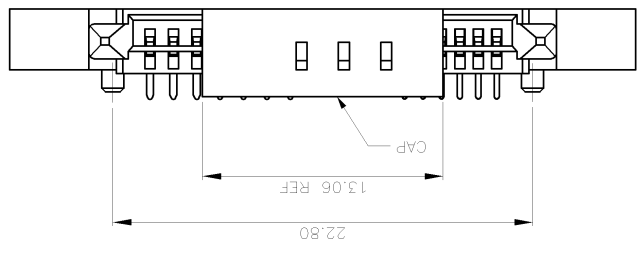

MATERIAL		FINISH		DIMENSIONS:	
APPLICATIO SPEC		TOLERANCES UNLESS OTHERWISE SPECIFIED:		MM	
PRODUCT SPEC		0 P/LC ±		1 P/LC ±	
APVD		2 P/LC ±		3 P/LC ±	
NAME		4 P/LC ±		ANGLES ±	
SLIMLINE SATA RECEPTACLE, RIGHT ANGLE, TH, 1.5SH TOP MOUNT		WEIGHT		CUSTOMER DRAWING	
APVD		SIZE		SCALE	
CHK		CASE CODE		SHEET	
DWN		DRAWING NO		REV	
DWN		A300779		3 OF 3	
CHK		C=1735777		B	
DWN		RESTRICTED			

G/W	N/W	Pcs/REEL	Pcs/CARTON
4.9(kg)	2.1(kg)	500	2000

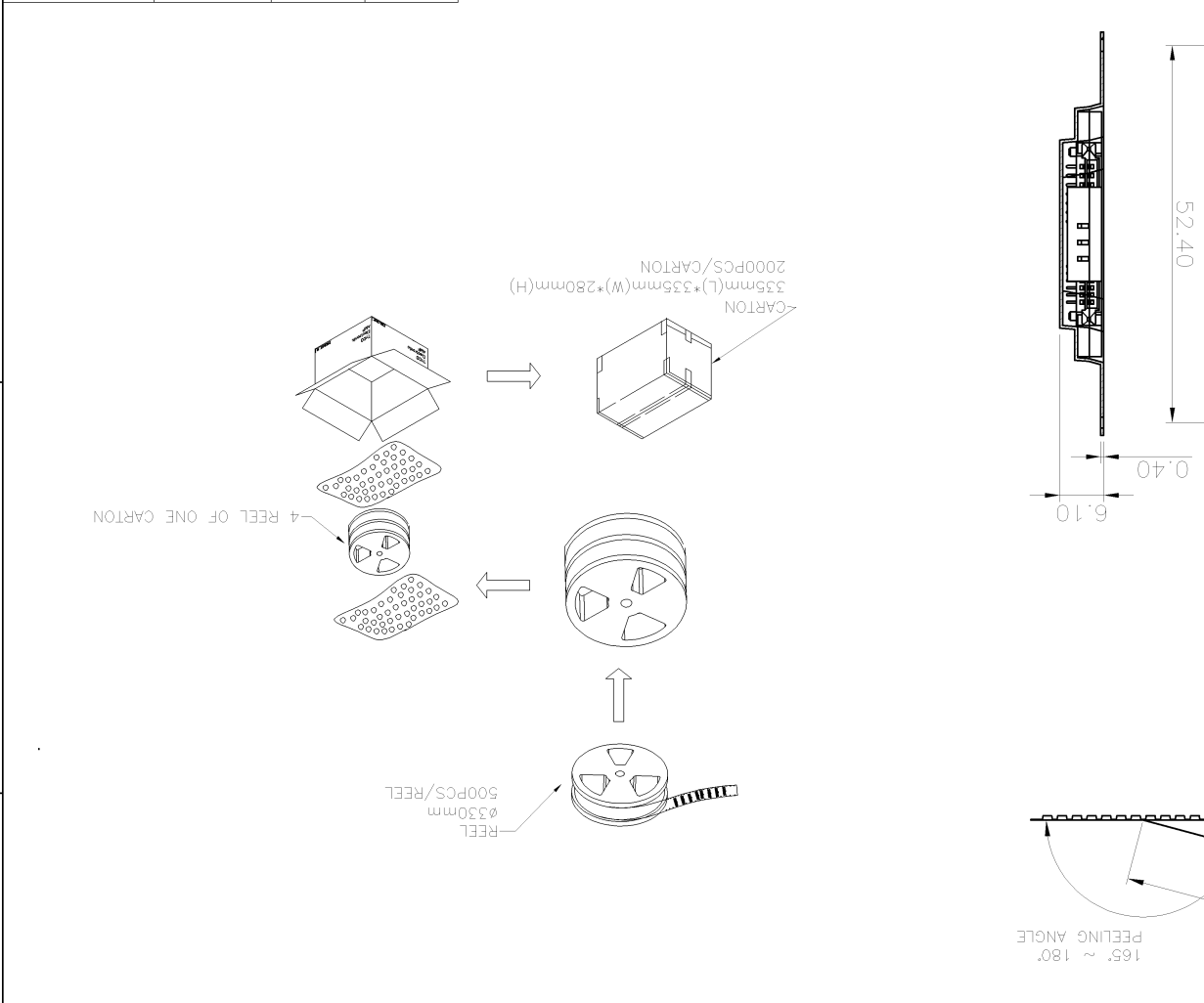

LOC	DW	SEE SHEET 1.	
DIST	P	LTR	DESCRIPTION
	DWN	DATE	
	APVD		

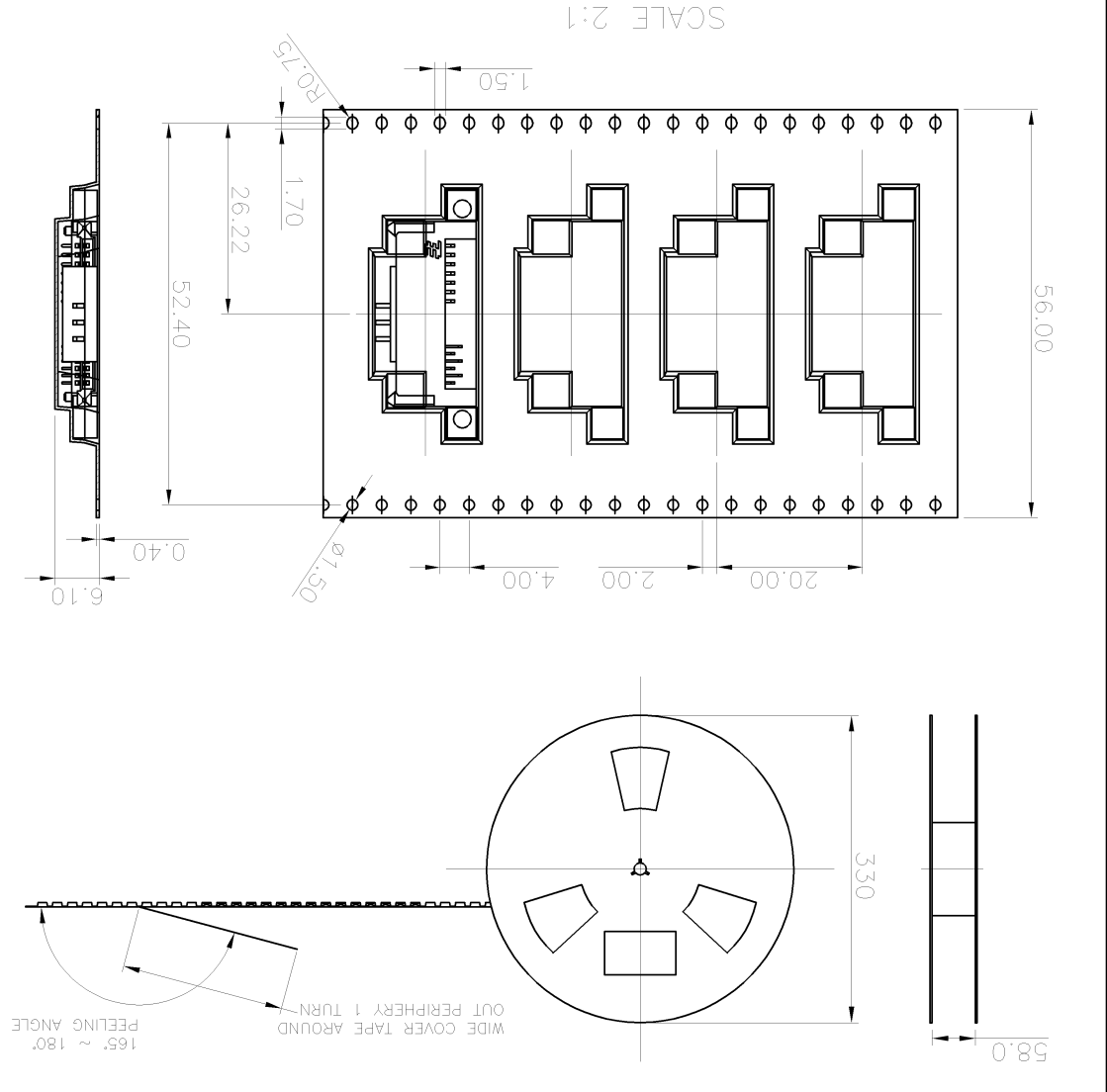

X-ON Electronics

Largest Supplier of Electrical and Electronic Components

Click to view similar products for [I/O Connectors](#) category:

Click to view products by [TE Connectivity](#) manufacturer:

Other Similar products are found below :

[571763P](#) [58098-0628](#) [61-168618-12P](#) [D38999/20FJ24PA L/C](#) [D38999/20FJ29SB L/C](#) [D38999/24FG11SN L/C](#) [72.250.1628.2](#) [72.250.2428.2](#)
[74720-0505](#) [76.350.0729.0](#) [76871-1403](#) [FCN-244F080-G/1](#) [FCN-260A9920](#) [FCN-268D024-G/2F#10X-R10](#) [PCS-E50FA](#) [PCS-XE26LKA](#)
[PCS-XE26MA+](#) [PCS-XES68MS+](#) [G38A71314B](#) [91-569719-35R](#) [9776-18-6](#) [DX40-50P\(55\)](#) [1571250010](#) [157-22500-3](#) [MS3476W12-10S](#)
[L/C](#) [1888020-8](#) [91-569786-35H](#) [91-569786-35M](#) [91-644626-35P](#) [172501-4002](#) [172501-6002](#) [FCN-260C008-A/L0](#) [FCN-260C024-AL0](#)
[FCN-261Z008](#) [FCN-268D008-G/1K](#) [2000314-1](#) [200331-1](#) [2007498-2](#) [PCR-E28LMDAG1+](#) [PCR-E36FC+](#) [PCS-E28FS+](#) [PCS-XE26SLFD+](#)
[PCS-XE26SLFDT+](#) [G38A71214B](#) [HDRA-E68W1LFDTC-SL+](#) [HDR-E14MSG1+](#) [R88A-CNK81S](#) [CRT1-ATT02](#) [54182-0605](#)
[U90B2054081210](#)