

4

3

2

1

ACCESSORIES
 (NOT PART OF STANDARD ASSEMBLY)
 SEE DRAWING 10-150000

71513-2		REVISIONS		
ZONE	LTR	DESCRIPTION	DATE	APPROVED
	A			

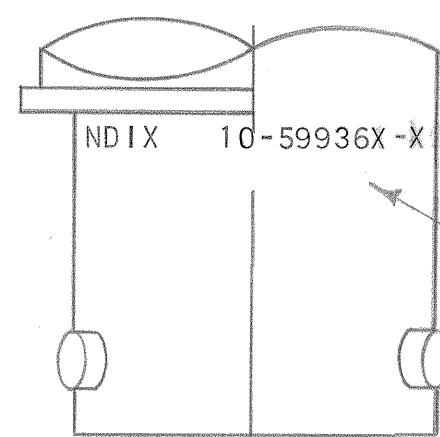

9
 STAMP "BENDIX" & ASSY
 PER 9-5788 IN APPROX
 POSITION SHOWN
 EXAMPLE: 10-599361-4P

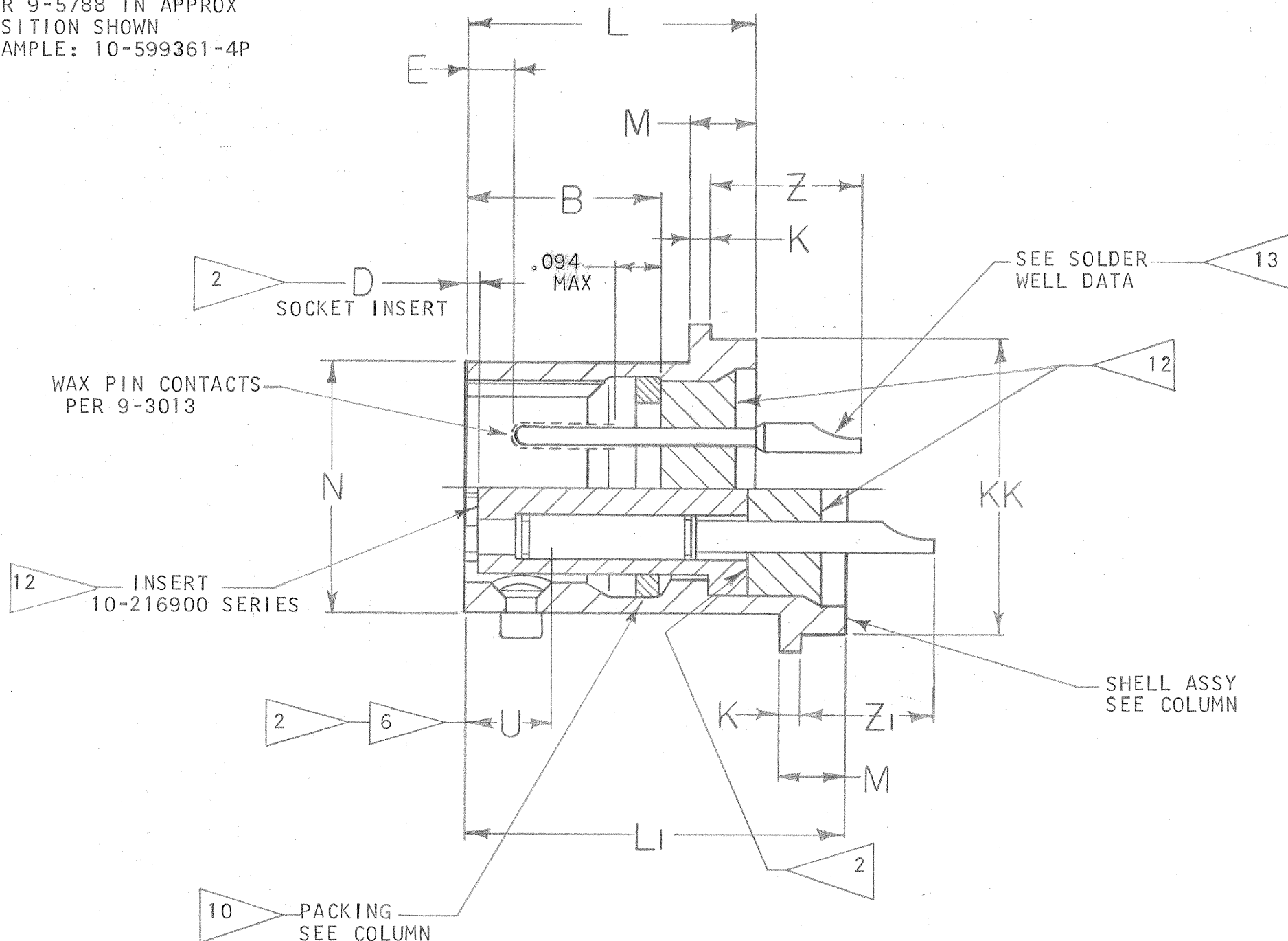
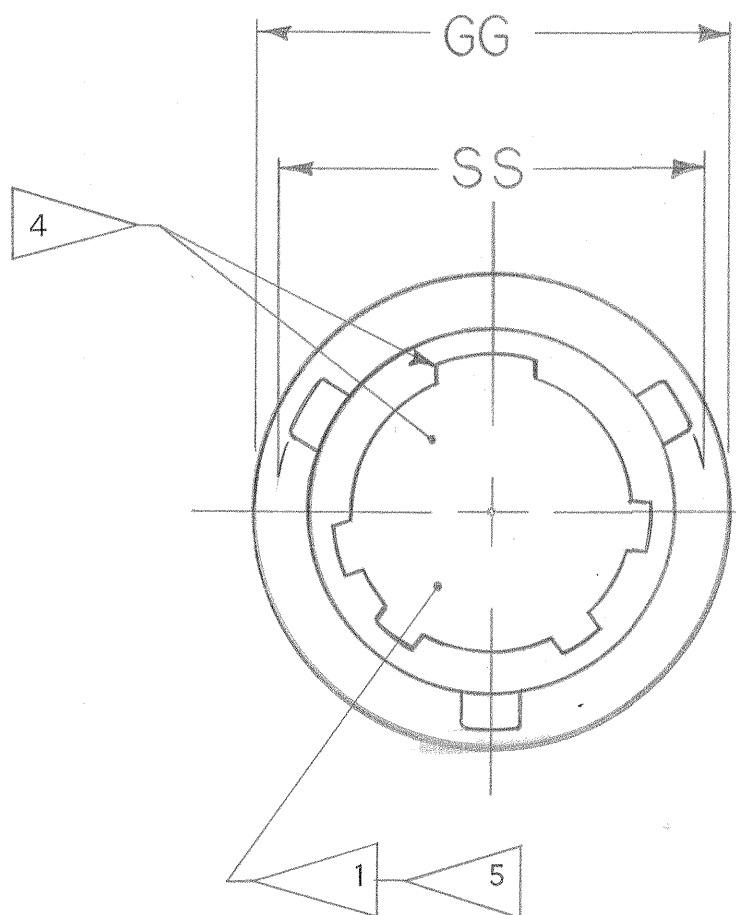

FIND NO.	QTY REQD	CODE IDENT	PART NUMBER	DESCRIPTION	NOTE REF
PARTS LIST					
UNLESS OTHERWISE SPECIFIED LINEAR DIMENSIONS ARE IN INCHES. TOLERANCES: .XXX ± .010, .XX ± .03, .X ± .1, ANGLES ± 2°. OTHER STANDARDS PER 9-3800 AND MIL-D-1000. NOTE REF			SIGNATURES	DATES	The Bendix Corporation Electrical Components Division Sidney, New York TITLE: CONNECTOR, ELECTRICAL RECEPTACLE, TYPE PTIH () SM, TIN PLATED
MATERIAL SPEC			PREPARED		
PROCESS SPEC			CHECKED		
TEST			MATERIAL		
9-3920			APPROVED		SIZE C CODE IDENT NO. 77820 10-599360 THRU 10-599369 SCALE NONE WT REF 10-150256/99 SHEET 1 OF 2
9-4385			APPROVED		
9-3013					
9-2837					
9-5788					
9-2437-1					

SEE SHEET 2
 NOTES:

USE OF THIS DOCUMENT IS UNLIMITED. DOCUMENTS REFERENCED HEREON CONTAIN LIMITED RIGHTS DATA.

NEXT ASSEMBLY

[10-599360/69]

ASSEMBLY NUMBER	PT.NO. REF	SHELL ASSEMBLY	PACKING	B	D	K	L	L1	M	N	U	GG	KK	SS	E
				+ .010 - .005	+ .010 - .025	+ .006 - .005	+ .011 - .000	+ .011 - .000	+ .006 - .005	+ .001 - .005	MAX	+ .011 - .010	+ .001 - .005	+ .000 - .016	+ .010 - .020
10-599360-()	IH- 6-()	10-257965-()	10-90354- 8	.370	.025	.031	.541	.706	.125	.348	.153	.500	.438	.439	.085
10-599361-()	- 8-()	10-257966-()	-11							.473		.625	.562	.563	
10-599362-()	-10-()	10-257967-()	-13							.590		.750	.672	.680	
10-599363-()	-12-()	10-257968-()	-15							.750		.844	.781	.859	
10-599364-()	-14-()	10-257969-()	-17							.875		.969	.906	.984	
10-599365-()	-16-()	10-257970-()	-19							1.000		1.094	1.031	1.108	
10-599366-()	-18-()	10-257971-()	-21							1.125		1.218	1.156	1.233	
10-599367-()	-20-()	10-257972-()	-23	.432	.087		.603	.768		1.250	.215	1.312	1.250	1.358	.147
10-599368-()	-22-()	10-257973-()	-25				.634	.799	.156	1.375		1.438	1.375	1.483	.147
10-599369-()	-24-()	10-257974-()	-27				.667	.832	.156	1.500		1.563	1.500	1.610	.147



11. LUBRICATE INDICATED PACKING ON PIN ASSEMBLIES ONLY WITH A LIGHT COATING OF 9-2837.
10. FOR CONNECTORS CONTAINING SOCKET CONTACTS, ASSEMBLE PACKING AFTER ASSY OF FRONT INSERT. USE OF UNDILUTED PROPRIETARY ALCOHOL TO ASSIST IN ASSEMBLY IS PERMITTED. USE OF OTHER LUBRICANTS IS PROHIBITED. PACKING MUST BE PROPERLY SEATED AND FREE OF FOLDS AND CONVOLUTIONS.
9. SEE WORK ORDER FOR PERMISSIBLE ADDITIONAL OR ALTERNATE STAMPING.
8. SEE SEPARATE PARTS LIST FOR COMPONENT PART NUMBERS AND QUANTITIES.
7. FOR MATING PLUG ASSEMBLIES, SEE DRAWING 10-146506/50 AND OTHERS.
6. DISTANCE BETWEEN END OF SHELL AND THE POINT AT WHICH A GAGE PIN, HAVING THE SAME BASIC DIA AS THE MATING CONTACT AND A SQUARE FACE, ENGAGES SOCKET CONTACT SPRING.
5. INSERTS AND CONTACTS MUST NOT BE REMOVED.
4. VERTICAL CENTERLINES OF INSERT ARRANGEMENT AND THE MAIN SHELL POLARIZING KEYWAY TO BE WITHIN .005 OF INDICATED ROTATION PER 9-2437-1.
3. TO COMPLETE ASSY NO., PART NO. AND SHELL ASSY NO., ADD APPLICABLE INSERT ARRANGEMENT SUFFIX TO BASE NUMBERS LISTED ABOVE PER 9-2437-1.
2. DIMENSIONS MUST BE MAINTAINED WHEN INSERTS ARE PRESSED FIRMLY AGAINST INDICATED SURFACE.
1. FOR CONTACT ARRANGEMENTS, SEE DRAWINGS L-15206-() THRU L-15250-().

14. UNITS ILLUSTRATED MEET THE MATERIAL AND FINISH REQUIREMENTS OF MIL-C-26482 EXCEPT SHELL IS TIN PLATED STEEL & PACKING MATERIAL IS SILICONE RUBBER.
13. RESULTANT UNPLATED AREA, DUE TO PLATING PROCEDURE, IS PERMISSIBLE ON WELL END OF CONTACTS.
12. LETTERS MAY BE INCOMPLETE, BUT ALL LETTERS MUST BE LEGIBLE.

SOLDER WELL DATA		
CONTACT SIZE	20	16
WELL DIA	.044 ⁺ .006 -.002	.078 ⁺ .004 -.002
WELL DEPTH ±.016	.125	.188
Z DIM MAX FOR 10-599360/67	.356	.387
Z DIM MAX FOR 10-599368	.356	.418
Z DIM MAX FOR 10-599360/68	.300	.300
Z DIM MAX FOR 10-599369	.323	.385
Z DIM MAX FOR 10-599369	.267	.287

SIZE	CODE IDENT NO.	10-599360 THRU 10-599369
C	77820	

10-599360/69

X-ON Electronics

Largest Supplier of Electrical and Electronic Components

Click to view similar products for [Circular MIL Spec Connector](#) category:

Click to view products by [Amphenol](#) manufacturer:

Other Similar products are found below :

[89075GULPR](#) [0025-262-542](#) [0025-264-3014](#) [58-570121-04S](#) [0134-213-1208](#) [0134-213-2209](#) [0025-258-000](#) [60-042022-07P](#) [60-042022-19P](#)
[60-042022-23P](#) [60-042217-10P](#) [0114-201-1278](#) [012-0467-000](#) [602GB06EG24-61SN](#) [0134-201-1207](#) [0134-213-1006](#) [6104-207-2302](#) [6104-](#)
[208-1902](#) [61-168211-04P](#) [61-168617-10P](#) [6131-202-19149P](#) [6131-204-21149P](#) [6131-208-13149P](#) [6131-209-17149P](#) [6131-210-11149P](#) [6131-](#)
[211-19149P](#) [6131-216-19149P](#) [6131-259-21149P](#) [6131-259-23149P](#) [6131-265-17149P](#) [6131-265-19149P](#) [CS3100A18-1P-472](#) [CS3100A-36-](#)
[77P](#) [CS3101A-16-55P](#) [CS3102A-10SL-55P](#) [CS3102A-14S-58P](#) [CS3102A-32-17P](#) [CS3102A32-25S](#) [CS3102C18-4P-472](#)
[CS3106A10SL3S004](#) [CS3106A-18-73S](#) [CS3108A-14S-52S](#) [CS3108A-28-51S](#) [6162-233-1277](#) [6162-324-1231](#) [M243082296Z](#)
[M2884010AC1S1](#) [CT0-24-10SC](#) [CT0M20-7PCAU](#) [M28840/17AC1G3](#)