

LOC	DIST	REVISIONS					
A1	-	P	LTN	DESCRIPTION	DATE	DMN	APVD
		G2	PN 1394897 AND 1418847 OBSOLETE		15NOV2012	S.R.	C.G.
		G3	ECR-14-008680 CANCELED		12JUN2014	Abt	Raab
		G4	Loose Piece Parts removed from Table. ECR-14-012725		25AUG2014	Abt	Raab
		G5	Tolerance from dim. J changed (drawing failure)		02FEB2015	Ho.	Raab

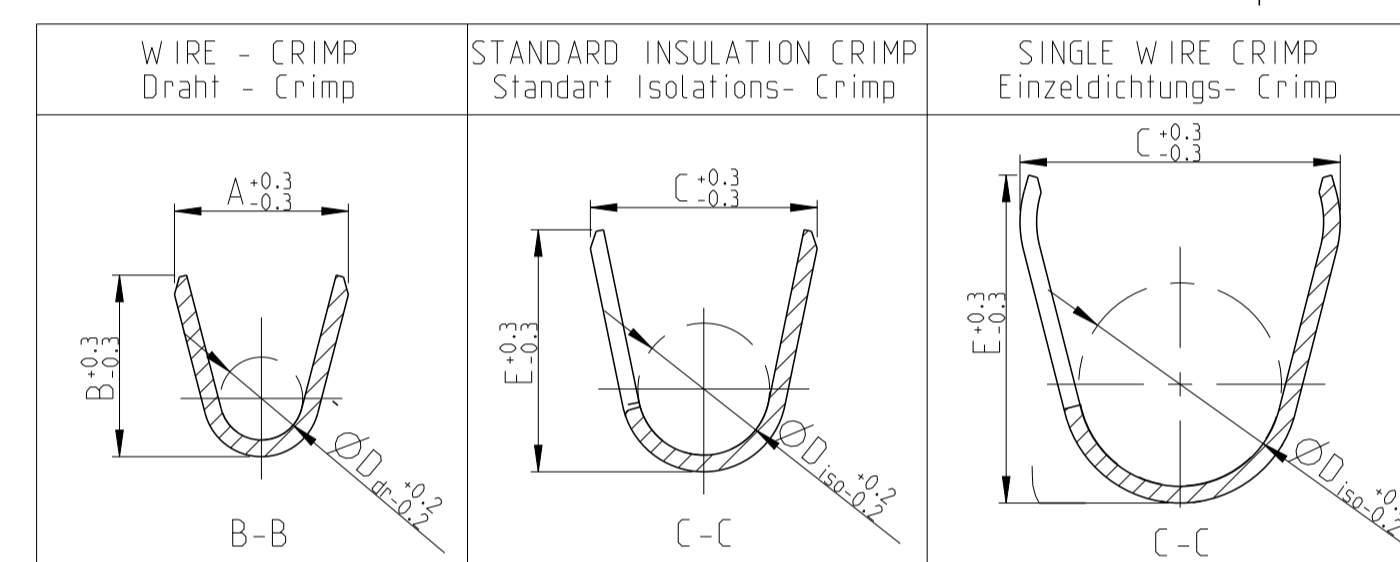
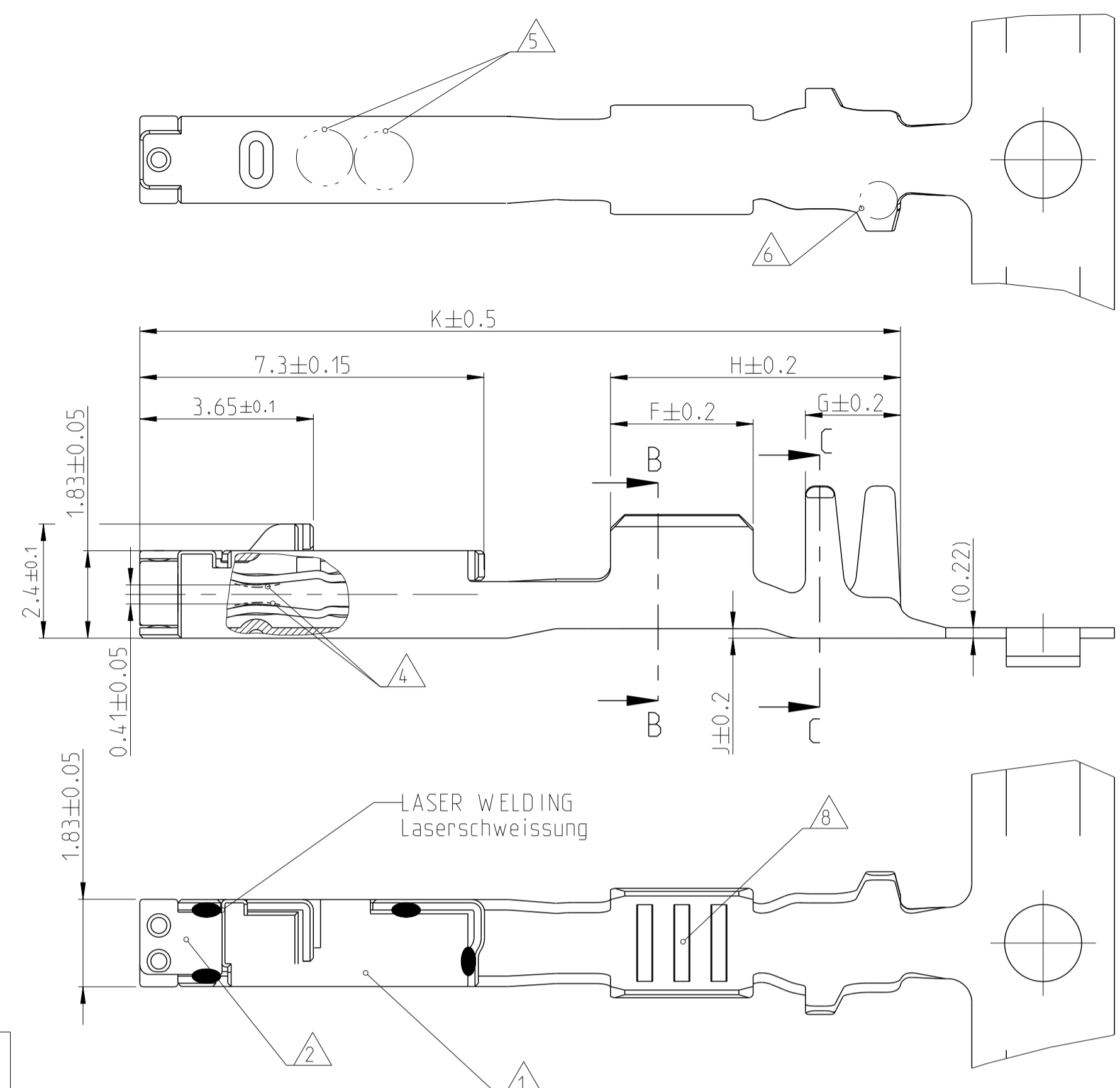
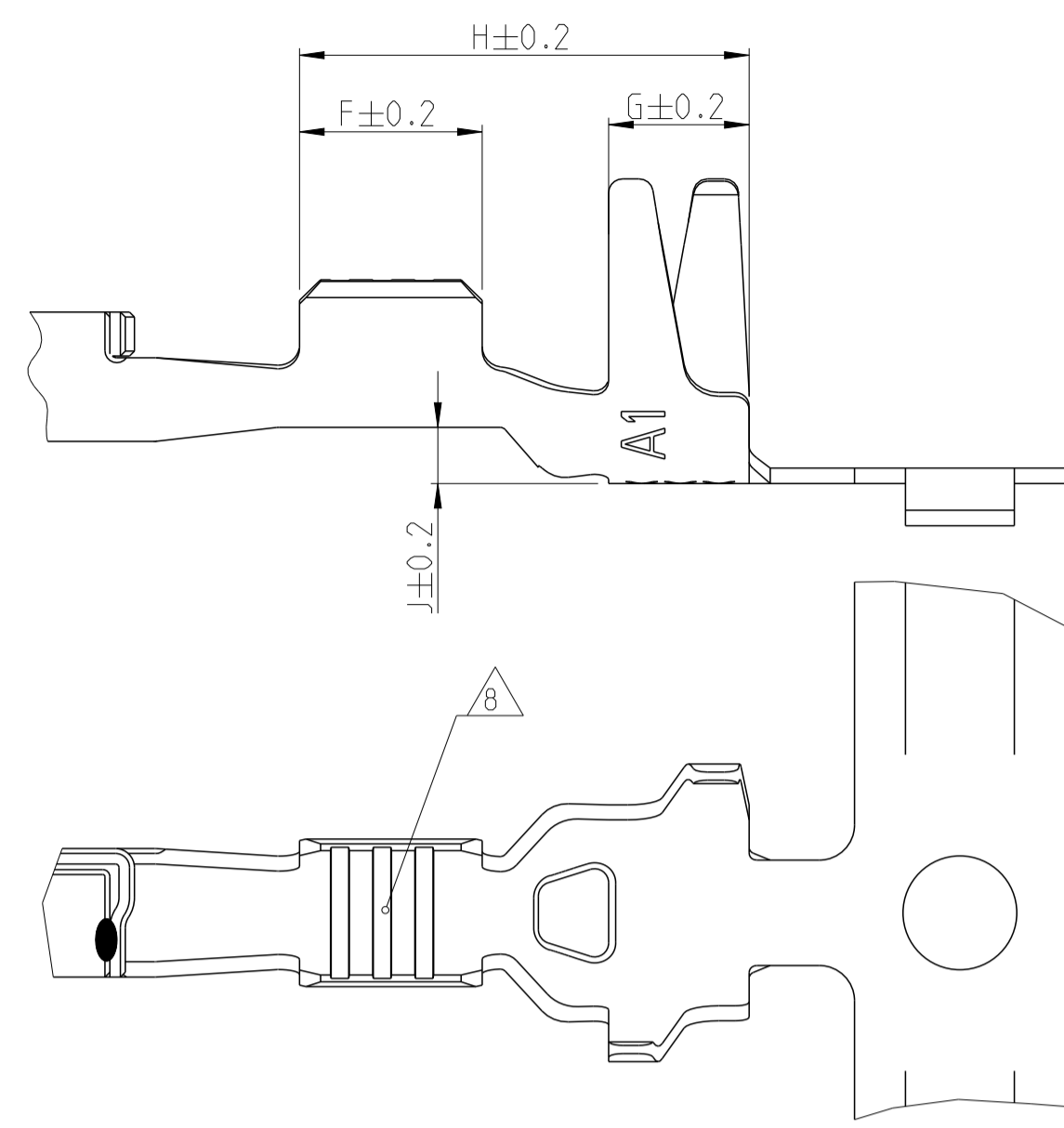

VERSION / Ausführung	Rev.	BODY Kontakt-koerper	SPRING Kontakt-feder	BODY Kontakt-koerper	SPRING Kontakt-feder	RANGE Bereich	AWG	mm <sup>2</sup>	INSULATION Isolations-φ	A	(B)	D <sub>Dr</sub>	C	E	D <sub>ISO</sub>	AS PRODUCTS ON CARRIERSTRIP wie Bandware	F	G	H	J	K	Ø 3.55 [mm]	Ø 3.95 [mm]	TE NO.	MASTER APPLICATION-TOOL Basis Crimp-Werkzeug	DIE-PN FOR BASIC-HAND TOOL 539635-1 ERGO-CRIMP Matrizen PN fuer Basisbandzange 539635-1 ERGO-Crimp	EXTRACTION TOOL Ausdrueckwerkzeug 0-1579007-8	EXTRACTION TOOL FOR SECONDARY LOCK Ausdrueckwerkzeug fuer zweite Kontaktsicherung 1-1579007-0	ORDER NO./Bestell-Nr.		
																														WIRE CRIMP Drahtcrimp	ISOLATION CRIMP Isolationscrimp
SINGLE WIRE SEAL / Einzeldichtung	1418841-3	-	CuSn0.15	CuNi3Si	TIN PLATED verzinkt	SILVER PLATED versilbert	0.14	26	0.14	1.05	-	-	-	-	-	2.6	2	6.4	0.8	16	967067-2	963142-2	1528151	4-1579001-8							
	1418841-2	-	CuSn0.15	CuNi3Si	TIN PLATED verzinkt	GOLD PLATED vergoldet	0.22	-	0.22	1.2	1.55	1.55	0.65	4.25	4.3	2.6	2	6.4	0.8	16	967067-2	963142-2	1528152	3-1579001-9							
	1418841-1	-	CuSn0.15	CuNi3Si	TIN PLATED verzinkt	SILVER PLATED versilbert	0.25	24	-	1.1	1.85	1.85	0.8	4.25	4.3	2.6	2	6.4	0.8	16	967067-2	963142-2	1528152	3-1579001-9							
	1418844-3	C	CuSn0.15	CuNi3Si	TIN PLATED verzinkt	GOLD PLATED vergoldet	0.35	-	0.35	1.75	-	-	-	-	-	-	-	-	-	-	-	967067-1	963142-1	1528674	5-1579021-7						
	1418844-2	C	CuSn0.15	CuNi3Si	TIN PLATED verzinkt	SILVER PLATED versilbert	0.5	20	0.5	1.4	2.1	2.1	1.1	4.25	4.3	2.7	2.6	2	6.4	0.8	16	967067-1	963142-1	1528674	5-1579021-7						
	1418844-1	C	CuSn0.15	CuNi3Si	TIN PLATED verzinkt	GOLD PLATED vergoldet	0.75	-	0.75	1.9	-	-	-	-	-	-	-	-	-	-	-	-	967067-1	963142-1	1528674	5-1579021-7					
	1670146-3	A	CuSn0.15	CuNi3Si	TIN PLATED verzinkt	SILVER PLATED versilbert	1.0	18	-	1.9	2.6	2.95	1.3	4.45	4.3	2.9	2.6	2	6.4	0.8	16	967067-1	963142-2	1528153	3-1579001-8						
	1670146-2	A	CuSn0.15	CuNi3Si	TIN PLATED verzinkt	GOLD PLATED vergoldet	1.5	-	1.5	2.4	-	-	-	-	-	-	-	-	-	-	-	-	967067-1	967067-1	1528154	3-1579001-7					
	1670146-1	A	CuSn0.15	CuNi3Si	TIN PLATED verzinkt	SILVER PLATED versilbert	0.14	26	0.14	1.05	1.55	1.55	0.65	2.1	2.1	1.1	2.6	2	6.4	0.8	16	967067-1	963142-1	1528674	5-1579021-7						
	1418847-3	D	CuSn0.15	CuNi3Si	TIN PLATED verzinkt	GOLD PLATED vergoldet	0.5	-	0.5	1.9	2.3	2.5	1.1	4.25	4.3	2.7	2.6	2	6.4	0.8	16	967067-1	963142-2	1528153	3-1579001-8						
	1418847-2	D	CuSn0.15	CuNi3Si	TIN PLATED verzinkt	SILVER PLATED versilbert	0.75	-	0.75	1.9	-	-	-	-	-	-	-	-	-	-	-	-	967067-1	963142-2	1528153	3-1579001-8					
	1418847-1	D	CuSn0.15	CuNi3Si	TIN PLATED verzinkt	GOLD PLATED vergoldet	1.0	18	-	1.9	2.6	2.95	1.3	4.45	4.3	2.9	2.6	2	6.4	0.8	16	967067-1	967067-1	1528154	3-1579001-7						
	1418850-3	B	CuSn0.15	CuNi3Si	TIN PLATED verzinkt	SILVER PLATED versilbert	1.5	-	1.5	2.4	-	-	-	-	-	-	-	-	-	-	-	-	-	967067-1	967067-1	1528154	3-1579001-7				
	1418850-2	B	CuSn0.15	CuNi3Si	TIN PLATED verzinkt	GOLD PLATED vergoldet	0.14	26	0.14	1.05	1.55	1.55	0.65	2.1	2.1	1.1	2.6	2	6.4	0.8	16	967067-1	963142-1	1528674	5-1579021-7						
	1418850-1	B	CuSn0.15	CuNi3Si	TIN PLATED verzinkt	SILVER PLATED versilbert	0.22	-	0.22	1.2	1.55	1.55	0.65	2.1	2.1	1.1	2.6	2	6.4	0.8	16	967067-1	963142-1	1528674	5-1579021-7						
1452500-3	-	CuSn0.15	CuNi3Si	TIN PLATED verzinkt	GOLD PLATED vergoldet	0.35	22	-	1.75	-	-	-	-	-	-	-	-	-	-	-	-	-	-	-	-	-	-	-	-		
1534594-3	E	CuSn0.15	CuNi3Si	TIN PLATED verzinkt	SILVER PLATED versilbert	0.25	24	-	1.1	1.85	1.85	0.8	2.65	2.65	1.4	2.6	2	6.4	0.2	15	-	-	1528147	0-1579001-6							
1534594-2	E	CuSn0.15	CuNi3Si	TIN PLATED verzinkt	GOLD PLATED vergoldet	0.35	-	0.35	1.75	-	-	-	-	-	-	-	-	-	-	-	-	-	-	-	-	-	-	-	-		
1534594-1	E	CuSn0.15	CuNi3Si	TIN PLATED verzinkt	SILVER PLATED versilbert	0.5	20	0.5	1.4	2.1	2.1	1.1	2.8	2.9	1.6	3	2	6.1	0.2	16	-	-	1528673	5-1579021-6							
1670144-3	A	CuSn0.15	CuNi3Si	TIN PLATED verzinkt	GOLD PLATED vergoldet	0.75	-	0.75	1.9	2.1	2.1	1.1	3.2	3.2	1.75	3	2	6.1	0.2	16	-	-	1528673	5-1579021-6							
1670144-2	A	CuSn0.15	CuNi3Si	TIN PLATED verzinkt	SILVER PLATED versilbert	1.0	18	-	1.9	2.6	2.95	1.3	3.75	3.95	2.1	3	2	6.1	0.2	16	-	-	1528150	1-1579001-3							
1670144-1	A	CuSn0.15	CuNi3Si	TIN PLATED verzinkt	GOLD PLATED vergoldet	1.5	-	1.5	2.4	-	-	-	-	-	-	-	-	-	-	-	-	-	-	-	-	-	-	-	-		
1394897-3	E	CuSn0.15	CuNi3Si	TIN PLATED verzinkt	SILVER PLATED versilbert	0.5	20	0.5	1.4	2.3	2.5	1.1	3	3.2	1.75	3	2	6.1	0.2	16	-	-	1528148	0-1579001-5							
1394897-2	E	CuSn0.15	CuNi3Si	TIN PLATED verzinkt	GOLD PLATED vergoldet	0.75	-	0.75	1.9	2.3	2.5	1.1	3	3.2	1.75	3	2	6.1	0.2	16	-	-	1528148	0-1579001-5							
1394897-1	E	CuSn0.15	CuNi3Si	TIN PLATED verzinkt	SILVER PLATED versilbert	1.0	18	-	1.9	2.6	2.95	1.3	3.75	3.95	2.1	3	2	6.1	0.2	16	-	-	1528150	1-1579001-3							
1452503-3	C	CuSn0.15	CuNi3Si	TIN PLATED verzinkt	GOLD PLATED vergoldet	1.5	-	1.5	2.4	-	-	-	-	-	-	-	-	-	-	-	-	-	-	-	-	-	-	-	-		
1452503-2	C	CuSn0.15	CuNi3Si	TIN PLATED verzinkt	SILVER PLATED versilbert	0.14	26	0.14	1.05	1.55	1.55	0.65	2.1	2.1	1.1	2.6	2	6.4	0.8	16	967067-1	963142-1	1528674	5-1579021-7							
1452503-1	C	CuSn0.15	CuNi3Si	TIN PLATED verzinkt	GOLD PLATED vergoldet	0.22	-	0.22	1.2	1.55	1.55	0.65	2.1	2.1	1.1	2.6	2	6.4	0.8	16	967067-1	963142-1	1528674	5-1579021-7							

NOTES

- 1 BODY
- 2 SPRING
- 3 ONLY FOR FLR-WIRE SEE DIN 72551, PART 6 AND AWG WIRE ACCORDING DC-SPEC: MS-8288; MS-7889; MS-9532
- 4 SURFACE
  - a) BODY -PRE TIN 1 TO 3 µm
  - b) SPRING -PRE TIN SnAg 1 TO 3µm -GOLD PLATED MIN. 0.8µm (ONLY CONTACT AREA) -SILVER PLATED 2 TO 5µm (ONLY CONTACT AREA)
- 5 STAMPED INDICATOR FOR PLATING:
  - A U GOLD PLATING
  - A G SILVER PLATING
  - TIN PLATING WITHOUT INDICATOR
- 6 OPTIONAL DATE CODE
- 7 1394897-1, -2, -3 superseded by 1670144-1, -2, -3 1418847-1, -2, -3 superseded by 1670146-1, -2, -3

CAUTION!  
PART NUMBERS 1670144 AND 1670146 ARE PROCESSED WITH OTHER CRIMP HEIGHTS. SEE APPLICATION SPECIFICATION NO.114-18464 UP FROM REVISION "P"

8 DIFFERENT FORM OF THE SERRATIONS POSSIBLE

Bemerkungen

- 1 Kontaktkoerper
- 2 Kontaktfeder
- 3 Nur fuer FLR-Leitung nach DIN 72551, Teil 6 und AWG Leitung nach DC-Spec: MS-8288; MS-7889; MS-9532
- 4 Oberflaeche
  - a) Kontaktkoerper -verzinkt 1 bis 3 µm
  - b) Kontaktfeder -verzinkt SnAg 1 bis 3µm -galv. vergoldet min. 0.8µm (nur Kontaktzone) -galv. versilbert 2 bis 5µm (nur Kontaktzone)
- 5 Markierung fuer galvanische Ausfuehrung:
  - A U vergoldet
  - A G versilbert
  - Verzinkt: ohne Markierung
- 6 Optional Datumscode
- 7 1394897-1, -2, -3 ersetzt durch 1670144-1, -2, -3 1418847-1, -2, -3 ersetzt durch 1670146-1, -2, -3
- 8 Unterschiedliche Ausfuehrung der Rillen moeglich

THIS DRAWING IS A CONTROLLED DOCUMENT.

DIMENSIONS: mm	TOLERANCES UNLESS OTHERWISE SPECIFIED:	0 PLC #0.2	1 PLC #0.2	2 PLC #0.2	3 PLC #0.2	4 PLC #0.2	ANGLES #°
MATERIAL: -	FINISH: -	WEIGHT: 0.18 g	Customer Drawing	SCALE: 10:1	SHEET: 1 of 1	REV: G5	

TE Connectivity  
MCON 1.2 CB (CLEAN BODY)

Customer Drawing

## X-ON Electronics

Largest Supplier of Electrical and Electronic Components

*Click to view similar products for [Automotive Connectors](#) category:*

*Click to view products by [TE Connectivity](#) manufacturer:*

Other Similar products are found below :

[003-018-000](#) [600858](#) [60403001](#) [60993906-B](#) [60993913-B](#) [629515004020001](#) [M902-2131](#) [M902-2161](#) [M902-2344](#) [72.330.1035.1](#)  
[73.353.4028.0](#) [F118010](#) [F119300-B](#) [F132210](#) [F132210-B](#) [F166900](#) [F180100](#) [F258300](#) [F258300-B](#) [F294300-B](#) [F339100](#) [F339700](#) [F358300-](#)  
[B](#) [F374110](#) [F407400](#) [F412210](#) [F427600](#) [F444110](#) [F487000](#) [F495100-B](#) [F500900-B](#) [F509500B-B](#) [770444-1](#) [776880-1](#) [827153-1](#) [881735-1](#)  
[8N1515-32-24P](#) [9-1326727-8](#) [9-1326729-8](#) [925467-1](#) [925474-1](#) [928905-1](#) [936398-2](#) [964562-1](#) [964562-4](#) [964731-2](#) [965051-1](#) [968782-1](#)  
[GT17SA-8DS-HU](#) [GT17VS-10DP-5.2CF](#)