

a) Part as supplied.

KTKK 5011Q

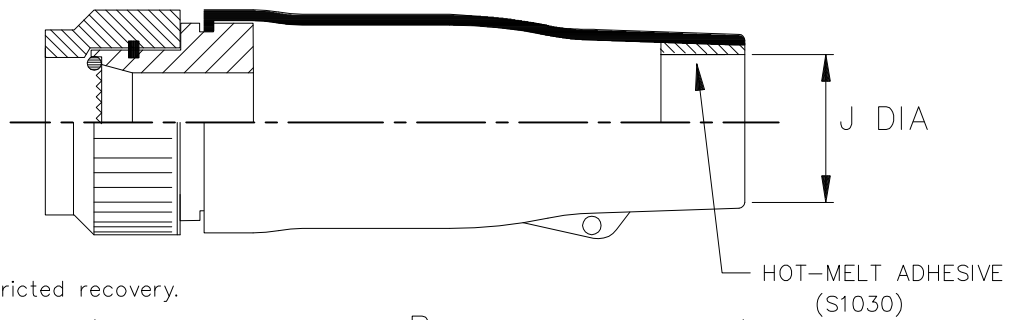

b) Part after unrestricted recovery.

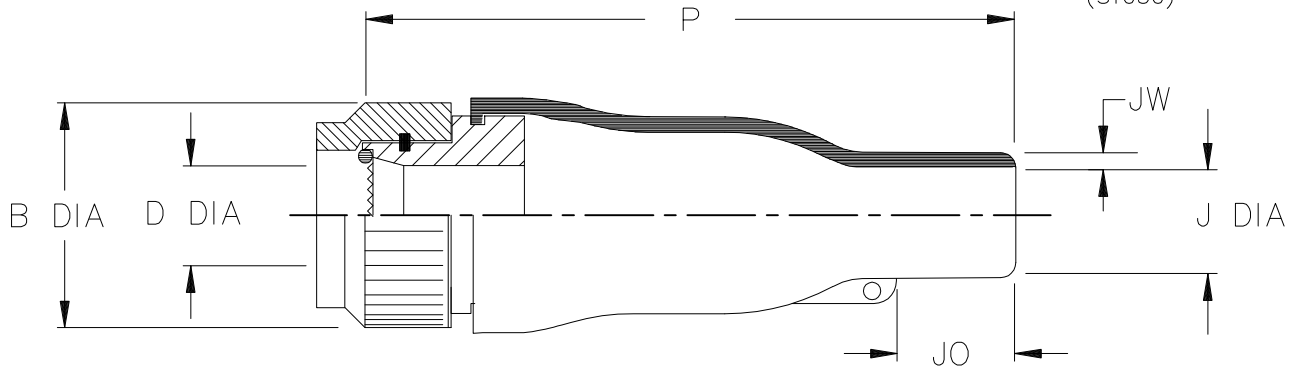

Raychem connector code: - 64  
Connector series: - VEAM CIR06BRT  
Adaptor Series: - 215M7\*\*-19-Q\*\*-K-NS  
Moulded Part Material: - -100, RW 2082

Assembly will be Part Marked with Part Number.  
Kits to include cleaning tissue, 1 piece 100 grit emery cloth.  
Assembly to be installed per Raychem instruction sheet AER#90611.

Dimensions in millimetres {inches}.

a) Part as supplied.

b) Part after unrestricted recovery.

Part No.	SHELL SIZE	B	D	J		P	JO	JW	CABLE RANGE	
		DIA	DIA	MIN	MAX	±10%	REF	±30%	MIN	MAX
		MAX	MIN	a	b	b	b	b		
KTKK 5011Q	18	34.4 {1.35}	16.4 {0.64}	24 {0.94}	8.4 {0.33}	98 {3.84}	20 {0.77}	1.0 {0.04}	8.8 {0.35}	16 {0.62}

Copyright(!)

The copyright in this drawing is the property of TE Connectivity. The drawing is issued on the condition that it is not copied, reproduced or disclosed to a third party, either in whole or in part without the prior written consent of TE Connectivity.

Drawn N. NAGAR    Checked    Issue 1    Date 12/08/13

Conforms to ISO Recommendations  
3rd Angle Projection  
Not to Scale

Approval  
Design H. SMITH    MKTG. D. JONES    Q.A. H. JOHNS

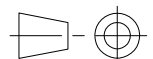

## X-ON Electronics

Largest Supplier of Electrical and Electronic Components

*Click to view similar products for [Heat Shrink Cable Boots & End Caps](#) category:*

*Click to view products by [TE Connectivity](#) manufacturer:*

Other Similar products are found below :

[577159N001](#) [007758-000](#) [610368N003](#) [645494-000](#) [M85049/141-02HU](#) [M85049/141-03HU](#) [M85049/141-04HU](#) [687025-000](#) [705331-000](#)  
[718446-000](#) [725666N001](#) [729257-000](#) [F21914-000](#) [F27131-000](#) [F85868-000](#) [770-006A103R](#) [770-006A304W1](#) [770-006A305W1](#) [770-](#)  
[006A308W1](#) [770-011T303W1](#) [770-011T304W1](#) [770-020S702W1](#) [770-020S704W1](#) [806138-000](#) [806542N001](#) [807507-000](#) [808059-000](#)  
[808296-000](#) [808362-000](#) [808828-000](#) [809125-000](#) [809130-000](#) [809218-000](#) [811218-000](#) [811288-000](#) [812014-000](#) [812047-000](#) [813166-000](#)  
[813767N002](#) [814417-000](#) [819115N001](#) [819117N001](#) [823026-000](#) [823070-000](#) [825002-000](#) [841189N001](#) [861471-000](#) [866647-000](#) [937577-](#)  
[000](#) [950764-000](#)