

THIS COPY IS PROVIDED ON A RESTRICTED BASIS AND IS NOT TO BE USED IN ANY WAY DETRIMENTAL TO THE INTERESTS OF PANDUIT CORP.

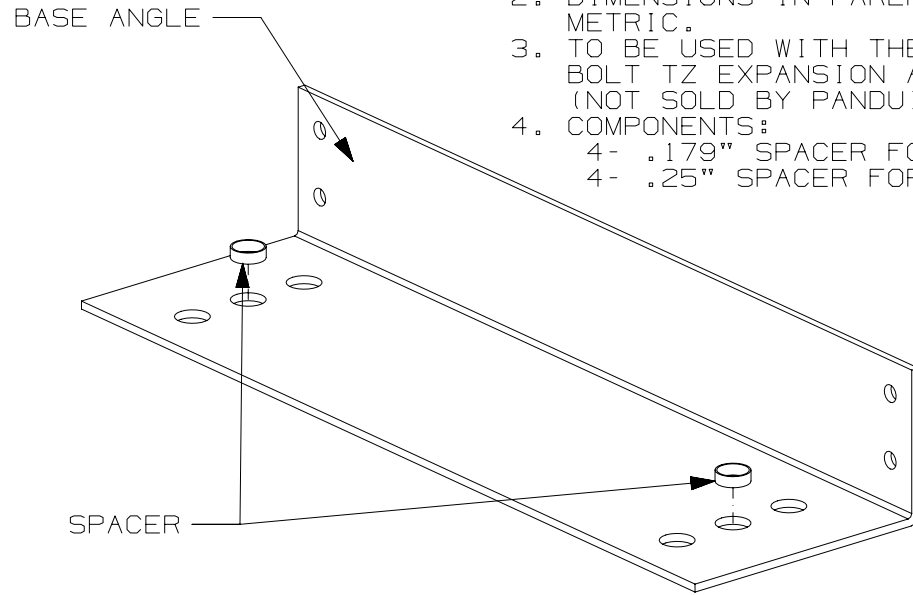
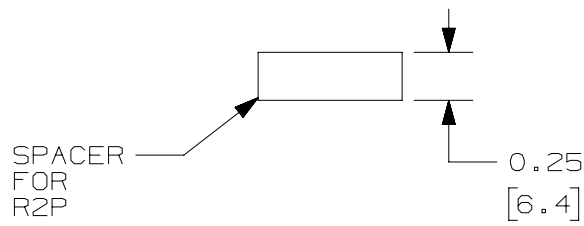
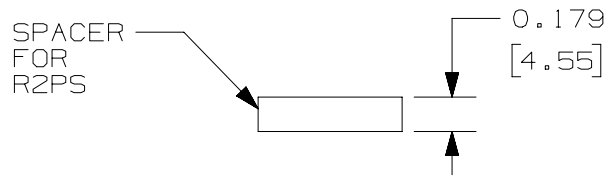
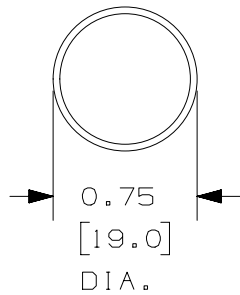

PANDUIT PART NO.	WEIGHT
R2PAK-OSHPD	0.5 LBS/EACH 0.2 Kg/EACH

NOTES:

- VISIT OUR ON-LINE CATALOG AT WWW.PANDUIT.COM FOR A LIST OF CURRENT PARTS APPLICABLE FOR USE WITH THIS PRODUCT.
- DIMENSIONS IN PARENTHESIS ARE METRIC.
- TO BE USED WITH THE 5/8" KWIK BOLT TZ EXPANSION ANCHORS. (NOT SOLD BY PANDUIT)
- COMPONENTS:
4- .179" SPACER FOR R2PS
4- .25" SPACER FOR R2P

REV	DATE	BY	CHK	APR	DESCRIPTION	ECN
00A	5-7-15	TWV	NAGL	NAGL	RELEASED TO PRODUCTION	14V456BW-DC

TITLE OSHPD BASE ANGLE ANCHOR HOLE INSERT KIT (R2PAK-OSHPD) CUSTOMER DRAWING			
ITEM REVISION NAME 14V456BW/00		PANDUIT	
DATASET FILE NAME 14V456BW_DC/00A			
UNLESS OTHERWISE SPECIFIED, DIMENSIONAL TOLERANCES ARE: ANGLE +/- 1°		MATERIAL: SEE NOTES	
DRAWN BY TWV		DRAWING NUMBER: 14V456BW-DC	
DATE 5-7-15	CHK NAGL	SCALE NONE	SIZE A
SHT 1 OF 1			

2

1

X-ON Electronics

Largest Supplier of Electrical and Electronic Components

Click to view similar products for [Racks & Rack Cabinet Accessories](#) category:

Click to view products by [Panduit](#) manufacturer:

Other Similar products are found below :

[CR-1727](#) [M00-PLN](#) [F2420](#) [F2424](#) [8310-1032-SS](#) [9104](#) [PLFF2000](#) [PLFF6000](#) [GP216](#) [PTFA60000LG](#) [H-9163-B](#) [AC220-84-1](#) [HEH050BA](#)
[1427C3](#) [BAS-5104](#) [N-700-2](#) [190-002](#) [HTL10](#) [HTS10](#) [PC-118](#) [PC-780L](#) [PC-79](#) [PC-800](#) [SC4-28](#) [F3024](#) [AKWAMT](#) [PLFF1000](#) [GRPB12PG](#)
[CG3-340S/12](#) [2CWDP36](#) [2CWDP48](#) [2SSHINGE](#) [CP-001BK](#) [CPL19431LG1](#) [R570-004-107](#) [M6123-4007-SS](#) [TS170](#) [531300535](#) [BRX-](#)
[12290](#) [C4BD3077SBK1](#) [UPS 7-17-14 PLAIN](#) [LP40](#) [5261304-07](#) [CCA26-44-01](#) [706-102](#) [CG3-160G](#) [7112C-PLN ALUM](#) [CM10](#) [TS81](#) [7142](#)