

Panduit Part number	Wire range AWG (mm <sup>2</sup> )	Tab Size	Housing color	Dim. "F"	Dim. "W"	Dim. "L"	Maximum Wire Insulation Diameter	MINIMUM Wire Insulation Diameter	Tools
DNG18-187FB	22-18 (0.5 - 1.0)	.187 X .032	Red	.22 (5.6)	.29 (7.4)	.89 (22.6)	.126 (3.20)	.050 (1.27)	CT-1015
DNG18-188FB	22-18 (0.5 - 1.0)	.187 X .020	Red	.22 (5.6)	.29 (7.4)	.89 (22.6)	.126 (3.20)	.050 (1.27)	
DNG18-250FB	22-18 (0.5 - 1.0)	.250 X .032	Red	.22 (5.6)	.35 (8.9)	.93 (23.6)	.126 (3.20)	.050 (1.27)	
* DNG14-187FB	16-14 (1.5 - 2.5)	.187 X .032	Blue	.25 (6.4)	.29 (7.4)	.89 (22.6)	.153 (3.89)	.070 (1.78)	
* DNG14-188FB	16-14 (1.5 - 2.5)	.187 X .020	Blue	.25 (6.4)	.29 (7.4)	.89 (22.6)	.153 (3.89)	.070 (1.78)	
DNG14-250FB	16-14 (1.5 - 2.5)	.250 X .032	Blue	.25 (6.4)	.35 (8.9)	.93 (23.6)	.153 (3.89)	.070 (1.78)	

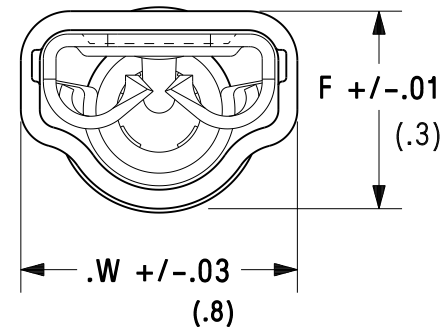

Notes:

- Used for:
  - A. 600V max voltage rating
  - B. 221°F (105°C) max temperature rating
  - C. Stranded copper wire only
- Wire strip length:
  - 250: 1/4 <sup>+1/32</sup> (6.4 <sup>+8</sup> / -0)
  - 187/188: 9/32 <sup>+1/32</sup> (7.1 <sup>+8</sup> / -0)
- Material:
  - A. Stamping - Tin plated brass
  - B. Housing - Nylon
- SEE [www.panduit.com](http://www.panduit.com) FOR PART NUMBER SUFFIX DESIGNATION FOR PACKAGE SIZE.
- Dimensions in brackets are in millimeters or mm<sup>2</sup>
- DNG14-187FB AND DNG14-188FB ARE UL RECOGNIZED FOR USE WITH COPPER ALLOY TABS.

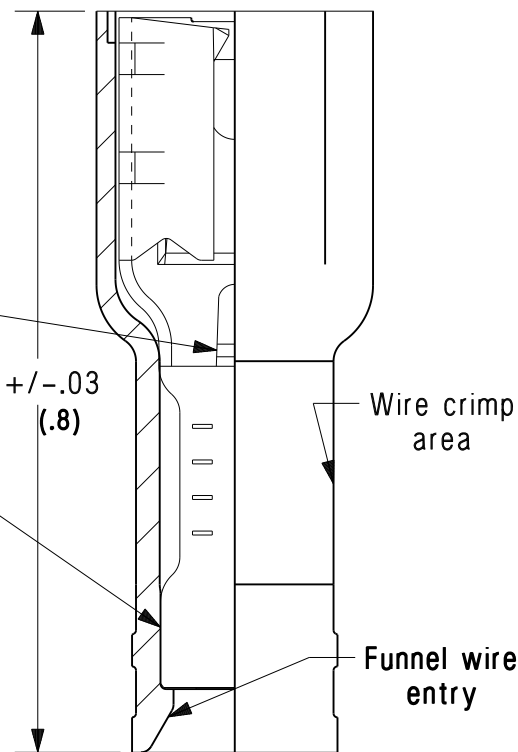

TINLEY PARK, ILLINOIS

Supra-Grip™ Fully Insulated Loose Piece Female Disconnect

08	8/11	SHOR	MODIFIED NOTE #4, REMOVED PACKAGE SIZES		
07	02/11	SRB	Added Packaging code L= 50 pieces		
REV	DATE	BY	DESCRIPTION	PM	CUST

DRAWN BY	BDK	CHK'D	RLS	SCALE	None	DRAWING NO./CAD FILENAME	A41570
----------	-----	-------	-----	-------	------	--------------------------	--------

## X-ON Electronics

Largest Supplier of Electrical and Electronic Components

*Click to view similar products for [Terminals](#) category:*

*Click to view products by [Panduit](#) manufacturer:*

Other Similar products are found below :

[HT-13-10](#) [71M-250-32-NB](#) [01-2065-1-0216](#) [00581P0075](#) [M10-10RX](#) [M10BCK](#) [60205-1](#) [604200-1](#) [60598-1-CUT-TAPE](#) [60617-1-C](#) [60873-1](#) [M14-516R/SK](#) [M14-6RSX](#) [M18-10FLX](#) [M18-8FBX](#) [M18-8R/LX](#) [M18BCK](#) [61314-6-C](#) [61-S](#) [61-SN-A](#) [62-NBM-A](#) [63-S](#) [640179-1](#) [640917-2-CUT-TAPE](#) [6501550002](#) [66107-2-C](#) [66107-4-C](#) [696683-1](#) [696834-1](#) [696861-1](#) [696931-1](#) [696999-1](#) [M8-516RK](#) [M86700006](#) [MA250DMFMX-A](#) [701-2007](#) [701-2307](#) [701-7761-03](#) [70F-110-32-PB](#) [718-N-A](#) [71M-187-20-NBL](#) [71M-250-32-NBL](#) [72F-187-20-NBL](#) [72M-250-32-NBL](#) [7310](#) [73F-250-32](#) [73F-250-32-NBL](#) [73F-250-32-NL](#) [F14-10C](#) [F-1M](#)