

LOC	DIST	HB	P	LTR	D	DESCRIPTION	DATE	DWN	APVD
						PN. OBSOLETE ECD-12-004810	24APR12		BHY

REVISIONS

STATUS	PART NO	PART B	PART A	ITEM
OBSOLETE	1721150-1	3V	ORWH-SS-103D1F	A
ACTIVE	1721150-2	5V	ORWH-SS-105D1F	B
ACTIVE	1721150-3	6V	ORWH-SS-106D1F	C
ACTIVE	1721150-4	9V	ORWH-SS-109D1F	D
ACTIVE	1721150-5	12V	ORWH-SS-112D1F	E
OBSOLETE	1721150-6	18V	ORWH-SS-118D1F	F
ACTIVE	1721150-7	24V	ORWH-SS-124D1F	G
ACTIVE	1721150-8	48V	ORWH-SS-148D1F	H
OBSOLETE	1721150-9	3V	ORWH-SH-103D1F	I
ACTIVE	1-1721150-0	5V	ORWH-SH-105D1F	J
OBSOLETE	1-1721150-1	6V	ORWH-SH-106D1F	K
OBSOLETE	1-1721150-2	9V	ORWH-SH-109D1F	L
ACTIVE	1-1721150-3	12V	ORWH-SH-112D1F	M
OBSOLETE	1-1721150-4	18V	ORWH-SH-118D1F	N
ACTIVE	1-1721150-5	24V	ORWH-SH-124D1F	O
ACTIVE	1-1721150-6	48V	ORWH-SH-148D1F	P
ACTIVE	1-1721150-7	24V	ORWH-SH-124D1F	R

①

DRILLING DIAGRAM (BOTTOM VIEW)

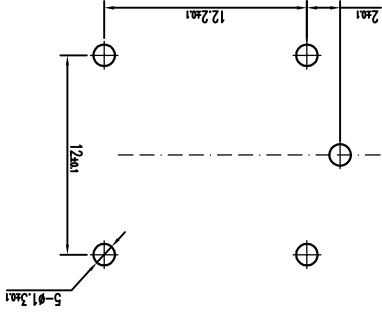

CIRCUIT DIAGRAM (BOTTOM VIEW)

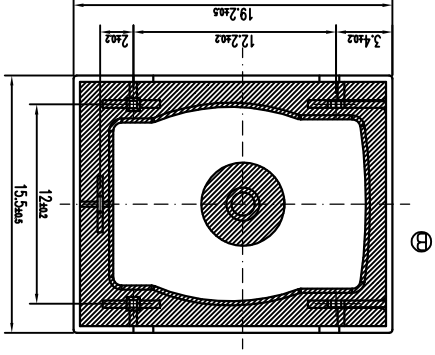
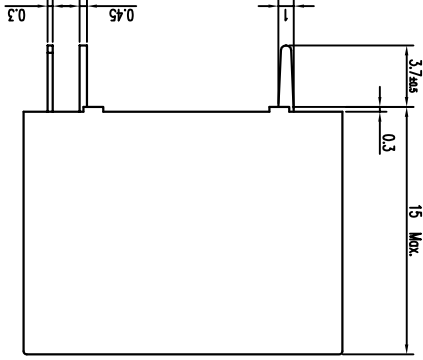
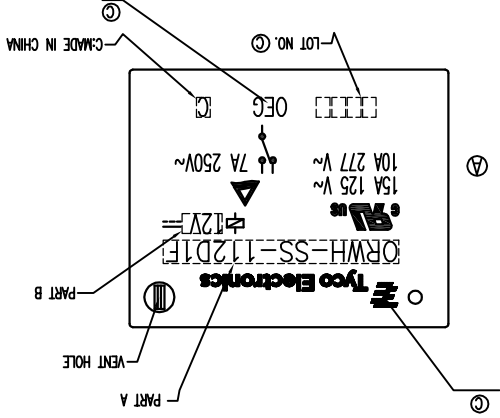
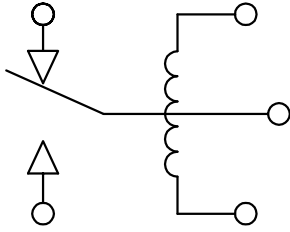

GENERAL TOLERANCE

3mm min.	±0.3mm
1 - 2.99mm	±0.2mm
0.99mm max.	±0.1mm
Diagram dimension	Tolerance

NOTE
①LOT NO. SYSTEM AS FOLLOWING:
YEAR
WEEK

ITEM	DESCRIPTION	MATERIAL	TREATMENT	INCOMBUSTIBILITY
1	YOKE	STEEL	N! PLATED	
2	ARMATURE FORM C	STEEL	Cu PLATED	
3	CORE	STEEL	Cu PLATED	
4	NO TERMINAL	CU ALLOY		
5	NC TERMINAL	CU ALLOY		
6	MOVABLE SPRING	CU ALLOY		
7	MOVABLE CONTACT	Ag ALLOY		
8	STATIONARY CONTACT	Ag ALLOY		
9	CASE	PBT	UL94 V-0	
10	BOBBIN	PBT	UL94 V-0	
11	COIL TERMINAL	HCP		
12	MAGNETIC WIRE	MW79	CLASS 155 F	
13	SEAL	EPOXY RESIN		
14	UV SEAL (FOR SH)	UV RESIN		

DWN XN.ZHANG		CHK WAYNE PENG	APVD M.J.HO	PRODUCT SPEC	APPLICATION SPEC	WEIGHT	MATERIAL		SEE MATERIAL TABLE
TE Connectivity		WAYNE PENG		M.J.HO		DIMENSIONS: MM		TOLERANCES UNLESS OTHERWISE SPECIFIED:	
TE Connectivity		ORWH-11 CD FREE CUSTOMER DRAWING		DRAWING NO. 1721150		PAGE CODE A3 00779		FINISH	
SCALE 3:1		SHEET 1 OF 1		REV D		RESTRICT TO		0 PLC	
CUSTOMER DRAWING		DRAWING NO. 1721150		DRAWING NO. 1721150		SIZE A3		1 PLC	
3:1		SHEET 1 OF 1		REV D		RESTRICT TO		2 PLC	
SCALE 3:1		SHEET 1 OF 1		REV D		RESTRICT TO		3 PLC	
SCALE 3:1		SHEET 1 OF 1		REV D		RESTRICT TO		4 PLC	

X-ON Electronics

Largest Supplier of Electrical and Electronic Components

Click to view similar products for [General Purpose Relays](#) category:

Click to view products by [TE Connectivity](#) manufacturer:

Other Similar products are found below :

[APF30318](#) [JVN1AF-4.5V-F](#) [PCN-105D3MHZ](#) [5JO-10000S-SIL](#) [5JO-1000CD-SIL](#) [5JO-400CD-SIL](#) [LY2S-AC220/240](#) [LYQ20DC12](#)
[6031007G](#) [6131406HQ](#) [6-1393099-8](#) [6-1393122-4](#) [6-1393123-2](#) [6-1393767-1](#) [6-1393843-7](#) [6-1415012-1](#) [6-1419102-2](#) [6-1423698-4](#) [6-](#)
[1608051-6](#) [6-1608067-0](#) [6-1616170-6](#) [6-1616248-2](#) [6-1616282-3](#) [6-1616348-2](#) [6-1616350-1](#) [6-1616350-8](#) [6-1616358-7](#) [6-1616359-9](#) [6-](#)
[1616360-9](#) [6-1616931-6](#) [6-1617039-1](#) [6-1617052-1](#) [6-1617090-2](#) [6-1617090-5](#) [6-1617347-5](#) [6-1617353-3](#) [6-1617801-8](#) [6-1618107-9](#) [6-](#)
[1618248-4](#) [M83536/1-027M](#) [CX-4014](#) [MAHC-5494](#) [MAVCD-5419-6](#) [703XCX-120A](#) [7-1393100-5](#) [7-1393111-7](#) [7-1393767-8](#) [7-1414968-8](#)
[7-1419130-3](#) [7-1608047-2](#)