

3M™ Fibre Optic Couplings, LC

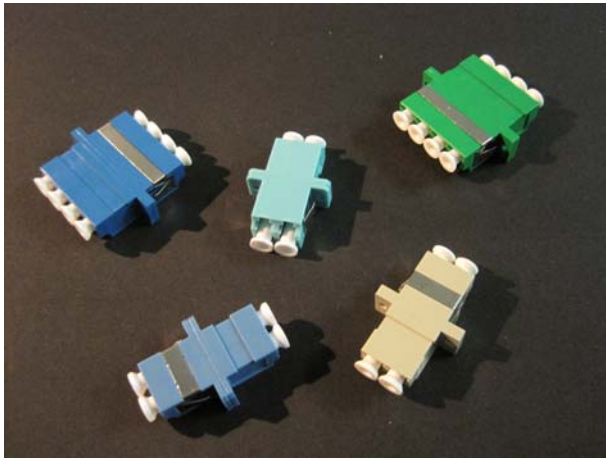

LC Single-mode and Multimode Couplings
Simplex and Duplex and Quad

3M offers a wide range of RoHS compliant LC couplings for all applications in Premise and FTTX networks.

All couplings comply with the corresponding Standards IEC 61754-20 and GR-326 for single-mode and multimode technology.

Single-mode couplings for both PC and APC connections are equipped with Zirconia ceramic split sleeves to ensure best alignment and high performance also under temperature extremes and rough handling conditions.

The precision moulded polymer housing provides constant long term optical and mechanical performance.

Also the multimode OM3 and OM4 couplings contain Zirconia ceramic sleeves, whereas the OM1 and OM2 couplings are equipped with PhBr metal sleeves.

All couplings can be fixed with the applied standard stainless steel fixing clamp. The flanged versions also have holes for 2mm screw fixing.

Features

- Single-mode and OM3/4 with Zirconia sleeves
- Integrated metal clips
- Flanged and unflanged versions

Benefits

- Low insertion loss, perfect alignment
- Easy and quick mounting in front plates
- High port density

Specifications

Parameters for all SM and MM Couplings

Insertion Loss	≤0,2dB
Mating Durability	≤0,2dB increase after ≤ 500 matings
Pullout Force	100-300 N
Operating Temperature	-40°C to +85°C
Alignment sleeve material, multimode OM1/OM2	PhBr
Alignment sleeve material, single-mode and MM OM3/OM4	Zirconia ceramic

- LC Duplex Coupling, SM, flanged, SC SX footprint, blue 8613-E
- LC/APC Duplex Coupling, SM, flanged, SC SX footprint, green 8613-GE
- LC Duplex Coupling, MM OM1/2, flanged, SC SX footprint, beige 6613-E
- LC Duplex Coupling, MM OM3/4 flanged, SC SX footprint, aqua 6613-EOZ

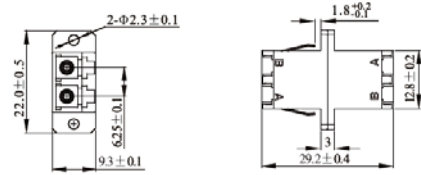

Unit: mm

- LC Duplex Coupling, SM, flangeless, SC SX footprint, blue 05-751-20700
- LC/APC Duplex Coupling, SM, flangeless, SC SX footprint, green 05-751-19900

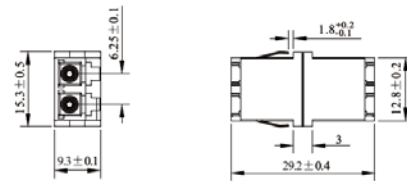

Unit: mm

- LC Quad Coupling, SM, flanged, blue 8314-E
- LC/APC Quad Coupling, SM, flanged, green 8314-GE

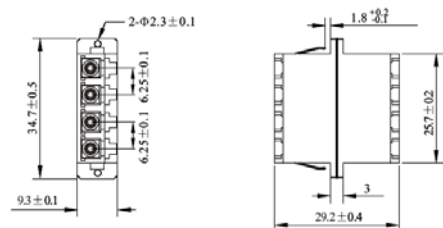

Unit: mm

Sheet thickness



1,6mm max. incl coating for quick assembly spring
1,2mm min. incl. coating for 2mm screw mounting

Hole pattern LC DX

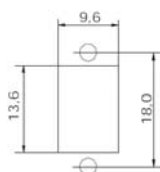

Hole pattern LC Quad

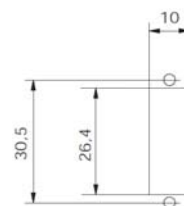

Ordering Information

Ref. No. MOQ

	LC Duplex Coupling, SM, flanged, SC SX footprint, blue LC/APC Duplex Coupling, SM, flanged, SC SX footprint, green	8613-E 8613-GE	60 each 60 each
	LC Duplex Coupling, MM OM1/2, flanged, SC SX footprint, beige LC Duplex Coupling, MM OM3/4, flanged, SC SX footprint, aqua	6613-E 6613-EOZ	60 each 60 each
	LC Duplex Coupling, SM, flangeless, blue LC/APC Duplex Coupling, SM, flangeless, green	05-751-20900 05-751-20800	60 each 60 each
	LC Quad Coupling, SM, flanged, blue LC/APC Quad Coupling, SM, flanged, green	8314-E 8314-GE	60 each 60 each

Pictures show typical housing designs. Variants within the specification are possible.

Important Notice

The details contained in this literature have been carefully prepared from information available to 3M at the time of its production. However, it is not intended to be relied upon for purposes of product specification and you should contact your sales representative if specification details are required. Because of the wide variety of processes and conditions in which these products may be used, the user should first carry out tests to determine the suitability of the products for the particular use intended. All questions of warranty and liability relating to 3M products are governed by the selling 3M subsidiary's Terms of Sale subject where applicable to the prevailing law.

3M is trademark of the 3M company. SID is a trademark of Quante AG.



Europe, Middle East & Africa
c/o 3M Deutschland GmbH
Carl-Schurz-Straße 1
41453 Neuss - Germany
Tel.: ++49 (0)2131 / 14-5999
Fax: ++49 (0)2131 / 14-5998
Internet: www.3MTelecommunications.com/eu

Rights reserved to make technical alternations.
Dr.Nr.07-401-30200 Index 0 Revision 03.2013

X-ON Electronics

Largest Supplier of Electrical and Electronic Components

Click to view similar products for [3m manufacturer](#):

Other Similar products are found below :

[SC401U](#) [98-0003-3071-6](#) [80-0012-6467-2](#) [00-054007-70220-7](#) [00-054007-34717-0](#) [5952-3/4"x15yds](#) [021200-40230](#) [6840-2X50-GRAY](#)
[6A11-A0121-007.0-0](#) [701-W](#) [7993MP-2CIRCLE-100](#) [FDV14-187C](#) [FE-5100-5126-4](#) [FE-5100-5273-4](#) [FE-5100-5492-0](#) [8124/14](#) [812510-100](#)
[8125/17](#) [813216](#) [8204-3LFM](#) [8425-8](#) [MNG14BCX](#) [FP301-1-6"-Clear](#) [FV14-6C](#) [920102-01-25-R](#) [927739-40](#) [929835-01-28-RK](#)
[929974-01-40-R](#) [951240-2520-AR-PR](#) [960X/980X](#) [98-0003-3075-7](#) [HF365/16SF](#) [HF36564-100](#) [HF625/26-30](#) [1/2-5-4492W](#) [1/2-5-5430](#) [1/2-](#)
[5-850S](#) [1/2-5-3431](#) [12X12-6-4056B](#) [12X12-6-433](#) [12X12-6-4930](#) [1311](#) [13-500-NB](#) [14526-EZ5B-300-02C](#) [1-4-4658F](#) [14520-EZAB-300-](#)
[0EC](#) [DSTK9013-3420](#) [DSTK9015-3402](#) [14T26-SZLB-200-0LC](#) [14T50-SZWB-100-0NC](#)