

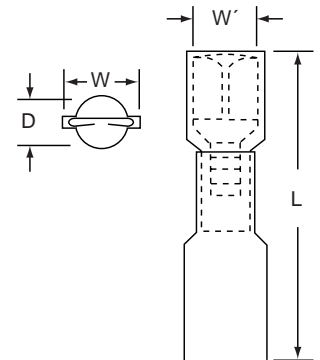

# Scotchlok™ Terminals

MNHU18-250DFI, MNHU14-250DFI,  
MNHU10-250DFI

Female Disconnect, Nylon/Heat Shrink  
Fully Insulated, Butted Seam



## Data Sheet

Product Number	Wire Range (AWG)	Male Tab Width (W') x Thickness	L	W	D	Barrel Length	Barrel I.D.
MNHU18-250DFI	22-18	0.250 x 0.032	1.2	0.37	0.23	0.25	0.080
MNHU14-250DFI	16-14	0.250 x 0.032	1.2	0.37	0.23	0.25	0.080
MNHU10-250DFI	12-10	0.250 x 0.032	1.2	0.39	0.32	0.25	0.165

## Specifications

Wire Size: See Table Above  
 Barrel Seam: Butted  
 Maximum Voltage Rating: 600 V Building Wire  
 1000 V Signs or Fixtures (Luminares)  
 Maximum Temperature Rating: 221°F (105°C)  
 Maximum Current: Same as Wire  
 Insulator Material: Nylon/Adhesive Lined Polyolefin  
 Terminal Material: Brass  
 Plating: Tin

## Installation Information

**⚠ WARNING**

Turn power off before installing or removing terminal. All electrical work should be done according to appropriate electrical codes.

For use on stranded copper wire only.

Strip away the end 3/8 inch of wire insulation.

Make the crimp in the proper station of a recommended 3M™ crimp tool: TH-440, TH-450 (scissor style) hand tools.



 Barrel Crimp (Electrical)

Shrink tubing using a heat gun. Heat until tubing is completely shrunk and adhesive protrudes slightly from the tubing.

## Engineering Specification

Crimp-Type Female Disconnects shall, electrically and mechanically connect permanently to a prestripped end of a stranded copper wire: and have a tongue portion with fingers which grip a male quick disconnect in a separable, reusable manner, forming a Quick Connect Wiring Connection.

The connector line shall offer a tongue variations (sized to grip Male Tabs: 0.250" x 0.032" per ANSI/NEMA CD-2) and barrel variations in wire(AWG) size (22-18, 16-14, 12-10) and construction (nylon fully insulated and polyolefin heatshrink material). The tongue shall be marked with the wire range and the manufacturer's symbol (↑).

The Nylon Fully Insulated 0.250" Female Disconnect shall be tin plated 0.020" thick brass, with a tongue for gripping a 0.250" x 0.032" male tab per ANSI/NEMA CD-2 and a 0.25" long barrel covered by a molded nylon funnel entry sleeve, which extends to cover the tongue, color coded, and sized for a specified (AWG) wire range (22-18, 16-14, 12-10). Color coded adhesive lined heat shrink tubing extends from the crimp area beyond the terminal. The heat activated tubing conforms to the terminal and the adhesive bonds to the conductor.

3M and Scotchlok are trademarks of 3M

### IMPORTANT NOTICE

Before using this product, you must evaluate it and determine if it is suitable for your intended application. You assume all risks and liability associated with such use.

**Warranty; Limited Remedy; Limited Liability.** This product will be free from defects in material and manufacture as of the date of purchase. **3M MAKES NO OTHER WARRANTIES INCLUDING, BUT NOT LIMITED TO, ANY IMPLIED WARRANTY OF MERCHANTABILITY OR FITNESS FOR A PARTICULAR PURPOSE.** If this product is defective within the warranty period stated above, your exclusive remedy shall be, at 3M's option, to replace or repair the 3M product or refund the purchase price of the 3M product. **Except where prohibited by law, 3M will not be liable for any loss or damage arising from this 3M product, whether direct, indirect, special, incidental or consequential regardless of the legal theory asserted.**

# 3M

### Electrical Products Division

6801 River Place Blvd.  
Austin, TX 78726-9000  
<http://www.3M.com/elpd>

Litho in USA.  
© 3M 2002 78-8125-9932-8-B

## X-ON Electronics

Largest Supplier of Electrical and Electronic Components

*Click to view similar products for [Terminals](#) category:*

*Click to view products by [3M](#) manufacturer:*

Other Similar products are found below :

[00-054007-01074-6](#) [00-054007-70206-1](#) [00-054007-70210-8](#) [00-054007-70217-7](#) [00-054007-70226-9](#) [00-054007-70228-3](#) [00-054007-70248-1](#) [00-054007-70256-6](#) [00-054007-70301-3](#) [00-054007-70316-7](#) [00-054007-49560-4](#) [00-054007-70209-2](#) [00-054007-70225-2](#) [00-054007-70227-6](#) [00-054007-70231-3](#) [00-054007-70241-2](#) [00-054007-70242-9](#) [00-054007-70244-3](#) [00-054007-70246-7](#) [00-054007-70263-4](#) [00-054007-70288-7](#) [00-054007-70290-0](#) [00-054007-70300-6](#) [00-054007-70304-4](#) [01-2065-1-0216](#) [01-2900-1-04412](#) [00581P0075](#) [600TS-10](#) [60205-1](#) [604200-1](#) [605601-1](#) [60598-1-CUT-TAPE](#) [61314-6-C](#) [61810-3](#) [61-S](#) [62149-1](#) [626-0194](#) [62-NBM-A](#) [63-S](#) [640179-1](#) [M55155/059I03](#) [M55155/079C01](#) [M55155/099B03](#) [M55155/099H02](#) [M55155/109H01](#) [M55155/109H02](#) [M55155/12XH05](#) [M55155/16XH02](#) [M55155/29-5S](#) [M55155/29XJ08](#)