

3M™ Helmet Integrated Safety Spectacles – V9 Series

Technical datasheet



Product description

The 3M™ Helmet Integrated Safety Spectacles V9 Series is a range of integrated safety eyewear designed to attach to the headband of 3M™ helmet or headgear products.

Product range

V9A: Helmet integrated spectacles, Amber

V9C: Helmet integrated spectacles, Clear

V9G: Helmet integrated spectacles, Grey

Key features

- ▶ The 3M™ Helmet integrated Safety Spectacles V9 Series are designed to be fitted to the following 3M™ products:
 - 3M™ G500 Headgear
 - 3M™ G22 Industrial Safety Helmet
 - 3M™ G2000 Industrial Safety Helmets
 - 3M™ G3000 Industrial Safety Helmets
 - 3M™ G3501 Industrial Safety Helmets
 - 3M™ H700 Industrial Safety Helmets
 - 3M™ X5000 SecureFit™ Safety Helmets
 - 3M™ X5500 SecureFit™ Safety Helmets
- ▶ The Spectacles feature an easy to use clip-on attachment to connect to the headband of the helmet or headgear
- ▶ The Spectacles feature 3 pivoting adjustment points allowing for easy positioning to a range of face shapes and sizes. In order to assess the fit of safety eyewear we recommend the 3M™ eyewear fit system
- ▶ Possible adjustments include:
 - Up and down
 - Forwards and backwards
 - Angle up and down
- ▶ The adjustment mechanism also allows the spectacles to be stored inside the helmet to protect it from damage during storage or when eye protection is not required
- ▶ The spectacles can be used at the same time as faceshields when continuous eye protection is required but faceshields are not in constant use
- ▶ Designed without temple arms the helmet integrated safety spectacles will not interfere with the acoustic seal of helmet mounted earmuffs

Typical applications

- ▶ General industry
- ▶ Construction
- ▶ Forestry
- ▶ Metal working

Materials

Component	Material
Lens	Polycarbonate
Spectacle arms	Polyamide
Nose pad	Thermoplastic rubber

Standards and approvals

The 3M™ Helmet integrated Safety Spectacles V9 Series meet the requirements of the PPE Regulation (EU) 2016/425 and are thus CE marked. The products have been tested and approved by BSI Group, The Netherlands B.V. Say Building, John M. Keynesplein 9, 1066 EP Amsterdam, The Netherlands, Notified Body No. 2797.

The 3M™ Helmet integrated Safety Spectacles V9 Series have been tested and approved in accordance with EN 166:2001.

Storage

Temperature range for usage	+3° C - +40° C, <85% humidity
Maximum recommended product life	5 years.

The product life as defined above is indicative data. The product life is subject to many external and non-controllable factors and should not be interpreted as a warranty.

Coatings

The 3M™ Helmet Integrated Safety Spectacles feature a fog resistant coating to help improve fog resistance performance when compared to an uncoated eye protector.

Performance

The table below summarises the 3M™ Helmet Integrated Safety Spectacles specifications according to EN 166:2001

Model	Filtering performance	Optical clarity	Impact performance
V9A	2-1,2	1	F
V9C	2-1,2	1	F
V9G	5-3,1	1	F

Filtering performance:

2-1,2 = UV filter (EN 170:2001), Shade 1,2
 5-3,1 = Sunglare filter (EN 172:1994), Shade 3,1

Optical clarity:

The allowable variation in refractive powers for oculars is assessed during certification of the product. Class 1 is the highest performance class for optical clarity.

Impact performance:

Protection against high speed particles for low energy impacts, marked F (45m/s).

Use limitations

- ▶ Where the visor and frame markings do not match the lowest level of protection applies
- ▶ Scratched or damaged oculars should be replaced
- ▶ Eye-protectors against high speed particles worn over standard ophthalmic spectacles may transmit impacts, thus creating a hazard to the wearer. Do not use this product against hazards other than those specified in this document
- ▶ Never modify or alter this product
- ▶ Please contact 3M for further information on alternative or additional protection requirements

Important notice

The use of the 3M product described within this document assumes that the user has previous experience of this type of product and that it will be used by a competent professional. Before any use of this product it is recommended to complete some trials to validate the performance of the product within its expected application.

All information and specification details contained within this document are inherent to this specific 3M product and would not be applied to other products or environment. Any action or usage of this product made in violation of this document is at the risk of the user.

Compliance to the information and specification relative to the 3M product contained within this document does not exempt the user from compliance with additional guidelines (safety rules, procedures). Compliance to operational requirements especially in respect to the environment and usage of tools with this product must be observed. The 3M group (which cannot verify or control those elements) would not be held responsible for the consequences of any violation of these rules which remain external to its decision and control.

Warranty conditions for 3M products are determined with the sales contract documents and with the mandatory and applicable clause, excluding any other warranty or compensation.

Eye Protection is only effective if it is correctly selected, fitted and worn throughout the time when the wearer is exposed to hazards. 3M offers advice on the selection of products, and training in the correct fitting and usage.

For more information on 3M products and services please contact 3M.

Personal Safety Division

3M United Kingdom PLC
 3M Centre
 Cain Road, Bracknell
 Berkshire RG12 8HT
 t: 0870 60 800 60
 www.3M.eu/PPEsafety

Assembly instructions

These instructions detail the steps required to fit the spectacles onto any 3M™ Helmet or 3M™ G500 Headgear.

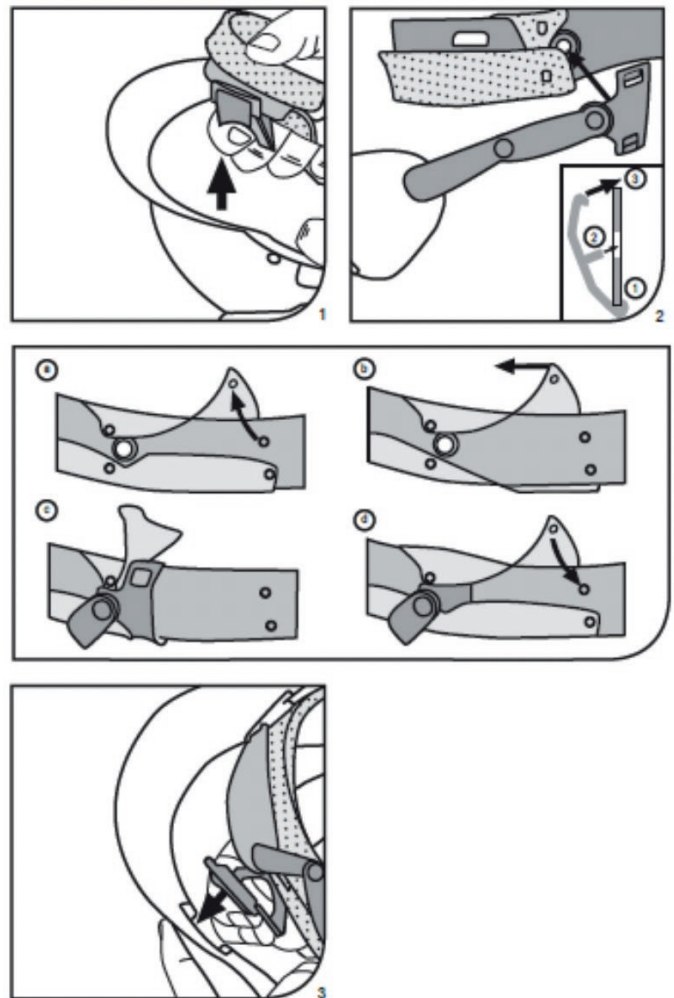

X-ON Electronics

Largest Supplier of Electrical and Electronic Components

Click to view similar products for [PPE Safety Equipment / Lockout Tagout](#) category:

Click to view products by [3M](#) manufacturer:

Other Similar products are found below :

[AB12-SF1260](#) [GPSL-6KA](#) [GPSL-8MKEY](#) [35035](#) [702201756](#) [PSL-PC38-33](#) [7100078986](#) [132231](#) [44-809](#) [G3000NUV-VI-R](#) [STC1165](#)
[STC5951](#) [DAF010701](#) [WC000003](#) [509-0015](#) [509-0017](#) [509-0019](#) [509-0020](#) [509-0021](#) [509-0022](#) [509-0002](#) [509-0003](#) [509-0004](#) [509-0006](#)
[109-0920](#) [109-0917](#) [109-0918](#) [109-0919](#) [DYC200-01-01-9-DYCLEAN-S](#) [109-0027](#) [X2A](#) [26702](#) [28774](#) [SFTY PADLOCK NYLON 38MM](#)
[SHA YELLOW 6/PAC](#) [FMB12](#) [FMB14](#) [FMB14 MIDI](#) [FMB18](#) [FMB38](#) [FMFR 12](#) [FMFR 12-AUT](#) [FMFR 14](#) [FMFR 14 MIDI](#) [FMFR 18](#)
[FMFR 38](#) [FML 12](#) [FML 14](#) [FML 14 MIDI](#) [FML 18](#) [FMR 12](#)