

REV C HDT-04-10

REVISIONS			
SYM	DESCRIPTION	DATE	APPROVED
C	ECR-15-015015	10/14/15	BAW

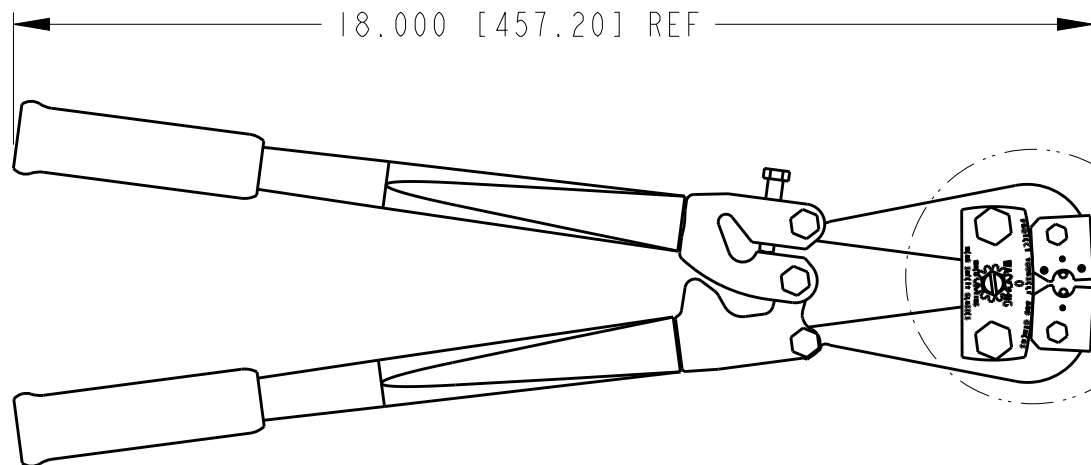

SEE DETAIL A



SOLID CONTACT PART NUMBER	SIZE TYPE	WIRE SIZE AWG	RETAINER ASSY CRIMP TOOL	RECOMMENDED INS. STRIP LENGTH	"GO" GAGE	"NOGO" GAGE
4062-006-04141 4060-005-04141	4 SOC 4 PIN	4	4034-201-0400	.480-.542 [12.19-13.77]	.120 [3.05]	.130 [3.30]
4062-005-04141 4060-006-04141	4 SOC 4 PIN	6				
4062-004-08141 4060-003-08141	8 SOC 8 PIN	8	4034-202-0800	.475-.537 [12.06-13.64]	.090 [2.29]	.100 [2.54]
4062-003-08141 4060-004-08141	8 SOC 8 PIN	10				

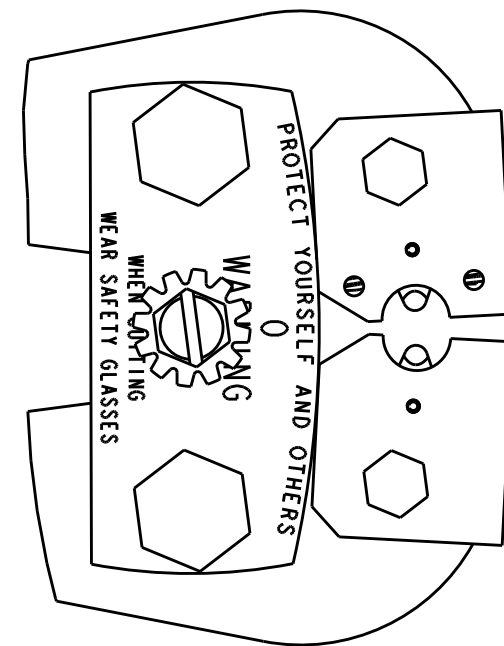

DETAIL A

DRAWING REPLACED BY 408-32133

- 5. WIRE SIZES PER SAE J1128 AND J1127.
- 4. PROPER LOCATION OF CONTACT IN CRIMP TOOL WILL PRODUCE A CRIMP CENTERED BETWEEN THE INSPECTION HOLE AND CRIMP BARREL END.
- 3. CAUTION: DO NOT CLOSE TOOL ON GAGES. CLOSE TOOL FIRST THEN INSERT GAGE PIN.
- 2. MINIMUM ±.0005 [.013] TOLERANCE STEEL GAGE PINS.
- 1. DIMENSIONS ARE IN INCHES [mm].

NOTES: UNLESS OTHERWISE SPECIFIED

- 6. TOOL IS PREASSEMBLED WITH 4034-201-0400. 4034-202-0800 IS PACKAGED SEPARATE WITH TOOL.

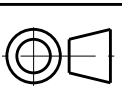

SIGNATURE & DATE		CRIMP TOOL CE SERIES	EP	MATL. CODE	
DR	J. APOSTOL 17JUN2002		3850 INDUSTRIAL AVE. HEMET, CA 92545		
CHK			<b>DEUTSCH</b> INDUSTRIAL		
PE			<b>B</b>	<b>HDT-04-10</b>	
APPD				DWG SIZE	CODE 4AFU8
SCALE	NONE	WT			

ENVELOPE

## X-ON Electronics

Largest Supplier of Electrical and Electronic Components

*Click to view similar products for [Crimpers](#) category:*

*Click to view products by [TE Connectivity](#) manufacturer:*

Other Similar products are found below :

[576771-1](#) [576788-2](#) [010-0041](#) [010-0055](#) [010-0096](#) [604228-1](#) [M225202-37](#) [CT150-2-D02](#) [CT150-4-LY2](#) [CT150-6-RH07](#) [M322](#) [63484-3701](#)  
[63800-0140](#) [63800-8355](#) [63811-3275](#) [63811-3376](#) [63811-6375](#) [63811-6475](#) [63811-7875](#) [63811-8175](#) [63811-8875](#) [63819-0475](#) [63819-1875](#)  
[63819-2875](#) [63819-4375](#) [63819-4475](#) [63823-3475](#) [63823-5175](#) [63823-6375](#) [63823-8375](#) [63827-5375](#) [64001-0975](#) [64001-2175](#) [64001-4175](#)  
[662903-2](#) [690142-4](#) [690602-6](#) [D38999/20WA98JB-LC](#) [7-1633664-2](#) [7-22278-0](#) [7-22280-5](#) [7-240641-3](#) [762637-1](#) [808714-1](#) [8-1633117-3](#)  
[853721-6](#) [91362-1](#) [995-0001-187](#) [1-1633932-5](#) [999-50-020083](#)