

REVISION AS

DO NOT SCALE FROM THIS PRINT

DIMENSIONS ARE IN INCHES		UNLESS OTHERWISE NOTED	TOLERANCES ARE:
ONE PLACE DECIMALS: ± .1	THREE PLACE DECIMALS: ± .005	ANGLES	± 5°
TWO PLACE DECIMALS: ± .01	FOUR PLACE DECIMALS: ± .0020		

TITLE: RECEPTACLE SURFACE MOUNT (DOUBLE ROW)  
 DWG NO: RSM-1XX-XX-XXX-D-XX  
 SHEET 1 OF 2

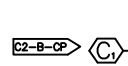
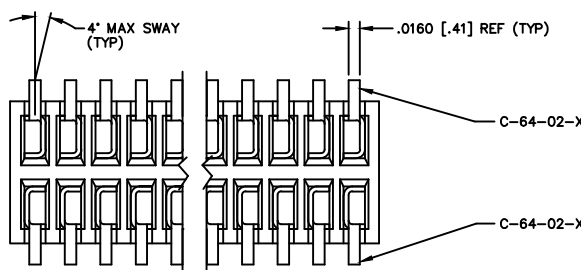
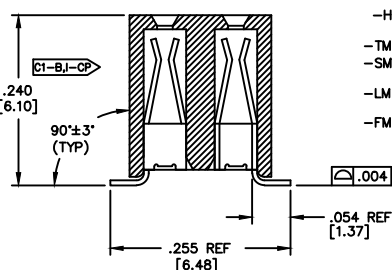
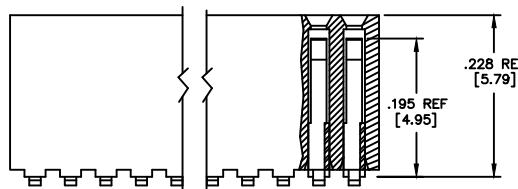
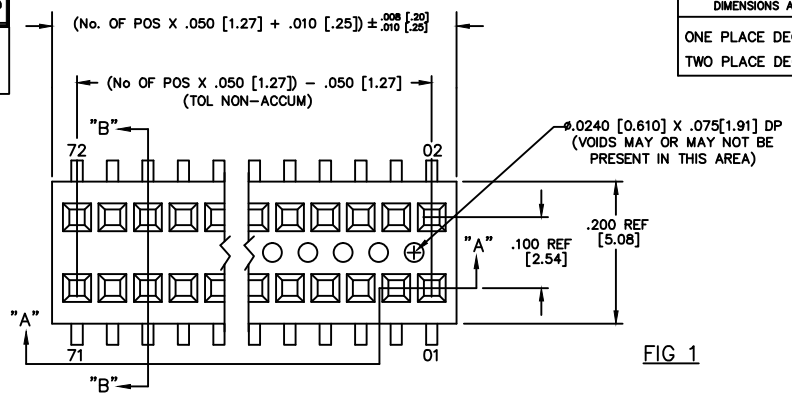

1. WILL LOSE A POSITION FOR EVERY CUT MADE ON A SOCKET STRIP; CUT FLASH TO BE .010 [.25] MAX WITH NO FLASH ALLOWED IN HOLES OR EXTENDING BELOW LEADS.
2. C1 REPRESENTS A CRITICAL DIMENSION.
3. MINIMUM RETENTION FORCE: 1.0 LB.
4. DUE TO THE HIGH AMOUNT OF INSERTION FORCE NEEDED, THE -LC OPTION IS NOT COMPATIBLE WITH AUTO PLACEMENT. SAMTEC RECOMMENDS MANUAL PLACEMENT FOR ALL ASSEMBLIES WITH THE -LC OPTION.
5. INSULATOR MATERIAL: LCP, UL 94 VO

- RSM-1XX-XX-XXX-D-XX
- BODY LENGTH SPECIFICATION**  
-02 THRU -40 POSITIONS
- LEAD STYLE**  
-02: C-64-02-X
- PLATING SPECIFICATIONS**
- S: 30μ" SELECTIVE GOLD IN CONTACT AREA MATTE TIN ON TAIL
  - F: 3 FLASH SELECTIVE GOLD IN CONTACT AREA MATTE TIN ON TAIL
  - L: 10μ" LIGHT SELECTIVE GOLD IN CONTACT AREA MATTE TIN ON TAIL
  - T: MATTE TIN CONTACT AND TAIL
  - STL: 30μ" SELECTIVE GOLD IN CONTACT AREA TIN/LEAD (90%/10 +/-5%) TAIL
  - H: 30μ" HEAVY GOLD IN CONTACT AREA 3 ON TAIL
  - TM: MATTE TIN CONTACT AND TAIL
  - SM: 30μ" SELECTIVE GOLD IN CONTACT AREA MATTE TIN ON TAIL
  - LM: 10μ" LIGHT SELECTIVE GOLD IN CONTACT AREA MATTE TIN ON TAIL
  - FM: 3μ" FLASH SELECTIVE GOLD IN CONTACT AREA MATTE TIN ON TAIL

- OPTIONS**
- LC: LOCKING CLIP (USE LC-05-TM)(SEE FIG 2, SHT 2)(SEE NOTE 4)
  - P: PICK AND PLACE PAD (AVAILABLE ON POS. 5 THRU 40 ONLY) (USE LMP-02)(SEE FIG 3, SHT 2)
  - K: POLYAMIDE FILM PAD (AVAILABLE ON POS. 5 THRU 40 ONLY) (.005 [.13] THICKNESS WITH SILICONE ADHESIVE)(SEE FIG 4, SHT 2) (USE K-500-300)
  - TR: TAPE & REEL
- BODY SPECIFICATION**
- D: DOUBLE ROW (USE RSM-XX-D)

CRITICAL DIMENSION INSPECTION TABLE	
ASSEMBLY OPERATION	IN-PROCESS INSPECTION
BREAK CARRIER	C1
ROTARY CUT	C2

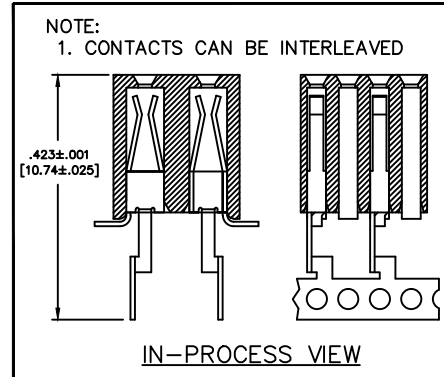

PACKAGING

- NOTES:
1. 1<sup>st</sup> POSITION TO BE LOADED IN TUBE IN THE DIRECTION OF THE ARROW.
  2. LAYER PACKAGE POSITIONS 2-4, TUBE PACKAGE POSITIONS 5-36
  3. ENDWALLS TO BE .020±.003"

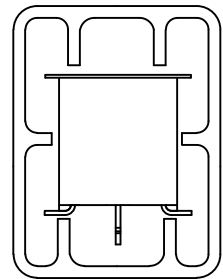
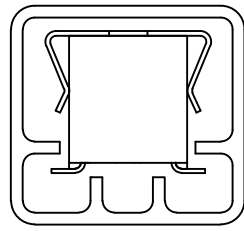

OPTION	TUBE	PLUG
-K, -LC, -K-LC	PT-1-24-04-64	TP-03
NONE, -P, -P-LC	PT-1-24-05-38	TP-09

EXISPROD\ASSEMBLY\050 RSM-DASM

**samtec**

520 PARK EAST BLVD. NEW ALBANY, INDIANA 47150  
 PHONE (812) 944-6733 P.O. BOX 1147  
 CODE 55322

MADE BY: GREG REIDINGER 11-24-92

RSM-1XX-XX-XXX-D-XX  
 SHEET 1 OF 2

**PROPRIETARY NOTE**  
 THIS DOCUMENT CONTAINS INFORMATION CONFIDENTIAL AND PROPRIETARY TO SAMTEC INC. AND SHALL NOT BE REPRODUCED OR TRANSFERRED TO OTHER DOCUMENTS OR DISCLOSED TO OTHERS OR USED FOR ANY PURPOSE OTHER THAN THAT FOR WHICH IT WAS OBTAINED WITHOUT THE EXPRESSED WRITTEN CONSENT OF SAMTEC INC.

REVISION AE

DO NOT SCALE FROM THIS PRINT

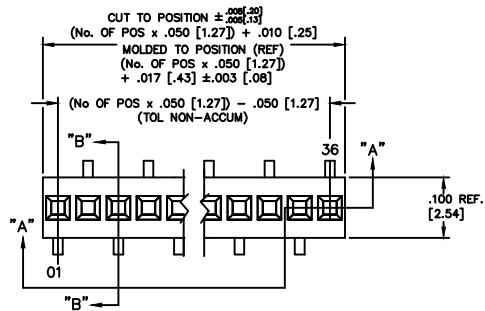
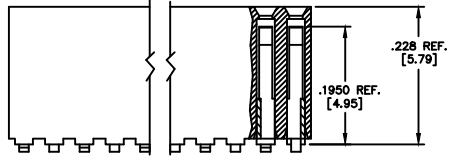
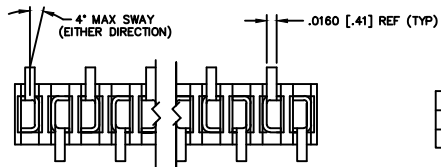

FIG. 1



SECT: "A-A"



SECT: "B-B"

CRITICAL DIMENSION INSPECTION TABLE	
ASSEMBLY OPERATION	IN-PROCESS INSPECTOR
BREAK CARRIER	C1

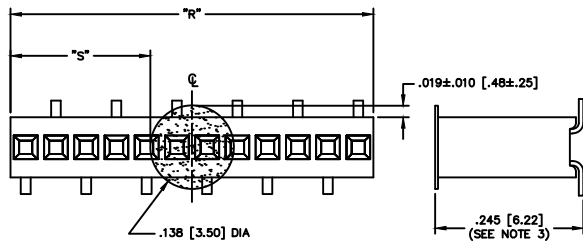

"R" = USE MEASURED DIMENSION (REF)  
 "S" =  $\{("R" - .138 [3.50]) / 2\} \pm .020 [0.51]$

FIG. 3

-K: POLYAMIDE FILM PAD  
 AVAILABLE ON POS 7 - 36 ONLY

PROPRIETARY NOTE  
 THE CONTENTS OF THIS DOCUMENT ARE UNCLASSIFIED EXCEPT WHERE SHOWN OTHERWISE. THIS DOCUMENT IS UNCLASSIFIED DATE 08-08-2010 BY 60322 UCBAW/SJS/STP

RSM-1XX-XX-XXX-S-X

UNLESS OTHERWISE NOTED TOLERANCES ARE:

ONE PLACE DECIMALS: ±.1	THREE PLACE DECIMALS: ±.005	ANGLES: ±5°
TWO PLACE DECIMALS: ±.01	FOUR PLACE DECIMALS: ±.0020	

OPTION: PICK AND PLACE PAD (USE PPP-20) (SEE FIG. 2) (AVAILABLE ON POS. 6 THRU 36 ONLY)

OPTION: POLYAMIDE FILM PAD (AVAILABLE ON POS. 7 THRU 36 ONLY) (.005 [0.13] THICKNESS WITH SILICONE ADHESIVE) (SEE FIG. 3) (USE K-500-300)

OPTION: TAPE AND REEL

PLATING SPECIFICATIONS

- S: 30μ" SELECTIVE GOLD IN CONTACT AREA, MATTE TIN ON TAIL
- F: 3μ" FLASH SELECTIVE GOLD IN CONTACT AREA, MATTE TIN ON TAIL
- L: 10μ" LIGHT SELECTIVE GOLD IN CONTACT AREA, MATTE TIN ON TAIL
- T: MATTE TIN CONTACT AND TAIL
- STL: 30μ" SELECTIVE GOLD IN CONTACT AREA, TIN/LEAD (90/10+/-5%) TAIL
- TM: MATTE TIN CONTACT AND TAIL
- SM: 30μ" SELECTIVE GOLD IN CONTACT AREA, MATTE TIN ON TAIL
- LM: 10μ" LIGHT SELECTIVE GOLD IN CONTACT AREA, MATTE TIN ON TAIL
- FM: 3μ" FLASH SELECTIVE GOLD IN CONTACT AREA, MATTE TIN ON TAIL

LEAD STYLE: -02: C-64-02-X

AD: .004

62-E-06

TITLE: RECEPTACLE SURFACE MOUNT (SINGLE ROW)

DWG NO: RSM-1XX-XX-XXX-S-X

SHEET 1 OF 1

- NOTES:
- PIN ONE TO BE IN DIRECTION OF ARROW ON TUBE
  - FOR ODD POSITIONS, LOSE ONE PIN PER CUT FOR EVEN POSITIONS, LOSE TWO PINS PER CUT
  - MEASURED AT BEND RADIUS
  - MINIMUM RETENTION: 1.0 LB.
  - CUT FLASH TO BE .010" MAX WITH NO FLASH ALLOW IN HOLES OR EXTENDING BELOW LEADS.
  - CONTACTS NOT TO BE INTERLEAVED.
  - Ⓢ REPRESENTS A CRITICAL DIMENSION.
  - INSULATOR MATERIAL: BLACK, LCP, UL 94 V0

OPTION	TUBE	PLUG
-P	PT-1-24-01-14	TP-03
-	PT-1-24-03-64	TP-24
-K	PT-1-24-03-64	TP-24

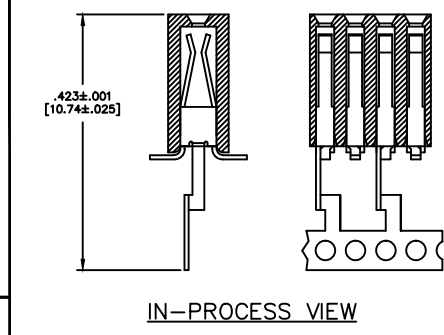

IN-PROCESS VIEW

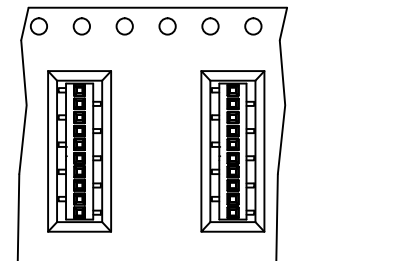
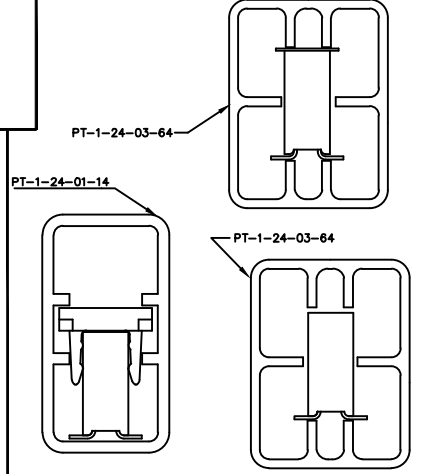

USER DIRECTION OF UNREELING  
 POCKET NOT DETAILED  
 FIG. 4  
 -TR: TAPE AND REEL

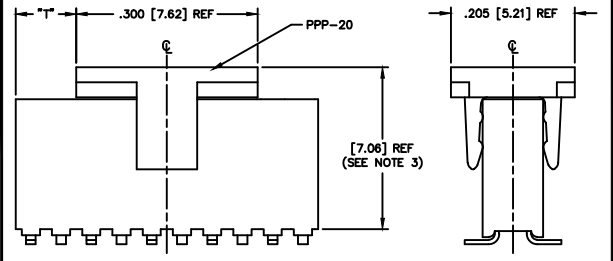

"R" = USE MEASURED DIMENSION (REF)  
 "T" =  $\{("R" - .300) / 2\} \pm .020$   
 FIG. 2  
 -P: PICK AND PLACE PAD  
 AVAILABLE ON POS 6 - 36 ONLY

RSM-1XX-XX-XXX-S-X-MKT

**samtec**

520 PARK EAST BLVD, NEW ALBANY, INDIANA 47150  
 PHONE (812) 944-8733 P.O. BOX 1147  
 CODE 95322

MADE IN CHINA REVISION 11-24-02 APPROVAL

RSM-1XX-XX-XXX-S-X  
 SHEET 1 OF 1

## X-ON Electronics

Largest Supplier of Electrical and Electronic Components

*Click to view similar products for [Board to Board & Mezzanine Connectors](#) category:*

*Click to view products by [Samtec](#) manufacturer:*

Other Similar products are found below :

[10135583-642402LF](#) [89885-310LF](#) [589158040000018](#) [6-1393048-0](#) [68683-613](#) [MDF7-12DP-2.54DSA](#) [MDF7-18P-2.54DSA\(01\)](#) [MDF7-20DP-2.54DSA](#) [MDF7-26D-2.54DSA\(55\)](#) [MDF7-3P-2.54DSA\(01\)](#) [MDF7B-3P-2.54DSA\(55\)](#) [MDF7C-11P-2.54DSA\(55\)](#) [MDF7C-18P-2.54DSA\(55\)](#) [MDF7C-5P-2.54DSA\(01\)](#) [MDF7P-5P-2.54DSA\(55\)](#) [75234-0516](#) [FCN-230C068-11](#) [FCN-268F012-G/BD](#) [FCN-268F036-G/BD](#) [FCN-268M012-G/0D](#) [FCN-268M024-G/1D](#) [FCN-360C008-C](#) [FCN-360C040-C](#) [FCN-723J004/1](#) [MIS-048-01-F-D-DP-K](#) [832-10-034-10-001000](#) [93696-325LF](#) [11828-1FA](#) [AXK630345P](#) [18097-0013](#) [ICA-328STT](#) [2007042-2](#) [304400-2](#) [FCN-214Q030-G/0](#) [FCN-215Q040-G/0](#) [FCN-230C068-ESA](#) [FCN-234P048-G/0](#) [FCN-235D050-G/C](#) [FCN-360A3](#) [FCN-360C040-B](#) [210-93-314-41-105000](#) [2-22603-0](#) [379-064-521-202](#) [MDF7-12P-2.54DSA\(01\)](#) [MDF7-16P-2.54DS\(56\)](#) [MDF7-40DP-2.54DSA\(55\)](#) [MDF7-8P-2.54DSA\(55\)](#) [MDF7B-16P-2.54DSA\(55\)](#) [AXG720047](#) [5031084030](#)